

UNITED STATES  
DEPARTMENT OF THE INTERIOR  
BUREAU OF LAND MANAGEMENT

APPLICATION FOR PERMIT TO DRILL, DEEPEN, OR PLUG BACK

1a. TYPE OF WORK  
DRILL ☒ DEEPEN ☐ PLUG BACK ☐

b. TYPE OF WELL  
OIL WELL ☐ GAS WELL ☒ OTHER ☐

2. NAME OF OPERATOR  
Meridian Oil Inc.

3. ADDRESS OF OPERATOR  
PO Box 4289, Farmington, NM 87499

4. LOCATION OF WELL (Report location clearly and in accordance with any State requirements.)  
At surface 800'S, 800'W

At proposed prod. zone

14. DISTANCE IN MILES AND DIRECTION FROM NEAREST TOWN OR POST OFFICE\*  
7 miles from Aztec, NM

15. DISTANCE FROM PROPOSED\*  
LOCATION TO NEAREST  
PROPERTY OR LEASE LINE, FT.  
(Also to nearest drig. unit line, if any)  
800'

16. NO. OF ACRES IN LEASE  
657.11

17. NO. OF ACRES ASSIGNED  
TO THIS WELL 160.00 / 160.68

18. DISTANCE FROM PROPOSED LOCATION\*  
TO NEAREST WELL, DRILLING, COMPLETED,  
OR APPLIED FOR, ON THIS LEASE, FT.  
150'

19. PROPOSED DEPTH  
2940'

20. ROTARY OR CABLE TOOLS  
Rotary

21. ELEVATIONS (Show whether DF, RT, GR, etc.)  
6318' GL  
22. APPROX. DATE WORK WILL START\*

23. DRILLING OPERATIONS AUTHORIZED ARE  
SUBJECT TO COMPLIANCE WITH ATTACHED  
PROPOSED CASING AND CEMENTING PROGRAM  
"GENERAL REQUIREMENTS". This action is subject to technical and  
procedural review pursuant to 43 CFR 3165.3  
and appeal pursuant to 43 CFR 3165.4.

SIZE OF HOLE	SIZE OF CASING	WEIGHT PER FOOT	SETTING DEPTH	
12 1/4"	9 5/8"	32.3#	200'	130 cf. circulated
8 3/4"	7"	20.0#	2758'	890 cf circ. surface
6 1/4"	5 1/2" liner	23.0#	2940'	do not cement

The Fruitland coal formation will be completed.

A 3000 psi WP and 6000 psi test double gate preventer equipped with  
blind and pipe rams will be used for blow out prevention on this well.

This gas is dedicated.

The SW/4 of Section 15 is dedicated to this well.

RECEIVED

SEP 14 1988

OIL CON. DIST. 2

IN ABOVE SPACE DESCRIBE PROPOSED PROGRAM: If proposal is to deepen or plug back, give data on present productive zone and proposed new productive zone. If proposal is to drill or deepen directionally, give pertinent data on subsurface locations and measured and true vertical depths. Give blowout preventer program, if any.

24. SIGNED [Signature] TITLE Regulatory Affairs DATE 08-18-88

(This space for Federal or State office use)

PERMIT NO. Approval of this action does not warrant that the applicant holds legal or equitable rights or title to this lease. APPROVAL DATE 08-18-88  
APPROVED BY [Signature] DATE 08-18-88  
CONDITION NMOCC

\*See Instructions On Reverse Side

STATE OF NEW MEXICO  
ENERGY AND MINERALS DEPARTMENT

OIL CONSERVATION DIVISION  
P. O. BOX 2088  
SANTA FE, NEW MEXICO 87501

Form C-102  
Revised 10-1-78

All distances must be from the outer boundaries of the Section.

Operator <b>Meridian Oil Inc.</b>		Lease <b>Sunray B (SF-078208)</b>		Well No. <b>215</b>
Unit Letter <b>M</b>	Section <b>15</b>	Township <b>30 North</b>	Range <b>10 West</b>	County <b>San Juan</b>
Actual Footage Location of Wells <b>800</b> feet from the <b>South</b> line and <b>800</b> feet from the <b>West</b> line				
Ground Level Elev. <b>6318'</b>	Producing Formation <b>Fruitland Coal</b>	Pool <b>Undesignated</b>	Dedicated Acreage: <b>160</b> <i>160-68</i> Acres	

1. Outline the acreage dedicated to the subject well by colored pencil or hachure marks on the plat below.
2. If more than one lease is dedicated to the well, outline each and identify the ownership thereof (both as to working interest and royalty).
3. If more than one lease of different ownership is dedicated to the well, have the interests of all owners been consolidated by communitization, unitization, force-pooling, etc?

☐ Yes ☐ No If answer is "yes," type of consolidation \_\_\_\_\_

If answer is "no," list the owners and tract descriptions which have actually been consolidated. (Use reverse side of this form if necessary.) \_\_\_\_\_

No allowable will be assigned to the well until all interests have been consolidated (by communitization, unitization, forced-pooling, or otherwise) or until a non-standard unit, eliminating such interests, has been approved by the Division

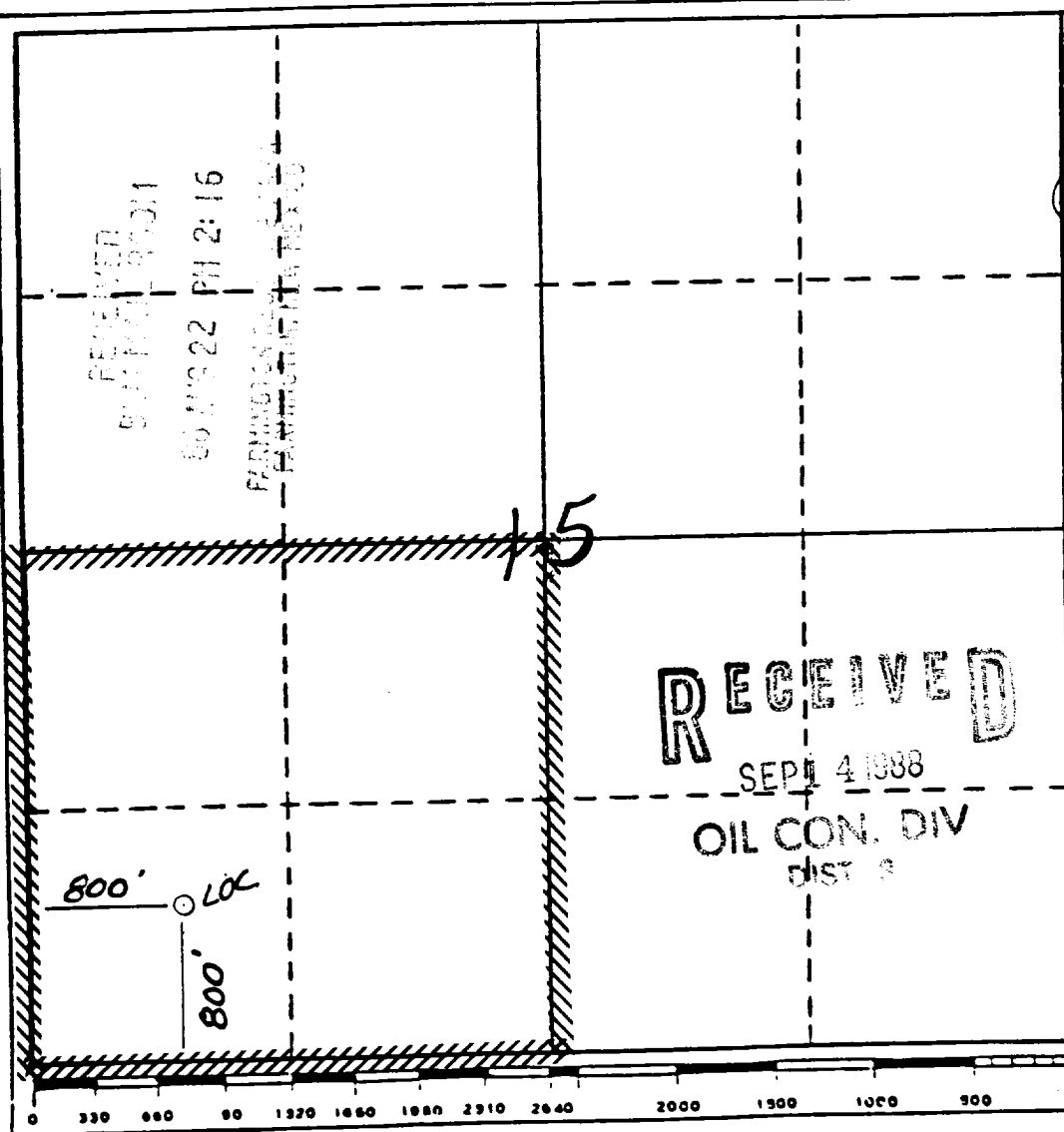

CERTIFICATION

I hereby certify that the information contained herein is true and complete to the best of my knowledge and belief.

Name  
**Meridian Oil Inc.**

Position  
**Regulatory Affairs**

Company  
**8-19-88**

Date  
**8-19-88**

I hereby certify that the well location shown on this plat is plotted from field notes of actual surveys made by me or under my supervision, and the same is true to the best of my knowledge and belief.

**NEALE C. EDWARDS**  
Date Surveyed  
**7-9-88**

Registered Professional Engineer and/or Land Surveyor

**Neale C. Edwards**

Certificate No.  
**6657**

