

UNITED STATES
DEPARTMENT OF THE INTERIOR
BUREAU OF LAND MANAGEMENT

APPLICATION FOR PERMIT TO DRILL, DEEPEN, OR PLUG BACK

1A. TYPE OF WORK

DRILL ☒

DEEPEN ☐

PLUG BACK ☐

B. TYPE OF WELL

OIL
WELL ☐

GAS
WELL ☒

OTHER ☐

SINGLE
ZONE ☒

MULTIPLE
ZONE ☐

2. NAME OF OPERATOR

Meridian Oil Inc.

3. ADDRESS OF OPERATOR

PO Box 4289, Farmington, NM 87499

4. LOCATION OF WELL (Report location clearly and in accordance with any State requirements.)

At 1190'S, 1800'W

At proposed prod. zone

14. DISTANCE IN MILES AND DIRECTION FROM NEAREST TOWN OR POST OFFICE*

10 miles from Aztec, NM

15. DISTANCE FROM PROPOSED*

LOCATION TO NEAREST
PROPERTY OR LEASE LINE, FT.
(Also to nearest drg. unit line, if any)

1190'

16. NO. OF ACRES IN LEASE

24.00

17. NO. OF ACRES ASSIGNED
TO THIS WELL

60.00 / 15.98

18. DISTANCE FROM PROPOSED LOCATION
TO NEAREST WELL DRILLING, COMPLETED,
OR APPLIED FOR, ON THIS LEASE, FT.

400'

19. PROPOSED DEPTH

3033'

20. ROTARY OR CABLE TOOLS

Rotary

21. ELEVATIONS (Show whether DF, RT, GR, etc.)

6397' GL

22. APPROX. DATE WORK WILL START*

23. SUBJECT TO COMPLIANCE WITH PROPOSED CASING AND CEMENTING PROGRAM, AND GENERAL REQUIREMENTS, IF ANY.

SIZE OF HOLE	SIZE OF CASING	WEIGHT PER FOOT	SETTING DEPTH	QUANTITY OF CEMENT
12 1/4"	9 5/8"	32.3#	200'	130 cf. circulated
8 3/4"	7"	20.0#	2874'	327 cf. cover Ojo Alamo
6 1/4"	5 1/2" liner	23.0#	3033'	do not cement

The Fruitland coal formation will be completed.

A 3000 psi WP and 6000 psi test double gate preventer equipped with blind and pipe rams will be used for blow out prevention on this well.

This gas is dedicated.

The SW/4 of Section 13 is dedicated to this well.

IN ABOVE SPACE DESCRIBE PROPOSED PROGRAM: If proposal is to deepen or plug back, give data on present productive zone and proposed new productive zone. If proposal is to drill or deepen directionally, give pertinent data on subsurface locations and measured and true vertical depths. Give blowout preventer program, if any.

24. SIGNED [Signature] TITLE Regulatory Affairs DATE 09-13-88

(This space for Federal or State office use)

PERMIT NO. _____

APPROVAL DATE _____

APPROVED
AS AMENDED [Signature]

SEP 26 1988

AREA MANAGER

"Approval of this action does
not warrant that the applicant
holds legal or equitable rights
or title to this lease."

*See Instructions On Reverse Side

Title 18 U.S.C. Section 1001, makes it a crime for any person knowingly and willfully to make to any department or agency of the United States any false, fictitious or fraudulent statements or representations as to any matter within its jurisdiction.

All distances must be from the outer boundaries of the Section

Operator Meridian Oil Inc.		Lease Pierce A SF-078125B)		Well No. 210
Unit Letter A	Section 13	Township 30 North	Range 10 West	County San Juan
Actual Footage Location of Wells: 1190 feet from the South line and 1800 feet from the West line				
Ground Level Elev. 6397	Producing Formation Fruitland Coal	Pool Undesignated	Dedicated Acreage: 164 156.98 ac	

1. Outline the acreage dedicated to the subject well by colored pencil or hachure marks on the plat below.
2. If more than one lease is dedicated to the well, outline each and identify the ownership thereof (both as to work interest and royalty).
3. If more than one lease of different ownership is dedicated to the well, have the interests of all owners been consolidated by communitization, unitization, force-pooling etc?

☐ Yes ☐ No If answer is "yes," type of consolidation _____

If answer is "no," list the owners and tract descriptions which have actually been consolidated. (Use reverse side this form if necessary.) _____

No allowable will be assigned to the well until all interests have been consolidated (by communitization, unitization, forced-pooling, or otherwise) or until a non-standard unit, eliminating such interests, has been approved by the Division.

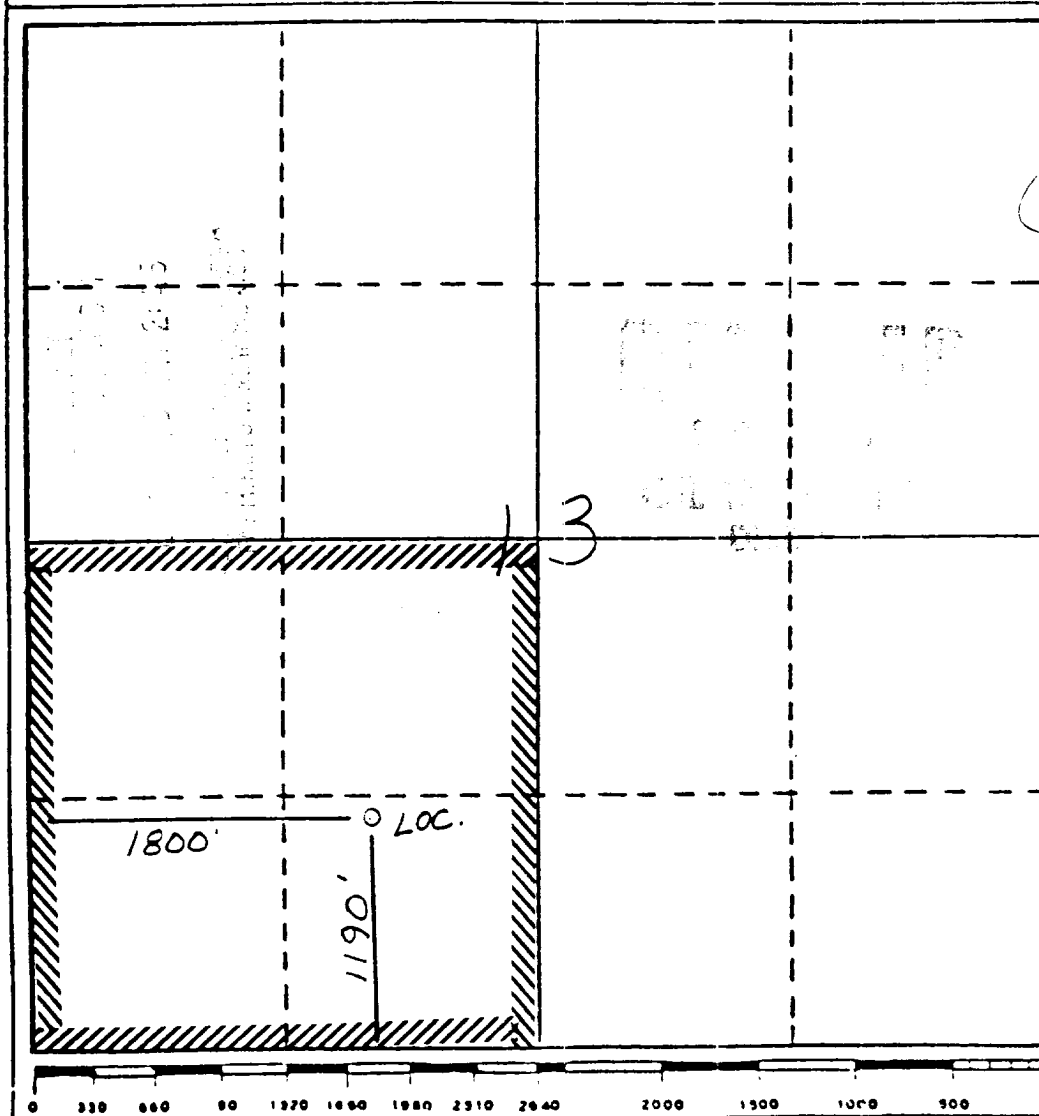

CERTIFICATION

I hereby certify that the information contained herein is true and complete to best of my knowledge and belief.

Name
Regulatory Affairs

Position
Meridian Oil Inc.

Company
9-17-88

Date

I hereby certify that the well location shown on this plat is plotted from field notes of actual survey made by me under supervision, and to the best of my knowledge and belief is true.

Neale C. Edwards

Date Surveyed
7-22-88

Registered Professional Engineer
and/or Land Surveyor

Neale C. Edwards

Certificate No.
6857

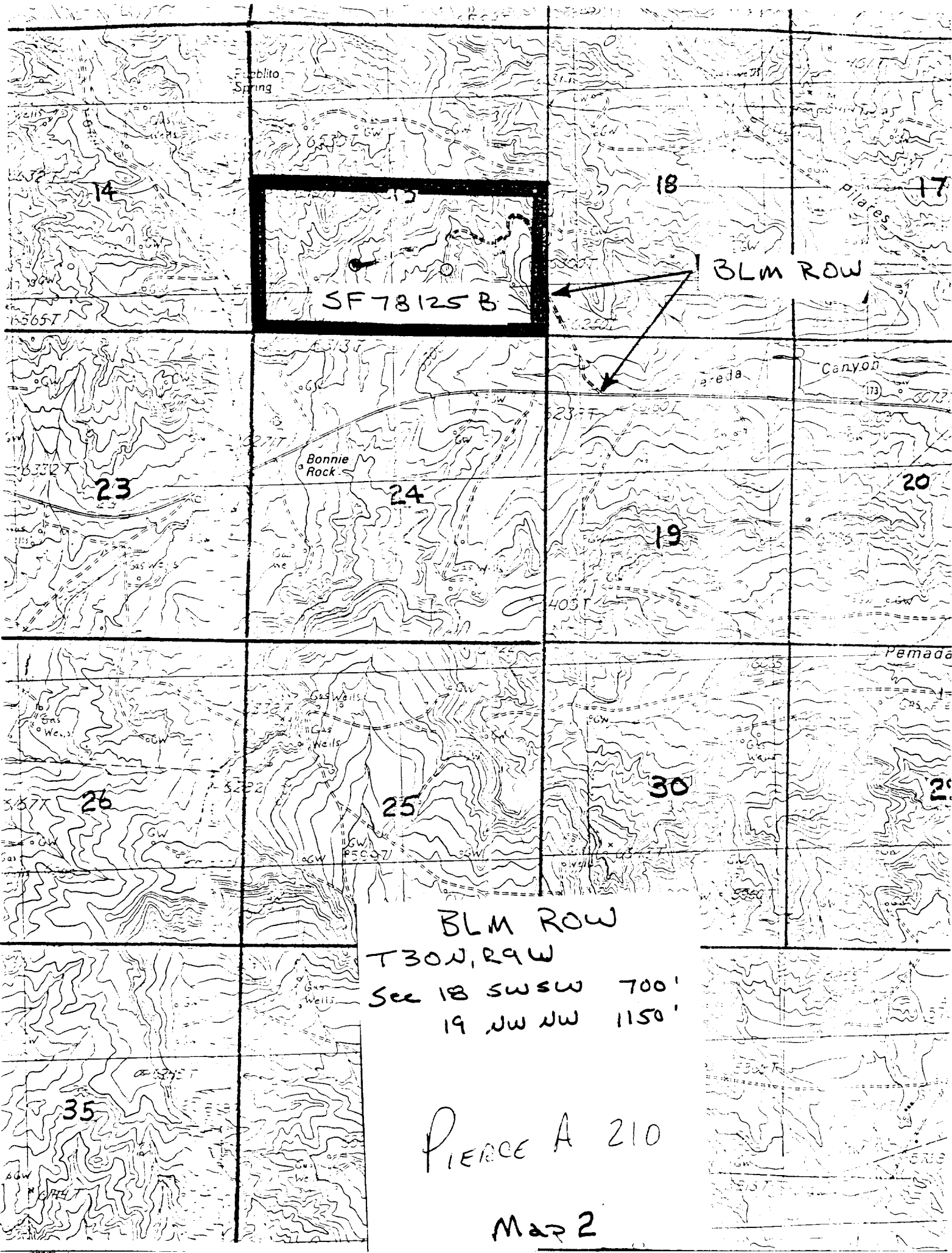

Flabito Spring

SF 78125 B

BLM ROW

Bonnie Rock

BLM ROW

T30N, R9W

Sec 18 SWSW 700'

19 NW NW 1150'

Pierce A 210

Mar 2