

UNITED STATES
DEPARTMENT OF THE INTERIOR
BUREAU OF LAND MANAGEMENT

SUBMIT IN TRIPLICATE*
(Other instructions on re-
verse side)

Form approved.
Budget Bureau No. 1004-0135
Expires August 31, 1985

SUNDRY NOTICES AND REPORTS ON WELLS

(Do not use this form for proposals to drill or to deepen or plug back to a different reservoir.
Use "APPLICATION FOR PERMIT—" for such proposals.)

1. OIL WELL <input type="checkbox"/> GAS WELL <input checked="" type="checkbox"/> OTHER <input type="checkbox"/>	7. UNIT AGREEMENT NAME
2. NAME OF OPERATOR Meridian Oil Inc.	8. FARM OR LEASE NAME Riddle B
3. ADDRESS OF OPERATOR P.O. Box 4289, Farmington, NM 87499	9. WELL NO. 222
4. LOCATION OF WELL (Report location clearly and in accordance with any State requirements.* See also space 17 below.) At surface 1450'S, 1520'W	10. FIELD AND POOL, OR WILDCAT Basin Fruitland Coal
14. PERMIT NO.	11. SEC., T., R., M., OR S.E. AND SUBVY OF LAND Sec. 23, T30N, R10W NMPM
15. ELEVATIONS (Show whether OF, ST, OR, etc.) 6183'GL	12. COUNTY OR PARISH 13. STATE San Juan NM

16. Check Appropriate Box To Indicate Nature of Notice, Report, or Other Data

NOTICE OF INTENTION TO:		SUBSEQUENT REPORT OF:	
TEST WATER SHUT-OFF <input type="checkbox"/>	POOL OR ALTER CASING <input type="checkbox"/>	WATER SHUT-OFF <input type="checkbox"/>	REPAIRING WELL <input type="checkbox"/>
FRACTURE TREAT <input type="checkbox"/>	MULTIPLE COMPLETION <input type="checkbox"/>	FRACTURE TREATMENT <input type="checkbox"/>	ALTERING CASING <input type="checkbox"/>
SHOOT OR ACIDIZE <input type="checkbox"/>	ABANDON* <input type="checkbox"/>	SHOOTING OR ACIDIZING <input type="checkbox"/>	ABANDONMENT* <input type="checkbox"/>
REPAIR WELL <input type="checkbox"/>	CHANGE PLANS <input type="checkbox"/>	(Other) <input type="checkbox"/>	
(Other) Revision <input checked="" type="checkbox"/>		(NOTE: Report results of multiple completion on Well Completion or Recompletion Report and Log form.)	

17. DESCRIBE PROPOSED OR COMPLETED OPERATIONS (Clearly state all pertinent details, and give pertinent dates, including estimated date of starting any proposed work. If well is directionally drilled, give subsurface locations and measured and true vertical depths for all markers and zones pertinent to this work.) *

Attached is a copy of the C102 showing the revised pool & dedication.

RECEIVED

DEC 28 1988

BUREAU OF LAND MANAGEMENT
FARMINGTON RESOURCE AREA

18. I hereby certify that the foregoing is true and correct

SIGNED [Signature]

TITLE Regulatory Affairs

DATE 12-23-88

(This space for Federal or State office use)

APPROVED BY _____
CONDITIONS OF APPROVAL, IF ANY:

TITLE _____

ACCEPTED FOR RECORD
DATE _____

JAN 09 1989

*See Instructions on Reverse Side

FARMINGTON, NM

STATE OF NEW MEXICO
ENERGY AND MINERALS DEPARTMENT

P. O. BOX 2088
SANTA FE, NEW MEXICO 87501

Form C-102
Revised 10-1-78

All distances must be from the outer boundaries of the Section.

Operator Meridian Oil Inc.		Lease Riddle B (SF-078200B0)		Well No. 222
Unit Letter K	Section 23	Township 30 North	Range 10 West	County San Juan
Actual Footage Location of Well: 1450 feet from the South line and 1520 feet from the West line				
Ground Level Elev. 6183'	Producing Formation Fruitland Coal		Pool <i>Basin</i>	Dedicated Acreage: W 315.56 Acres

1. Outline the acreage dedicated to the subject well by colored pencil or hatchure marks on the plat below.
2. If more than one lease is dedicated to the well, outline each and identify the ownership thereof (both as to working interest and royalty).
3. If more than one lease of different ownership is dedicated to the well, have the interests of all owners been consolidated by communitization, unitization, force-pooling, etc?

☐ Yes ☐ No If answer is "yes," type of consolidation _____

If answer is "no," list the owners and tract descriptions which have actually been consolidated. (Use reverse side of this form if necessary.) _____

No allowable will be assigned to the well until all interests have been consolidated (by communitization, unitization, forced-pooling, or otherwise) or until a non-standard unit, eliminating such interests, has been approved by the Division

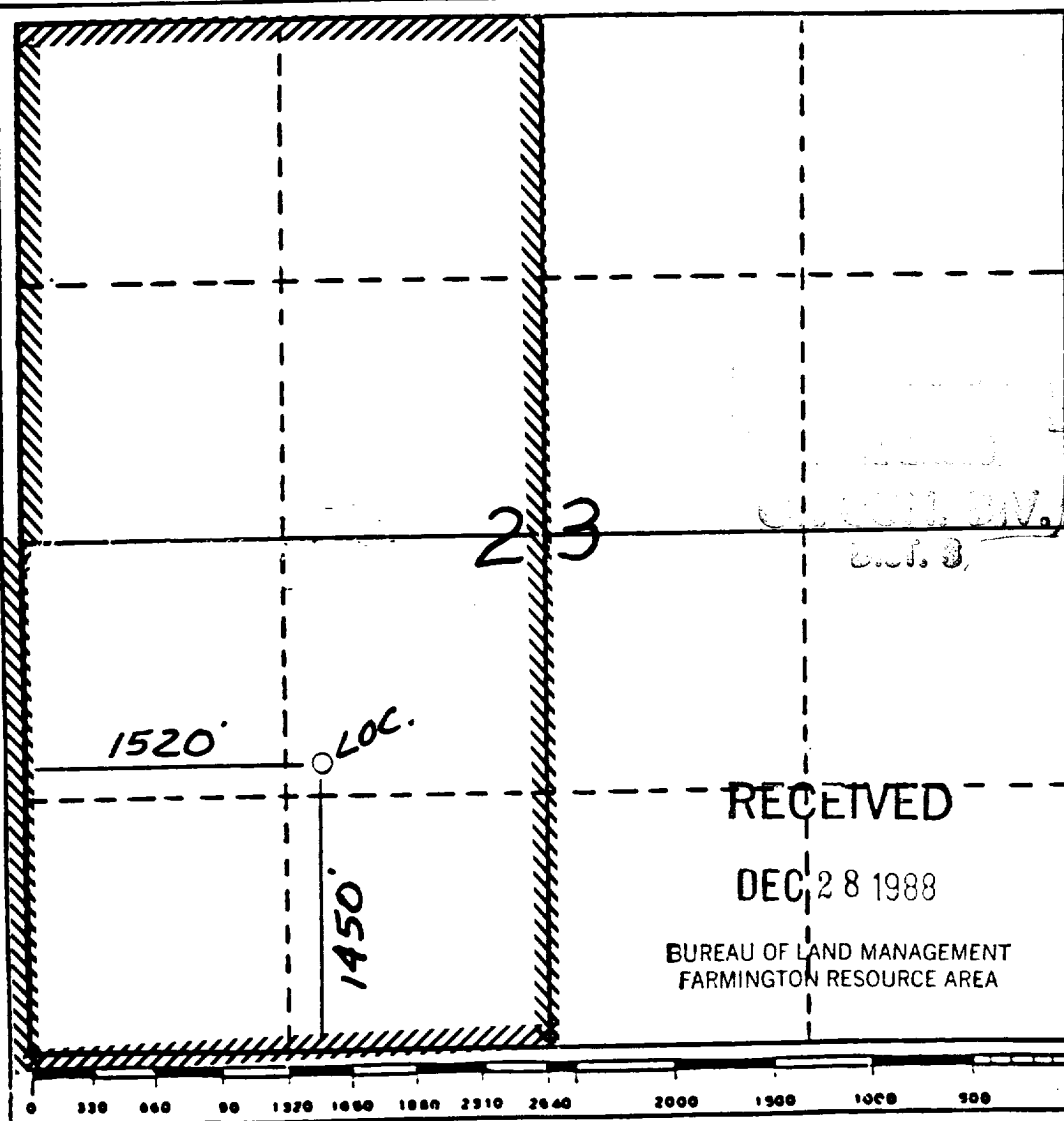

CERTIFICATION

I hereby certify that the information contained herein is true and complete to the best of my knowledge and belief.

Name
Drilling Clerk
Position
Meridian Oil Inc.
Company
12-22-88

Date
30

I hereby certify that the well location shown on this plat was plotted from field notes of actual survey made by me or under my supervision, and that the same is true and correct to the best of my knowledge and belief.

NEALE C. EDWARDS
Date Surveyed
7-13-88
Registered Professional Engineer
and/or Land Surveyor

Neale C. Edwards
Certificate No.
6857

RECEIVED

DEC 28 1988

BUREAU OF LAND MANAGEMENT
FARMINGTON RESOURCE AREA