

NO. OF COPIES RECEIVED	
DISTRIBUTION	
SANTA FE	
FILE	
U.S.G.S.	
LAND OFFICE	
OPERATOR	

NEW MEXICO OIL CONSERVATION COMMISSION

Form C-101
Revised 1-4-65

5A. Indicate Type of Lease	
STATE <input checked="" type="checkbox"/>	FEE <input type="checkbox"/>
5. State Oil & Gas Lease No.	
E-3521-2	

APPLICATION FOR PERMIT TO DRILL, DEEPEN, OR PLUG BACK

1a. Type of Work		7. Unit Agreement Name	
b. Type of Well OIL WELL <input type="checkbox"/> GAS WELL <input checked="" type="checkbox"/> OTHER <input type="checkbox"/>		8. Farm or Lease Name Seymour A Com	
2. Name of Operator Meridian Oil Inc.		9. Well No. 503	
3. Address of Operator PO Box 4289, Farmington, NM 87499		10. Field and Pool, or Wildcat Basin, Fruitland Coal	
4. Location of Well UNIT LETTER <u>K</u> LOCATED <u>1450</u> FEET FROM THE <u>South</u> LINE AND <u>1835</u> FEET FROM THE <u>West</u> LINE OF SEC. <u>36</u> TWP. <u>30N</u> RGE. <u>11W</u> NMPM		12. County San Juan	
19. Proposed Depth 2223'		19A. Formation Fruitland	
20. Rotary or C.T. Rotary		21. Elevations (Show whether DF, RT, etc.) 5858' GL	
21A. Kind & Status Plug. Bond statewide		21B. Drilling Contractor	
22. Approx. Date Work will start			

PROPOSED CASING AND CEMENT PROGRAM

SIZE OF HOLE	SIZE OF CASING	WEIGHT PER FOOT	SETTING DEPTH	SACKS OF CEMENT	EST. TOP
12 1/4"	9 5/8"	36.0#	200'	130 cu.ft.	circ. surface
8 3/4"	7"	20.0#	2010'	333 cu.ft.	circ. surface
6 1/4"	5 1/2"	23.0#	2223'	do not cement	

The Fruitland Coal formation will be completed.

A 3000 psi WP and 6000 psi test double gate preventer equipped with blind and pipe rams will be used for blow out prevention on this well.

This gas is dedicated.

The W/ 2 of Section 36 is dedicated to this well.

APPROVAL BY 6-1-88
UNLESS DRILLING IS COMMENCED.
SPUD NOTICE MUST BE SUBMITTED
WITHIN 10 DAYS.

RECEIVED
NOV 30 1988
OIL CON. DIV
DIST

IN ABOVE SPACE DESCRIBE PROPOSED PROGRAM: IF PROPOSAL IS TO DEEPEN OR PLUG BACK, GIVE DATA ON PRESENT PRODUCTIVE ZONE AND PROPOSED NEW PRODUCTIVE ZONE. GIVE BLOWOUT PREVENTER PROGRAM, IF ANY.

I hereby certify that the information above is true and complete to the best of my knowledge and belief.

Signed [Signature] Title Regulatory Affairs Date November 29, 1988
(This space for State Use)

DEPUTY OIL & GAS DISTRICT, DIST. 43

APPROVED BY [Signature] TITLE DEPUTY OIL & GAS DISTRICT, DIST. 43 DATE DEC 01 1988
CONDITIONS OF APPROVAL, IF ANY:

All distances must be from the outer boundaries of the Section.

Operator Meridian Oil Inc.		Lease Seymour A Com (E-3521-2)		Well No. 503
Unit Letter K	Section 36	Township 30 North	Range 11 West	County San Juan
Actual Footage Location of Wells 1450 feet from the South line and 1835 feet from the West line				
Ground Level Elev. 5858'	Producing Formation Fruitland Coal	Pool Undesignated	Dedicated Acreage: 320.00 Acres	

1. Outline the acreage dedicated to the subject well by colored pencil or hatchure marks on the plat below.
2. If more than one lease is dedicated to the well, outline each and identify the ownership thereof (both as to working interest and royalty).
3. If more than one lease of different ownership is dedicated to the well, have the interests of all owners been consolidated by communitization, unitization, force-pooling, etc?

☒ Yes ☐ No If answer is "yes," type of consolidation communitization

If answer is "no," list the owners and tract descriptions which have actually been consolidated. (Use reverse side of this form if necessary.)

No allowable will be assigned to the well until all interests have been consolidated (by communitization, unitization, forced-pooling, or otherwise) or until a non-standard unit, eliminating such interests, has been approved by the Division.

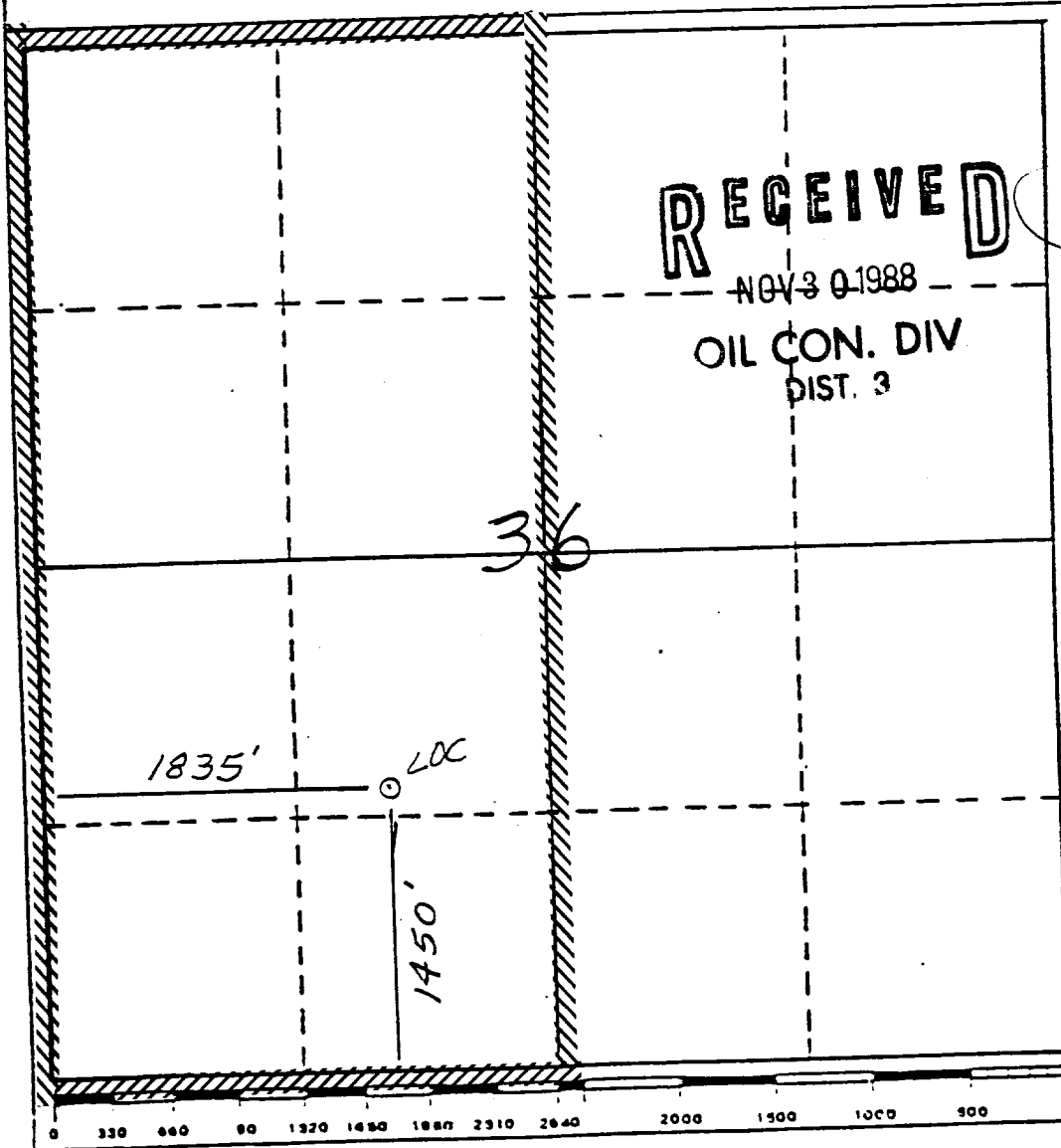

CERTIFICATION

I hereby certify that the information contained herein is true and complete to the best of my knowledge and belief.

[Signature]

Name
Regulatory Affairs

Position
Meridian Oil Inc.

Company
11-29-88

Date

I hereby certify that the location shown on this plat was plotted from notes of actual surveys made by me under supervision, and that the same is true and correct to the best of my knowledge and belief.

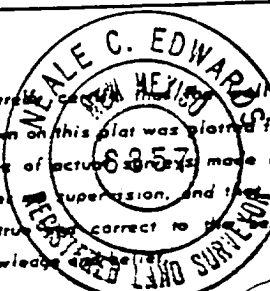

[Signature]

Date Surveyed 10-27-88

Registered Professional Engineer and/or Land Surveyor

Neale C. Edwards

Certificate No. 6857