



STATE OF NEW MEXICO

ENERGY, MINERALS AND NATURAL RESOURCES DEPARTMENT

OIL CONSERVATION DIVISION

GARREY CARRUTHERS
GOVERNOR

POST OFFICE BOX 2088
STATE LAND OFFICE BUILDING
SANTA FE, NEW MEXICO 87504
(505) 827-5800

November 22, 1988

Meridian Oil, Inc.
P.O. Box 4289
Farmington, NM 87499-4289

Attention: Peggy Bradfield

Administrative Order NSP-1547(L)

Dear Ms. Bradfield:

Reference is made to your application of July 15, 1988 and October 20, 1988 for an 83.10-acre non-standard gas spacing and proration unit consisting of the following acreage in the Undesignated Blanco Fruitland Pool:

SAN JUAN COUNTY, NEW MEXICO
TOWNSHIP 30 NORTH, RANGE 8 WEST, NMPM
Irregular Section 31: Lots 15, 16, 17 and 18

It is my understanding that this unit is to be dedicated to your Howell "M" Well No. 300 to be drilled at an unorthodox gas well location 1590 feet from the South line and 875 feet from the West line of said Section 31.

By authority granted me under the provisions of General Rules 104.F.I. and 104.D.II. the above described unorthodox gas well location and non-standard gas proration unit, respectively, are hereby approved.

Sincerely,

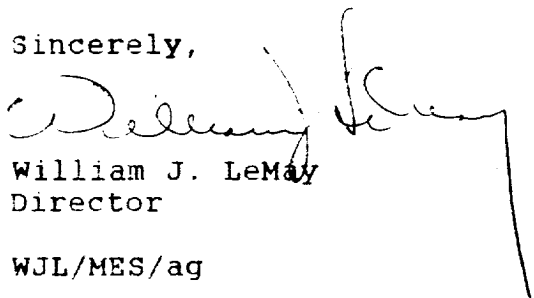
William J. LeMay
Director

WJL/MES/ag

cc: Oil Conservation Division - Aztec
NM Oil and Gas Engineering Committee - Hobbs
US Bureau of Land Management - Farmington

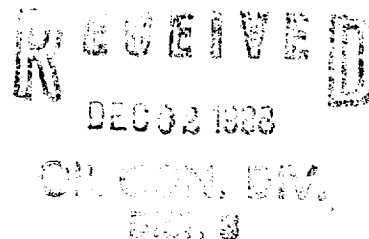



STATE OF NEW MEXICO
ENERGY AND MINERALS DEPARTMENT

OIL CONSERVATION DIVISION
AZTEC DISTRICT OFFICE

1000 OLD HIAZOS ROAD
AZTEC, NEW MEXICO 87410
(505) 334-6178

OIL CONSERVATION DIVISION
BOX 2088
SANTA FE, NEW MEXICO 87501

DATE 10-24-88

RE: Proposed HC _____
Proposed DHC _____
Proposed HSL _____
Proposed SWD _____
Proposed WFX _____
Proposed PMX _____

NSP &

Gentlemen:

I have examined the application dated 10-6-88

for the MERIDIAN OIL INC. HOWELL M#300 K-31-30N-8cs
Operator Lease and Well No. Unit, S-T-R

and my recommendations are as follows:

APPROVE

Yours truly,

E. Burch

MERIDIAN OIL

October 6, 1988

Mr. William LeMay
New Mexico Oil Conservation Division
Post Office Box 2088
Santa Fe, New Mexico 87501

Dear Mr. LeMay:

This is a request for administrative approval for a non-standard unit for a gas well location in the Undesignated Fruitland Pool.

It is intended to locate the Meridian Oil Inc.'s Howell M #300 at 1590' from the South line and 875' from the West line of Section 31, T-30-N, R-8-W, San Juan County, New Mexico.

A copy of this application is being submitted to all offset operators by certified mail with a request that they furnish your Santa Fe office with a Waiver of Objection, and return one copy to this office.

A plat showing the proposed well location and configuration of Section 31, along with an ownership plat, are attached.

Sincerely yours,



Peggy Bradfield

encl.

WAIVER

_____ hereby waives objection to Meridian Oil Inc.'s application for a non-standard unit location for their Howell M #300 as proposed above.

By: _____

Date: _____

cc: Tenneco Oil
Union Texas Petroleum
Mesa Limited Partnership
Southland Royalty

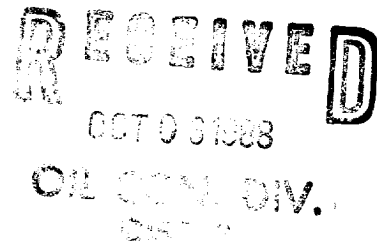

MERIDIAN OIL INC.

Well Name Howell M #300, Undesignated Fruitland

Footage---- 1590' FSL; 875' FWL

APPLICATION FOR NON-STANDARD PRORATION UNIT

County San Juan State New Mexico Section 31 Township 30N Range 8W

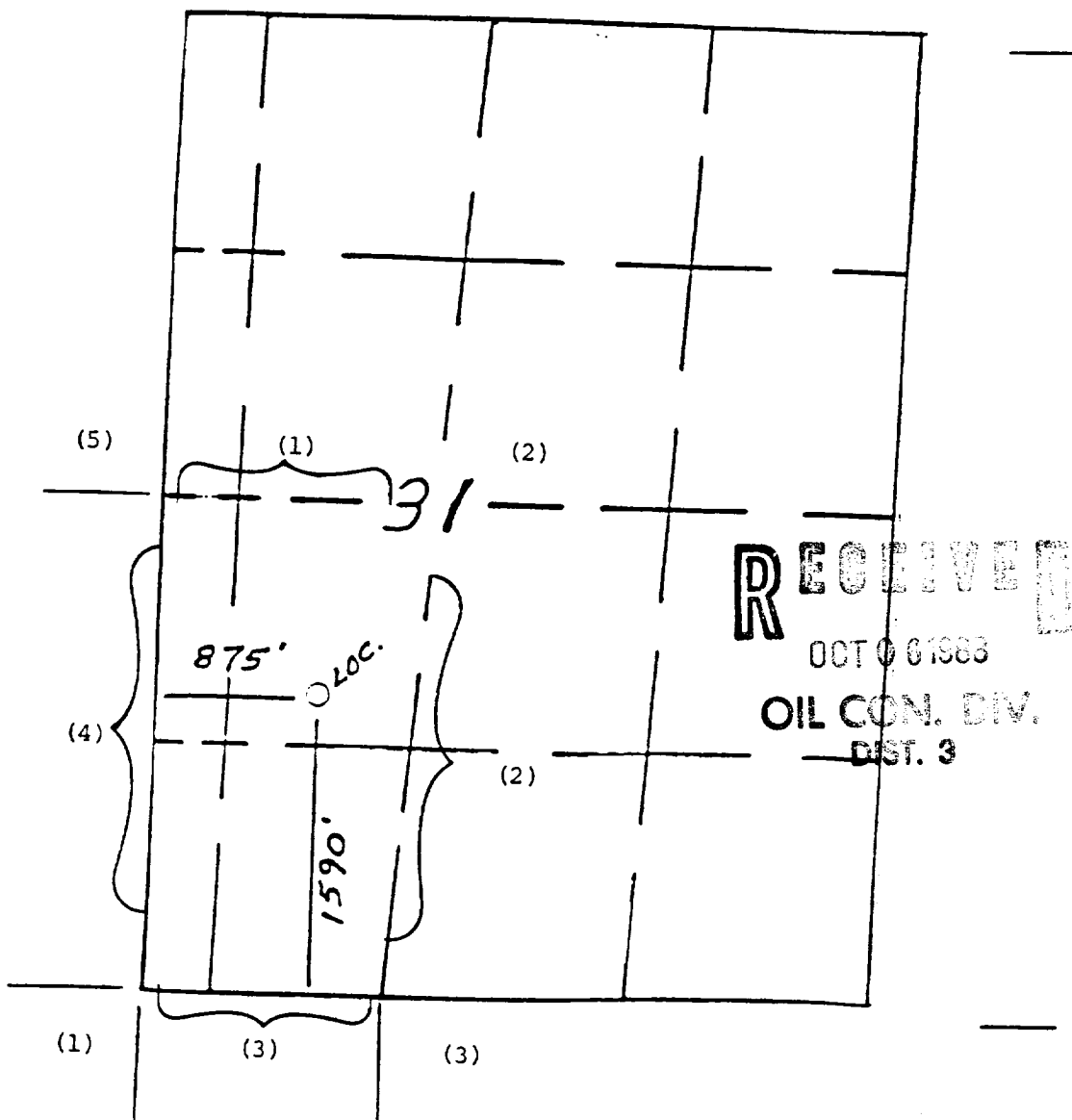

REMARKS: OFFSET OPERATORS:

(1) Meridian Oil Inc.

(2) Tenneco Oil Company

(3) Union Texas Petroleum

(4) Mesa Limited Partnership

(5) Southland Royalty Company

All distances must be from the outer boundaries of the Section.

Operator Meridian Oil Inc.		Lease Howell M NM-012708		Well No. 300
Unit Letter K	Section 31	Township 30 N	Range 8 W	County San Juan
Actual Footage Location of Wells 1590 feet from the South line and 875 feet from the West line				
Ground Level Elev. 6278'	Producing Formation Fruitland Coal	Pool Undesignated	Dedicated Acreage: 83.10 Acres	

1. Outline the acreage dedicated to the subject well by colored pencil or hatchure marks on the plat below.
2. If more than one lease is dedicated to the well, outline each and identify the ownership thereof (both as to working interest and royalty).
3. If more than one lease of different ownership is dedicated to the well, have the interests of all owners been consolidated by communitization, unitization, force-pooling, etc?

☐ Yes ☐ No If answer is "yes," type of consolidation _____

If answer is "no," list the owners and tract descriptions which have actually been consolidated. (Use reverse side of this form if necessary.) _____

No allowable will be assigned to the well until all interests have been consolidated (by communitization, unitization, forced-pooling, or otherwise) or until a non-standard unit, eliminating such interests, has been approved by the Division.

* Note: There are no standard locations in this $\frac{1}{4}$ section.

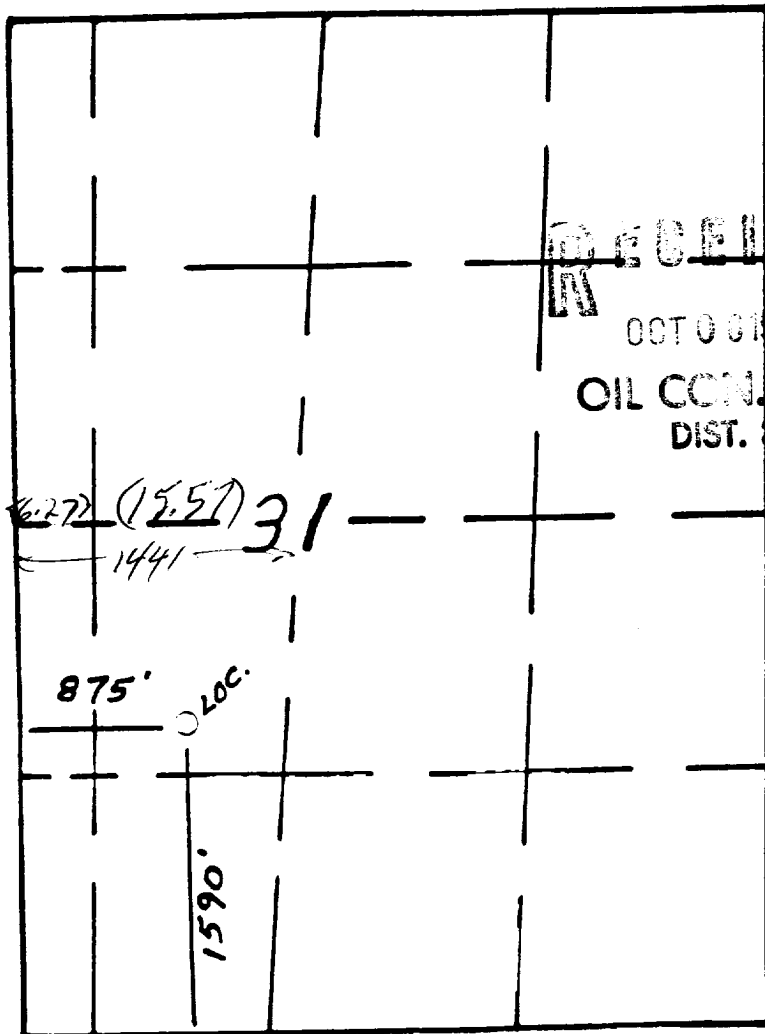

CERTIFICATION

I hereby certify that the information contained herein is true and complete to the best of my knowledge and belief.

Name
Drilling Clerk

Position
Meridian Oil Inc.

Company

Date

I hereby certify that the well location shown on this plat was plotted from field notes of actual surveys made by me or under my supervision, and that the same is true and correct to the best of my knowledge and belief.

Leale C. Edwards

Date Surveyed
6-15-88

Registered Professional Engineer
and/or Land Surveyor

Leale C. Edwards

Certificate No.
6857