



STATE OF NEW MEXICO
ENERGY AND MINERALS DEPARTMENT
OIL CONSERVATION DIVISION
AZTEC DISTRICT OFFICE

1000 RIO BRAZOS ROAD
AZTEC NEW MEXICO 87410
(505) 334-6178

OIL CONSERVATION DIVISION
BOX 2088
SANTA FE, NEW MEXICO 87501

DATE 4-4-89

RE: Proposed MC _____
Proposed DHC _____
Proposed NSL X _____
Proposed SWD _____
Proposed WFX _____
Proposed PMX _____

Gentlemen:

I have examined the application dated 4-3-89
for the Blackwood & Nichols N.E. B.U. #450 N-32-31A5-7W
Operator Lease and Well No. Unit, _____

and my recommendations are as follows:

It appears -

Yours truly,

Edna Buel

Attn: E. Busch

BLACKWOOD & NICHOLS Co., LTD.

P.O. BOX 1237

DURANGO, COLORADO 81302-1237

(303) 247-0728

March 23, 1989

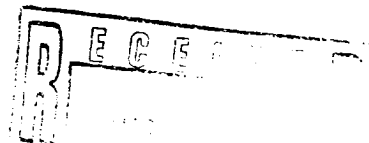

Mr. William LeMay
New Mexico Oil Conservation Division
P.O.Box 2088
Santa Fe, New Mexico 87501

Re: Unorthodox Gas Well Location
Northeast Blanco Unit No. 450
795' FSL - 2010' FWL, Sec. 32, T31N, R7W
San Juan Co., New Mexico

Dear Mr. LeMay;

Blackwood & Nichols Co., Ltd. requests administrative approval of an exception to the footage requirements of Rule 7, R -8768 for the subject well, located in the Basin Fruitland Coal Pool.

This request is for exception due to topography. A Vicinity Map and C-102 are attached for your reference. The location was staked at this proposed site to stay away from the steep walls of the Pine River arm of Navajo Lake.

The west half of Section 32, T31N, R7W, will be dedicated to this well. All offset proration units are operated by Blackwood and Nichols Co., Ltd.

Your prompt consideration of this request is appreciated.

Sincerely,

RECEIVED
APR 3 - 1989
OIL CON. DIV.
DIST. 8

William F. Clark

William F. Clark
Operations Manager
Blackwood & Nichols
Co., Ltd.

STATE OF NEW MEXICO
ENERGY AND MINERALS DEPARTMENT

OIL CONSERVATION DIVISION

P. O. BOX 2088
SANTA FE, NEW MEXICO 87501

Form C-102
Revised 10-1-7

All distances must be from the outer boundaries of the Section.

Operator Blackwood & Nichols Co., LTD.			Lease Northeast Blanco Unit		Well No. 450
Unit Letter N	Section 32	Township 31 North	Range 7 West	County San Juan	
Actual Footage Location of Wells 795 feet from the South line and 2010 feet from the West line					
Ground Level Elev. 6349'	Producing Formation Fruitland Coal		Pool Basin Fruitland Coal		Dedicated Acreage 320.11 Acres

1. Outline the acreage dedicated to the subject well by colored pencil or hatchure marks on the plat below.
2. If more than one lease is dedicated to the well, outline each and identify the ownership thereof (both as to working interest and royalty).
3. If more than one lease of different ownership is dedicated to the well, have the interests of all owners been consolidated by communitization, unitization, force-pooling, etc?

☒ Yes ☐ No If answer is "yes," type of consolidation Unitization

If answer is "no," list the owners and tract descriptions which have actually been consolidated. (Use reverse side of this form if necessary.)

No allowable will be assigned to the well until all interests have been consolidated (by communitization, unitization, force-pooling, or otherwise) or until a non-standard unit, eliminating such interests, has been approved by the Division.

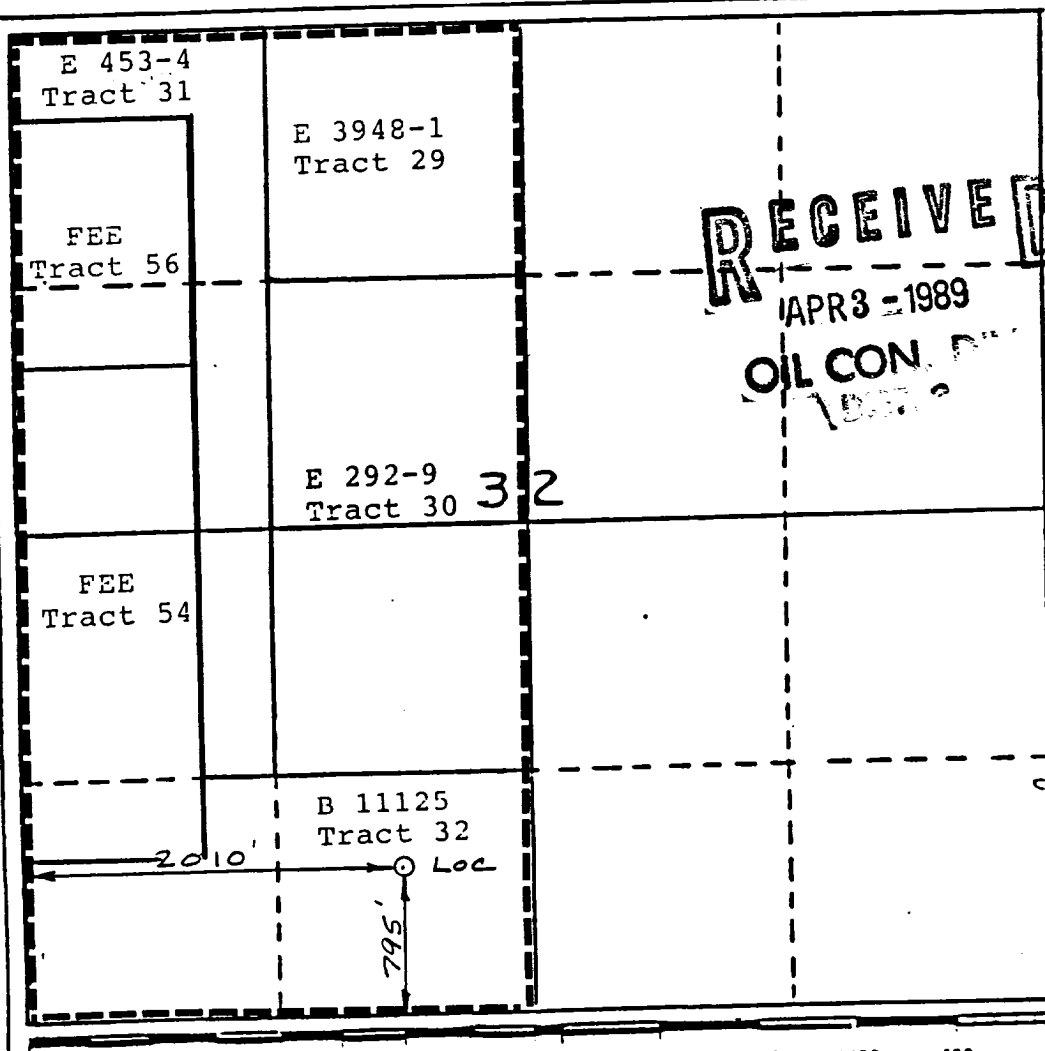

CERTIFICATION

I hereby certify that the information contained herein is true and complete to the best of my knowledge and belief.

Name William F. Clark
Position Operations Manager
Company Blackwood & Nichols Co.
Date 3-27-89

I hereby certify that the location shown on this plat was plotted from the notes of survey made by me under supervision, and the same is true and correct to the best of my knowledge and belief.

Date Surveyed 11/28/88
Registered Professional Engineer and/or Land Surveyor

W. C. Edwards
Certificate No. 6057

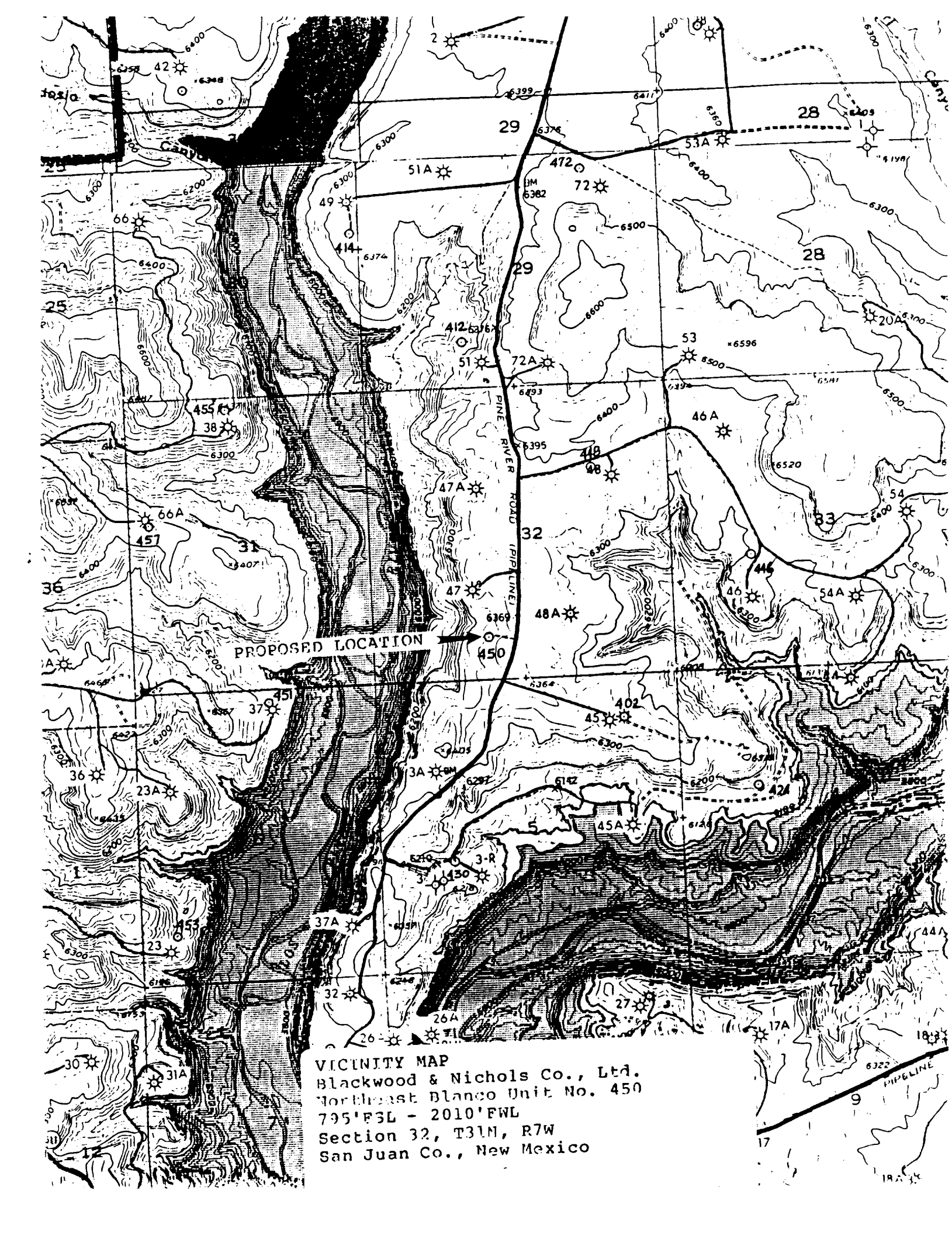

VICINITY MAP
 Blackwood & Nichols Co., Ltd.
 Northeast Blanco Unit No. 450
 795'F3L - 2010'FWL
 Section 32, T31N, R7W
 San Juan Co., New Mexico

BLACKWOOD & NICHOLS CO., LTD.
 Northeast Blanco Unit No. 450
 N, Sec. 32, T31N, R7W, San Juan, NM

T
31
N

