

All distances must be from the outer boundaries of the Section.

Operator Meridian Oil Inc.			Lease Federal Com (SF-043260B)		Well No. 502
Unit Letter L	Section 33	Township 30 North	Range 11 West	County San Juan	
Actual Footage Location of Well: 1350 feet from the South line and 1225 feet from the West line					
Ground Level Elev. 5866	Producing Formation Fruitland Coal		Pool Basin		Dedicated Acreage 320.89 Act

1. Outline the acreage dedicated to the subject well by colored pencil or hatchure marks on the plat below.
2. If more than one lease is dedicated to the well, outline each and identify the ownership thereof (both as to working interest and royalty).
3. If more than one lease of different ownership is dedicated to the well, have the interests of all owners been consolidated by communitization, unitization, force-pooling, etc?

☒ Yes ☐ No If answer is "yes," type of consolidation communitization agreement NM-8389

If answer is "no," list the owners and tract descriptions which have actually been consolidated. (Use reverse side of this form if necessary.)

No allowable will be assigned to the well until all interests have been consolidated (by communitization, unitization, force-pooling, or otherwise) or until a non-standard unit, eliminating such interests, has been approved by the Division.

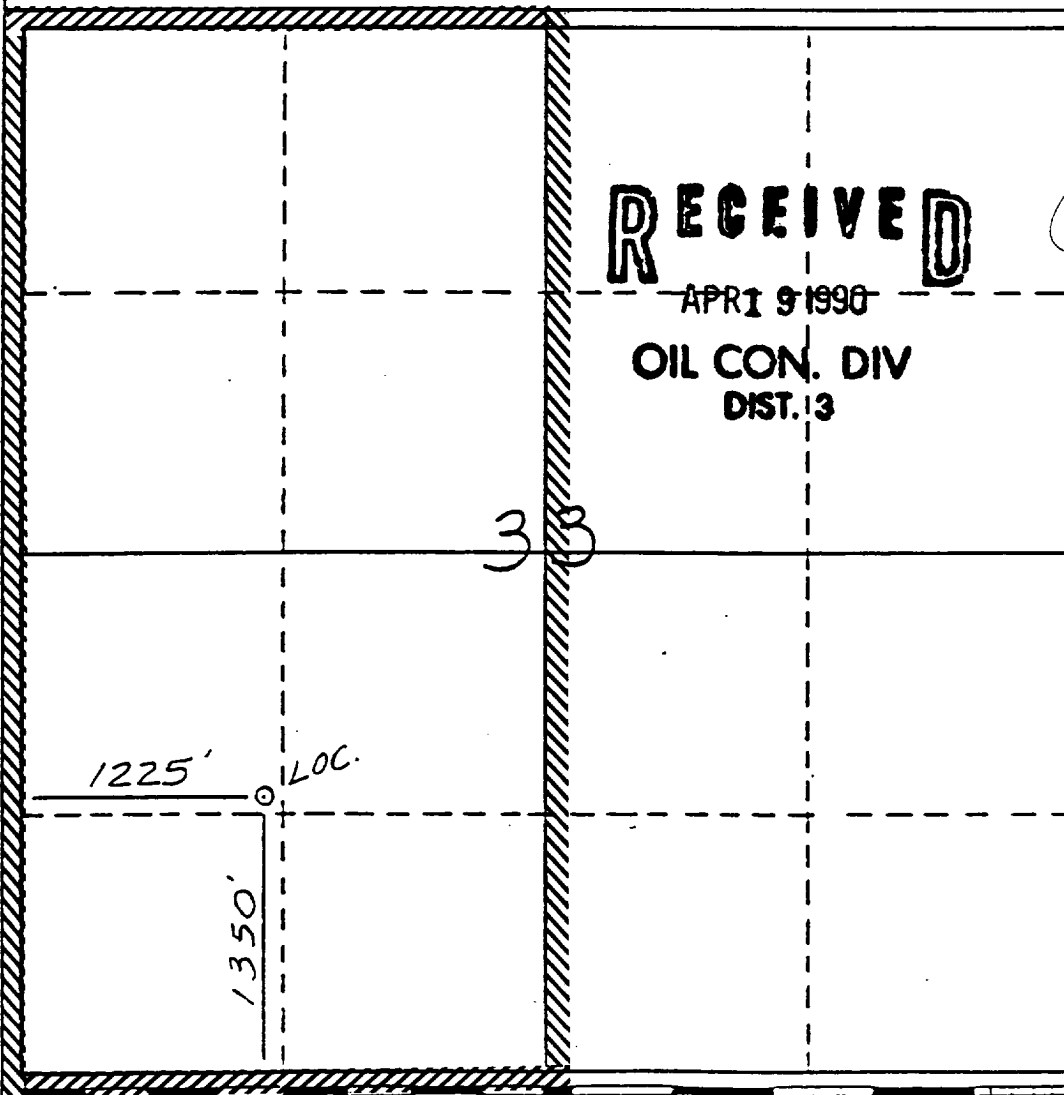

RECEIVED
APR 9 1990
OIL CON. DIV
DIST. 3

CERTIFICATION

I hereby certify that the information contained herein is true and complete to the best of my knowledge and belief.

Peggy Bradford
Name

Peggy Bradford

Position
Regulatory Affairs

Company
Meridian Oil Inc.

Date
4-18-90

I hereby certify that the location shown on this plat was plotted from field notes of actual surveys made by me or under my supervision, and that the same is true and correct to the best of my knowledge and belief.

Neale C. Edwards
Date Surveyed

12-1-88

Registered Professional Engineer and/or Land Surveyor

Neale C. Edwards

Certificate No.
6857

RECEIVED
JAN 14 1964
OFFICE OF THE
DIRECTOR
U.S. AIR FORCE