

UNITED STATES  
DEPARTMENT OF THE INTERIOR  
GEOLOGICAL SURVEY

## APPLICATION FOR PERMIT TO DRILL, DEEPEN, OR PLUG BACK

## 1a. TYPE OF WORK

DRILL ☒DEEPEN ☐PLUG BACK ☐

## b. TYPE OF WELL

OIL  
WELL ☐GAS  
WELL ☒

OTHER

## 2. NAME OF OPERATOR

Blackwood &amp; Nichols Co., LTD.

## 3. ADDRESS OF OPERATOR

P.O. Box 1237, Durango, CO 81302-1237

## 4. LOCATION OF WELL (Report location clearly and in accordance with any State requirements)

At surface

1310' FNL - 830' FEL

At proposed prod. zone

## 14. DISTANCE IN MILES AND DIRECTION FROM NEAREST TOWN OR POST OFFICE\*

16.5 miles NE of Blanco, New Mexico

## 15. DISTANCE FROM PROPOSED\*

LOCATION TO NEAREST  
PROPERTY OR LEASE LINE, FT.  
(Also to nearest drlg. unit line, if any)

830'

## 18. DISTANCE FROM PROPOSED LOCATION\*

TO NEAREST WELL, DRILLING, COMPLETED,  
OR APPLIED FOR, ON THIS LEASE, FT.

950'

## 16. NO. OF ACRES IN LEASE

2056.12

## 19. PROPOSED DEPTH

3180'

17. NO. OF ACRES ASSIGNED  
TO THIS WELL

320

## 20. ROTARY OR CABLE TOOLS

Rotary

## 21. ELEVATIONS (Show whether DF, RT, GR, etc.)

6403' GL

## 22. APPROX. DATE WORK WILL START\*

April 1, 1989

## 23. PROPOSED CASING AND CEMENTING PROGRAM

SIZE OF HOLE	SIZE OF CASING	WEIGHT PER FOOT	SETTING DEPTH
12 1/4"	9 5/8"	36 #	300'
8 3/4"	7"	23 #	3000'
6 1/4"	5 1/2"	17 #	2900- 3180'

DRILLING OPERATIONS AUTHORIZED ARE  
SUBJECT TO COMPLIANCE WITH ATTACHED  
"GENERAL REQUIREMENTS"  
20' cuft to circulate  
781 cuft to circulate  
39 cuft to circulate

Propose to spud in the San Jose formation. Will drill a 12 1/4" hole to a TD of 300'. Surface casing will be run and cemented with cement returns to surface. WOC 12 hours. Pressure test to 600 psi/30 mins. Drill an 8 3/4" hole to a TD of 3000' with fresh water mud. No abnormal pressures or poisonous gases are anticipated. Run and cement intermediate casing with cement returns to surface. WOC 12 hours. Test to 1500 psi/30 mins. Drill a 6 1/4" hole through the Fruitland coals using water and air. A 5 1/2" liner will be run. The liner may or may not be cemented, depending on the wells natural producing ability.

Surface is BLM

IN ABOVE SPACE DESCRIBE PROPOSED PROGRAM: If proposal is to deepen or plug back, give data on present productive zone and proposed new productive zone. If proposal is to drill or deepen directionally, give pertinent data on subsurface locations and measured and true vertical depths. Give blowout preventer program, if any.

24.

SIGNED

*William F. Clark*

TITLE

Operations Manager

DATE

*March 27, 89*

(This space for Federal or State office use)

PERMIT NO.

APPROVAL DATE

APPROVED BY

TITLE

CONDITIONS OF APPROVAL, IF ANY:

DATE

APPROVED  
AS AMENDED

\*See Instructions On Reverse Side

NMOCC

All distances must be from the outer boundaries of the Section.

Operator <b>Blackwood &amp; Nichols Co., LTD.</b>			Lease <b>Northeast Blanco Unit</b>		Well No. <b>416</b>
Unit Letter <b>A</b>	Section <b>21</b>	Township <b>31 North</b>	Range <b>7 West</b>	County <b>San Juan</b>	
Actual Footage Location of Wells <b>1310'</b> feet from the <b>North</b> line and <b>830'</b> feet from the <b>East</b> line					
Ground Level Elev. <b>6403</b>	Producing Formation <b>Basin Fruitland</b>		Pool <b>Basin Fruitland Coal</b>		Dedicated Acreage: <b>320</b> Acres

1. Outline the acreage dedicated to the subject well by colored pencil or hatchure marks on the plat below.
2. If more than one lease is dedicated to the well, outline each and identify the ownership thereof (both as to working interest and royalty).
3. If more than one lease of different ownership is dedicated to the well, have the interests of all owners been consolidated by communitization, unitization, force-pooling, etc?

☐ Yes ☐ No If answer is "yes," type of consolidation N/A

If answer is "no," list the owners and tract descriptions which have actually been consolidated. (Use reverse side of this form if necessary.)

No allowable will be assigned to the well until all interests have been consolidated (by communitization, unitization, force-pooling, or otherwise) or until a non-standard unit, eliminating such interests, has been approved by the Division.

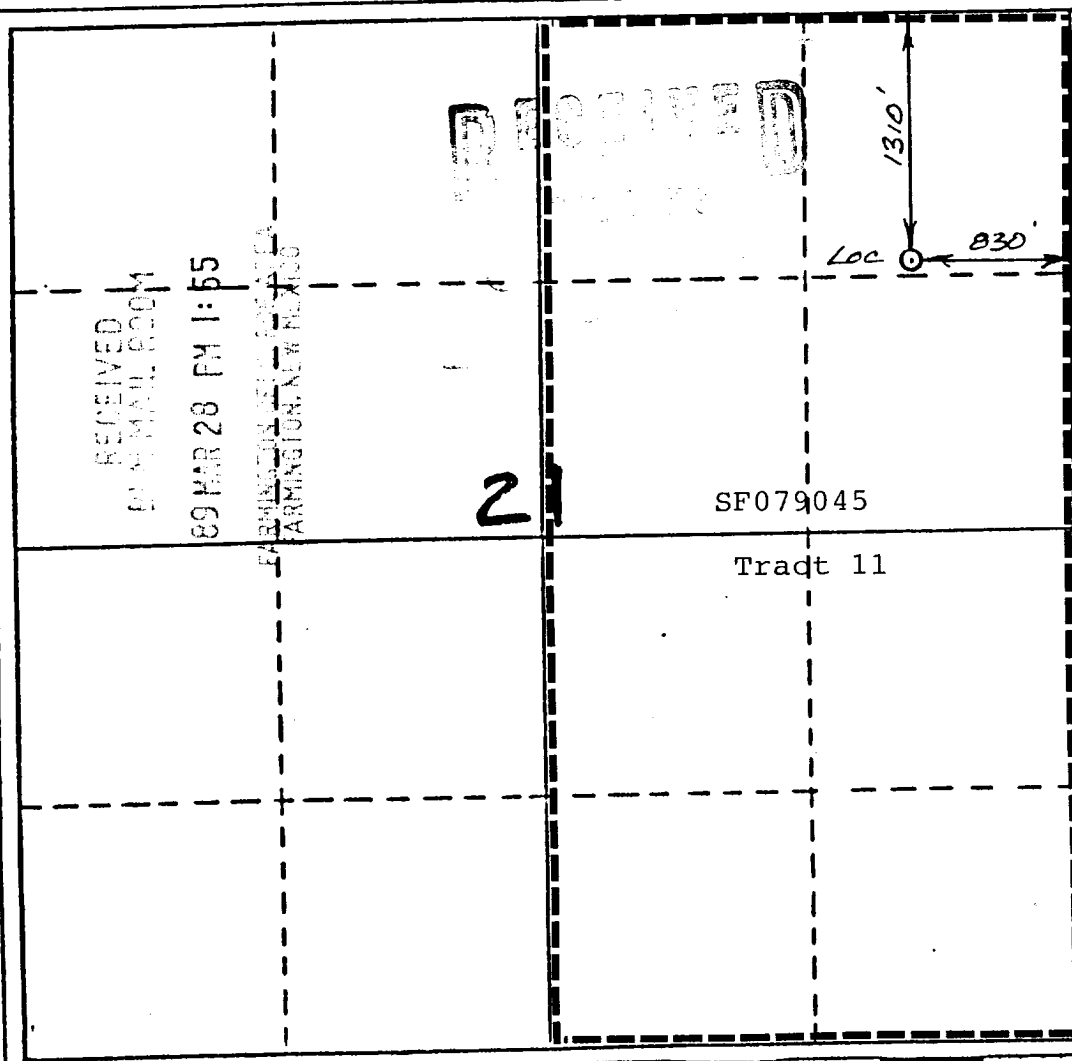

CERTIFICATION

I hereby certify that the information contained herein is true and complete to the best of my knowledge and belief.

Name William F. Clark  
Position Operations Manager  
Company Blackwood & Nichols Co.  
Date 3-27-89

I hereby certify that the well location shown on this plat was plotted from field notes of actual surveys made by me or under my supervision, and that the same is true and correct to the best of my knowledge and belief.

Date Surveyed 11/24/88  
Registered Professional Engineer and/or Land Surveyor

Neale C. Edwards

Certificate No. 6857

