

UNITED STATES
DEPARTMENT OF THE INTERIOR
GEOLOGICAL SURVEY

SUNDRY NOTICES AND REPORTS ON WELLS

(Do not use this form for proposals to drill or to deepen or plug back to a different reservoir. Use Form 9-331-C for such proposals.)

1. oil well ☐ gas well ☒ other

2. NAME OF OPERATOR
Blackwood and Nichols Co., LTD

3. ADDRESS OF OPERATOR
P.O. Box 1237, Durango, CO 81302-1237

4. LOCATION OF WELL (REPORT LOCATION CLEARLY. See space 17 below.)
AT SURFACE: 1095' FSL - 1700' FWL
AT TOP PROD. INTERVAL:
AT TOTAL DEPTH:

16. CHECK APPROPRIATE BOX TO INDICATE NATURE OF NOTICE, REPORT, OR OTHER DATA

REQUEST FOR APPROVAL TO:

TEST WATER SHUT-OFF ☐
FRACTURE TREAT ☐
SHOOT OR ACIDIZE ☐
REPAIR WELL ☐
PULL OR ALTER CASING ☐
MULTIPLE COMPLETE ☐
CHANGE ZONES ☐
ABANDON* ☐

SUBSEQUENT REPORT OF:

(other) Change footage location

5. LEASE
SF079045
6. IF INDIAN, ALLOTTEE OR TRIBE NAME

7. UNIT AGREEMENT NAME
Northeast Blanco

8. FARM OR LEASE NAME
Northeast Blanco Unit

9. WELL NO.
422

10. FIELD OR WILDCAT NAME
Basin Fruitland Coal

11. SEC., T., R., M., OR BLK. AND SURVEY OR AREA
Sec. 20, T31N, R7W, NMPM

12. COUNTY OR PARISH
San Juan

13. STATE
NM

14. API NO.

15. ELEVATIONS (SHOW DF, KDB, AND WD)
6419' GL

(NOTE: Report results of multiple completion or zone change on Form 9-330.)

17. DESCRIBE PROPOSED OR COMPLETED OPERATIONS (Clearly state all pertinent details, and give pertinent dates, including estimated date of starting any proposed work. If well is directionally drilled, give subsurface locations and measured and true vertical depths for all markers and zones pertinent to this work.)

Move footage location to 1048' FSL - 1770' FWL. New C102 and cut and fill diagram attached.

RECEIVED

OCT 10 1989

OIL CON. DIV
DIST. 3

APPROVED

OCT 31 1989
FREDERICK
FEDERAL MANAGER

Subsurface Safety Valve: Manu. and Type

Set @ _____ Ft.

18. I hereby certify that the foregoing is true and correct

SIGNED William F. Clark TITLE Operations Manager

DATE Sept 28, 1989

(This space for Federal or State office use)

APPROVED BY
CONDITIONS OF APPROVAL, IF ANY

TITLE

DATE

NMOOD

Submit to Appropriate
District Office
State Lease - 4 copies
Fee Lease - 3 copies

State of New Mexico
Energy, Minerals and Natural Resources Department

Form C-102
Revised 1-1-89

OIL CONSERVATION DIVISION

DISTRICT I
P.O. Box 1980, Hobbs, NM 88240

P.O. Box 2088
Santa Fe, New Mexico 87504-2088

DISTRICT II
P.O. Drawer DD, Artesia, NM 88210

DISTRICT III
1000 Rio Brazos Rd., Aztec, NM 87410

WELL LOCATION AND ACREAGE DEDICATION PLAT

All Distances must be from the outer boundaries of the section

Operator Blackwood & Nichols Co., LTD			Lease Northeast Blanco Unit		Well No. 422
Unit Letter N	Section 20	Township 31 North	Range 7 West	County San Juan	
Actual Footage Location of Well: 1048 feet from the South line and 1770 feet from the West line					
Ground level Elev. 6419'	Producing Formation Fruitland Coal		Pool Basin Fruitland Coal		Dedicated Acreage: 320 Acres

1. Outline the acreage dedicated to the subject well by colored pencil or hatchure marks on the plat below.
2. If more than one lease is dedicated to the well, outline each and identify the ownership thereof (both as to working interest and royalty).
3. If more than one lease of different ownership is dedicated to the well, have the interest of all owners been consolidated by communitization, unitization, force-pooling, etc.?
☒ Yes ☐ No If answer is "yes" type of consolidation Unitization
If answer is "no" list the owners and tract descriptions which have actually been consolidated. (Use reverse side of this form if necessary).
No allowable will be assigned to the well until all interests have been consolidated (by communitization, unitization, forced-pooling, or otherwise) or until a non-standard unit, eliminating such interest, has been approved by the Division.

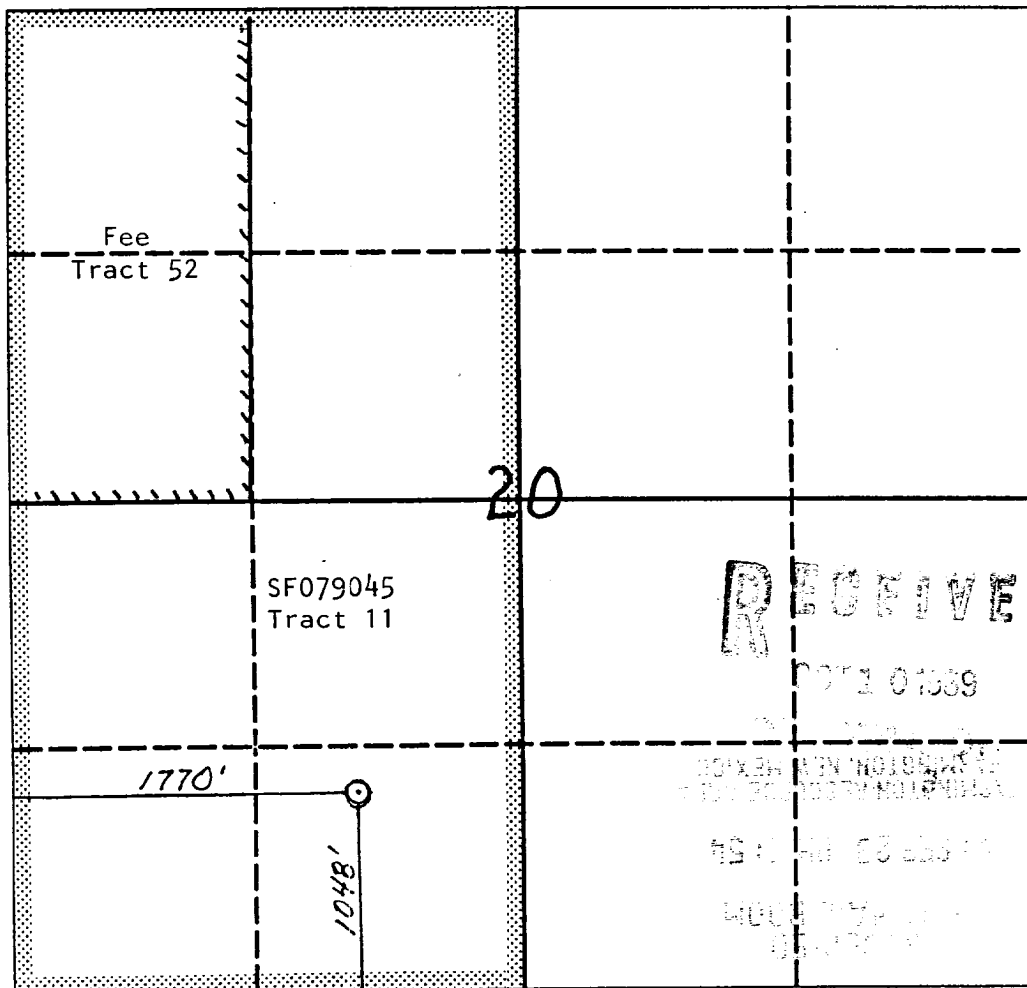

OPERATOR CERTIFICATION

I hereby certify that the information contained herein is true and complete to the best of my knowledge and belief.

Signature
William F. Clark
Printed Name
William F. Clark
Position
Operations Manager
Company
Blackwood & Nichols
Date
Sept 28, 1989

SURVEYOR CERTIFICATION

I hereby certify that the well location shown on this plat was plotted from field notes of actual surveys made by me or under my supervision, and that the same is true and correct to the best of my knowledge and belief.

Date Surveyed
Signature & Seal of Professional Surveyor

Moved in field with chain and compass.

Certificate No.

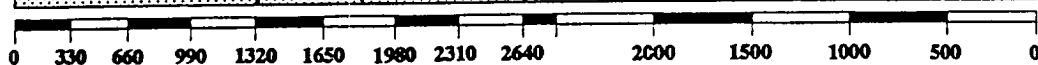

Blackwood & Nichols
Co., LTD

Northeast Blanco Unit
#422
1048' FSL - 1770' FWL
Section 20, T31N, R7W
NMPM
San Juan County, NM

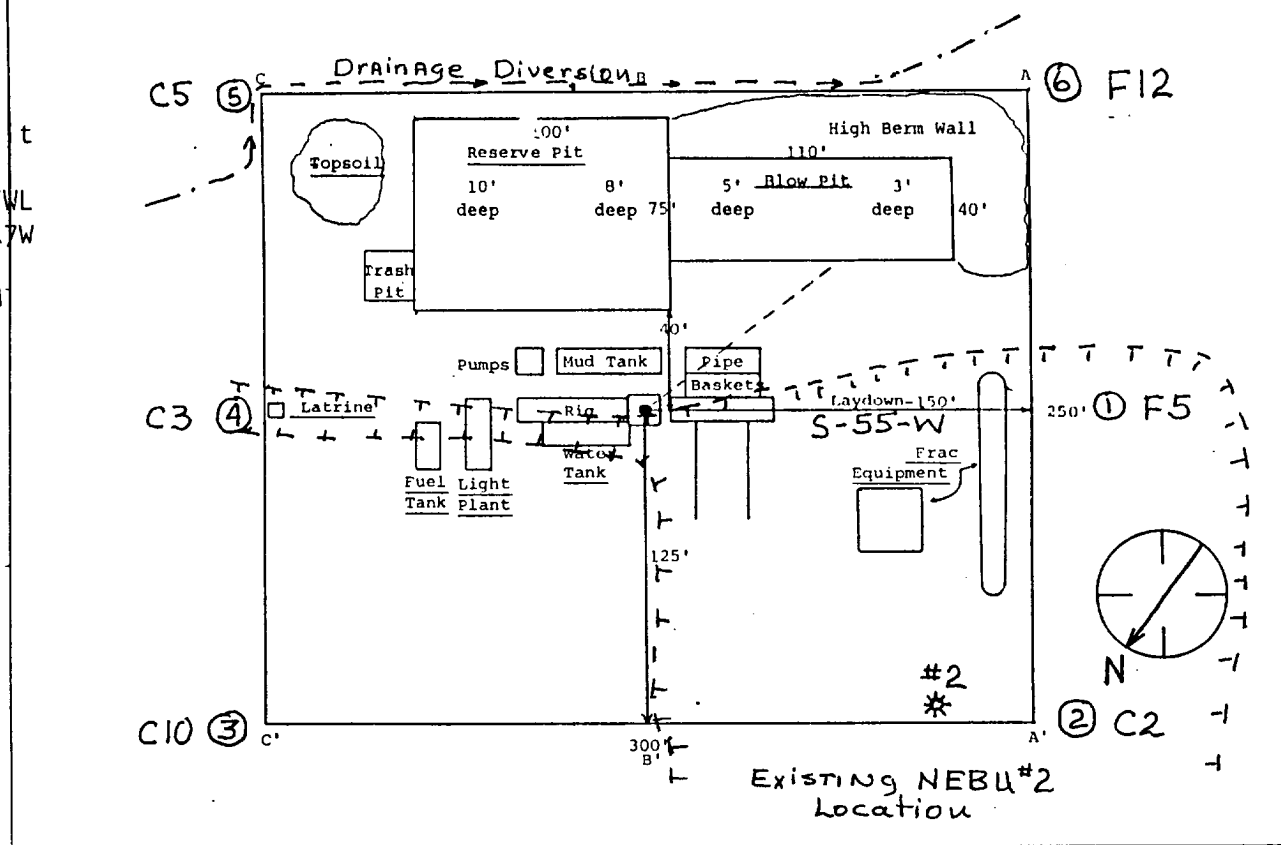

A - A'

Vert.: 1" = 30'

Horiz.: 1" = 50'

C/L

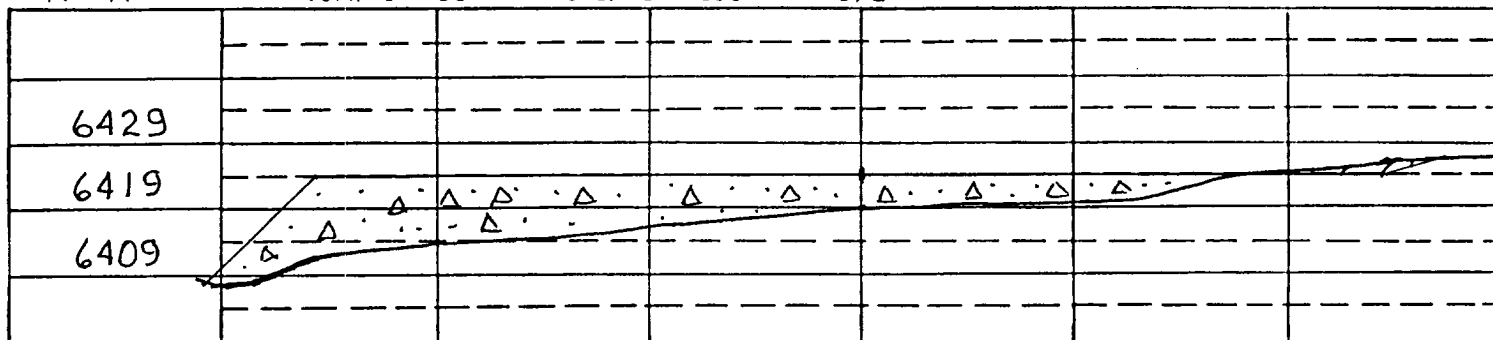

B - B'

C/L

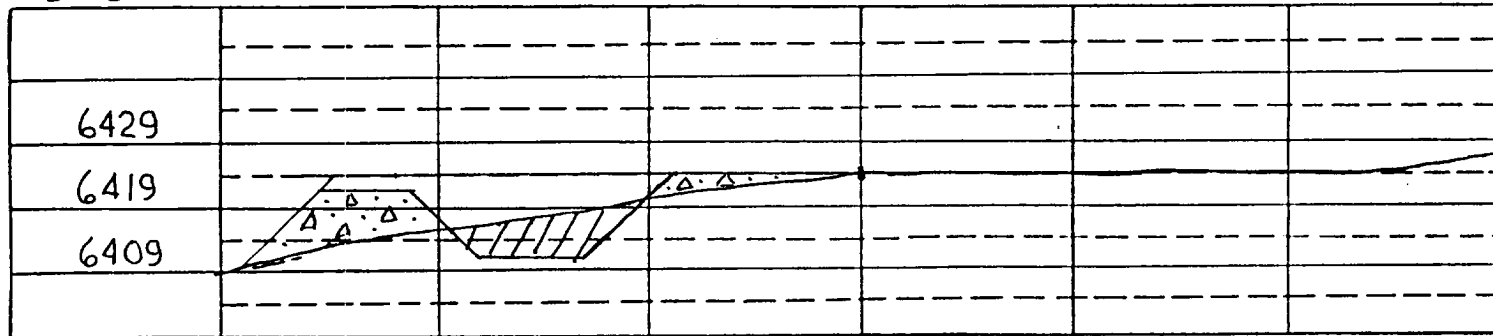

C - C'

C/L

