

UNITED STATES
DEPARTMENT OF THE INTERIOR
BUREAU OF LAND MANAGEMENT

SUBMIT IN TRIPLICATE*
(Other Instructions on
reverse side)

Form approved.
Budget Bureau No. 1004-0136
Expires August 31, 1985

APPLICATION FOR PERMIT TO DRILL, DEEPEN, OR PLUG BACK

1. TYPE OF WORK
DRILL ☒ DEEPEN ☐ PLUG BACK ☐ 60 MAY 15 PM 1:00

2. TYPE OF WELL
OIL WELL ☐ GAS WELL ☒ Coal Seam ☐ OTHER ☐

3. NAME OF OPERATOR
Amoco Production Company

4. ADDRESS OF OPERATOR
2325 East 30th Street, Farmington NM 87401

5. LOCATION OF WELL (Report location clearly and in accordance with any State requirements.)
At surface 1830' FSL x 1810' FWL
At proposed prod. zone Same

6. DISTANCE IN MILES AND DIRECTION FROM NEAREST TOWN OR POST OFFICE*
20 miles northeast east of Bloomfield NM

7. DISTANCE FROM PROPOSED* LOCATION TO NEAREST PROPERTY OR LEASE LINE, FT.
(Also to deepest drig. unit line, if any) 1810'

8. DISTANCE FROM PROPOSED LOCATION* TO NEAREST WELL, DRILLING, COMPLETED, OR APPLIED FOR, ON THIS LEASE, FT.
3225'

9. NO. OF ACRES IN LEASE
2,549.29

10. NO. OF ACRES ASSIGNED TO THIS WELL
320 W/2

11. ROTARY OR CABLE TOOLS
Rotary

12. APPROX. DATE WORK WILL START*
As soon as permitted

13. ELEVATIONS (Show whether DF, RT, GR, etc.)
6275' GR

14. DRILLING OPERATIONS AUTHORIZED ARE SUBJECT TO COMPLIANCE WITH ATTACHED PRODUCTION SAFETY PROGRAM

15. THIS ACTION IS SUBJECT TO TECHNICAL AND PROCEDURAL REVIEW PURSUANT TO 43 CFR 3165.3 AND APPEAL PURSUANT TO 43 CFR 3165.4.

SIZE OF HOLE	SIZE OF CASING	WEIGHT PER FOOT	SETTING DEPTH
12-1/4"	9-5/8"	36# K55	250'
8-3/4"	7"	20# K55	2752'
6-1/4"	5-1/2"	23# P110	2964'

16. 200 cf Class B
773 cf Class B
uncommented

Notice of Staking was submitted 4-21-89.

Lease description:

T30N-R8W, NMPM

Sec. 26: E/2, SW/4, E/2 NW/4, SW/4 NW/4

Sec. 27: SE/4 NE/4, W/2 NE/4, NW/4, S/2

Sec. 28: All

Sec. 29: Lots 1,8

Sec. 33: All

RECEIVED
JUL 31 1989
OIL COAL DIV.
DIST. 9

IN ABOVE SPACE DESCRIBE PROPOSED PROGRAM: If proposal is to deepen or plug back, give data on present productive zone and proposed new productive zone. If proposal is to drill or deepen directionally, give pertinent data on subsurface locations and measured and true vertical depths. Give blowout preventer program, if any.

SIGNED J. J. Hampton TITLE Admin. Supv. DATE 5/12/89
(This space for Federal or State office use)

PERMIT NO. _____ APPROVAL DATE _____

APPROVED BY _____ TITLE _____ DATE _____
CONDITIONS OF APPROVAL, IF ANY:

NMOCD

*See Instructions On Reverse Side

APPROVED
AS AMENDED

JUL 27 1989
AREA MANAGER

Submit to Appropriate
District Office
State Lease - 4 copies
Fee Lease - 3 copies

State of New Mexico
Energy, Minerals and Natural Resources Department

Form C-102
Revised 1-1-89

OIL CONSERVATION DIVISION

P.O. Box 2088
Santa Fe, New Mexico 87504-2088

DISTRICT I
P.O. Box 1980, Hobbs, NM 88240

DISTRICT II
P.O. Drawer DD, Artesia, NM 88210

DISTRICT III
1000 Rio Brazos Rd., Aztec, NM 87410

WELL LOCATION AND ACREAGE DEDICATION PLAT

All Distances must be from the outer boundaries of the section

Operator AMOCO PRODUCTION COMPANY			Lease GARTNER /A/		Well No. # 14
Unit Letter K	Section 28	Township 30 NORTH	Range 8 WEST	County SAN JUAN	
Actual Footage Location of Well: 1830 feet from the SOUTH line and 1810 feet from the WEST line					
Ground level Elev. 6275	Producing Formation Fruitland		Pool Basin Fruitland Coal Gas		Dedicated Acreage: W/2 320 Acres

1. Outline the acreage dedicated to the subject well by colored pencil or hatchure marks on the plat below.
2. If more than one lease is dedicated to the well, outline each and identify the ownership thereof (both as to working interest and royalty).
3. If more than one lease of different ownership is dedicated to the well, have the interest of all owners been consolidated by communitization, unitization, force-pooling, etc?
☐ Yes ☐ No If answer is "yes" type of consolidation _____
If answer is "no" list the owners and tract descriptions which have actually been consolidated. (Use reverse side of this form if necessary.)
No allowable will be assigned to the well until all interests have been consolidated (by communitization, unitization, forced-pooling, or otherwise) or until a non-standard unit, eliminating such interest, has been approved by the Division.

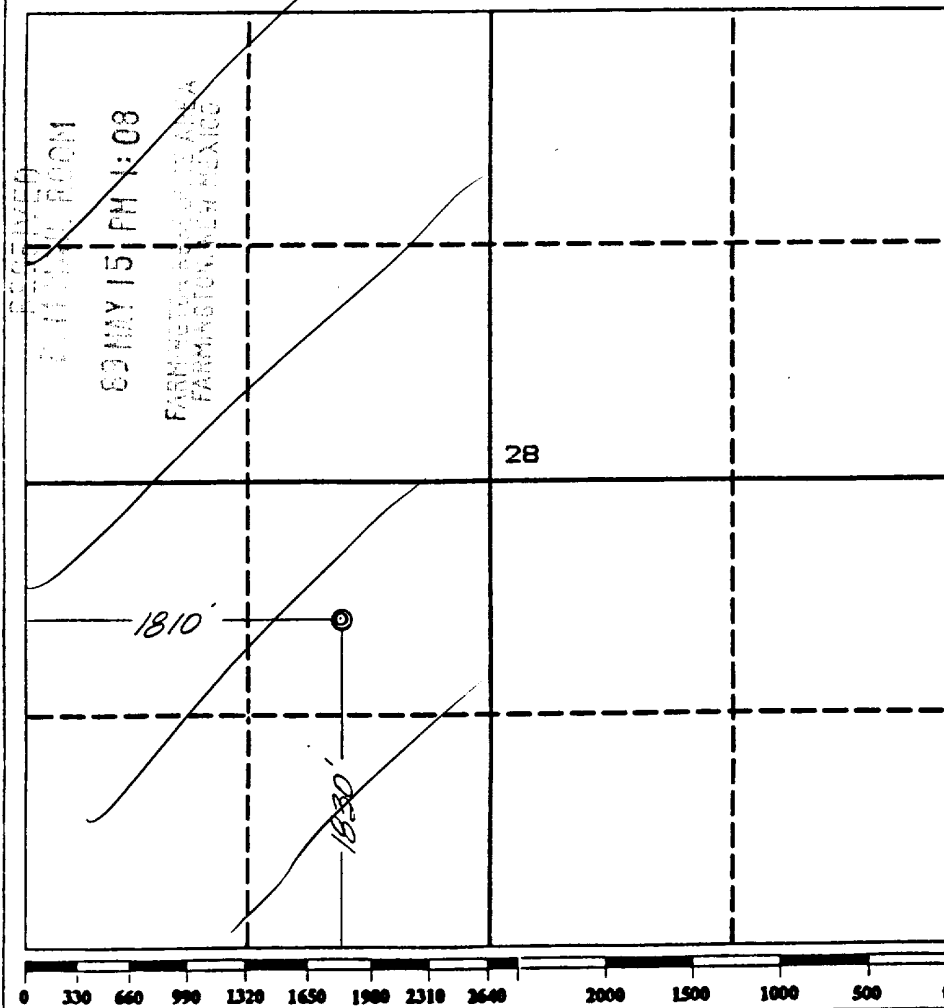

OPERATOR CERTIFICATION

I hereby certify that the information contained herein is true and complete to the best of my knowledge and belief.

Signature
C. B. Douglas
Printed Name
C. B. Douglas
Position
Admin. Supv.
Company
Amoco Production
Date
4-21-89

SURVEYOR CERTIFICATION

I hereby certify that the well location shown on this plat was plotted from field notes of actual surveys made by me or under my supervision, and that the same is true and correct to the best of my knowledge and belief.

Date Surveyed
April 19, 1989

Signature & Seal of Professional Surveyor
Gary D. Vann
GARY D. VANN
7016
7016
NEW MEXICO
REGISTERED PROFESSIONAL LAND SURVEYOR

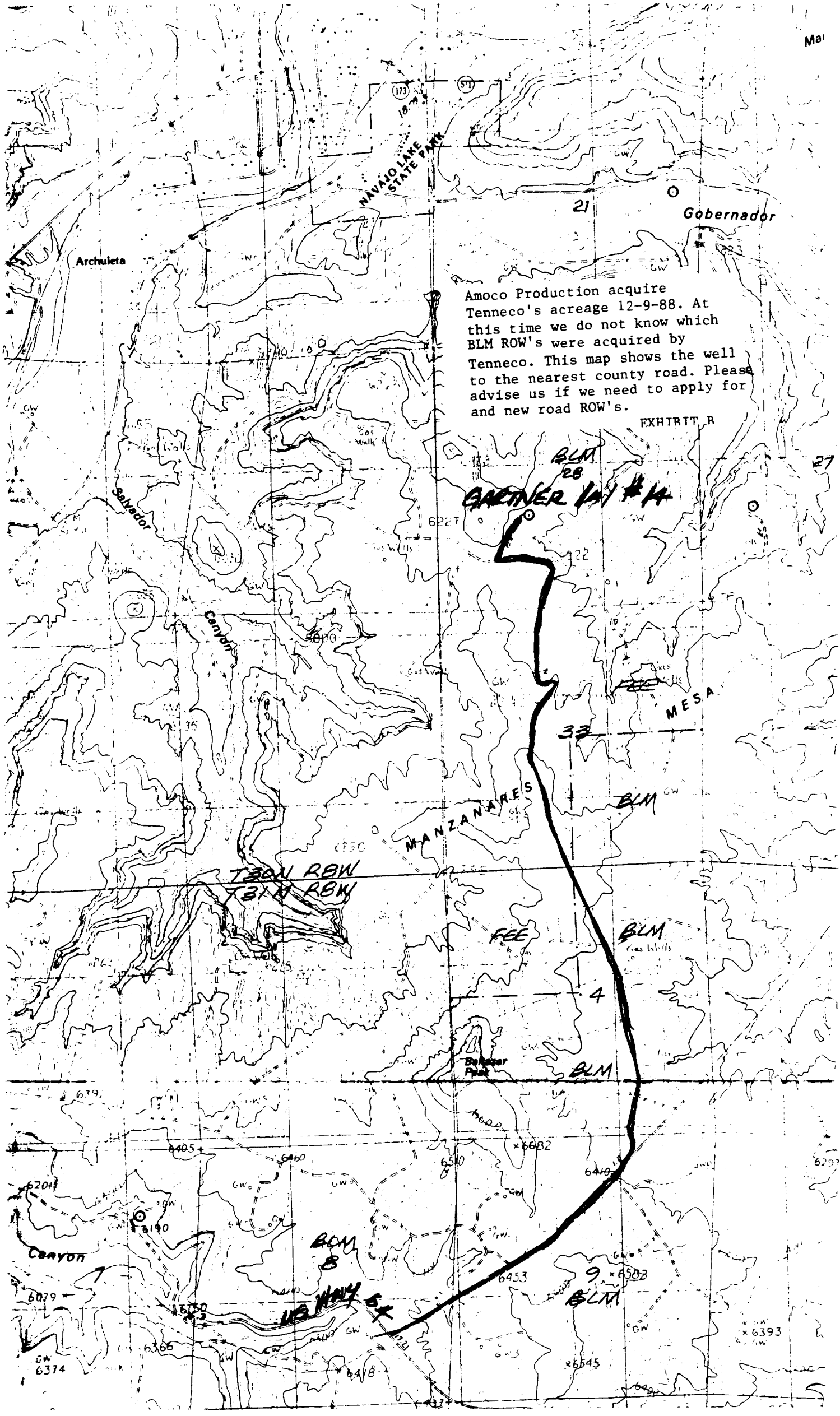

Amoco Production acquire Tenneco's acreage 12-9-88. At this time we do not know which BLM ROW's were acquired by Tenneco. This map shows the well to the nearest county road. Please advise us if we need to apply for and new road ROW's.

EXHIBIT R

BLM 28
GARTNER 1A #14

TEQUILA ROW
BLM ROW

BLM 3

BLM 9
BLM 27

BLM 4

BLM 33

BLM 28