

Submit to Appropriate
District Office
State Lease - 6 copies
Fee Lease - 5 copies

State of New Mexico
Energy, Minerals and Natural Resources Department

Form C-101
Revised 1-1-89

OIL CONSERVATION DIVISION

DISTRICT I
P.O. Box 1980, Hobbs, NM 88240

DISTRICT II
P.O. Drawer DD, Artesia, NM 88210

DISTRICT III
1000 Rio Brazos Rd., Aztec, NM 87410

P.O. Box 2088
Santa Fe, New Mexico 87504-2088

API NO. (assigned by OCD on New Wells)

30-045-27549

5. Indicate Type of Lease

STATE ☒

FEE ☐

6. State Oil & Gas Lease No.

E-3150-1

APPLICATION FOR PERMIT TO DRILL, DEEPEN, OR PLUG BACK

1a. Type of Work:

DRILL ☒

RE-ENTER ☐

DEEPEN ☐

PLUG BACK ☐

b. Type of Well:

OIL
WELL ☐

GAS
WELL ☒

OTHER ☐

SINGLE
ZONE ☒

MULTIPLE
ZONE ☐

7. Lease Name or Unit Agreement Name

Northeast Blanco Unit

8. Well No.

484

9. Pool name or Wildcat

Basin Fruitland Coal

2. Name of Operator

Blackwood & Nichols Co., LTD.

3. Address of Operator

P.O. Box 1237, Durango, Colorado, 81302-1237

4. Well Location

Unit Letter A : 990 Feet From The North Line and 790 Feet From The East Line

Section 16 Township 31N Range 7W NMPM San Juan County

10. Proposed Depth

3432'

11. Formation

Fruitland Coal

12. Rotary or C.T.

Rotary

13. Elevations (Show whether DF, RT, GR, etc.)

6526' GL

14. Kind & Status Plug. Bond

Statewide

15. Drilling Contractor

NA

16. Approx. Date Work will start

January 5, 1990

17. PROPOSED CASING AND CEMENT PROGRAM

SIZE OF HOLE	SIZE OF CASING	WEIGHT PER FOOT	SETTING DEPTH	SACKS OF CEMENT	EST. TOP
12 1/4"	9 5/8"	36#	300'	250(295 cuft)	circ.
8 3/4"	7"	23#	3112'	555(863 cuft)	circ.
6 1/4"	5 1/2"	17#	3012' - 3432'	30(35 cuft)	circ.

Propose to spud in the San Jose formation. Will drill a 12 1/4" hole to a TD of 300'. Run and cement surface casing, with cement returns to surface. WOC 12 hours. Test to 600 psi/ 30 mins. Drill an 8 3/4" hole to a TD of 3112' using fresh water mud. No abnormal pressures or poisonous gas is anticipated. Run and cement intermediate casing with cement returns to surface. WOC 12 hours. Test to 1500 psi/ 30 mins. Drill the Fruitland Coals with a 6 1/4" bit, using air and water. The 5 1/2" liner may not be cemented if the coals exhibit a natural flow capacity.

APPROVAL EXPIRES 6-8-90
UNLESS DRILLING IS COMMENCED.
SPUD NOTICE MUST BE SUBMITTED
WITHIN 10 DAYS.

RECEIVED

DEC 08 1989

OIL CON. DIV

IN ABOVE SPACE DESCRIBE PROPOSED PROGRAM: IF PROPOSAL IS TO DEEPEN OR PLUG BACK, GIVE DATA ON PRESENT PRODUCTIVE ZONE, PROPOSED NEW PRODUCTIVE ZONE, GIVE BLOWOUT PREVENTER PROGRAM, IF ANY.

I hereby certify that the information above is true and complete to the best of my knowledge and belief.

SIGNATURE William F. Elia TITLE Operations Manager DATE December 7, 1989

TYPE OR PRINT NAME

TELEPHONE NO.

(This space for State Use)

APPROVED BY Emilia Busch TITLE DEPUTY OIL & GAS INSPECTOR, DIST. #3 DATE DEC 08 1989

CONDITIONS OF APPROVAL, IF ANY:

**NEW MEXICO OIL CONSERVATION COMMISSION
WELL LOCATION AND ACREAGE DEDICATION PLAT**

Form C-102
Supersedes C-128
Effective 1-1-65

All distances must be from the outer boundaries of the Section.

Operator BLACKWOOD & NICHOLS CO., LTD.			Lease NORTHEAST BLANCO UNIT		Well No. 484
Unit Letter A	Section 16	Township 31 North	Range 7 West	County San Juan County	
Actual Footage Location of Well: <div style="display: flex; justify-content: space-between; align-items: center;"> 990 feet from the north line and 790 feet from the east line </div>					
Ground Level Elev: 6526 (U.G.)	Producing Formation Fruitland Coal	Pool Basin Fruitland Coal	Dedicated Acreage: 320 Acres		

1. Outline the acreage dedicated to the subject well by colored pencil or hachure marks on the plat below.
2. If more than one lease is dedicated to the well, outline each and identify the ownership thereof (both as to working interest and royalty).
3. If more than one lease of different ownership is dedicated to the well, have the interests of all owners been consolidated by communitization, unitization, force-pooling, etc?

☒ Yes ☐ No If answer is "yes," type of consolidation Unitization

If answer is "no," list the owners and tract descriptions which have actually been consolidated. (Use reverse side of this form if necessary.) _____

No allowable will be assigned to the well until all interests have been consolidated (by communitization, unitization, forced-pooling, or otherwise) or until a non-standard unit, eliminating such interests, has been approved by the Commission.

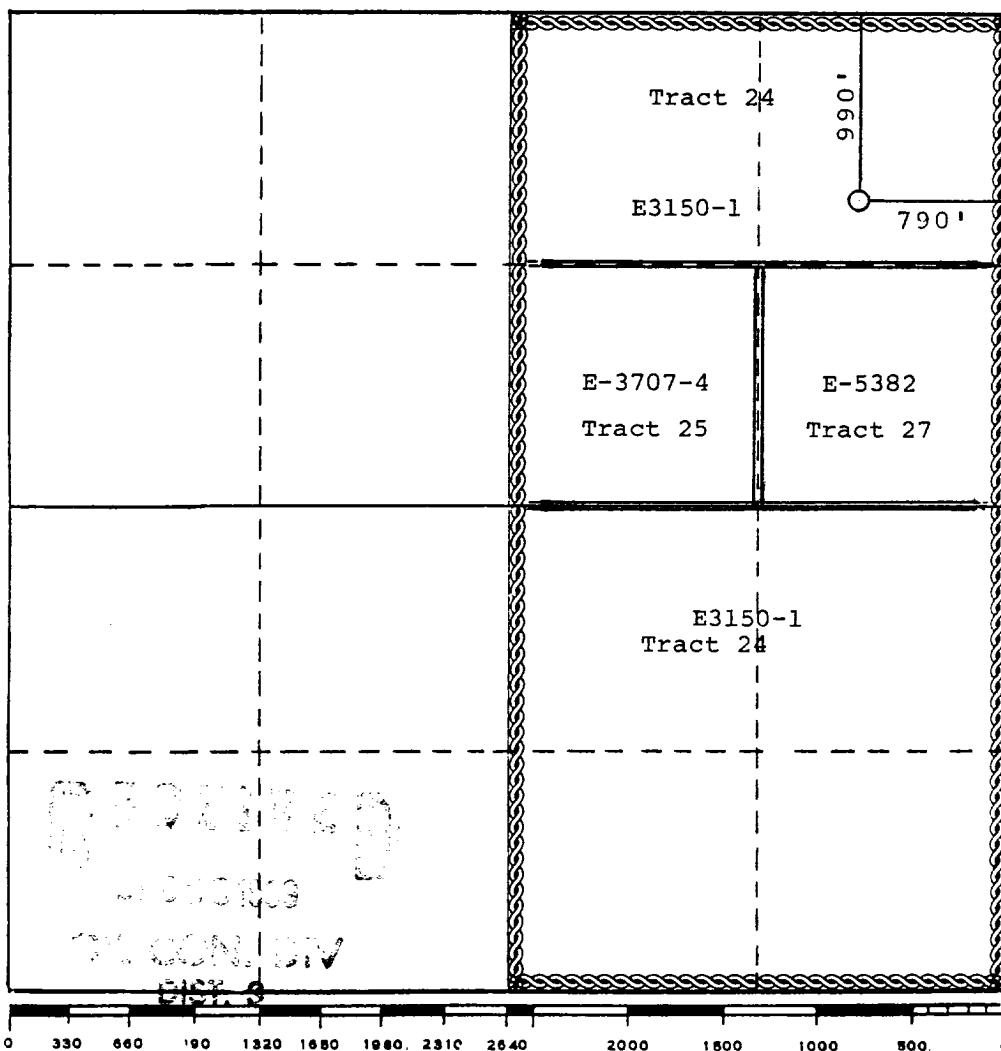

CERTIFICATION

I hereby certify that the information contained herein is true and complete to the best of my knowledge and belief.

William F. Clark

Name
William F. Clark

Position
Operations Manager

Company
Blackwood & Nichols Co.

Date
December 7, 1989

I hereby certify that the well location shown on this plat was plotted from field notes of actual surveys made by me or under my supervision, and that the same is true and correct to the best of my knowledge and belief.

Date Surveyed
November 6, 1989

Registered Professional Engineer and/or Land Surveyor

Allison L. Kroeger
Allison L. Kroeger

Certificate No.

7922

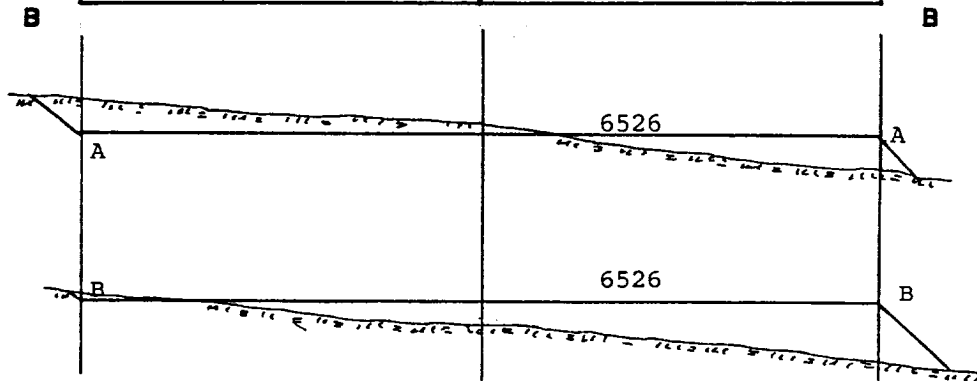
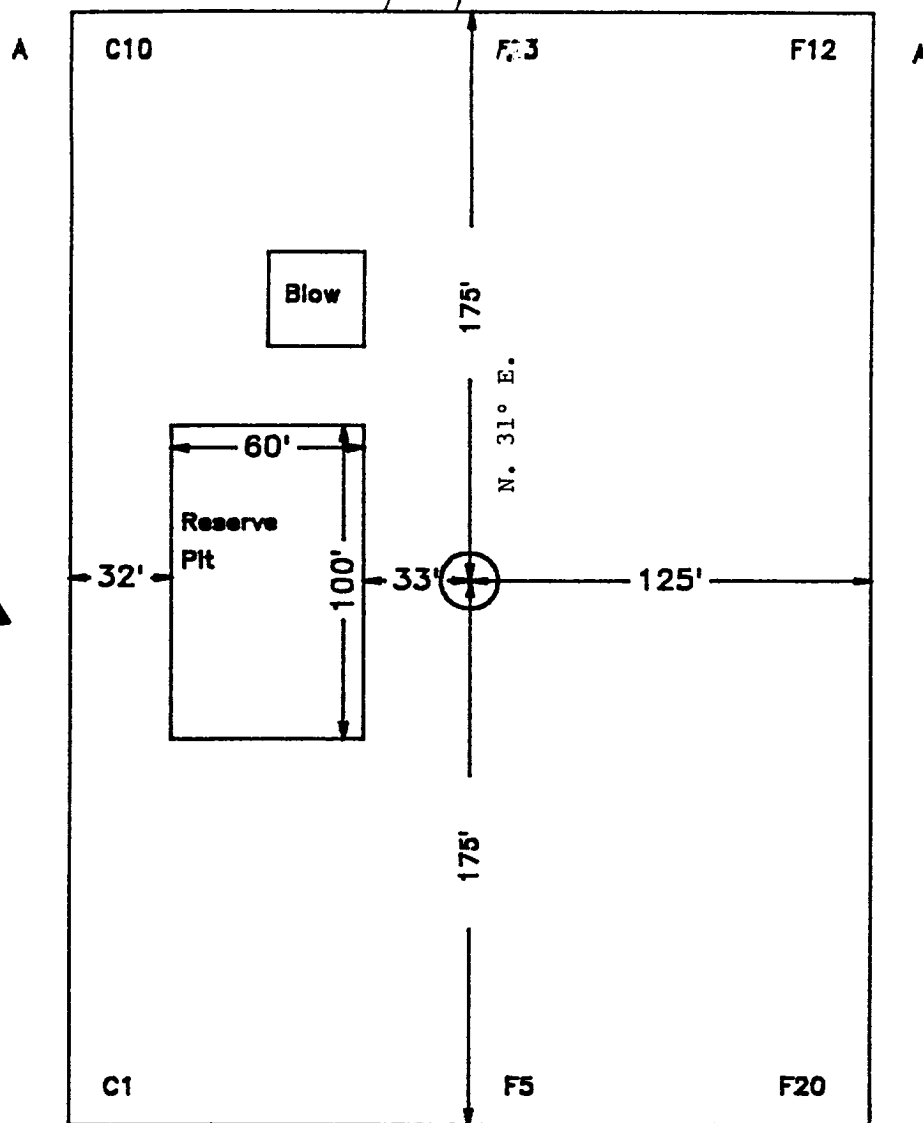
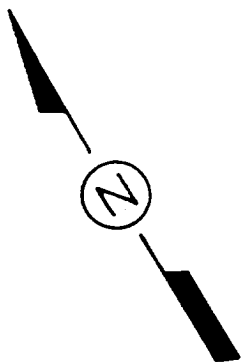

Horizontal & Vertical Scales: 1"=60'

RECEIVED
 DEC 08 1989
 OIL CON. DIV
 DIST ?

BLACKWOOD & NICHOLS CO., LTD.	
Site Plan For Northeast Blanco Unit 484	
Date: November, 1989	Scale: 1" = 60'
Kroeger & Associates Durango, Colorado	

