

State of New Mexico  
Energy, Minerals and Natural Resources Department

Form C-101

OIL CONSERVATION DIVISION  
P.O. Box 2088  
Santa Fe, New Mexico 87504-2088

APPLICATION FOR PERMIT TO DRILL, DEEPEN,  
OR PLUG BACK

**RECEIVED**

FEB 13 1990

**OIL CON. DIV.**  
**DIST. 3**

1a. Type of Work  
DRILL  
b. Type of Well  
GAS SINGLE ZONE

2. Name of Operator  
MERIDIAN OIL INC.

3. Address of Operator  
PO Box 4289, Farmington, NM 87499

4. Well Location  
Unit letter L 1440'S 940'W  
Section 23 T30N R11W NMPM SAN JUAN COUNTY

API NO. (assigned by OCD on new well)

5. Indicate Type of Lease  
FEE

6. State Oil & Gas Lease No.

7. Lease Name or Unit Agreement Name  
HARTMAN COM

8. Well No.  
550

9. Pool Name or Wildcat  
BASIN FRUITLAND COAL

10. Proposed Depth  
2315'

11. Formation  
FRUITLAND COAL

12. Rotary or C.T.  
Rotary

13. Elevation  
5911'GL

14. Bond Type  
statewide

15. Drill. Contractor

16. Est. Start Date  
upon approval

17. PROPOSED CASING AND CEMENT PROGRAM

SIZE HOLE	SIZE CASING	WT. PER FT.	SET. DEPTH	SKS OF CEMENT	EST. TOP
12 1/4"	8 5/8"	24.0#	200 ft.	248 cu.ft.	circ surface
7 7/8"	5 1/2"	15.5#	2315 ft.	810 cu.ft.	circ surface

The Fruitland Coal formation will be completed.  
A minimum 2000 psi working pressure double gate blowout preventer  
equipped with blind and pipe rams will be used for blow out prevention  
on this well. This gas is dedicated.  
The W/2 of Sec 23 is dedicated to this well.

I hereby certify that the information above is true and complete to the best  
of my knowledge and belief.

SIGNATURE [Signature] TITLE Reg. Drilling Engr. DATE 2/9/90

(This space for State Use)

APPROVED BY [Signature] DEPUTY OIL & GAS INSPECTOR, DIST. #3 DATE FEB 14 1990  
Conditions of approval, if any:

APPROVAL EXPIRES 8-14-90  
UNLESS DRILLING IS COMMENCED.  
SPUD NOTICE MUST BE SUBMITTED  
WITHIN 60 DAYS

Hold C-104 FOR CA

Submit to Appropriate  
District Office  
State Lease - 4 copies  
Fee Lease - 3 copies

State of New Mexico  
Energy, Minerals and Natural Resources Department

Form C-102  
Revised 1-1-89

OIL CONSERVATION DIVISION

P.O. Box 2088  
Santa Fe, New Mexico 87504-2088

DISTRICT I

P.O. Box 1980, Hobbs, NM 88240

DISTRICT II

P.O. Drawer DD, Artesia, NM 88210

DISTRICT III

1000 Rio Brazos Rd., Aztec, NM 87410

WELL LOCATION AND ACREAGE DEDICATION PLAT

All Distances must be from the outer boundaries of the section

Operator Meridian Oil Inc.			Lease Hartman Com (Fee)		Well No. 550
Unit Letter L	Section 23	Township 30 North	Range 11 West	County San Juan	
Actual Footage Location of Well: 1440 feet from the South line and 940 feet from the West line					
Ground level Elev. 5911'	Producing Formation Fruitland Coal		Pool Basin	Dedicated Acreage: 319.91 Acres	

1. Outline the acreage dedicated to the subject well by colored pencil or hatchure marks on the plat below.

2. If more than one lease is dedicated to the well, outline each and identify the ownership thereof (both as to working interest and royalty).

3. If more than one lease of different ownership is dedicated to the well, have the interest of all owners been consolidated by communitization, unitization, force-pooling, etc.?

☐ Yes ☐ No

If answer is "yes" type of consolidation communitization agreement will be obtained  
If answer is "no" list the owners and tract descriptions which have actually been consolidated. (Use reverse side of this form if necessary.)

No allowance will be assigned to the well until all interests have been consolidated (by communitization, unitization, forced-pooling, or otherwise) or until a non-standard unit, eliminating such interest, has been approved by the Division.

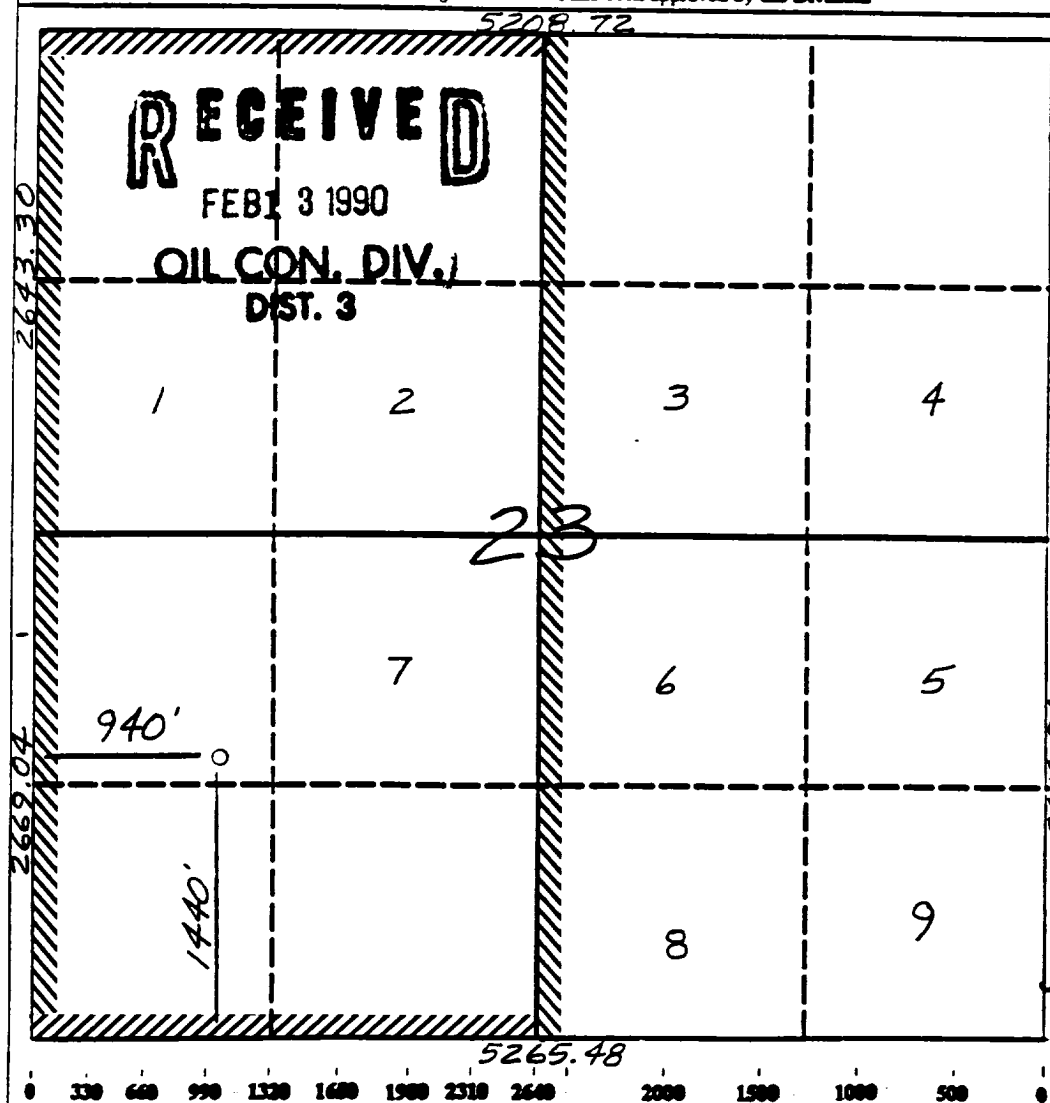

OPERATOR CERTIFICATION

I hereby certify that the information contained herein is true and complete to the best of my knowledge and belief.

Signature Peggy Bradfield

Printed Name  
Peggy Bradfield

Position  
Regulatory Affairs

Company  
Meridian Oil Inc.

Date  
2-9-90

Date

SURVEYOR CERTIFICATION

I hereby certify that the well location shown on this plat was plotted from field notes of actual surveys made by me or under my supervision, and that the same is true and correct to the best of my knowledge and belief.

Date Surveyed 1-22-90  
Name C. Edwards  
Signature of Section Professional Surveyor [Signature]

REGISTERED LAND SURVEYOR  
Certificate No. 6857