

RECEIVED
OCT 31 1990

UNITED STATES
DEPARTMENT OF THE INTERIOR
BUREAU OF LAND MANAGEMENT

OIL CON. DIV.
DIST. 3
SUNDRY NOTICES AND REPORTS ON WELLS

1. TYPE OF WELL GAS		5. LEASE NUMBER SF-078510	
2. OPERATOR MERIDIAN OIL INC.		6. IF INDIAN, ALL. OR TRIBE NAME	
3. ADDRESS & PHONE NO. OF OPERATOR P O BOX 4289 FARMINGTON, NM 87499		7. UNIT AGREEMENT NAME	
4. LOCATION OF WELL 1575'FSL 1870'FWL		8. FARM OR LEASE NAME OXNARD	
14. PERMIT NO.		9. WELL NO. 334	
15. ELEVATIONS 6527'GL		10. FIELD, POOL, OR WILDCAT BASIN FRUITLAND COAL	
		11. SEC. T. R. M OR BLK. K SEC. 8 T31N R08W NMPM	
		12. COUNTY SAN JUAN	13. STATE NM

16. SUBSEQUENT REPORT OF: Amended Application for Permit to Drill
 17. Describe proposed or completed operations *Open & Name Change*

Reference is made to Union Texas Petroleum's Application for Permit to Drill the Oxnard 8 #1 approved 02-27-90.

Meridian Oil Inc. will operate and drill this well as the Oxnard #334 at 1575'FSL and 1870'FWL of Section 8 of Township T31N and Range R08W.

Submitted for review:

- C102
- Operations Plan
- BOP Diagrams
- Location Laydown
- Cut and Fill Diagram
- Facilities Diagram

RECEIVED
OCT 31 1990
OIL CON. DIV.
DIST. 3

18. AUTHORIZED BY: *[Signature]*
REGULATORY AFFAIRS

7-10-90
DATE

NOTE: THIS FORMAT IS ISSUED IN LIEU OF US BLM FORM 3160-5. AS AP

(This space for Federal or State office use)

APPROVED BY _____ TITLE _____ DATE *[Signature]*

OK
[Handwritten marks]

NMOCD

Submit to Appropriate
District Office
State Lease - 4 copies
Fee Lease - 3 copies

State of New Mexico
Energy, Minerals and Natural Resources Department

Form C-102
Revised 1-1-89

OIL CONSERVATION DIVISION

P.O. Box 2088

Santa Fe, New Mexico 87504-2088

DISTRICT I
P.O. Box 1980, Hobbs, NM 88240

DISTRICT II
P.O. Drawer DD, Artesia, NM 88210

DISTRICT III
1000 Rio Brazos Rd., Aztec, NM 87410

WELL LOCATION AND ACREAGE DEDICATION PLAT

All Distances must be from the outer boundaries of the section

Operator Meridian Oil Inc.			Lease Oxnard (SF-078510)		Well No. 334
Unit Letter K	Section 8	Township 31 North	Range 8 West	County San Juan	
Actual Footage Location of Well:					
1575 feet from the		South	line and	1870	feet from the West line
Ground level Elev. 6527'	Producing Formation Fruitland Coal		Pool Basin	Dedicated Acreage: 320 Acres	

- Outline the acreage dedicated to the subject well by colored pencil or hatchure marks on the plat below.
 - If more than one lease is dedicated to the well, outline each and identify the ownership thereof (both as to working interest and royalty).
 - If more than one lease of different ownership is dedicated to the well, have the interest of all owners been consolidated by communitization, unitization, force-pooling, etc.?
 - Yes No
 - If answer is "yes" type of consolidation _____
- If answer is "no" list the owners and tract descriptions which have actually been consolidated. (Use reverse side of this form if necessary.)
- No allowable will be assigned to the well until all interests have been consolidated (by communitization, unitization, forced-pooling, or otherwise) or until a non-standard unit, eliminating such interest, has been approved by the Division.

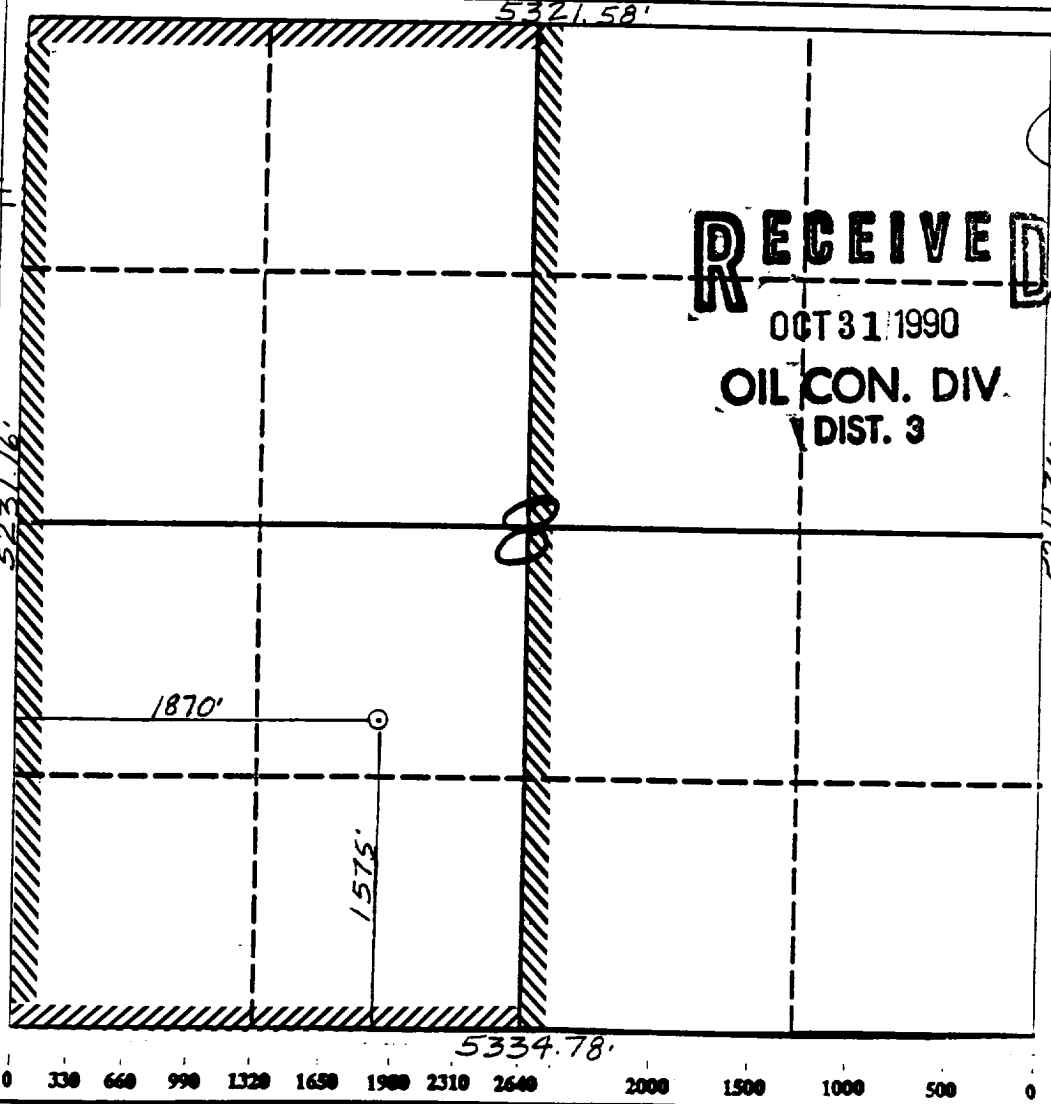

OPERATOR CERTIFICATION

I hereby certify that the information contained herein is true and complete to the best of my knowledge and belief.

Peggy Bradford
Signature

Peggy Bradford
Printed Name

Regulatory Affairs
Position

Meridian Oil Inc.
Company

7-10-90
Date

SURVEYOR CERTIFICATION

I hereby certify that the well location shown on this plat was plotted from field notes of actual surveys made by me or under my supervision, and that the same is true and correct to the best of my knowledge and belief.

7-2-90
Date Surveyed

Neale C. Edwards
Signature & Seal of Professional Surveyor

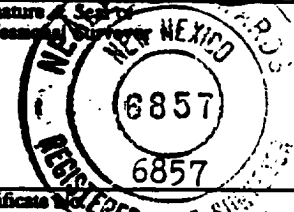

Neale C. Edwards
Certification

Well Name: 334 OXNARD
 Sec. 8 T31N R08W
 BASIN FRUITLAND COAL
 1575' FSL 1870' FWL
 SAN JUAN NEW MEXICO
 Elevation 6527' GL

Formation tops: Surface- SAN JOSE
 Ojo Alamo- 2112
 Kirtland- 2197
 Fruitland- 3084
 Fruitland Coal Top- 3240
 Fruitland Coal Base- 3426
 Pictured Cliffs- 3432
 Intermediate TD- 3220
 Total Depth- 3428

Logging Program: Mud logs from intermediate to total depth.

Mud Program:	Interval	Type	Weight	Visc.	Fl. Loss
	0 - 350	Spud	8.4 - 8.9	40-50	no control
	350 - 3220	Non-dispersed	8.4 - 9.1	30-60	no control
	3220 - 3428	Formation Water	8.4		no control

Casing Program:	Hole Size	Depth Interval	Csg. Size	Weight	Grade
	12 1/4"	0 - 350	9 5/8"	32.3#	H-40
	8 3/4"	0 - 3220	7"	20.0#	K-55
	6 1/4"	3170 - 3428	5 1/2"	15.5#	K-55
Tubing Program:		0 - 3428	2 7/8"	6.5#	J-55

Float Equipment: 9 5/8" surface casing - saw tooth guide shoe. Centralizers will be run in accordance with Onshore Order #2.

7" intermediate casing - guide shoe and self-fill insert float valve. Three centralizers run every other joint above shoe. Run insert float one joint above the guide shoe. Two turbolizing type centralizers - one below and one into the base of the Ojo Alamo @ 2197'. Standard centralizers thereafter every fourth joint up to the base of the surface pipe.

5 1/2" production casing - float shoe on bottom and a pre-drilled liner run to the 7" casing with a minimum 50' overlap. Liner hanger is a double slip grip type.

Wellhead Equipment: 9 5/8" x 7" x 2 7/8" x 11" 3000 psi xmas tree assembly.

Cementing:

9 5/8" surface casing - cement with 279 sacks of class "B" cement with 1/4# flocele/sack and 3% calcium chloride (329 cu ft. of slurry, 200% excess to circulate to surface). WOC 12 hours. Test casing to 600 psi for 30 minutes.

7" intermediate casing - lead with 474 sacks of 65/35 class "B" poz with 6% gel, 2% calcium chloride and 1/2 cu ft. Perlite/sack (10.3 gallons of water/sack) tail with 100 sacks of class "B" with 2% calcium chloride. 1034 cu ft. of slurry, 110% excess to circulate to surface. If hole conditions permit, a 600 ft spacer will be run ahead of the cement slurry to avoid mud contamination of the cement. WOC 12 hours. If cement does not circulate to surface, a temperature log will be run after 8 hours to determine TOC.

5 1/2" liner - do not cement.