

UNITED STATES  
DEPARTMENT OF THE INTERIOR  
BUREAU OF LAND MANAGEMENT

SUNDRY NOTICES AND REPORTS ON WELLS

1. TYPE OF WELL GAS		5. LEASE NUMBER SF-078510	
2. OPERATOR MERIDIAN OIL INC.		6. IF INDIAN, ALL. OR TRIBE NAME	
3. ADDRESS & PHONE NO. OF OPERATOR P O BOX 4289 FARMINGTON, NM 87499		7. UNIT AGREEMENT NAME	
4. LOCATION OF WELL 1815'FNL 895'FEL		8. FARM OR LEASE NAME OXNARD	
		9. WELL NO. 332	
		10. FIELD, POOL, OR WILDCAT BASIN FRUITLAND COAL	
		11. SEC. T. R. M OR BLK. H SEC. 7 T31N R08W NMPM	
14. PERMIT NO.	15. ELEVATIONS 6419'GL	12. COUNTY SAN JUAN	13. STATE NM
16. SUBSEQUENT REPORT OF: Amended Application for Permit to Drill			
17. Describe proposed or completed operations <i>Spec. &amp; Name Change</i>			

Reference is made to **Union Texas Petroleum's** Application for Permit to Drill the **Oxnard 7** approved 03-19-90.

Meridian Oil Inc. will operate and drill this well as the Oxnard #332 at 1815'FNL and 895'FEL of Section 7 of Township T31N and Range R08W.

Submitted for review:

- C102
- Operations Plan
- BOP Diagrams
- Location Laydown
- Cut and Fill Diagram
- Facilities Diagram

18. AUTHORIZED BY: *[Signature]*  
REGULATORY AFFAIRS

RECEIVED  
OCT 31/1990  
OIL CON. DIV.  
105713

*6-25-90*  
DATE

NOTE: THIS FORMAT IS ISSUED IN LIEU OF US BLM FORM 3160-5.

=====

(This space for Federal or State office use)

APPROVED BY  
CONDITION OF APPROVAL, IF ANY:

TITLE

DATE

*[Signature]*  
NMOCD

Submit to Appropriate  
District Office  
State Lease - 4 copies  
Fee Lease - 3 copies

State of New Mexico  
Energy, Minerals and Natural Resources Department

Form C-102  
Revised 1-1-89

OIL CONSERVATION DIVISION

P.O. Box 2088

Santa Fe, New Mexico 87504-2088

DISTRICT I  
P.O. Box 1980, Hobbs, NM 88240

DISTRICT II  
P.O. Drawer DD, Artesia, NM 88210

DISTRICT III  
1000 Rio Brazos Rd., Aztec, NM 87410

WELL LOCATION AND ACREAGE DEDICATION PLAT

All Distances must be from the outer boundaries of the section

Operator Meridian Oil Inc.		Lease Oxnard (SF-073510)		Well No. 332
Unit Letter H	Section 7	Township 31 North	Range 8 West	County San Juan
Actual Footage Location of Well: 1815 feet from the North line and 895 feet from the East line				
Ground level Elev. 6419'	Producing Formation Fruitland Coal		Pool Basin	Dedicated Acreage: 319.73 Acres

1. Outline the acreage dedicated to the subject well by colored pencil or hectare marks on the plat below.
2. If more than one lease is dedicated to the well, outline each and identify the ownership thereof (both as to working interest and royalty).
3. If more than one lease of different ownership is dedicated to the well, have the interest of all owners been consolidated by communitization, unitization, force-pooling, etc.?  
☐ Yes ☐ No If answer is "yes" type of consolidation \_\_\_\_\_

If answer is "no" list the owners and tract descriptions which have actually been consolidated. (Use reverse side of this form if necessary.)

No allowable will be assigned to the well until all interests have been consolidated (by communitization, unitization, force-pooling, or otherwise) or until a non-standard unit, eliminating such interest, has been approved by the Division.

OPERATOR CERTIFICATION

I hereby certify that the information contained herein is true and complete to best of my knowledge and belief.

Signature  
Peggy Bradfield

Printed Name  
Regulatory Affairs

Position  
Meridian Oil Inc.

Company  
6-25-90

Date

SURVEYOR CERTIFICATION

I hereby certify that the well location shown on this plat was plotted from field notes, actual surveys made by me or under supervision, and that the same is true correct to the best of my knowledge and belief. 6-20-90

Date Surveyed

Signature  
Professional Surveyor

NEWMEXICO  
6857  
6857  
REGISTERED LAND SURVEYOR  
Neale C. Edwards

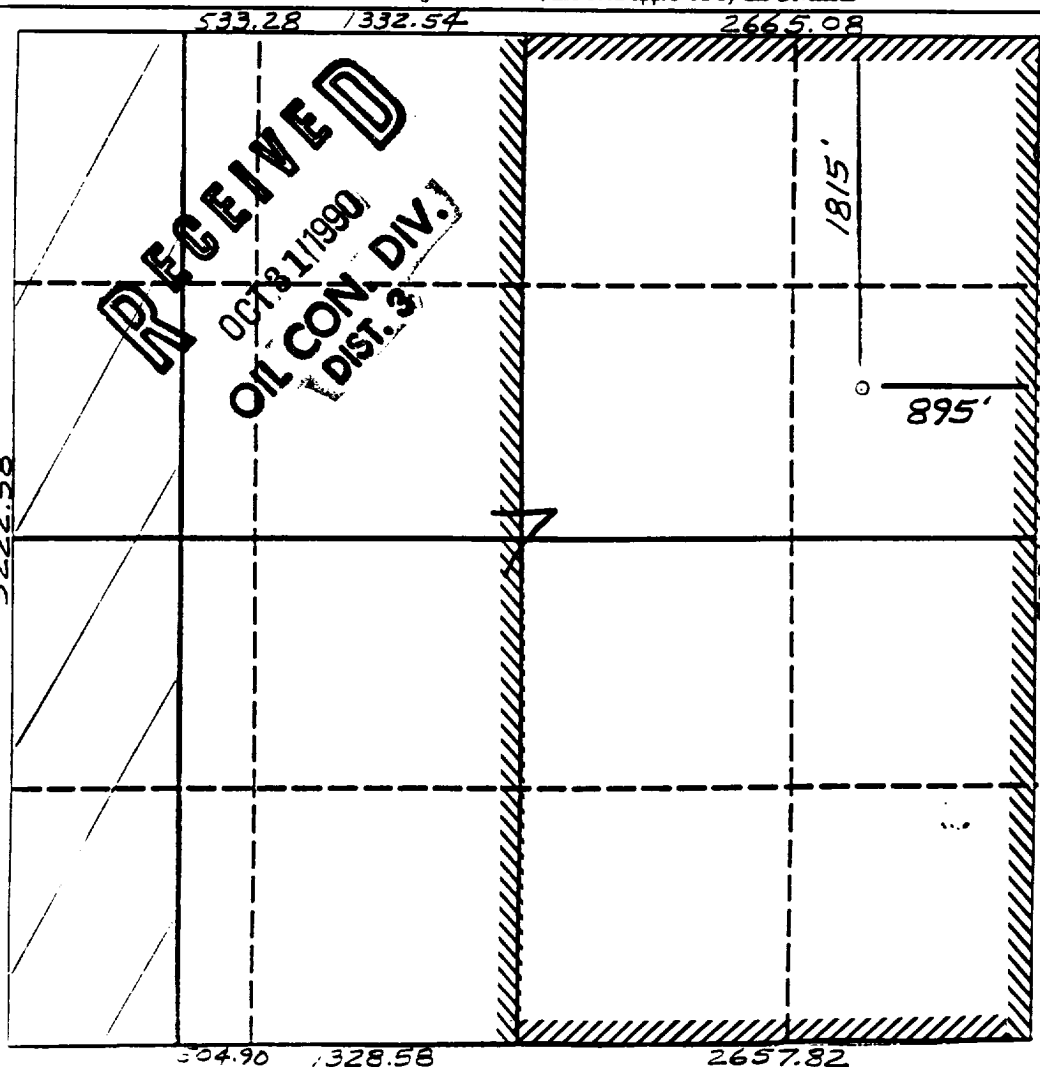

Well Name: 332 OXNARD  
 Sec. 7 T31N R08W  
 BASIN FRUITLAND COAL

1815'FNL 895'FEL  
 SAN JUAN NEW MEXICO  
 Elevation 6419'GL

Formation tops: Surface- SAN JOSE

Ojo Alamo- 1860

Kirtland- 2066

Fruitland- 2886

Fruitland Coal Top- 2941

Fruitland Coal Base- 3306

Pictured Cliffs- 3318

Intermediate TD- 2921

Total Depth- 3310

Logging Program: Mud logs from intermediate to total depth.

Mud Program:	Interval	Type	Weight	Visc.	Fl. Loss
	0 - 350	Spud	8.4 - 8.9	40-50	no control
	350 - 2921	Non-dispersed	8.4 - 9.1	30-60	no control
	2921 - 3310	Formation Water	8.4		no control

Casing Program:	Hole Size	Depth Interval	Csg. Size	Weight	Grade
	12 1/4"	0 - 350	9 5/8"	32.3#	H-40
	8 3/4"	0 - 2921	7"	20.0#	K-55
	6 1/4"	2871 - 3310	5 1/2"	15.5#	K-55
Tubing Program:		0 - 3310	2 7/8"	6.5#	J-55

Float Equipment: 9 5/8" surface casing - saw tooth guide shoe. Centralizers will be run in accordance with Onshore Order #2.

7" intermediate casing - guide shoe and self-fill insert float valve. Three centralizers run every other joint above shoe. Run insert float one joint above the guide shoe. Two turbolizing type centralizers - one below and one into the base of the Ojo Alamo @ 2066'. Standard centralizers thereafter every fourth joint up to the base of the surface pipe.

5 1/2" production casing - float shoe on bottom and a pre-drilled liner run to the 7" casing with a minimum 50' overlap. Liner hanger is a double slip grip type.

Wellhead Equipment: 9 5/8" x 7" x 2 7/8" x 11" 3000 psi xmas tree assembly.

#### Cementing:

9 5/8" surface casing - cement with 279 sacks of class "B" cement with 1/4# flocele/sack and 3% calcium chloride (329 cu ft. of slurry, 200% excess to circulate to surface). WOC 12 hours. Test casing to 600 psi for 30 minutes.

7" intermediate casing - lead with 425 sacks of 65/35 class "B" poz with 6% gel, 2% calcium chloride and 1/2 cu ft. Perlite/sack (10.3 gallons of water/sack) tail with 100 sacks of class "B" with 2% calcium chloride. 940 cu ft. of slurry, 110% excess to circulate to surface. If hole conditions permit, a 600 ft spacer will be run ahead of the cement slurry to avoid mud contamination of the cement. WOC 12 hours. If cement does not circulate to surface, a temperature log will be run after 8 hours to determine TOC.

5 1/2" liner - do not cement.