

Submit to Appropriate District Office  
State Lease - 6 copies  
Fee Lease - 5 copies

State of New Mexico  
Energy, Minerals and Natural Resources Department

Form C-101  
Revised 1-1-89

DISTRICT I  
P.O. Box 1980, Hobbs, NM 88240

DISTRICT II  
P.O. Drawer DD, Artesia, NM 88210

DISTRICT III  
1000 Rio Brazos Rd., Aztec, NM 87410

OIL CONSERVATION INVESTMENT  
P.O. Box 2088  
Santa Fe, New Mexico 87504-2088  
MAR 27 1990

OIL CON. DIV.

API NO. (assigned by OCD on New Wells)

30-045-27705

5. Indicate Type of Lease

STATE  FEE

6. State Oil & Gas Lease No.

Fee

APPLICATION FOR PERMIT TO DRILL, DEEPEN, OR PLUG BACK

1a. Type of Work:

DRILL  RE-ENTER  DEEPEN  PLUG BACK

b. Type of Well:

OIL WELL  GAS WELL  OTHER   
SINGLE ZONE  MULTIPLE ZONE

7. Lease Name or Unit Agreement Name

Northeast Blanco Unit

2. Name of Operator

Blackwood & Nichols Co., Ltd.

8. Well No.

489

3. Address of Operator

P.O. Box 1237 Durango, Colorado 81302 - 1237

9. Pool name or Wildcat

Basin Fruitland Coal

4. Well Location

Unit Letter L : 2330 Feet From The South Line and 1240 Feet From The West Line

Section 12 Township 31 North Range 7 West NMPM San Juan County

10. Proposed Depth

3335'

11. Formation

Fruitland Coal

12. Rotary or C.T.

Rotary

13. Elevations (Show whether DF, RT, GR, etc.)

6525' GL

14. Kind & Status Plug. Bond

Statewide

15. Drilling Contractor

NA

16. Approx. Date Work will start

May 1, 1990

17. PROPOSED CASING AND CEMENT PROGRAM

W/320

SIZE OF HOLE	SIZE OF CASING	WEIGHT PER FOOT	SETTING DEPTH	SACKS OF CEMENT	EST. TOP
12 1/4"	9 5/8"	36#	300'	250(295 cuft)	circ.
8 3/4"	7"	23#	3071'	555(863 cuft)	circ.
6 1/4"	5 1/2"	17#	3071' - 3335'	30( 39 cuft)	circ.

Propose to spud in the San Jose formation. Will drill a 12 1/4" hole to a TD of 300'. Run and cement surface casing, with cement returns to surface. WOC 12 hours. Test to 600 psi/30 mins. Drill an 8 3/4" hole to a TD of 3071' using fresh water mud. No abnormal pressures or poisonous gas is anticipated. Run and cement intermediate casing with cement returns to surface. WOC 12 hours. Test to 1500 psi/30 mins. Drill the Fruitland Coals with a 6 1/4" bit, using air and water. The 5 1/2" liner may not be cemented if the coals exhibit a natural flow capacity. Total Depth is 3335'.

APPROVAL EXPIRES 9-28-90  
UNLESS DRILLING IS COMMENCED.  
SPUD NOTICE MUST BE SUBMITTED  
WITHIN 10 DAYS.

IN ABOVE SPACE DESCRIBE PROPOSED PROGRAM: IF PROPOSAL IS TO DEEPEN OR PLUG BACK, GIVE DATA ON PRESENT PRODUCTIVE ZONE AND PROPOSED NEW PRODUCTIVE ZONE. GIVE BLOWOUT PREVENTER PROGRAM, IF ANY.

I hereby certify that the information above is true and complete to the best of my knowledge and belief.

SIGNATURE William F. Clark TITLE Operations Manager DATE March 26, 1990

TYPE OR PRINT NAME William F. Clark TELEPHONE NO. 303-247-0728

(This space for State Use)

APPROVED BY [Signature] TITLE MANAGER DISTRICT # 9 DATE MAR 28 1990

CONDITIONS OF APPROVAL, IF ANY:

RECEIVED  
MAY 10 1964  
U.S. DEPARTMENT OF COMMERCE  
OFFICE OF ECONOMIC AFFAIRS  
WASHINGTON, D.C.

U.S. DEPARTMENT OF COMMERCE  
OFFICE OF ECONOMIC AFFAIRS  
WASHINGTON, D.C.

U.S. DEPARTMENT OF COMMERCE

OFFICE OF ECONOMIC AFFAIRS

NEW MEXICO OIL CONSERVATION COMMISSION  
WELL LOCATION AND ACREAGE DEDICATION PLAT

Form C-102  
Supersedes C-128  
Effective 1-1-65

All distances must be from the outer boundaries of the Section.

Operator BLACKWOOD & NICHOLS CO., LTD.		Lease NORTHEAST BLANCO UNIT		Well No. 489
Unit Letter L	Section 12	Township 31 North	Range 7 West	County San Juan County
Actual Footage Location of Well: 2330 feet from the south line and 1240 feet from the west line				
Ground Level Elev: 6525 (U.G.)	Producing Formation Fruitland Coal	Pool Basin Fruitland Coal	Dedicated Acreage: 320 Acres	

1. Outline the acreage dedicated to the subject well by colored pencil or hachure marks on the plat below.
2. If more than one lease is dedicated to the well, outline each and identify the ownership thereof (both as to working interest and royalty).
3. If more than one lease of different ownership is dedicated to the well, have the interests of all owners been consolidated by communitization, unitization, force-pooling, etc?

Yes  No If answer is "yes," type of consolidation Unitization

If answer is "no," list the owners and tract descriptions which have actually been consolidated. (Use reverse side of this form if necessary.) \_\_\_\_\_

No allowable will be assigned to the well until all interests have been consolidated (by communitization, unitization, forced-pooling, or otherwise) or until a non-standard unit, eliminating such interests, has been approved by the Commission.

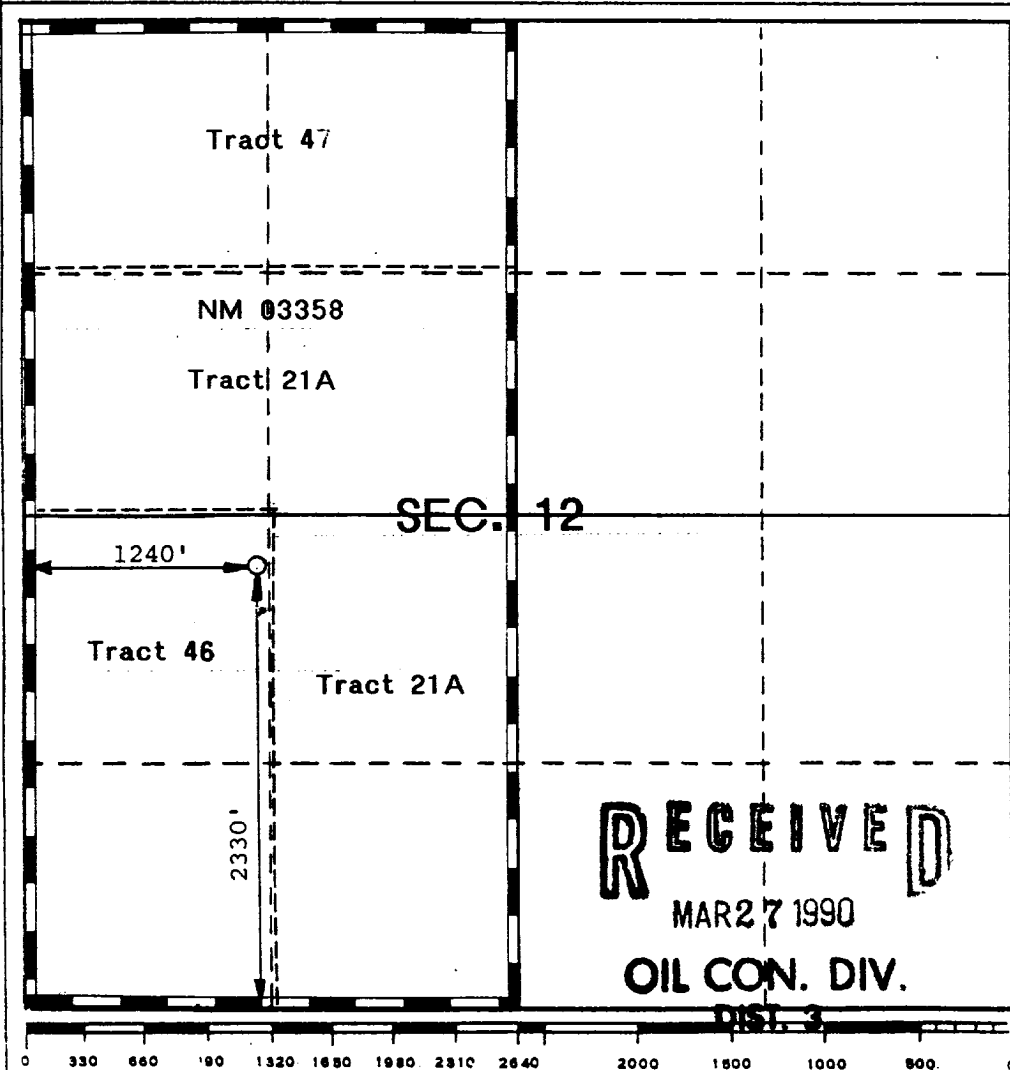

**RECEIVED**  
MAR 27 1990  
OIL CON. DIV.  
DIST. 3

CERTIFICATION

I hereby certify that the information contained herein is true and complete to the best of my knowledge and belief.

*William F. Clark*  
Name

*William F. Clark*  
Position

Operations Manager

Company  
Blackwood & Nichols Co., Ltd.

Date  
March 26, 1990

I hereby certify that the well location shown on this plat was plotted from field notes of actual surveys made by me or under my supervision, and that the same is true and correct to the best of my knowledge and belief.

Date Surveyed  
March 16, 1990

Registered Professional Engineer and/or Land Surveyor  
*Allison L. Kroeger*  
Allison L. Kroeger, PLS

Certificate No.  
7922

RECEIVED  
MAY 19 1964

OFFICE OF THE  
DIRECTOR



R. 7W R61  
T31N.

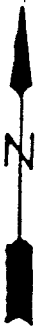

<b>BLACKWOOD &amp; NICHOLS CO., LTD.</b>	
VICINITY MAP NEBU 489 in Sec. 12, T. 31N., R. 7W. N.M.P.M. - San Juan County, NM	
Date: March, 1990	Scale: 1"=2000'
KROEGER & ASSOC. DURANGO, COLO.	

**RECEIVED**  
MAR 27 1990  
OIL CON. DIV  
DIST. 3