

State of New Mexico  
Energy, Minerals and Natural Resources Department

**RECEIVED**  
Form C-101

APR 04 1990

OIL CONSERVATION DIVISION  
P.O. Box 2088  
Santa Fe, New Mexico 87504-2088

OIL CON. DIV.  
DIST. 3

APPLICATION FOR PERMIT TO DRILL, DEEPEN,  
OR PLUG BACK

API NO. (assigned by OCD on new well)

*30-045-27713*

5. Indicate Type of Lease  
STATE

6. State Oil & Gas Lease No.  
E-5843

1a. Type of Work  
DRILL

b. Type of Well  
GAS SINGLE ZONE

7. Lease Name or Unit Agreement Name  
BEAVER LODGE COM

2. Name of Operator  
MERIDIAN OIL INC.

8. Well No.  
1A

3. Address of Operator  
PO Box 4289, Farmington, NM 87499

9. Pool Name or Wildcat  
BLANCO MESA VERDE

4. Well Location  
Unit letter C 865' FNL 1560' FWL  
Section 32 T30N R08W NMPM SAN JUAN COUNTY

*6823*

*W/320*

10. Proposed Depth  
5287'

11. Formation  
MESA VERDE

12. Rotary or C.T.  
Rotary

13. Elevation  
5882' GL

14. Bond Type  
statewide

15. Drill. Contractor

16. Est. Start Date  
upon approval

17. PROPOSED CASING AND CEMENT PROGRAM

SIZE HOLE	SIZE CASING	WT. PER FT.	SET. DEPTH	SKS OF CEMENT	EST. TOP
12 1/4"	9 5/8"	32.3#	200 ft.	189 cu.ft.	circ surface
8 3/4"	7"	20.0#	2850 ft.	910 cu.ft.	circ surface
6 1/4"	4 1/2"	10.5#	5287 ft.	451 cu.ft.	circ liner

The Mesa Verde formation will be completed.  
A minimum 2000 psi working pressure double gate blowout preventer  
equipped with blind and pipe rams will be used for blow out prevention  
on this well. This gas is dedicated.  
The W/2 of Sec 32 is dedicated to this well.

I hereby certify that the information above is true and complete to the best  
of my knowledge and belief.

SIGNATURE *[Signature]* TITLE Reg. Drilling Engr. DATE *4/2/90*

(This space for State Use)

APPROVED BY *[Signature]*  
Conditions of approval, if any:

TITLE DEPUTY OIL & GAS INSPECTOR, DIST. 3 DATE APR 05 1990

APPROVAL EXPIRES *10-5-90*  
UNLESS DRILLING IS COMMENCED.  
SPUD NOTICE MUST BE SUBMITTED  
WITHIN 10 DAYS.

*Hold C-104 FOR CA*



Submit to Appropriate District Office  
 State Lease - 4 copies  
 Fee Lease - 3 copies

State of New Mexico  
 Energy, Minerals and Natural Resources Department

Form C-102  
 Revised 1-1-89

**OIL CONSERVATION DIVISION**  
 P.O. Box 2088  
 Santa Fe, New Mexico 87504-2088

DISTRICT I  
 P.O. Box 1980, Hobbs, NM 88240

DISTRICT II  
 P.O. Drawer DD, Artesia, NM 88210

DISTRICT III  
 1000 Rio Brazos Rd., Aztec, NM 87410

**WELL LOCATION AND ACREAGE DEDICATION PLAT**

All Distances must be from the outer boundaries of the section

Operator <i>Meridian Oil Inc.</i>		Lease 31 Paso Natural Gas	Well No. Beaverlodge Com 1A
Unit Letter C	Section 32	Township 30 North	Range 8 West
Actual Footage Location of Well: 865 feet from the North line and 1560 feet from the West line		County San Juan	NMFM
Ground level Elev. 5882'	Producing Formation Mesa Verde	Pool Blanco Mesa Verde	Dedicated Acreage: 320.00 Acres

- Outline the acreage dedicated to the subject well by colored pencil or lacquer marks on the plat below.
- If more than one lease is dedicated to the well, outline each and identify the ownership thereof (both as to working interest and royalty).
- If more than one lease of different ownership is dedicated to the well, have the interest of all owners been consolidated by communitization, unitization, force-pooling, etc.?
  - Yes
  - No
 If answer is "yes" type of consolidation Communitization Agreement w/be obtained  
 this form if necessary. if answer is "no" list the owners and tract descriptions which have actually been consolidated. (Use reverse side of  
 No allowable will be assigned to the well until all interests have been consolidated (by communitization, unitization, forced-pooling, or otherwise) or until a non-standard unit, eliminating such interest, has been approved by the Division.

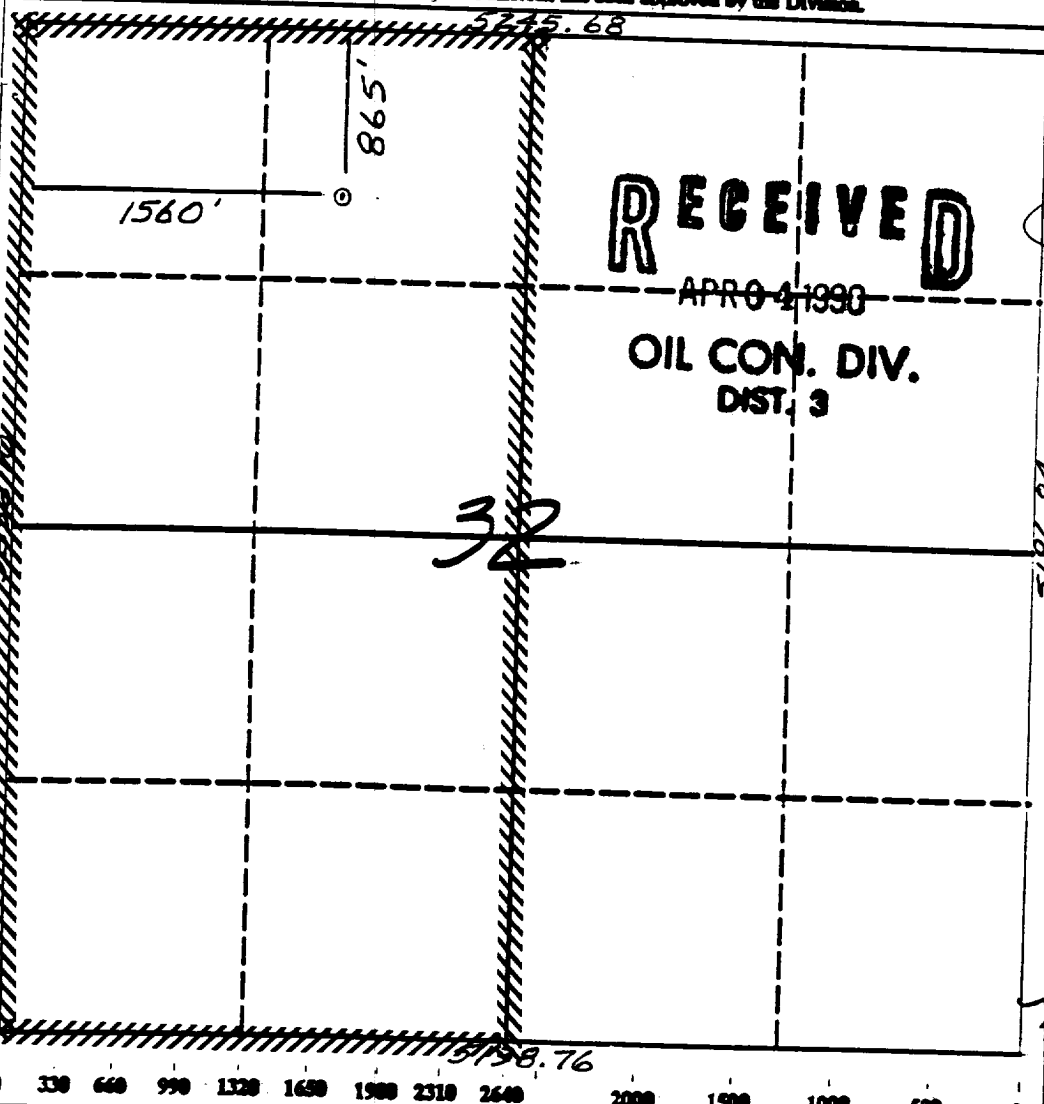

**RECEIVED**

APR 0 4 1990

OIL CON. DIV.  
 DIST. 3

**OPERATOR CERTIFICATION**

I hereby certify that the information contained herein is true and complete to the best of my knowledge and belief.

Signature: *Peggy Bradfield*  
 Printed Name: Peggy Bradfield  
 Position: Regulatory Affairs  
 Company: El Paso Natural Gas  
 Date: 3-13-90

**SURVEYOR CERTIFICATION**

I hereby certify that the well location shown on this plat was plotted from field notes, actual surveys made by me or under my supervision, and that the same is true and correct to the best of my knowledge and belief.

Date Surveyed: 3-12-90  
 Signature of Surveyor: *Neale C. Edwards*  
 Professional Surveyor No. 857

REGISTERED LAND SURVEYOR  
 Certificate No. 6857

RECEIVED  
MAY 19 1963  
DIVISION OF CONSTRUCTION  
DIST. 3