

UNITED STATES
DEPARTMENT OF THE INTERIOR
GEOLOGICAL SURVEY

APPLICATION FOR PERMIT TO DRILL, DEEPEN, OR PLUG BACK

1a. TYPE OF WORK DRILL <input checked="" type="checkbox"/> DEEPEN <input type="checkbox"/> PLUG BACK <input type="checkbox"/>				4. LEASE DESIGNATION AND SERIAL NO. NM03356	
b. TYPE OF WELL OIL WELL <input type="checkbox"/> GAS WELL <input checked="" type="checkbox"/> OTHER <input type="checkbox"/>				6. IF INDIAN, ALLOTTEE OR TRIBE NAME	
2. NAME OF OPERATOR Blackwood and Nichols Co., Ltd.				7. UNIT AGREEMENT NAME Northeast Blanco	
3. ADDRESS OF OPERATOR P.O. Box 1237, Durango, CO 81302-1237				8. FARM OR LEASE NAME Northeast Blanco Unit	
4. LOCATION OF WELL (Report location clearly and in accordance with any State requirements.) At surface 1595' FSL, 891' FWL At proposed prod. zone Same				9. WELL NO. 480	
14. DISTANCE IN MILES AND DIRECTION FROM NEAREST TOWN OR POST OFFICE* 19.5 miles NE of Blanco, New Mexico				10. FIELD AND POOL, OR WILDCAT Basin Fruitland Coal	
13. DISTANCE FROM PROPOSED* LOCATION TO NEAREST PROPERTY OR LEASE LINE, FT. (Also to nearest drig. unit line, if any) 429'		16. NO. OF ACRES IN LEASE 840.00		17. NO. OF ACRES ASSIGNED TO THIS WELL w/ 320	
15. DISTANCE FROM PROPOSED LOCATION* TO NEAREST WELL, DRILLING COMPLETED, OR APPLIED FOR, ON THIS LEASE, FT. 3250'		19. PROPOSED DEPTH 3365'		20. ROTARY OR CABLE TOOLS Rotary	
21. ELEVATIONS (Show whether DF, RT, GR, etc.) 6488 (U.G.) This action is subject to technical and procedural review pursuant to 43 CFR 3165.3 and appeal pursuant to 43 CFR 3165.4.				22. APPROX. DATE WORK WILL START* April 1, 1990	
23. PROPOSED DRILLING AND CEMENTING PROGRAM					
SIZE OF HOLE	SIZE OF CASING	WEIGHT PER FOOT	SETTING DEPTH	GENERAL QUANTITY OF CEMENT	
12 1/4"	9 5/8"	36#	300'	295 cuft/circulate to surface	
8 3/4"	7"	23#	3065'	940 cuft/circulate to surface	
6 1/4"	5 1/2"	17#	2965'-3365'	39 cuft/circulate to liner top	

Propose to spud in the San Jose formation. Will drill a 12 1/4" hole to a TD of 300'. Run surface casing and cement with cement returns to surface. WOC 12 hours. Test to 600 psi/30 mins. Drill a 8 3/4" hole to a TD of 3065' using fresh water mud. No poisonous gases or abnormal pressures are anticipated. Run intermediate casing and cement with cement returns to surface. WOC 12 hours. Test to 1500 psi/30 mins. Drill a 6 1/4" hole to a TD of 3365' using water and air. Run a mud logging unit while drilling this interval. Run the production liner. The liner will be cemented if the wells natural flow capacity indicates the need for fracture stimulation.

Surface ownership is Bureau of Land Management

RECEIVED
APR 10 1990

IN ABOVE SPACE DESCRIBE PROPOSED PROGRAM: If proposal is to deepen or plug back, give data on zone. If proposal is to drill or deepen directionally, give pertinent data on subsurface locations and true vertical depths. Give blowout preventer program, if any.

24. SIGNATURE William F. Clark TITLE Operations Manager DATE 5 Mar '90

(This space for Federal or State office use)

PERMIT NO. _____ APPROVAL DATE _____
APPROVED BY _____ TITLE _____
CONDITIONS OF APPROVAL, IF ANY: _____

APPROVED
AS AMENDED
DATE _____

5

*See Instructions On Reverse Side

APR 09 1990
AREA MANAGER

RECEIVED
OCT 10 1960
OIL COAL DIA
DIST 3

**NEW MEXICO OIL CONSERVATION COMMISSION
WELL LOCATION AND ACREAGE DEDICATION PLAT**

Form C-102
Supersedes C-128
Effective 1-1-65

All distances must be from the outer boundaries of the Section.

Operator BLACKWOOD & NICHOLS CO., LTD.			Lease NORTHEAST BLANCO UNIT		Well No. 480
Unit Letter L	Section 14	Township 31 North	Range 7 West	County San Juan County	
Actual Footage Location of Well: <div style="display: flex; justify-content: space-between;"> 1595 feet from the South line and 891 feet from the West line </div>					
Ground Level Elev: 6488 (U.G.)	Producing Formation Fruitland Coal	Pool Basin Fruitland Coal		Dedicated Acreage: 320 Acres	

1. Outline the acreage dedicated to the subject well by colored pencil or hachure marks on the plat below.
2. If more than one lease is dedicated to the well, outline each and identify the ownership thereof (both as to working interest and royalty).
3. If more than one lease of different ownership is dedicated to the well, have the interests of all owners been consolidated by communitization, unitization, force-pooling, etc?

☒ Yes ☐ No If answer is "yes," type of consolidation Unitization

If answer is "no," list the owners and tract descriptions which have actually been consolidated. (Use reverse side of this form if necessary.) _____

No allowable will be assigned to the well until all interests have been consolidated (by communitization, unitization, forced-pooling, or otherwise) or until a non-standard unit, eliminating such interests, has been approved by the Commission.

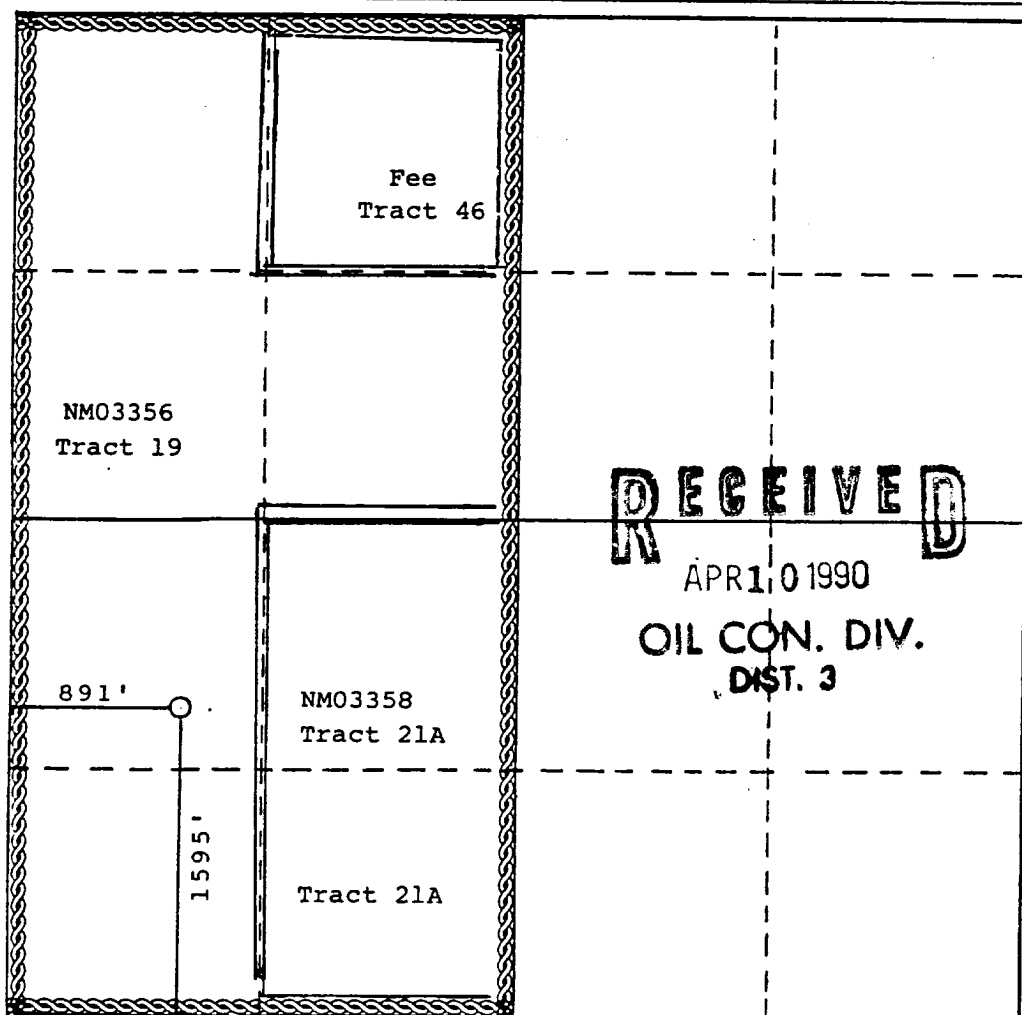

CERTIFICATION

I hereby certify that the information contained herein is true and complete to the best of my knowledge and belief.

William F. Clark

Name

William F. Clark

Position

Operations Manager

Company

Blackwood & Nichols Co.

Date

December 7, 1989

I hereby certify that the well location shown on this plat was plotted from field notes of actual surveys made by me or under my supervision, and that the same is true and correct to the best of my knowledge and belief.

Date Surveyed

November 12, 1989

Registered Professional Engineer and/or Land Surveyor

Allison L. Kroeger
Allison L. Kroeger, PLS

Certificate No.

7922

0 330 660 990 1320 1650 1980 2310 2640 2000 1500 1000 500 0

