

UNITED STATES  
DEPARTMENT OF THE INTERIOR  
GEOLOGICAL SURVEY

30-045-27724

APPLICATION FOR PERMIT TO DRILL, DEEPEN, OR PLUG BACK

1a. TYPE OF WORK  
DRILL ☒ DEEPEN ☐ PLUG BACK ☐

b. TYPE OF WELL  
OIL WELL ☐ GAS WELL ☒ OTHER ☐ SINGLE ZONE ☒ MULTIPLE ZONE ☐

2. NAME OF OPERATOR  
Blackwood and Nichols Co., Ltd.

3. ADDRESS OF OPERATOR  
P.O. Box 1237, Durango, CO 81302-1237

4. LOCATION OF WELL (Report location clearly and in accordance with any State requirements.)\*  
At surface  
1250' FSL - 1640' FWL  
At proposed prod. zone  
Same

14. DISTANCE IN MILES AND DIRECTION FROM NEAREST TOWN OR POST OFFICE\*  
18 miles NE of Blanco, New Mexico

15. DISTANCE FROM PROPOSED\*  
LOCATION TO NEAREST  
PROPERTY OR LEASE LINE, FT.  
(Also to nearest drig. unit line, if any) 1250'

18. DISTANCE FROM PROPOSED LOCATION\*  
TO NEAREST WELL, DRILLING, COMPLETED,  
OR APPLIED FOR, ON THIS LEASE, FT. 1950'

21. ELEVATIONS (Show whether DF, RT, GR, etc.)  
6182' (U.G.)

23. ~~This action is subject to technical and~~  
~~procedural review pursuant to 43 CFR 3163.3~~  
~~and appeal pursuant to 43 CFR 3163.4.~~

SIZE OF HOLE	SIZE OF CASING	WEIGHT PER FOOT	SETTING DEPTH
12 1/4"	9 5/8"	36#	300'
8 3/4"	7"	23#	2750'
6 1/4"	5 1/2"	17#	2650' - 3090'

5. LEASE DESIGNATION AND SERIAL NO.  
SF079003

6. IF INDIAN, ALLOTTEE OR TRIBE NAME

7. UNIT AGREEMENT NAME  
Northeast Blanco

8. FARM OR LEASE NAME  
Northeast Blanco Unit

9. WELL NO.  
494

10. FIELD AND POOL, OR WILDCAT  
Basin Fruitland Coal

11. SEC., T., R., M., OR BLK.  
AND SURVEY OR AREA  
N  
Sec. 27, T31N, R7W

12. COUNTY OR PARISH  
San Juan

13. STATE  
NM

16. NO. OF ACRES IN LEASE  
2560.00

19. PROPOSED DEPTH  
3090'

17. NO. OF ACRES ASSIGNED  
TO THIS WELL  
w/ 320

20. ROTARY OR CABLE TOOLS  
Rotary

22. APPROX. DATE WORK WILL START  
April 1, 1990

Propose to spud in the San Jose formation. Will drill a 12 1/4" hole to a TD of 300'. Run surface casing and cement with cement returns to surface. WOC 12 hours. Test to 600 psi/30 mins. Drill a 8 3/4" hole to a TD of 2750' using fresh water mud. No poisonous gases or abnormal pressures are anticipated. Run intermediate casing and cement with cement returns to surface. WOC 12 hours. Test to 1500 psi/30 mins. Drill a 6 1/4" hole to a TD of 3090' using water and air. Run a mud logging unit while drilling this interval. Run the production liner. The liner will be cemented if the wells natural flow capacity indicates the need for fracture stimulation.

Surface ownership is Bureau of Reclamation

"Approval of this action does  
not warrant that the applicant

holds legal or equitable rights  
or title to this lease."

SIGNED William F. Clark TITLE Operations Manager DATE 7 Mar '90

(This space for Federal or State office use)

PERMIT NO. \_\_\_\_\_ APPROVAL DATE \_\_\_\_\_

APPROVED BY \_\_\_\_\_ TITLE \_\_\_\_\_

CONDITIONS OF APPROVAL, IF ANY:

NMOCD

\*See Instructions On Reverse Side

RECEIVED

APR 10 1990

OIL CON. DIV.  
DIST. 3

APR 10 1990

AREA MANAGER

Head C-104 FOR CONVERSION  
OF THE N-E.T.B.U. # 211  
TO PROPOSED MONITORING WELL (E)

201333  
NO 1100 40  
20

100 100  
100 100  
100 100

**NEW MEXICO OIL CONSERVATION COMMISSION  
WELL LOCATION AND ACREAGE DEDICATION PLAT**

Form C-102  
Supersedes C-128  
Effective 1-1-65

All distances must be from the outer boundaries of the Section.

**RECEIVED**

Operator <b>BLACKWOOD &amp; NICHOLS CO., LTD.</b>			Lease <b>NORTHEAST BLANCO UNIT</b>		Well No. <b>494</b>
Unit Letter <b>N</b>	Section <b>27</b>	Township <b>31 North</b>	Range <b>7 West</b>	County <b>San Juan County</b>	
Actual Footage Location of Well: <div style="display: flex; justify-content: space-between;"> <span>1250 feet from the south line and</span> <span>1640 feet from the west line</span> </div>					
Ground Level Elev: <b>6182 (U.G.)</b>	Producing Formation <b>Fruitland Coal</b>	Pool <b>Basin Fruitland Coal</b>	Dedicated Acreage: <b>320</b> Acres		

1. Outline the acreage dedicated to the subject well by colored pencil or hachure marks on the plat below.
2. If more than one lease is dedicated to the well, outline each and identify the ownership thereof (both as to working interest and royalty).
3. If more than one lease of different ownership is dedicated to the well, have the interests of all owners been consolidated by communitization, unitization, force-pooling, etc?

☒ Yes    ☐ No    If answer is "yes," type of consolidation Unitization

If answer is "no," list the owners and tract descriptions which have actually been consolidated. (Use reverse side of this form if necessary.) \_\_\_\_\_

No allowable will be assigned to the well until all interests have been consolidated (by communitization, unitization, forced-pooling, or otherwise) or until a non-standard unit, eliminating such interests, has been approved by the Commission.

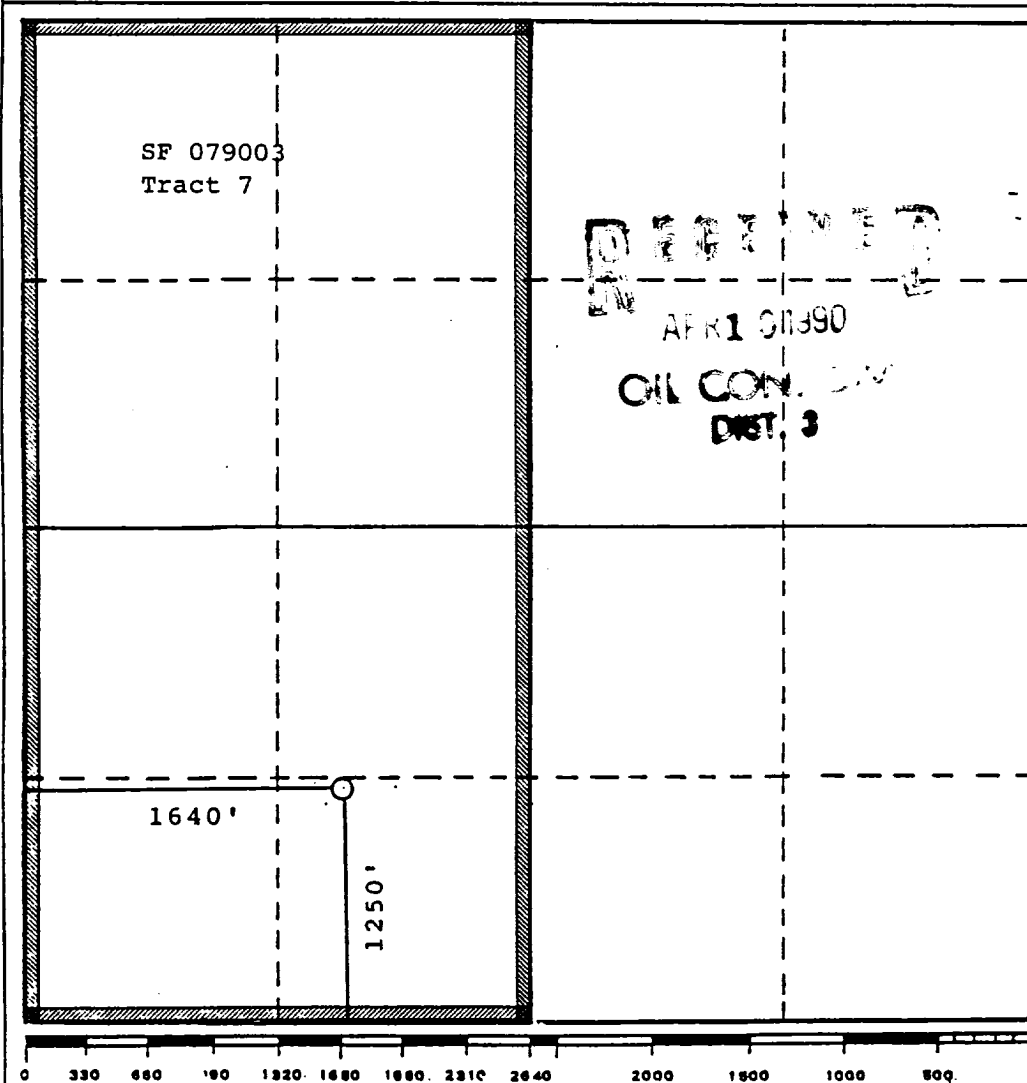

**CERTIFICATION**

I hereby certify that the information contained herein is true and complete to the best of my knowledge and belief.

*William F. Clark*

Name <b>William F. Clark</b>
Position <b>Operations Manager</b>
Company <b>Blackwood &amp; Nichols Co.</b>
Date <b>December 7, 1989</b>

I hereby certify that the well location shown on this plat was plotted from field notes of actual surveys made by me or under my supervision, and that the same is true and correct to the best of my knowledge and belief.

Date Surveyed <b>November 10, 1989</b>
Registered Professional Engineer and/or Land Surveyor <i>Allison L. Kroeger</i> <b>Allison L. Kroeger, PLS</b>
Certificate No. <b>7922</b>

