

UNITED STATES
DEPARTMENT OF THE INTERIOR
BUREAU OF LAND MANAGEMENT

APPLICATION FOR PERMIT TO DRILL, DEEPEN, OR PLUG BACK

1A. TYPE OF WORK

DRILL ☒

DEEPEN ☐

PLUG BACK ☐

B. TYPE OF WELL

OIL
WELL ☐

GAS
WELL ☒

OTHER ☐

SINGLE
ZONE ☒

MULTIPLE
ZONE ☐

2. NAME OF OPERATOR

Quinoco Petroleum, INC.

3. ADDRESS OF OPERATOR

PO Box 378111, Denver, Colorado 80237

4. LOCATION OF WELL (Report location clearly and in accordance with any State requirements.*)

At surface

1620 FNL & 1685 FEL

At proposed prod. zone

Non standard proration unit Order R-9061

14. DISTANCE IN MILES AND DIRECTION FROM NEAREST TOWN OR POST OFFICE*

10 miles South of Allison, Colorado

15. DISTANCE FROM PROPOSED*

LOCATION TO NEAREST
PROPERTY OR LEASE LINE, FT.
(Also to nearest drlg. unit line, if any)

955'

16. NO. OF ACRES IN LEASE

160

17. NO. OF ACRES ASSIGNED
TO THIS WELL

320.00

18. DISTANCE FROM PROPOSED LOCATION*

TO NEAREST WELL, DRILLING, COMPLETED,
OR APPLIED FOR, ON THIS LEASE, FT.

165'

19. PROPOSED DEPTH

3203

20. ROTARY OR CABLE TOOLS

Rotary

21. ELEVATIONS (Show whether DF, RT, GR, etc.)

6505 GR

This action is subject to technical and
procedural review pursuant to 43 CFR 3165.3
and appeal pursuant to 43 CFR 3165.4

22. APPROX. DATE WORK WILL START*

April 20, 1990

23.

SIZE OF HOLE	SIZE OF CASING	WEIGHT PER FOOT	SETTING DEPTH	GENERAL QUANTITY OF CEMENT
12 1/4	9 5/8	32.3	300	210sxs, 248cuft B
8 3/4	7	17.0	3092	220sxs 368cuft 65/35, 60sxs
6 1/4	5 1/2 liner	15.5	3017-3203	None (71cuft) B

Quinoco Petroleum, INC. wishes to advise that we intend to drill a 12 1/4" hole with spud mud to 300' and set 9 5/8", 32.3#, H-40 ST&C casing to 300' cementing to surface with 210 sxs (248 cu ft) Class B cement with 2% CaCl2. Wait on cement 12 hours. Nipple up and test BOP. Drill 8 3/4" hole out of surface to 3092' with mud. Set 7", 23.0#, K-55 ST&C intermediate casing to 3092' cementing to surface with 220 sxs (368 cu ft) 65/35 POZ with 6% gel and 12 1/4# gilsonite/sk, tailed by 60 sxs (71 cu ft) Class B cement with 2% CaCl2. Drill 6 1/4" hole to 3203 and snub in 5 1/2" slotted liner. If necessary acidize and frac with 250,000# sand in 180,000 gal 30# cross linked gel. Clean up well and install standard production equipment. Test well to reserve pit for a period not to exceed 30 days. Connect well to a gathering system.

Approved by: [Signature]

Not valid without approval of [Signature]

HOWEVER, DESCRIBE PROPOSED PROGRAM: If proposal is to deepen or plug back, give data on present productive zone and proposed new productive zone. If proposal is to drill or deepen directionally, give pertinent data on subsurface locations and measured and true vertical depths. Give blowout test program, if any.

SIGNED: [Signature] TITLE: Agent DATE: 3/19/90

(This space for Federal or State office use)

PERMIT NO.

APPROVAL DATE

APPROVED BY

CONDITIONS OF APPROVAL

TITLE

RECEIVED

APR 09 1990

OIL CON. DIV.,
DIST. 3

*See Instructions On Reverse Side

State of New Mexico
Energy, Minerals and Natural Resources Department

Form C-102
Revised 1-1-89

OIL CONSERVATION DIVISION

P.O. Box 2088
Santa Fe, New Mexico 87504-2088

Submit to Appropriate
District Office
State Lease - 4 copies
Fee Lease - 3 copies

DISTRICT I
P.O. Box 1980, Hobbs, NM 88240

DISTRICT II
P.O. Drawer DD, Artesia, NM 88210

DISTRICT III
1000 Rio Brazos Rd., Aztec, NM 87410

WELL LOCATION AND ACREAGE DEDICATION PLAT

All Distances must be from the outer boundaries of the section

Operator QUINOCO		Lease FEDERAL G		Well No. 8-4	
Unit Letter G	Section 10	Township 31N	Range 7W	County SAN JUAN	
Actual Footage Location of Well: 1620 feet from the North line and 1685 feet from the East line					
Ground level Elev. 6505	Producing Formation Fruitland Coal		Pool Basin Fruitland Coal		Dedicated Acreage: 320* Acres

1. Outline the acreage dedicated to the subject well by colored pencil or hatchure marks on the plat below. * Nonstandard proration unit B-9061.
2. If more than one lease is dedicated to the well, outline each and identify the ownership thereof (both as to working interest and royalty).
3. If more than one lease of different ownership is dedicated to the well, have the interest of all owners been consolidated by communitization, unitization, force-pooling, etc.?
☐ Yes ☐ No If answer is "yes" type of consolidation _____
If answer is "no" list the owners and tract descriptions which have actually been consolidated. (Use reverse side of this form if necessary.)
No allowable will be assigned to the well until all interests have been consolidated (by communitization, unitization, forced-pooling, or otherwise) or until a non-standard unit, eliminating such interest, has been approved by the Division.

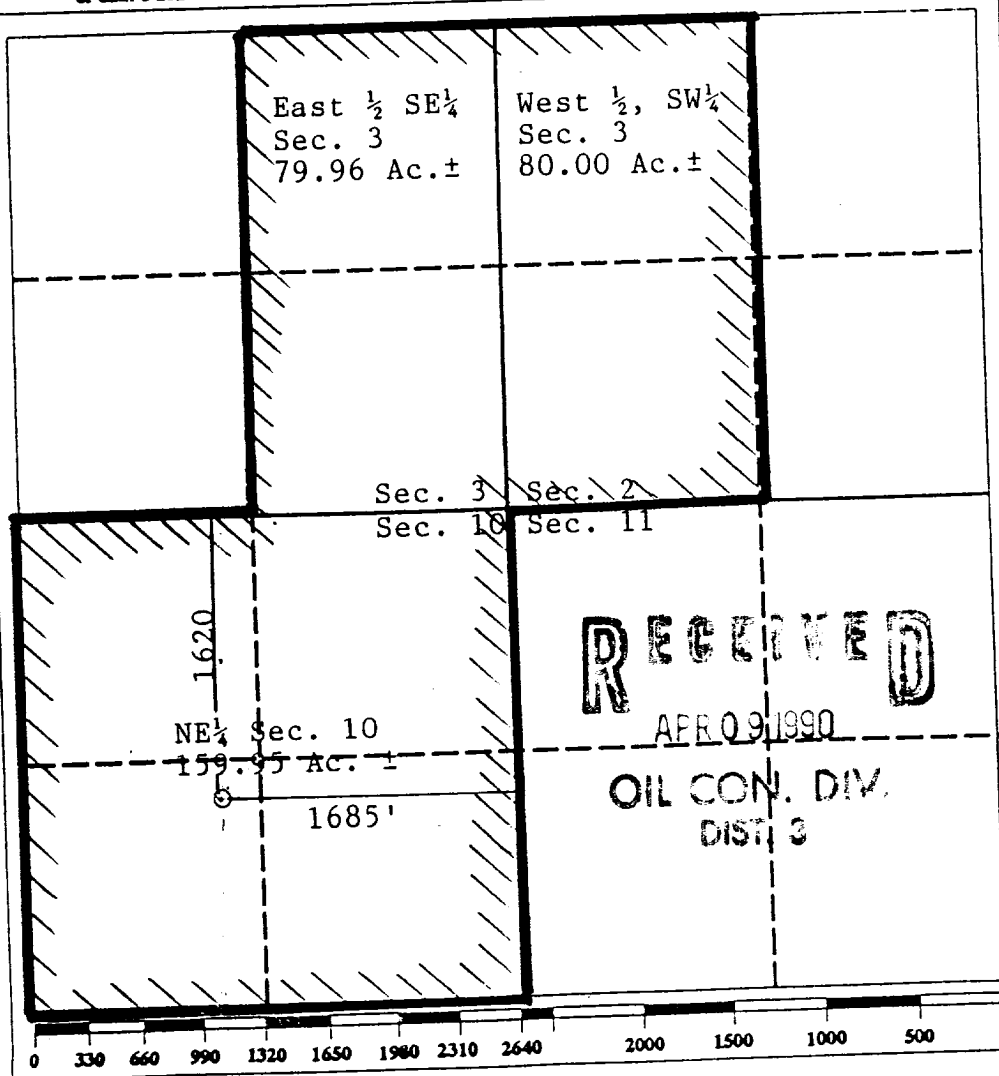

OPERATOR CERTIFICATION

I hereby certify that the information contained herein is true and complete to the best of my knowledge and belief.

Signature *Robert C. Frank*
Printed Name **Robert C. Frank**
Position **Agent**
Company **Quinoco Petroleum, INC.**
Date **March 19, 1990**

SURVEYOR CERTIFICATION

I hereby certify that the well location shown on this plat was plotted from field notes of actual surveys made by me or under my supervision, and that the same is true and correct to the best of my knowledge and belief.

Date Surveyed **August 1989**
Signature & Seal of Professional Surveyor *Cecil B. Tullis*
Certificate No. **9672**

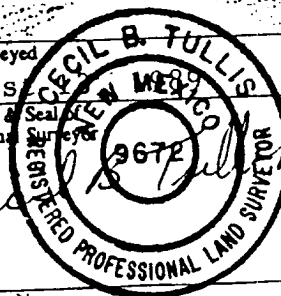

UNITED STATES
DEPARTMENT OF THE INTERIOR
BUREAU OF LAND MANAGEMENT

SUBMIT IN TRIPPLICATE*
(Other instructions on re-
verse side)

Budget Bureau No. 1004-0135
Expires August 31, 1985

SUNDRY NOTICES AND REPORTS ON WELLS

(Do not use this form for proposals to drill or to deepen or plug back to a different reservoir.
Use "APPLICATION FOR PERMIT—" for such proposals.)

1. OIL WELL ☐ GAS WELL ☒ OTHER ☐

2. NAME OF OPERATOR
Quinoco Petroleum, Inc.

3. ADDRESS OF OPERATOR
P.O. Box 378111, Denver, CO 80237

4. LOCATION OF WELL (Report location clearly and in accordance with any State requirements.
See also space 17 below.)
At surface
Unit G, 1620' FNL & 1685' FEL

14. PERMIT NO.

15. ELEVATIONS (Show whether DF, RT, GR, etc.)
6505' GR

5. LEASE DESIGNATION AND SERIAL NO
NM-28749

6. IF INDIAN, ALLOTTEE OR TRIBE NAME
N/A

7. UNIT AGREEMENT NAME
N/A

8. FARM OR LEASE NAME
Federal G

9. WELL NO.
4

10. FIELD AND POOL, OR WILDCAT
Basin Fruitland Coal

11. SEC., T., R., M., OR BLK. AND
SURVEY OR AREA
Sec. 10-T31N-R7W

12. COUNTY OR PARISH
San Juan

13. STATE
NM

16. Check Appropriate Box To Indicate Nature of Notice, Report, or Other Data

NOTICE OF INTENTION TO:		SUBSEQUENT REPORT OF:	
TEST WATER SHUT-OFF	<input type="checkbox"/>	WATER SHUT-OFF	<input type="checkbox"/>
FRACTURE TREAT	<input type="checkbox"/>	FRACTURE TREATMENT	<input type="checkbox"/>
SHOOT OR ACIDIZE	<input type="checkbox"/>	SHOOTING OR ACIDIZING	<input type="checkbox"/>
REPAIR WELL	<input type="checkbox"/>	(Other) Spudding	<input type="checkbox"/>
(Other)	<input type="checkbox"/>	(Note: Report results of multiple completion on Well Completion or Recompletion Report and Log form.)	<input type="checkbox"/>
PULL OR ALTER CASING	<input type="checkbox"/>	REPAIRING WELL	<input type="checkbox"/>
MULTIPLE COMPLETE	<input type="checkbox"/>	ALTERING CASING	<input type="checkbox"/>
ABANDON*	<input type="checkbox"/>	ABANDONMENT*	<input checked="" type="checkbox"/>
CHANGE PLANS	<input type="checkbox"/>		

17. DESCRIBE PROPOSED OR COMPLETED OPERATIONS (Clearly state all pertinent details, and give pertinent dates, including estimated date of starting any proposed work. If well is directionally drilled, give subsurface locations and measured and true vertical depths for all markers and zones pertinent to this work.)*

1. Begin building location - April 9, 1990.
2. MIRU rotary tool - April 14, 1990.
3. Spud well @ 3:45 PM, April 14, 1990.

ACCEPTED FOR RECORD

APR 24 1990

FARMINGTON RESOURCE AREA

BY

18. I hereby certify that the foregoing is true and correct

SIGNED Wally S. Richardson TITLE Sr. Ops. Eng. Tech.

DATE 4/16/90

(This space for Federal or State office use)

APPROVED BY
CONDITIONS OF APPROVAL, IF ANY:

TITLE

DATE

*See Instructions on Reverse Side