

90-045-27787

Form 3150-3
(November 1983)
(formerly 9-331C)

SUBMIT IN TRIPLICATE*
(Other instructions on
reverse side)

Form approved.
Budget Bureau No. 1004-0136
Expires August 31, 1985

UNITED STATES
DEPARTMENT OF THE INTERIOR
BUREAU OF LAND MANAGEMENT

APPLICATION FOR PERMIT TO DRILL, DEEPEN, OR PLUG BACK

1a. TYPE OF WORK
DRILL DEEPEN PLUG BACK
b. TYPE OF WELL
OIL WELL GAS WELL OTHER Coal Seam
SINGLE ZONE MULTIPLE ZONE

2. NAME OF OPERATOR
Amoco Production Company ATTN: J. L. Hampton
3. ADDRESS OF OPERATOR
P. O. Box 800 Denver, Colorado 80201

4. LOCATION OF WELL (Report location clearly and in accordance with any State requirements.)
At surface 1770' FNL, 1180' FEL SE/NE
At proposed prod. zone

14. DISTANCE IN MILES AND DIRECTION FROM NEAREST TOWN OR POST OFFICE*
18 miles to Artec, NM.

10. DISTANCE FROM PROPOSED* LOCATION TO NEAREST PROPERTY OR LEASE LINE, FT. (Also to nearest drlg. unit line, if any)
1180'

16. NO. OF ACRES IN LEASE
961.80 481.80

17. NO. OF ACRES ASSIGNED TO THIS WELL
320 acres E / 2

18. DISTANCE FROM PROPOSED LOCATION* TO NEAREST WELL, DRILLING, COMPLETED, OR APPLIED FOR, ON THIS LEASE, FT.

19. PROPOSED DEPTH
3171' TD

20. ROTARY OR CABLE TOOLS
Rotary

21. ELEVATIONS (Show whether DF, RT, GR, etc.)
6436' GR This action is subject to technical and

22. APPROX. DATE WORK WILL START*
As soon as permitted

23. PROPOSED CASING AND CEMENTING PROGRAM

SIZE OF HOLE	SIZE OF CASING	WEIGHT PER FOOT	SETTING DEPTH	QUANTITY OF CEMENT
12 1/4"	9 5/8"	36#	250'	200 cf Class B (cement to surface)
8 3/4"	7"	20#	2931'	820 cf Class B (cement to surface)
6 1/4"	5 1/2"	23#	3171' (TD)	None *

Notice of Staking was Submitted: 3/20/90

Lease Description:
T30N-R9W:
Sec. 5: Lots 1-2, S/2 NE/4, SE/4
Sec. 6: Lots 1,2, S/2 NE/4, SE/4
Sec. 8: W/2

RECEIVED
MAY 07 1990
OIL CON. DIV
DIST. 3

IN ABOVE SPACE DESCRIBE PROPOSED PROGRAM: If proposal is to deepen or plug back, give data on present productive zone and proposed new productive zone. If proposal is to drill or deepen directionally, give pertinent data on subsurface locations and measured and true vertical depths. Give blowout preventer program, if any.

24. SIGNED J. L. Hampton / JCB TITLE Sr. Staff Admin. Supervisor DATE 4/5/90

PERMIT NO. _____ APPROVAL DATE _____ APPROVED AS AMENDED

APPROVED BY _____ TITLE _____
CONDITIONS OF APPROVAL, IF ANY: _____
MAY 11 1990
AREA MANAGER

*See Instructions On Reverse Side

RECEIVED

NOV 19 1954

OIL COMPANY

8, 7210

Submit to Appropriate District Office
 State Lease - 4 copies
 Fee Lease - 3 copies

State of New Mexico
 Energy, Minerals and Natural Resources Department

Form C-102
 Revised 1-1-89

OIL CONSERVATION DIVISION

P.O. Box 2088
 Santa Fe, New Mexico 87504-2088

DISTRICT I
 P.O. Box 1980, Hobbs, NM 88240

DISTRICT II
 P.O. Drawer DD, Artesia, NM 88210

DISTRICT III
 1000 Rio Brazos Rd., Aztec, NM 87410

WELL LOCATION AND ACREAGE DEDICATION PLAT

All Distances must be from the outer boundaries of the section

Operator AMOCO PRODUCTION COMPANY			Lease FLORANCE GAS COM /J/		Well No. # 3
Unit Letter H	Section 6	Township 30 NORTH	Range 9 WEST	County SAN JUAN	
Actual Footage Location of Well: 1770 feet from the NORTH line and 1180 feet from the EAST line					
Ground level Elev. 6436	Producing Formation <i>Fruitland Coal</i>	Pool <i>Basin Fruitland Coal Gas</i>	Dedicated Acreage: 320.0 Acres		
<p>1. Outline the acreage dedicated to the subject well by colored pencil or hachure marks on the plat below.</p> <p>2. If more than one lease is dedicated to the well, outline each and identify the ownership thereof (both as to working interest and royalty).</p> <p>3. If more than one lease of different ownership is dedicated to the well, have the interest of all owners been consolidated by communitization, unitization, force-pooling, etc.? <input type="checkbox"/> Yes <input type="checkbox"/> No If answer is "yes" type of consolidation _____</p> <p>If answer is "no" list the owners and tract descriptions which have actually been consolidated. (Use reverse side of this form if necessary.) _____</p> <p>No allowable will be assigned to the well until all interests have been consolidated (by communitization, unitization, forced-pooling, or otherwise) or until a non-standard unit, eliminating such interest, has been approved by the Division.</p>					

RECEIVED
 MAY 07 1990
 OIL CON. DIV
 DIST. 3

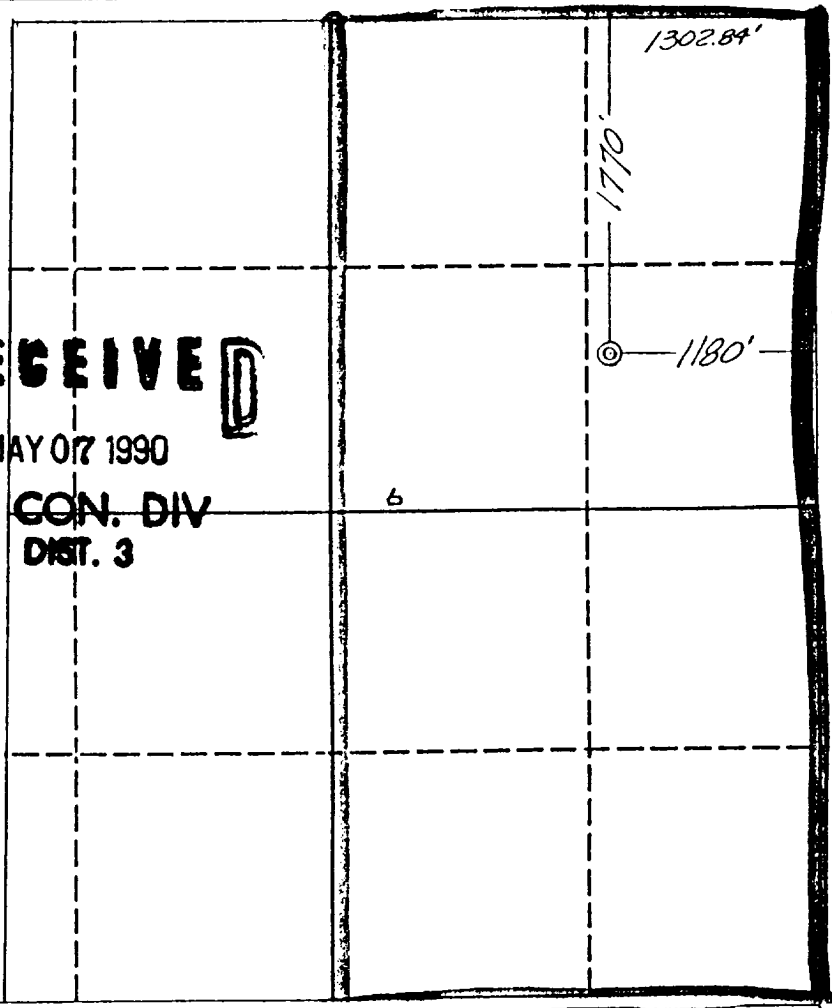

OPERATOR CERTIFICATION
 I hereby certify that the information contained herein is true and complete to the best of my knowledge and belief.

Signature
J. L. Hampton
 Printed Name
J. L. Hampton
 Position
Staff Admin. Supv.
 Company
Amoco Prod. Company
 Date
3/20/90

SURVEYOR CERTIFICATION
 I hereby certify that the well location shown on this plat was plotted from field notes of actual surveys made by me or under my supervision, and that the same is true and correct to the best of my knowledge and belief.

Date Surveyed
March 15, 1990

Signature & Seal of Professional Surveyor
GARY D. VANN
 Registered Professional Land Surveyor
 New Mexico
7016
 Vann
 Gary
 Certified
7016

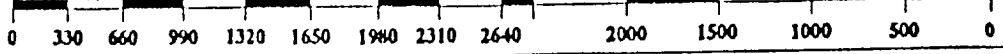

RECEIVED
MAY 10 1963
DISTRICT
OIL COMPANY

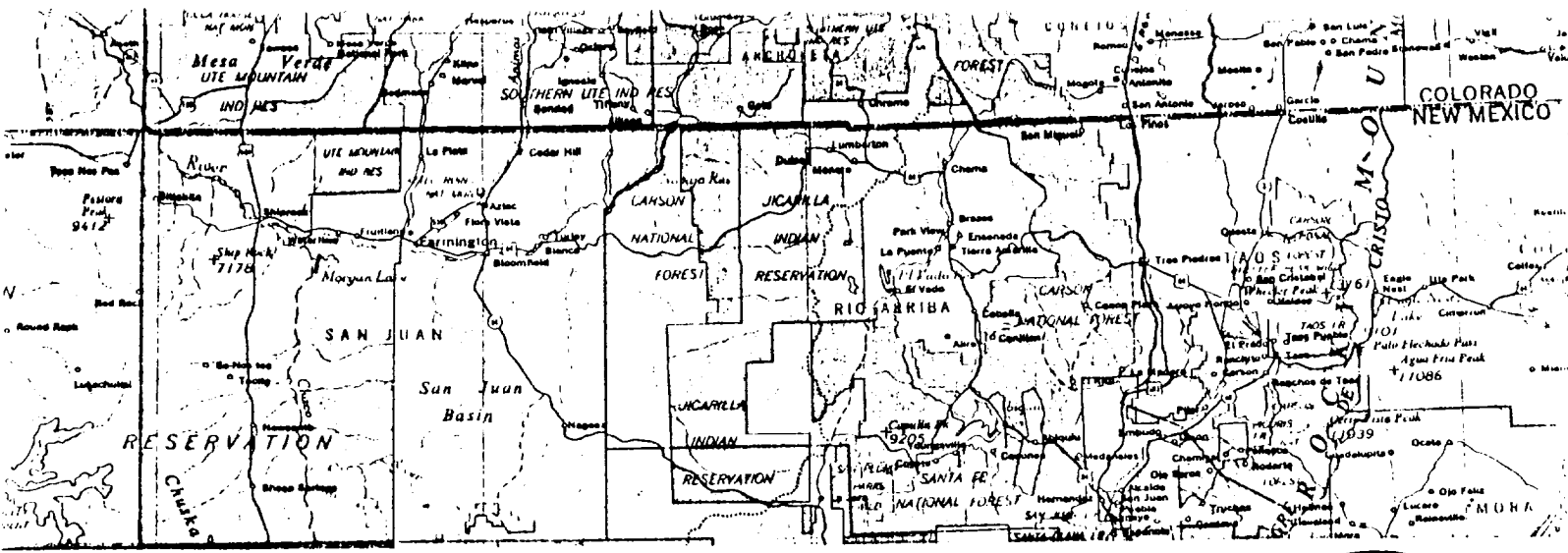

FLORANCE GAS COM /J/ # 3
 1770' F/NL 1180' F/EL
 SEC. 6, T30N, R9W, NMPM
 RAIL POINT: 160 mi. - Montrose, Co.
 MUD POINT: 18 mi. - Aztec, NM
 CEMENT POINT: 32 mi - Farmington, NM

PR 2

