

Submit to Appropriate
District Office
State Lease - 4 copies
Fee Lease - 3 copies

State of New Mexico
Energy, Minerals and Natural Resources Department

CA Approved
df
Q
Form C-102
Revised 1-1-89

OIL CONSERVATION DIVISION
P.O. Box 2088
Santa Fe, New Mexico 87504-2088

DISTRICT I
P.O. Box 1980, Hobbs, NM 88240

DISTRICT II
P.O. Drawer 503, Azusa, NM 88210

DISTRICT III
1000 Rio Arriba Rd., Azusa, NM 87410

WELL LOCATION AND ACREAGE DEDICATION PLAT

All Distances must be from the outer boundaries of the section

Operator Meridian Oil Inc.		Lease Quinn (SF-078511)	Well No. 338
U&M Layer N	Section 18	Township 31 North	Range 8 West
		County NMPM	San Juan
Actual Footage Location of Well: 975 feet from the South line and 925 feet from the West line			
Grounds Acreage 6054'	Provenning Formation Fruitland Coal	Basin	Dedicated Acreage 330.16 Acres

- Outline the acreage dedicated to the subject well by concrete posts or section marks on the plat below.
- If more than one lease is dedicated to the well, outline each and identify the ownership thereof (both as to working interest and royalty).
- If more than one lease of different ownership is dedicated to the well, have the interest of all owners been consolidated by commutation.

Consolidation, lease-acquiring, etc.?

Yes No If answer is "yes" type or commutation CA NM-86320

If answer is "no" list the owners and tract descriptions which have actually been commuted. (Use reverse side of this form if necessary.)

No allowance will be made to the well until all interests have been consolidated (by commutation, lease-acquiring, or otherwise) or until a non-standard unit, communiting such interest, has been approved by the Division.

RECEIVED

AUG 14 1991.

OIL CON. DIV
DIST. 3

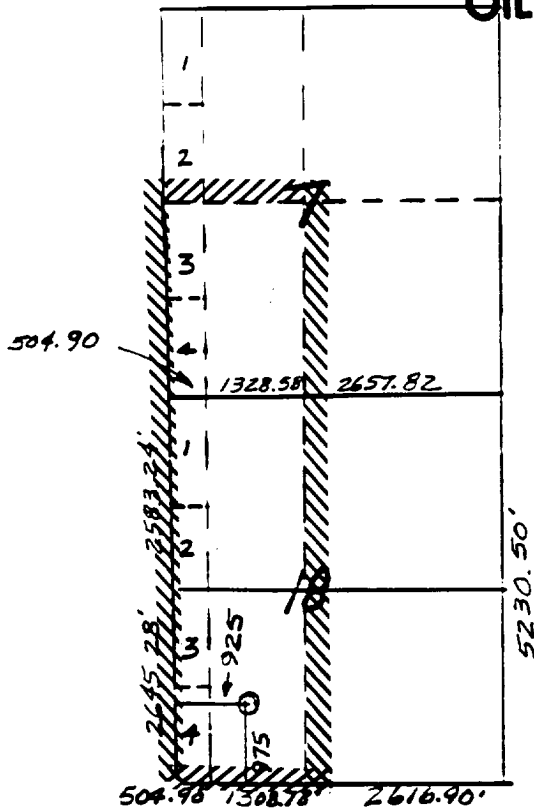

OPERATOR CERTIFICATION

I hereby certify that the information contained herein is true and accurate to the best of my knowledge and belief.

Peggy Bradford
Signature

Peggy Bradford

Printed Name

Regulatory Affairs

Position

Meridian Oil Inc.

Company

8-14-91

Date

SURVEYOR CERTIFICATION

I hereby certify that the well location shown on this plat was plotted from field notes of actual surveys made by me or under my supervision, and that the same is true and correct to the best of my knowledge and belief.

8-18-90

Date Surveyed

Signature of Surveyor
Professional Surveyor

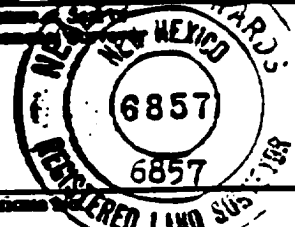

Neale C. Edwards