

UNITED STATES
DEPARTMENT OF THE INTERIOR
BUREAU OF LAND MANAGEMENT

APPLICATION FOR PERMIT TO DRILL, DEEPEN, OR PLUG BACK

1a. TYPE OF WORK DRILL <input checked="" type="checkbox"/> DEEPEN <input type="checkbox"/> PLUG BACK <input type="checkbox"/>		5. LEASE DESIGNATION AND SERIAL NO. SF-079004	
b. TYPE OF WELL OIL WELL <input type="checkbox"/> GAS WELL <input checked="" type="checkbox"/> OTHER <input type="checkbox"/> SINGLE ZONE <input checked="" type="checkbox"/> MULTIPLE ZONE <input type="checkbox"/>		6. IF INDIAN, ALLOTTEE OR TRIBE NAME	
2. NAME OF OPERATOR Phillips Petroleum Company		7. UNIT AGREEMENT NAME San Juan 32-8 Unit	
3. ADDRESS OF OPERATOR 300 W. Arrington, Suite 200, Farmington, N.M. 87401		8. FARM OR LEASE NAME	
4. LOCATION OF WELL (Report location clearly and in accordance with any State requirements.) At surface Unit A, 897' FNL & 1110' FEL At proposed prod. zone Unit A, 897' FNL & 1110' FEL		9. WELL NO. 222	
14. DISTANCE IN MILES AND DIRECTION FROM NEAREST TOWN OR POST OFFICE*		10. FIELD AND POOL, OR WILDCAT Basin Fruitland Coal Gas	
15. DISTANCE FROM PROPOSED* LOCATION TO NEAREST PROPERTY OR LEASE LINE, FT. (Also to nearest drig. unit line, if any) 897' FNL		11. SEC., T., R., M., OR BLK. AND SURVEY OR AREA A Sec. 9, T-31-N, R- 8-W	
16. NO. OF ACRES IN LEASE 1720 Ac		12. COUNTY OR PARISH San Juan	
17. NO. OF ACRES ASSIGNED TO THIS WELL 309 Ac E/2 of Section		13. STATE NM	
18. DISTANCE FROM PROPOSED LOCATION* TO NEAREST WELL, DRILLING, COMPLETED, OR APPLIED FOR, ON THIS LEASE, FT. 80' from #33		19. PROPOSED DEPTH 3471'	
20. ROTARY OR CABLE TOOLS Rotary		21. APPROX. DATE WORK WILL START* Upon Approval	
21. ELEVATIONS (Show whether DF, RT, GR, etc.) 6590' (GL Unprepared) This action is subject to technical and procedural review pursuant to 43 CFR 3165.3 and proposed drilling and cementing program		22. APPROX. DATE WORK WILL START* Upon Approval	

SIZE OF HOLE	SIZE OF CASING	WEIGHT PER FOOT	SETTING DEPTH	QUANTITY OF CEMENT
12-1/4"	9-5/8"	36#, K-55	250'	200 sxs, Circ to Surface
8-3/4"	7"	23#, K-55	3263'	600 sxs, Circ to Surface
6-1/8"	5-1/2"	15.5# or 23#	3163'-3471'	*

*If the coal is cleated a 5-1/2", 23#, P-110 liner will be run in the open hole without being cemented.

*If the coal is not cleated a 5-1/2", 15.5#, K-55 liner will be run, cemented with 100, sxs cement and the well fractured.

RECEIVED
JUN 26 1990
OIL CON. DIV.
DIST. 3

Mud Program and BOP Equipment: See Attached

IN ABOVE SPACE DESCRIBE PROPOSED PROGRAM: If proposal is to deepen or plug back, give data on present productive zone and proposed new productive zone. If proposal is to drill or deepen directionally, give pertinent data on subsurface locations and measured and true vertical depths. Give blowout preventer program, if any.

24.

SIGNED L.M. Sanders TITLE Supv. Regulatory Affairs DATE 5/21/90

(This space for Federal or State office use)

PERMIT NO. _____ APPROVAL DATE _____ APPROVED

APPROVED BY _____ TITLE _____ JUN 20 1990
CONDITIONS OF APPROVAL, IF ANY: _____ AREA MANAGER

*See Instructions On Reverse Side

Submit to Appropriate
District Office
State Lease - 4 copies
Fee Lease - 3 copies

State of New Mexico
Energy, Minerals and Natural Resources Department

OIL CONSERVATION DIVISION

P.O. Box 2088
Santa Fe, New Mexico 87504-2088

RECEIVED
MAIL ROOM
Form C-102
Revised 1-1-89

DISTRICT I
P.O. Box 1980, Hobbs, NM 88240

DISTRICT II
P.O. Drawer DD, Artesia, NM 88210

DISTRICT III
1000 Rio Brazos Rd., Aztec, NM 87410

WELL LOCATION AND ACREAGE DEDICATION PLAT

All Distances must be from the outer boundaries of the section

Operator PHILLIPS PETROLEUM			Lease SAN JUAN 32-8 UNIT		Well No. 222
Unit Letter A	Section 9	Township T.31 N.	Range R.8 W.	County SAN JUAN COUNTY	
Actual Footage Location of Well: 897 feet from the NORTH line and 1110 feet from the EAST line					
Ground level Elev. 6590	Producing Formation Fruitland	Pool Basin Fruitland Coal		Dedicated Acreage: 309 Acres	

- Outline the acreage dedicated to the subject well by colored pencil or hatchure marks on the plat below.
- If more than one lease is dedicated to the well, outline each and identify the ownership thereof (both as to working interest and royalty).
- If more than one lease of different ownership is dedicated to the well, have the interest of all owners been consolidated by communitization, unitization, force-pooling, etc?
☒ Yes ☐ No If answer is "yes" type of consolidation Unitization
If answer is "no" list the owners and tract descriptions which have actually been consolidated. (Use reverse side of this form if necessary.)
No allowable will be assigned to the well until all interests have been consolidated (by communitization, unitization, forced-pooling, or otherwise) or until a non-standard unit, eliminating such interest, has been approved by the Division.

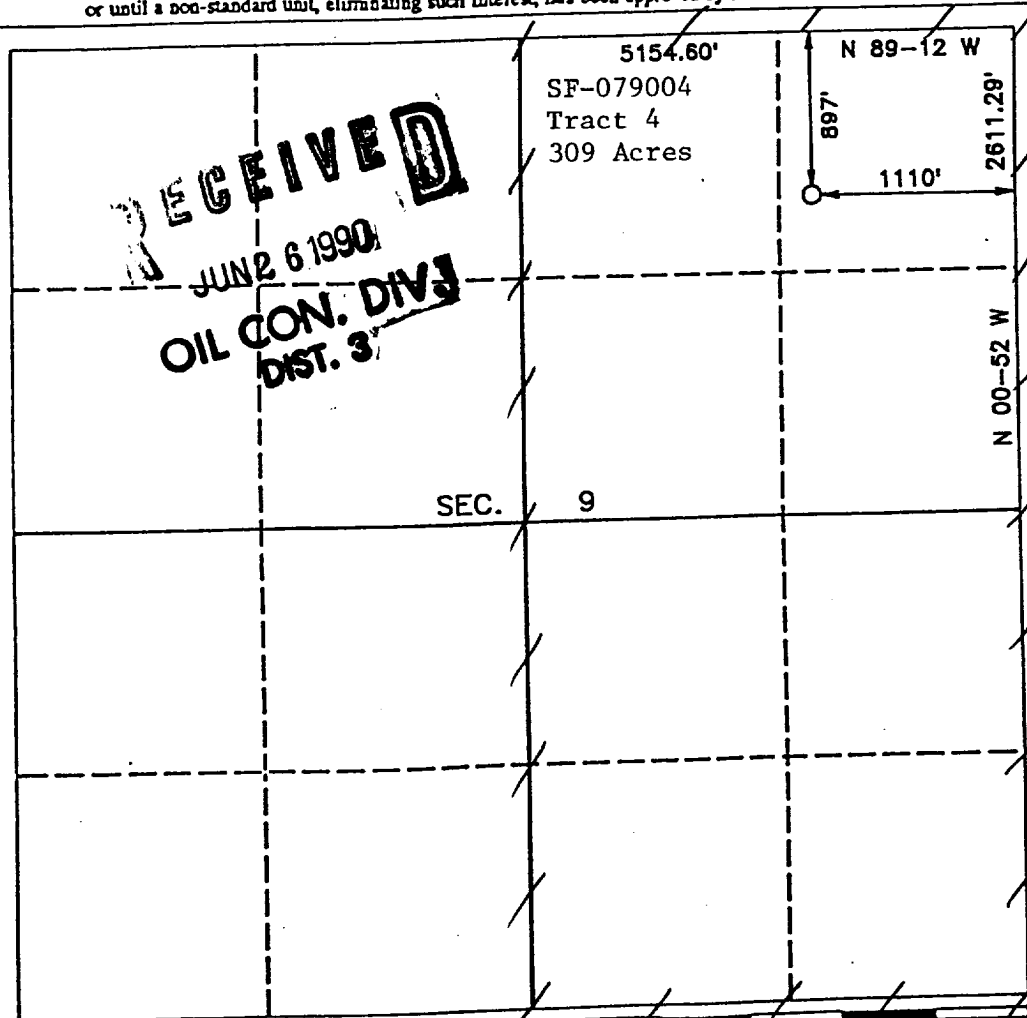

OPERATOR CERTIFICATION

I hereby certify that the information contained herein is true and complete to the best of my knowledge and belief.

Signature
L.M. Sanders
Printed Name
L.M. Sanders
Position
Supv. Regulatory Affairs
Company
Phillips Petroleum Co.
Date
5/24/90

SURVEYOR CERTIFICATION

I hereby certify that the well location shown on this plat was plotted from field notes of actual surveys made by me or under my supervision, and that the same is true and correct to the best of my knowledge and belief.

Date Surveyed
APR 16, 1990
Signature
R. Howard Daggett
Professional Surveyor
R. HOWARD DAGGETT
Certificate No.
9679
Registered Professional
Land Surveyor

