

Submit to Appropriate  
District Office  
State Lease - 6 copies  
Fee Lease - 5 copies

State of New Mexico  
Energy, Minerals and Natural Resources Department

Form C-101  
Revised 1-1-89

OIL CONSERVATION DIVISION

P.O. Box 2088  
Santa Fe, New Mexico 87504-2088

DISTRICT I  
P.O. Box 1980, Hobbs, NM 88240

DISTRICT II  
P.O. Drawer DD, Artesia, NM 88210

DISTRICT III  
1000 Rio Brazos Rd., Aztec, NM 87410

AFI NO. (assigned by OCD on New Wells)	30-045-27935
5. Indicate Type of Lease	STATE <input checked="" type="checkbox"/> FEE <input type="checkbox"/>
6. State Oil & Gas Lease No.	E-5113-21
7. Lease Name or Unit Agreement Name	San Juan 32-8 Unit SWD
8. Well No.	301
9. Pool name or Wildcat	SWD
Undesignated Morrison, Entrada	

APPLICATION FOR PERMIT TO DRILL, DEEPEN, OR PLUG BACK

1a. Type of Work:	DRILL <input checked="" type="checkbox"/> RE-ENTER <input type="checkbox"/> DEEPEN <input type="checkbox"/> PLUG BACK <input type="checkbox"/>
b. Type of Well:	OIL WELL <input type="checkbox"/> GAS WELL <input type="checkbox"/> OTHER <input checked="" type="checkbox"/> Salt Water Disposal
2. Name of Operator	Phillips Petroleum Company 17654
3. Address of Operator	300 W. Arrington, Suite 200, Farmington, NM 87401
4. Well Location	Unit Letter L : 1643 Feet From The South Line and 1006 Feet From The West Line
Section 16	Township 31N Range 8W NMPM San Juan County

10. Proposed Depth	9300 (±)
11. Formation	Morrison-Entrada
12. Rotary or C.T.	Rotary
13. Elevations (Show whether DF, RT, GR, etc.)	6621' GL (Unprepared)
14. Kind & Status Plug. Bond	Blanket
15. Drilling Contractor	Advise Later
16. Approx. Date Work will start	Upon Approval

PROPOSED CASING AND CEMENT PROGRAM					
SIZE OF HOLE	SIZE OF CASING	WEIGHT PER FOOT	SETTING DEPTH	SACKS OF CEMENT	EST. TOP
26"	20"	94#, H-40, ST&C	500'	1275 SX	Circ. to Surface
17-1/2"	13-3/8"	61#, K-55, ST&C	3800'	2450 SX	Circ. to Surface
12-1/4"	9-5/8"	40#, S-95, LT&C	3700'-6000'	700 SX	3700'
8-3/4"	7"	26#, N-80, LT&C	0 - 9300'	600 SX	5000'

APPROVAL EXPIRES 1-2-91  
UNLESS DRILLING IS COMMENCED.  
SPUD NOTICE MUST BE SUBMITTED  
WITHIN 10 DAYS.

RECEIVED

JUL 2 1990

OIL CON. DIV  
DIST. 2

Use Mud Additives as Required for Control.  
BOP Equipment: (See Fig. 7-9 or 7-10)

IN ABOVE SPACE DESCRIBE PROPOSED PROGRAM: IF PROPOSAL IS TO DEEPEN OR PLUG BACK, GIVE DATA ON PRESENT PRODUCTIVE ZONE AND PROPOSED NEW PRODUCTIVE ZONE. GIVE BLOWOUT PREVENTER PROGRAM, IF ANY.

I hereby certify that the information above is true and complete to the best of my knowledge and belief.

SIGNATURE [Signature] TITLE Supv. Regulatory Affairs DATE 7/2/90

TYPE OR PRINT NAME \_\_\_\_\_ TELEPHONE NO. \_\_\_\_\_

(This space for State Use)

APPROVED BY [Signature] TITLE DEPUTY OIL & GAS INSPECTOR, DIST. #3 DATE JUL 02 1990  
CONDITIONS OF APPROVAL, IF ANY:

SWD-412

Submit to Appropriate  
District Office  
State Lease - 4 copies  
Fee Lease - 3 copies

State of New Mexico  
Energy, Minerals and Natural Resources Department

Form C-102  
Revised 1-1-89

OIL CONSERVATION DIVISION

P.O. Box 2088  
Santa Fe, New Mexico 87504-2088

DISTRICT I  
P.O. Box 1980, Hobbs, NM 88240

DISTRICT II  
P.O. Drawer DD, Artesia, NM 88210

DISTRICT III  
1000 Rio Brazos Rd., Aztec, NM 87410

WELL LOCATION AND ACREAGE DEDICATION PLAT  
All Distances must be from the outer boundaries of the section

Operator <b>PHILLIPS PETROLEUM</b>		Lease <b>SAN JUAN 32-8 UNIT</b>		Well No. <b>SWD NO. 301</b>
Unit Letter <b>L</b>	Section <b>16</b>	Township <b>1.31 N.</b>	Range <b>R.8 W.</b>	County <b>SAN JUAN COUNTY</b>
Actual Footage Location of Well: <b>1643</b> feet from the <b>SOUTH</b> line and <b>1006</b> feet from the <b>WEST</b> line				
Ground level Elev. <b>6621</b>	Producing Formation <b>Morrison-Entrada</b>	Pool <b>Undesignated Morrison-Entrada</b>		Dedicated Acreage: <b>0</b> Acres

- Outline the acreage dedicated to the subject well by colored pencil or hatchure marks on the plat below.
- If more than one lease is dedicated to the well, outline each and identify the ownership thereof (both as to working interest and royalty).
- If more than one lease of different ownership is dedicated to the well, have the interest of all owners been consolidated by communitization, unitization, force-pooling, etc.?  
☐ Yes ☐ No If answer is "yes" type of consolidation \_\_\_\_\_  
If answer is "no" list the owners and tract descriptions which have actually been consolidated. (Use reverse side of this form if necessary.)  
No allowable will be assigned to the well until all interests have been consolidated (by communitization, unitization, forced-pooling, or otherwise) or until a non-standard unit, eliminating such interest, has been approved by the Division.

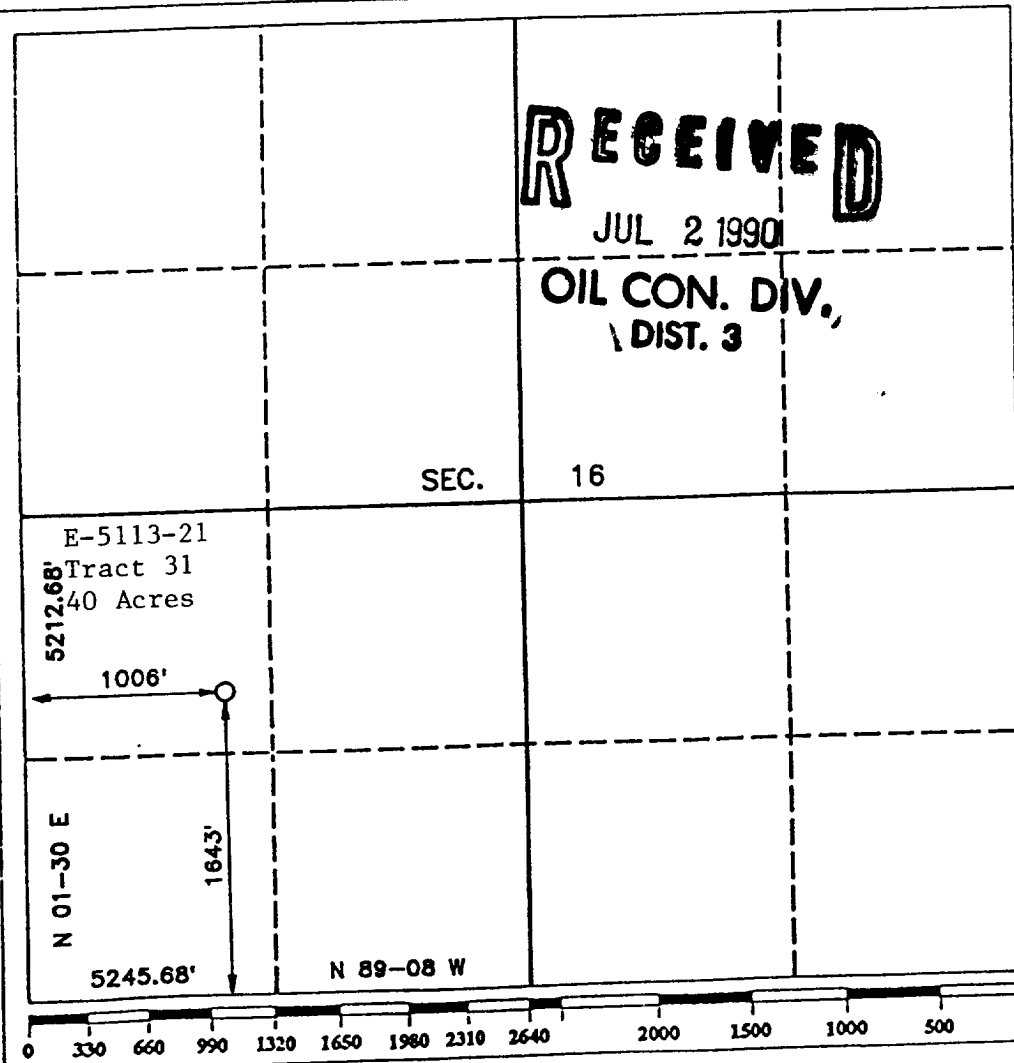

OPERATOR CERTIFICATION

I hereby certify that the information contained herein is true and complete to the best of my knowledge and belief.

Signature  
*L.M. Sanders*  
Printed Name  
**L.M. Sanders**  
Position  
**Supv. Regulatory Affairs**  
Company  
**Phillips Petroleum Co.**  
Date  
**July 2, 1990**

SURVEYOR CERTIFICATION

I hereby certify that the well location shown on this plat was plotted from field notes of actual surveys made by me or under my supervision, and that the same is true and correct to the best of my knowledge and belief.

Date Surveyed  
**JUNE 15, 1990**  
Signature of Professional Surveyor  
*R. Howard Daggett*  
**R. HOWARD DAGGETT**  
9878  
Certificate No. **9679**  
Registered Professional Land Surveyor