

UNITED STATES
DEPARTMENT OF THE INTERIOR
BUREAU OF LAND MANAGEMENT

30-045-28649

APPLICATION FOR PERMIT TO DRILL, DEEPEN, OR PLUG BACK

1a. TYPE OF WORK

DRILL ☒

DEEPEN ☐

PLUG BACK ☐

b. TYPE OF WELL

OIL
WELL ☐

GAS
WELL ☒

OTHER

Coal Seam

SINGLE
ZONE ☐

MULTIPLE
ZONE ☐

2. NAME OF OPERATOR

Amoco Production Company

ATTN: J. L. Hampton

3. ADDRESS OF OPERATOR

P. O. Box 800 Denver, Colorado 80201

4. LOCATION OF WELL (Report location clearly and in accordance with any State requirements.)

At surface

1580' FNL, 835' FEL SE/NE Unit H

At proposed prod. zone

same

14. DISTANCE IN MILES AND DIRECTION FROM NEAREST TOWN OR POST OFFICE*

21 miles from Bloomfield, NM

10. DISTANCE FROM PROPOSED*

LOCATION TO NEAREST

PROPERTY OR LEASE LINE, FT.

(Also to nearest drilg. unit line, if any)

990'

18. DISTANCE FROM PROPOSED LOCATION*

TO NEAREST WELL, DRILLING, COMPLETED,
OR APPLIED FOR, ON THIS LEASE, FT.

16. NO. OF ACRES IN LEASE

2549.29

19. PROPOSED DEPTH

3144' TD

17. NO. OF ACRES ASSIGNED
TO THIS WELL

287.18 acres E/2

20. ROTARY OR CARLIS TOOLS

Rotary

21. ELEVATIONS (Show whether DF, RT, GR, etc.)

6217' GR

22. APPROX. DATE WORK WILL START*

As soon as permitted

23.

This action is subject to technical and
procedural review and approval by the
Bureau of Land Management and the
Department of the Interior.

SIZE OF HOLE	SIZE OF CASING	WEIGHT PER FOOT	SETTING DEPTH
12 1/4"	8 5/8"	24#	250'
7 7/8"	5 1/2"	17#	3144" (TD)

DRILLING OPERATIONS AUTHORIZED ARE
SUBJECT TO COMPLIANCE WITH ATTACHED
GENERAL REQUIREMENTS

QUANTITY OF CEMENT

250 cf (cement to surface)

880 cf (cement to surface)

Notice of Staking was submitted: 4/11/90

Lease Description:

T30N-R8W

Sec. 26: E/2, SW/4NW/4, E/2NW/4, SW/4

Sec. 27: W/2NE/4, SE/4NE/4, NW/4, S/2

Sec. 28: All

Sec. 29: Lots 1,8

Sec. 33: All

Sec. 14: Lots 3-6, 11-14

Sec. 19: Lots 1,2,5-9, E/2NW/4

Sec. 20: Lot 2

Sec. 30: Lots 6,8,9,12,13

IN ADDITION, DRILLING PROPOSED PROGRAM: If proposal is to deepen or plug back, give data on present productive zone and proposed new productive zone. If proposal is to drill or deepen directionally, give pertinent data on subsurface locations and measured and true vertical depths. Give blowout preventer program, if any.

24.

J. L. Hampton

SIGNED

J. L. Hampton

TITLE Sr. Staff Admin. Supv.

DATE

2/6/92

(This space for Federal or State office use)

PERMIT NO.

APPROVAL DATE

APPROVED
AS AMENDED

APPROVED BY

CONDITIONS OF APPROVAL, IF ANY:

TITLE

FEB 13 1992

AREA MANAGER

*See Instructions On Reverse Side

1980

100-449494
100-449495

Submit to Appropriate
District Office
State Lease - 4 copies
Fee Lease - 3 copies

State of New Mexico
Energy, Minerals and Natural Resources Department

Form C-102
Revised 1-1-89

OIL CONSERVATION DIVISION

P.O. Box 2088
Santa Fe, New Mexico 87504-2088

DISTRICT I
P.O. Box 1980, Hobbs, NM 88240

DISTRICT II
P.O. Drawer DD, Artesia, NM 88210

DISTRICT III
1000 Rio Brazos Rd., Aztec, NM 87410

WELL LOCATION AND ACREAGE DEDICATION PLAT

All Distances must be from the outer boundaries of the section

Operator AMOCO PRODUCTION COMPANY			Lease FLORANCE GAS COM /F/		Well No. # 1
Unit Letter H	Section 29	Township 30 NORTH	Range 8 WEST	County SAN JUAN	

Actual Footage Location of Well:

1580 feet from the NORTH line and		835 feet from the EAST line	
Ground level Elev. 6217	Producing Formation Fruitland Coal	Pool Basin Fruitland Coal Gas	Dedicated Acreage: 287.13

- Outline the acreage dedicated to the subject well by colored pencil or hatchure marks on the plat below.
- If more than one lease is dedicated to the well, outline each and identify the ownership thereof (both as to working interest and royalty).
- If more than one lease of different ownership is dedicated to the well, have the interest of all owners been consolidated by communitization, unitization, force-pooling, etc.?
☐ Yes ☐ No If answer is "yes" type of consolidation _____
If answer is "no" list the owners and tract descriptions which have actually been consolidated. (Use reverse side of this form if necessary).
No allowable will be assigned to the well until all interests have been consolidated (by communitization, unitization, forced-pooling, or other) or until a non-standard unit, eliminating such interest, has been approved by the Division.

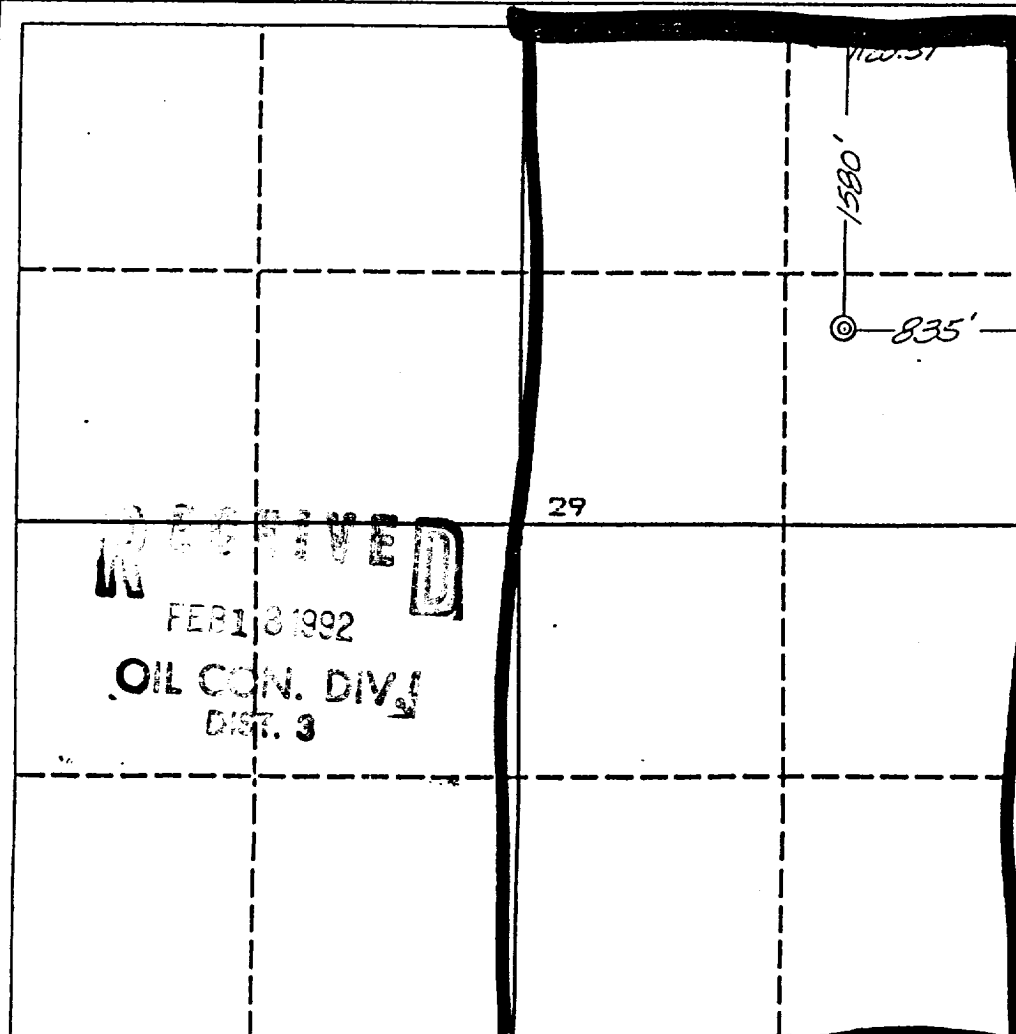

OPERATOR CERTIFICATION

I hereby certify that the information contained herein is true and complete to the best of my knowledge and belief.

Signature

Printed Name

JL Hampton

Position

Sr Staff Admin Supr

Company

Amoco Pro

Date

5-15-90

SURVEYOR CERTIFICATION

I hereby certify that the well location shown on this plat was plotted from field notes of actual surveys made by me or under my supervision, and that the same is true and correct to the best of my knowledge and belief.

Date Surveyed

May 9, 1990

Signature & Seal of
Professional Surveyor

GARY D. VANN
NEW MEXICO
REGISTERED
7016
PROFESSIONAL LAND SURVEYOR

Amoco proposes to drill the well to further develop the Fruitland Coal reservoir. The well will be drilled to the surface casing point using native mud. The well will then be drilled to the total depth with a non-dispersed mud system. The attached modified 12" 3000 psi blowout preventer will be used (please see attached BOP information). The well will be completed in the Fruitland Coal with a fracture stimulation.

Quantity	Size	Weight	Description	Cementing Program
<u>SURFACE CASING</u>				
250'	8-5/8"	24#	K55 ST&C	250 cf Class B, 2% CaCl ₂ 15.6 ppg
<u>INTERMEDIATE STRING</u>				
3144'	5.5"	17#	K55 ST&C	880' cf Class B, 65:35:6 10% salt, .25% dispersant 13.1 ppg 118 cf Class B, 2% CaCl ₂ 15.6 ppg

The above casing design is based upon a 11.0#/gal mud weight.

EVALUATION

The log surveys (FDC/GR/CAL, Microlog) will be run per attached drilling and completion program.

