

UNITED STATES
DEPARTMENT OF THE INTERIOR
BUREAU OF LAND MANAGEMENT

APPLICATION FOR PERMIT TO DRILL, DEEPEN, OR PLUG BACK

1a. TYPE OF WORK DRILL <input checked="" type="checkbox"/> DEEPEN <input type="checkbox"/> PLUG BACK <input type="checkbox"/>		5. LEASE DESIGNATION AND SERIAL NO. SI-080597		
b. TYPE OF WELL OIL WELL <input type="checkbox"/> GAS WELL <input checked="" type="checkbox"/> OTHER Coal Seam SINGLE ZONE <input checked="" type="checkbox"/> MULTIPLE ZONE <input type="checkbox"/>		6. IF INDIAN, ALLOTTEE OR TRIBE NAME		
2. NAME OF OPERATOR Amoco Production Company ATTN: J. L. Hampton		7. UNIT AGREEMENT NAME		
3. ADDRESS OF OPERATOR P. O. Box 800 Denver, Colorado 80201		8. FARM OR LEASE NAME Florance Gas Com /F/		
4. LOCATION OF WELL (Report location clearly and in accordance with any State requirements.) At surface 1.580 1.560 ' FNL, 990' FEL SE/NE 835 At proposed prod. zone same		9. WELL NO. 1		
14. DISTANCE IN MILES AND DIRECTION FROM NEAREST TOWN OR POST OFFICE 3 21 miles from Bloomfield, NM		10. FIELD AND POOL, OR WILDCAT Basin Fruitland Coal Gas		
15. DISTANCE FROM PROPOSED LOCATION TO NEAREST PROPERTY OR LEASE LINE, FT. (Also to nearest drlg. unit line, if any) 990'		11. SEC., T., R., M., OR BLK. AND SURVEY OR AREA Sec. 29, T30N-R8W		
16. NO. OF ACRES IN LEASE 3823.27 2549.29		12. COUNTY OR PARISH San Juan		
17. NO. OF ACRES ASSIGNED TO THIS WELL 220 acres E/2 287.18		13. STATE NM		
18. DISTANCE FROM PROPOSED LOCATION TO NEAREST WELL, DRILLING COMPLETED, OR APPLIED FOR, ON THIS LEASE, FT.		19. PROPOSED DEPTH 3144' TD		
20. ROTARY OR CABLE TOOLS Rotary		21. APPROX. DATE WORK WILL START As soon as permitted		
21. ELVATIONS (Show whether DF, RT, GR, etc.) 6217 6218 GR This action is subject to technical and procedural review pursuant to 43 CFR 3165.3 and appeal pursuant to 43 CFR 3165.4		22. APPROX. DATE WORK WILL START As soon as permitted		
23. PROPOSED CASING AND CEMENTING PROGRAM		24. QUANTITY OF CEMENT		
SIZE OF HOLE	SIZE OF CASING	WEIGHT PER FOOT	SETTING DEPTH	QUANTITY OF CEMENT
12 1/4"	8 5/8"	24#	250'	250 cf (cement to surface)
7 7/8"	5 1/2"	17#	3144' (TD)	880 cf (cement to surface)

Notice of Staking was submitted: 4/11/90

Lease Description:

T30N-R8W:

Sec. 26: E/2, SW/4NW/4, E/2NW/4, SW/4
Sec. 27: W/2NE/4, SE/4NE/4, NW/4, S/2
Sec. 28: ALL
Sec. 29: Lots 1, 8
Sec. 33: ALL
Sec. 14: Lots 3-6, 11-14
Sec. 19: Lots 1, 2, 5-9, E/2NW/4
Sec. 20: Lot 2
Sec. 30: Lots 6, 8, 9, 12, 13

IN ABOVE SPACE DESCRIBE PROPOSED PROGRAM: If proposal is to deepen or plug back, give data on present productive zone and proposed new productive zone. If proposal is to drill or deepen directionally, give pertinent data on subsurface locations and measured and true vertical depths. Give blowout preventer program, if any.

24. SIGNED J.L. Hampton J.L. Hampton/TUB TITLE Sr. Staff Admin. Supv. DATE 4/20/90
(This space for Federal or State office use)

PERMIT NO. APPROVAL DATE

APPROVED BY TITLE

APPROVED
AS AMENDED
JUL 30 1990
Ken Townsend
FOR AREA MANAGER

*See Instructions On Reverse Side

Submit to Appropriate
District Office
State Lease - 4 copies
Fee Lease - 3 copies

State of New Mexico
Energy, Minerals and Natural Resources Department

Form C-102
Revised 1-1-89

OIL CONSERVATION DIVISION

DISTRICT I
P.O. Box 1980, Hobbs, NM 88240

P.O. Box 2088

Santa Fe, New Mexico 87504-2088

DISTRICT II
P.O. Drawer DD, Artesia, NM 88210

DISTRICT III
1000 Rio Brazos Rd., Aztec, NM 87410

WELL LOCATION AND ACREAGE DEDICATION PLAT

All Distances must be from the outer boundaries of the section

Operator AMOCO PRODUCTION COMPANY			Lease FLORANCE GAS COM /F/		
Unit Letter H	Section 29	Township 30 NORTH	Range 8 WEST	County NMPM	Well No. # 1
Actual Footage Location of Well: 1580 feet from the NORTH line and 835 feet from the EAST line					
Ground level Elev. 6217	Producing Formation Fruitland Coal		Pool Basin Fruitland Coal Gas		Dedicated Acreage: E/2 287.13 Acres

- Outline the acreage dedicated to the subject well by colored pencil or hachure marks on the plat below.
- If more than one lease is dedicated to the well, outline each and identify the ownership thereof (both as to working interest and royalty).
- If more than one lease of different ownership is dedicated to the well, have the interest of all owners been consolidated by communization, unitization, force-pooling, etc.?
☐ Yes ☐ No If answer is "yes" type of consolidation _____
If answer is "no" list the owners and tract descriptions which have actually been consolidated. (Use reverse side of this form if necessary). _____
No allowable will be assigned to the well until all interests have been consolidated (by communization, unitization, forced-pooling, or otherwise) or until a non-standard unit, eliminating such interest, has been approved by the Division.

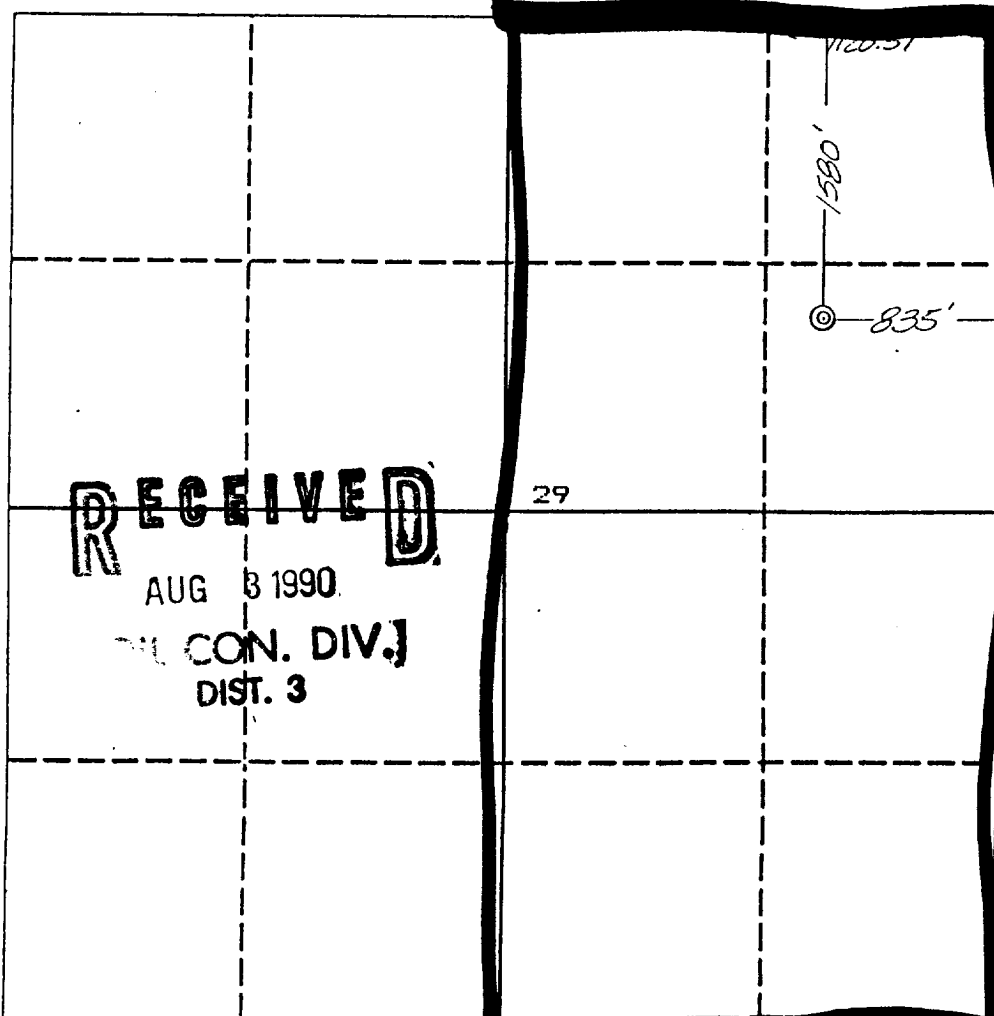

RECEIVED
AUG 8 1990
OIL CON. DIV.
DIST. 3

OPERATOR CERTIFICATION

I hereby certify that the information contained herein is true and complete to the best of my knowledge and belief.

Signature

Printed Name

Position

Company

Date

SURVEYOR CERTIFICATION

I hereby certify that the well location shown on this plat was plotted from field notes of actual surveys made by me or under my supervision, and that the same is true and correct to the best of my knowledge and belief.

Date Surveyed

Signature & Seal of
Professional Surveyor

Gary

Certification No.
7016

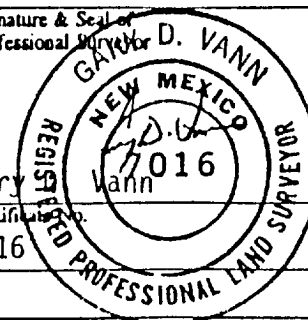

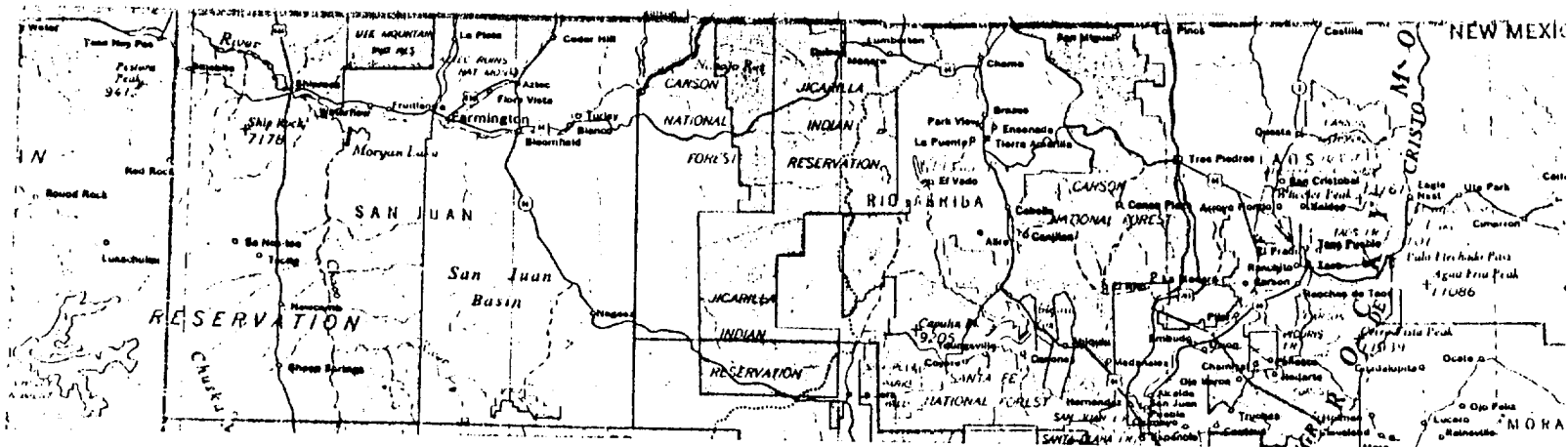

FLORANCE GAS COM /F/ # 1
 1580' F/NL 835' F/EL
 SEC. 29, T30N, R8W, NMPM
 RAIL POINT:
 MUD POINT:
 CEMENT POINT:

