

30-045-28096

UNITED STATES
DEPARTMENT OF THE INTERIOR
BUREAU OF LAND MANAGEMENT

APPLICATION FOR PERMIT TO DRILL, DEEPEN, OR PLUG BACK

1a. TYPE OF WORK DRILL	5. LEASE NUMBER SF-080376
1b. TYPE OF WELL GAS	6. IF INDIAN, ALL. OR TRIBE NAME
2. OPERATOR MERIDIAN OIL INC.	7. UNIT AGREEMENT NAME SAN JUAN 32-9 UNIT
3. ADDRESS & PHONE NO. OF OPERATOR P O BOX 4289 FARMINGTON, NM 87499	8. FARM OR LEASE NAME SAN JUAN 32-9 UNIT
4. LOCATION OF WELL 1763' FSL 1134' FWL	9. WELL NO. 107
10. FIELD, POOL, OR WILDCAT UNDESIGNATED PICTURED CLIFFS	11. SEC. T. R. M OR BLK. SEC. 9 T31N R09W NMPM
14. DISTANCE IN MILES FROM NEAREST TOWN 16 MILES FROM AZTEC	12. COUNTY SAN JUAN
	13. STATE NM
15. DISTANCE FROM PROPOSED LOCATION 1134' TO NEAREST PROPERTY OR LEASE LINE.	16. ACRES IN LEASE 17. ACRES ASSIGNED TO WELL 157.01
18. DISTANCE FROM PROPOSED LOCATION TO NEAREST WELL DR. 900' COMPL., OR APPLIED FOR ON THIS LEASE.	19. PROPOSED DEPTH 20. ROTARY OR CABLE TOOLS 3674' ROTARY
<small>DRILLING OPERATIONS AUTHORIZED ARE SUBJECT TO COMPLIANCE WITH ATTACHED "GENERAL REQUIREMENTS"</small>	
21. ELEVATIONS (DF, FT, GR, ETC.) 6661' GL	22. APPROX. DATE WORK WILL START

23. PROPOSED CASING AND CEMENTING PROGRAM

*SEE OPERATIONS PLAN

RECEIVED

AUG 13 1990

24. AUTHORIZED BY: *[Signature]*
REG. DRILLING ENGR.

OIL CON. DIV.
DIST. 3

7/27/90
DATE

PERMIT NO. _____ APPROVAL DATE _____

APPROVED BY _____ TITLE _____ DATE _____

NOTE: THIS FORMAT IS ISSUED IN LIEU OF US BLM FORM 3160-2.

NMOCD

[Signature]
AREA MANAGER

Submit to Appropriate
District Office
State Lease - 4 copies
Fee Lease - 3 copies

State of New Mexico
Energy, Minerals and Natural Resources Department

Form C-102
Revised 1-1-89

OIL CONSERVATION DIVISION

P.O. Box 2088

Santa Fe, New Mexico 87504-2088

DISTRICT I

P.O. Box 1980, Hobbs, NM 88240

DISTRICT II

P.O. Drawer DD, Artesia, NM 88210

DISTRICT III

1000 Rio Brazos Rd., Aztec, NM 87410

WELL LOCATION AND ACREAGE DEDICATION PLAT

All Distances must be from the outer boundaries of the section

Operator Meridian Oil Inc.			Lease SAN JUAN 32-9 UNIT		Well No. # 107
Utm Letter N	Section 9	Township 31 NORTH	Range 9 WEST	County SAN JUAN	
Actual Footage Location of Well: 1763 feet from the SOUTH line and 1134 feet from the WEST line					
Ground level Elev. 6661	Producing Formation Pictured Cliffs		Pool Blanco	Dedicated Acreage: 157.01 Acres	

1. Outline the acreage dedicated to the subject well by colored pencil or hatchure marks on the plat below.

2. If more than one lease is dedicated to the well, outline each and identify the ownership thereof (both as to working interest and royalty).

3. If more than one lease of different ownership is dedicated to the well, have the interest of all owners been consolidated by communitization, unitization, force-pooling, etc.?

☐ Yes ☐ No If answer is "yes" type of consolidation unitization

If answer is "no" list the owners and tract descriptions which have actually been consolidated. (Use reverse side of this form if necessary.)

No allowable will be assigned to the well until all interests have been consolidated (by communitization, unitization, forced-pooling, or otherwise) or until a non-standard unit, eliminating such interest, has been approved by the Division.

OPERATOR CERTIFICATION

I hereby certify that the information contained herein is true and complete to the best of my knowledge and belief.

Peggy Bradfield
Signature

Peggy Bradfield

Printed Name
Regulatory Affairs

Position
Meridian Oil Inc.

Company
7-18-90

Date

SURVEYOR CERTIFICATION

I hereby certify that the well location shown on this plat was plotted from field notes of actual surveys made by me or under my supervision, and that the same is true and correct to the best of my knowledge and belief.

Date Surveyed
March 17, 1990

Signature & Seal of
Professional Surveyor
D. VANN
7016
Gary Vann
7016
NEW MEXICO
REGISTERED PROFESSIONAL LAND SURVEYOR

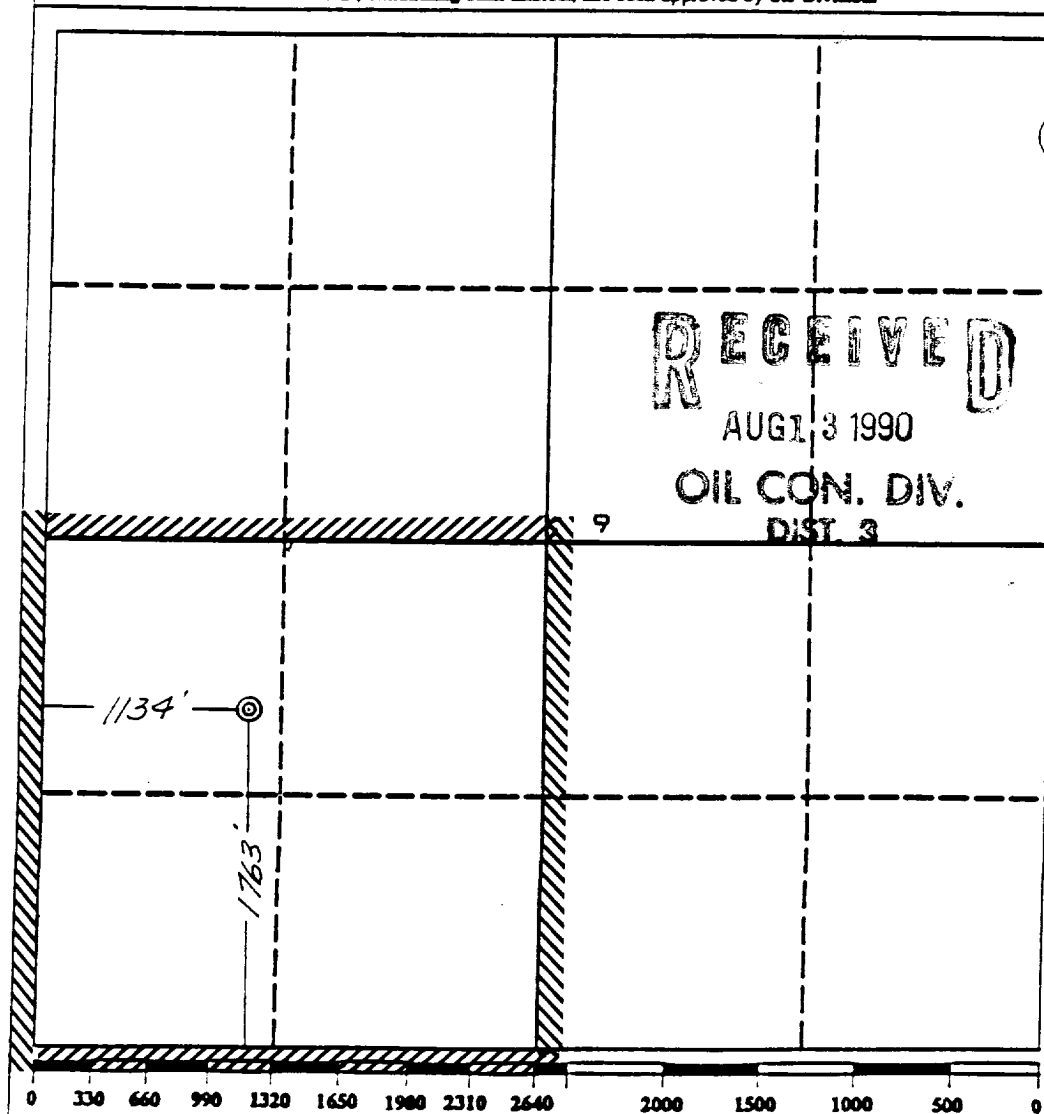

Well Name: 107 SAN JUAN 32-9 UNIT
 Sec. 9 T31N R09W
 UNDESIGNATED PICTURED CLIFFS

1763'FSL 1134'FWL
 SAN JUAN NEW MEXICO
 Elevation 6661'GL

Formation tops: Surface- SAN JOSE
 Ojo Alamo- 2165
 Kirtland- 2218
 Fruitland- 3152
 Fruitland Coal Base- 3519
 Pictured Cliffs- 3524

Total Depth- 3674

Logging Program: Mud logs from 3152 to total depth.

Mud Program:	Interval	Type	Weight	Visc.	Fl. Loss
	0 - 200	Spud	8.4 - 8.9	40-50	no contro
	200 - 3674	Non-dispersed	8.4 - 9.5	30-60	no contro

Casing Program:	Hole Size	Depth Interval	Csg. Size	Weight	Grade
	12 1/4"	0 - 200	8 5/8"	24.0#	K-40
	7 7/8"	0 - 3674	4 1/2"	10.0#	K-55
Tubing Program:		0 - 3674	2 3/8"	4.7#	J-55

Float Equipment: 8 5/8" surface casing - saw tooth guide shoe. Centralizers will be run in accordance with Onshore Order #2.

4 1/2" production casing - float shoe on bottom. Three centralizers run every other joint above shoe. Two turbolizing type centralizers - one below and one into the base of the Ojo Alamo @ 2218'. Standard centralizers thereafter every fourth joint up to the base of the surface pipe.

Wellhead Equipment: 8 5/8" x 4 1/2" x 2 3/8" x 11" 3000 psi xmas tree assembly

Cementing:

8 5/8" surface casing - cement with 211 sacks of class "B" cement with 1/4# flocele/sack and 3% calcium chloride (248 cu ft. of slurry, 200% excess to circulate to surface). WOC 12 hours. Test casing to 600 psi for 30 minutes.

4 1/2" production casing - lead with 810 sacks of 65/35 class "B" poz with 6% gel, 2% calcium chloride and 1/2 cu.ft. Perlite/sack (10.3 gallons of water/sack) tail with 100 sacks of class "B" with 2% calcium chloride. 1681 cu ft. of slurry, 100% excess to circulate to surface. If hole conditions permit, a 600 ft spacer will be run ahead of the cement slurry to avoid mud contamination of the cement. WOC 12 hours. If cement does not circulate to surface, a temperature log will be run after 8 hours to determine TOC.

