

SUBMIT IN TRIPLICATE*

(Other instructions on
reverse side)

Form approved.
Budget Bureau No. 1004-0136
Expires August 31, 1985

UNITED STATES
DEPARTMENT OF THE INTERIOR

BUREAU OF LAND MANAGEMENT

APPLICATION FOR PERMIT TO DRILL, DEEPEN, OR PLUG BACK

1a. TYPE OF WORK
DRILL ☒ DEEPEN ☐ PLUG BACK ☐
b. TYPE OF WELL
OIL WELL ☐ GAS WELL ☒ OTHER ☐ SINGLE ZONE ☐ MULTIPLE ZONE ☐
2. NAME OF OPERATOR
Meridian Oil Inc.
Union Texas Petroleum Corp.
3. ADDRESS OF OPERATOR
4289 Farmington, NM 87409
P.O. Box 2120 Houston, TX 77252-2120
4. LOCATION OF WELL (Report location clearly and in accordance with any State requirements.)*
At surface
1030 FNL & 1705 FEL, Unit E
At proposed prod. zone

5. LEASE DESIGNATION AND SERIAL NO.
SF-078505
6. IF INDIAN, ALLOTTEE OR TRIBE NAME
7. UNIT AGREEMENT NAME
8. FARM OR LEASE NAME
Seymour
9. WELL NO.
723
10. FIELD AND POOL, OR WILDCAT
Basin FRT Coal
11. SEC., T., R., M., OR BLK.
AND SURVEY OR AREA
Sec. 25-31N-9W
12. COUNTY OR PARISH
San Juan
13. STATE
NM

14. DISTANCE IN MILES AND DIRECTION FROM NEAREST TOWN OR POST OFFICE*
14 miles East of Aztec, NM
15. DISTANCE FROM PROPOSED*
LOCATION TO NEAREST
PROPERTY OR LEASE LINE, FT.
Also to nearest drilg. unit line, if any) 1030
16. NO. OF ACRES IN LEASE
2348.80
17. NO. OF ACRES ASSIGNED
TO THIS WELL
E 320.00
18. DISTANCE FROM PROPOSED LOCATION*
TO NEAREST WELL, DRILLING, COMPLETED,
OR APPLIED FOR, ON THIS LEASE, FT. 3200
19. PROPOSED DEPTH
3025 2813
20. ROTARY OR CABLE TOOLS
Rotary
21. ELEVATIONS (Show whether DF, RT, GR, etc.)
5985 GR
22. APPROX. DATE WORK WILL START*
5-1-90

DRILLING OPERATIONS AUTHORIZED ARE
SUBJECT TO COMPLIANCE WITH ATTACHED

"GENERAL REQUIREMENTS"

PROPOSED CASING AND CEMENTING PROGRAM

This action is subject to technical and
procedural review pursuant to 43 CFR 3165.3
and appeal pursuant to 43 CFR 3165.4.

SIZE OF HOLE	SIZE OF CASING	WEIGHT PER FOOT	SETTING DEPTH	
12 1/4	9 5/8	36#	350	210
8 3/4	7	23#	3025 2503	236
6 1/4	5 1/2	15.5	2453 - 2813	None

We propose to drill to 3025 in the Fruitland Coal formation according to
8 point drilling plan adn surface use plan.

RECEIVED
SEP 14 1990
OIL CON. DIV.
DIST. 1

IN ABOVE SPACE DESCRIBE PROPOSED PROGRAM: If proposal is to deepen or plug back, give data on present productive zone and proposed new productive zone. If proposal is to drill or deepen directionally, give pertinent data on subsurface locations and measured and true vertical depths. Give blowout preventer program, if any.

24. SIGNED Sam White TITLE Reg. Permit Coord. DATE 11/16/89
(This space for Federal or State office use)

PERMIT NO. _____ APPROVAL DATE _____

APPROVED BY _____ TITLE _____ DATE _____
CONDITIONS OF APPROVAL, IF ANY:

*See Instructions On Reverse Side

UNITED STATES
DEPARTMENT OF THE INTERIOR
BUREAU OF LAND MANAGEMENT

SUNDRY NOTICES AND REPORTS ON WELLS

1. TYPE OF WELL GAS		5. LEASE NUMBER SF-078505	
2. OPERATOR MERIDIAN OIL INC.		6. IF INDIAN, ALL. OR TRIBE NAME	
3. ADDRESS & PHONE NO. OF OPERATOR P O BOX 4289 FARMINGTON, NM 87499		7. UNIT AGREEMENT NAME	
4. LOCATION OF WELL 1030'FNL 1705'FEL		8. FARM OR LEASE NAME SEYMOUR	
		9. WELL NO. 723	
		10. FIELD, POOL, OR WILDCAT BASIN FRUITLAND COAL	
		11. SEC. T. R. M OR BLK. SEC. 25 T31N R09W NMPM	
14. PERMIT NO.	15. ELEVATIONS 5985'GL	12. COUNTY SAN JUAN	13. STATE NM
16. SUBSEQUENT REPORT OF: Amended Application for Permit to Drill			
17. Describe proposed or completed operations			

Reference is made to Union Texas Petroleum's Application for Permit to Drill the Seymour 25 #1 submitted 11-16-89.

Meridian Oil Inc. will operate and drill this well as the Seymour #723 at 1030'FNL and 1705'FEL of Section 25 of Township T31N and Range R09W.

Submitted for review:

- C102
- Operations Plan
- BOP Diagrams
- Location Laydown
- Cut and Fill Diagram
- Facilities Diagram

RECEIVED
SEP 14 1990
OIL CON. 1
DIST. 3

18. AUTHORIZED BY: [Signature]
REGULATORY AFFAIRS

7-10-90
DATE

NOTE: THIS FORMAT IS ISSUED IN LIEU OF US BLM FORM 3160-5.

=====
(This space for Federal or State office use)

APPROVED BY _____ TITLE _____ DATE _____
CONDITION OF APPROVAL, IF ANY: NMOC

Submit to Appropriate
District Office
State Lease - 4 copies
Fee Lease - 3 copies

State of New Mexico
Energy, Minerals and Natural Resources Department

Form C-102
Revised 1-1-89

OIL CONSERVATION DIVISION

P.O. Box 2088

Santa Fe, New Mexico 87504-2088

DISTRICT I

P.O. Box 1980, Hobbs, NM 88240

DISTRICT II

P.O. Drawer DD, Artesia, NM 88210

DISTRICT III

1000 Rio Brazos Rd., Aztec, NM 87410

WELL LOCATION AND ACREAGE DEDICATION PLAT

All Distances must be from the outer boundaries of the section

Operator Meridian Oil Inc.			Lease Seymour (SF-078505)		Well No. 723
Unit Letter B	Section 25	Township 31 North	Range 9 West	County NMPM San Juan	
Actual Footage Location of Well: 1030 feet from the North line and 1705 feet from the East line					
Ground level Elev. 5985'	Producing Formation Fruitland Coal		Pool Basin		Dedicated Acreage: 320.00 Acres

1. Outline the acreage dedicated to the subject well by colored pencil or hatchure marks on the plat below.
2. If more than one lease is dedicated to the well, outline each and identify the ownership thereof (both as to working interest and royalty).
3. If more than one lease of different ownership is dedicated to the well, have the interest of all owners been consolidated by communitization, unitization, force-pooling, etc.?
☐ Yes ☐ No If answer is "yes" type of consolidation _____
If answer is "no" list the owners and tract descriptions which have actually been consolidated. (Use reverse side of this form if necessary.)
No allowable will be assigned to the well until all interests have been consolidated (by communitization, unitization, forced-pooling, or otherwise) or until a non-standard unit, eliminating such interest, has been approved by the Division.

OPERATOR CERTIFICATION

I hereby certify that the information contained herein is true and complete to the best of my knowledge and belief.

Signature *Peggy Bradfield*

Printed Name **Peggy Bradfield**

Position **Regulatory Affairs**

Company **Meridian Oil Inc.**

Date **7-10-90**

SURVEYOR CERTIFICATION

I hereby certify that the well location shown on this plat was plotted from field notes of actual surveys made by me or under my supervision, and that the same is true and correct to the best of my knowledge and belief.

Date Surveyed **7-2-90**

Signature *Neale G. Edwards*

Professional Surveyor
NEW MEXICO
6857
REGISTERED LAND SURVEYOR

Certificate No. **6857**
Neale G. Edwards

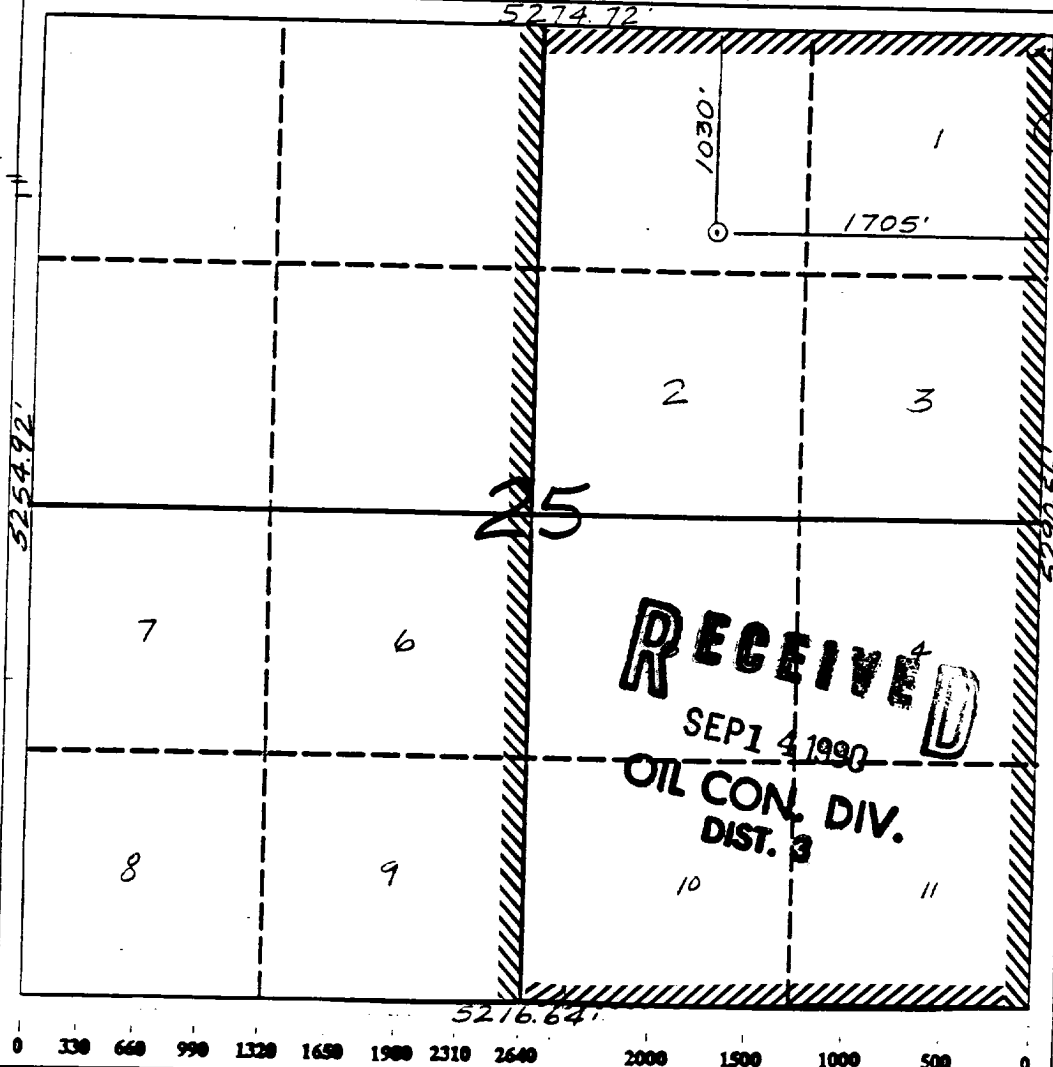

Well Name: 723 SEYMOUR
 Sec. 25 T31N R09W
 BASIN FRUITLAND COAL

1030'FNL 1705'FEL
 SAN JUAN NEW MEXICO
 Elevation 5985'GL

Formation tops: Surface- San Jose
 Ojo Alamo- 1440
 Kirtland- 1635
 Fruitland- 2461
 Fruitland Coal Top- 2523
 Fruitland Coal Base- 2811
 Pictured Cliffs- 2824

Intermediate TD- 2503
 Total Depth- 2813

Logging Program: Mud logs from intermediate to total depth.

Mud Program:	Interval	Type	Weight	Visc.	Fl. Loss
	0 - 350	Spud	8.4 - 8.9	40-50	no control
	350 - 2503	Non-dispersed	8.4 - 9.1	30-60	no control
	2503 - 2813	Formation Water	8.4		no control

Casing Program:	Hole Size	Depth Interval	Csg. Size	Weight	Grade
	12 1/4"	0 - 350	9 5/8"	32.3#	H-40
	8 3/4"	0 - 2503	7"	20.0#	K-55
	6 1/4"	2453 - 2813	5 1/2"	15.5#	K-55
Tubing Program:		0 - 2813	2 7/8"	6.5#	J-55

Float Equipment: 9 5/8" surface casing - saw tooth guide shoe. Centralizers will be run in accordance with Onshore Order #2.

7" intermediate casing - guide shoe and self-fill insert float valve. Three centralizers run every other joint above shoe. Run insert float one joint above the guide shoe. Two turbolizing type centralizers - one below and one into the base of the Ojo Alamo @ 1635'. Standard centralizers thereafter every fourth joint up to the base of the surface pipe.

5 1/2" production casing - float shoe on bottom and a pre-drilled liner run to the 7" casing with a minimum 50' overlap. Liner hanger is a double slip grip type.

Wellhead Equipment: 9 5/8" x 7" x 2 7/8" x 11" 3000 psi xmas tree assembly.

Cementing:

9 5/8" surface casing - cement with 279 sacks of class "B" cement with 1/4# flocele/sack and 3% calcium chloride (329 cu ft. of slurry, 200% excess to circulate to surface). WOC 12 hours. Test casing to 600 psi for 30 minutes.

7" intermediate casing - lead with 357 sacks of 65/35 class "B" poz with 6% gel, 2% calcium chloride and 1/2 cu ft. Perlite/sack (10.3 gallons of water/sack) tail with 100 sacks of class "B" with 2% calcium chloride. 808 cu ft. of slurry, 110% excess to circulate to surface. If hole conditions permit, a 600 ft spacer will be run ahead of the cement slurry to avoid mud contamination of the cement. WOC 12 hours. If cement does not circulate to surface, a temperature log will be run after 8 hours to determine TOC.

5 1/2" liner - do not cement.



SEYMOUR #25-1
NW $\frac{1}{4}$, NE $\frac{1}{4}$ Sec. 25 T31N R9W N.M.P.M.
San Juan Co. New Mexico

