

UNITED STATES
DEPARTMENT OF THE INTERIOR
BUREAU OF LAND MANAGEMENT

APPLICATION FOR PERMIT TO DRILL, DEEPEN, OR PLUG BACK

1a. TYPE OF WORK DRILL <input checked="" type="checkbox"/> DEEPEN <input type="checkbox"/> PLUG BACK <input type="checkbox"/>				5. LEASE DESIGNATION AND SERIAL NO. SF-078998	
b. TYPE OF WELL OIL WELL <input type="checkbox"/> GAS WELL <input checked="" type="checkbox"/> OTHER <input type="checkbox"/> SINGLE ZONE <input type="checkbox"/> MULTIPLE ZONE <input type="checkbox"/>				6. IF INDIAN, ALLOTTEE OR TRIBE NAME	
2. NAME OF OPERATOR Northwest Pipeline Corporation				7. UNIT AGREEMENT NAME San Juan 32-7 Unit	
3. ADDRESS OF OPERATOR 3539 East 30th Street - Farmington, NM 87402				8. FARM OR LEASE NAME San Juan 32-7 Unit	
4. LOCATION OF WELL (Report location clearly and in accordance with any State requirements.)* At surface 795' FSL & 1004' FWL NE/SW At proposed prod. zone same				9. WELL NO. #227	
14. DISTANCE IN MILES AND DIRECTION FROM NEAREST TOWN OR POST OFFICE* 32 miles southeast of Ignacio, Colorado.				10. FIELD AND POOL, OR WILDCAT Basin Fruitland Coal	
16. DISTANCE FROM PROPOSED* LOCATION TO NEAREST PROPERTY OR LEASE LINE, FT. (Also to nearest drlg. unit line, if any)		695'		17. NO. OF ACRES ASSIGNED TO THIS WELL 321	
18. DISTANCE FROM PROPOSED LOCATION* TO NEAREST WELL, DRILLING, COMPLETED, OR APPLIED FOR, ON THIS LEASE, FT.		+ 4000'		20. ROTARY OR CABLE TOOLS Rotary	
21. ELEVATIONS (Show whether DF, RT, GR, etc.) This action is subject to technical and procedural review pursuant to 43 CFR 3165.3 and appeal pursuant to 43 CFR 3165.4. PROPOSED CASING AND CEMENTING PROGRAM				22. APPROX. DATE WORK WILL START* October 1, 1990	
23. 6540' GR				DRILLING OPERATIONS AUTHORIZED ARE SUBJECT TO COMPLIANCE WITH ATTACHED "GENERAL REQUIREMENTS"	
SIZE OF HOLE	SIZE OF CASING	WEIGHT PER FOOT	SETTING DEPTH	QUANTITY OF CEMENT	
13-1/2"	9-5/8"	36# K-55	500'	275 sx (327 cu.ft.)	
8-3/4"	7"	23# K-55	3140'	335 sx (834 cu.ft.)	
6-1/4"	5-1/2"	23# P110	3040'-3380'	Open hole	

1) Plan to drill Fruitland and set liner in open hole. If open hole proves unproductive, the 5-1/2" liner will be changed to 15.5#, K-55, cemented and hydraulically stimulated as necessary.

2) The dedicated acreage to this well is shown on the attached plat.

RECEIVED

NOV 06 1990

OIL CON. DIV
DIST. 3

IN ABOVE SPACE DESCRIBE PROPOSED PROGRAM: If proposal is to deepen or plug back, give data on present productive zone and proposed new productive zone. If proposal is to drill or deepen directionally, give pertinent data on subsurface locations and measured and true vertical depths. Give blowout preventer program, if any.

24. SIGNED Mike J. Turnbaugh TITLE Production Superintendent DATE 9-18-90
(This space for Federal or State office use)

PERMIT NO. _____ APPROVAL DATE _____

APPROVED BY _____ TITLE _____ DATE OCT 20 1990
CONDITIONS OF APPROVAL, IF ANY: _____

Hold C-100x FOR NSP
NSP-9305
NMOC

*See Instructions On Reverse Side

Submit to Appropriate
District Office
State Lease - 4 copies
Fee Lease - 3 copies

State of New Mexico
Energy, Minerals and Natural Resources Department

Form C-102
Revised 1-1-89

OIL CONSERVATION DIVISION

DISTRICT I
P.O. Box 1980, Hobbs, NM 88240

P.O. Box 2088
Santa Fe, New Mexico 87504-2088

DISTRICT II
P.O. Drawer DD, Artesia, NM 88210

DISTRICT III
1000 Rio Brazos Rd., Aztec, NM 87410

WELL LOCATION AND ACREAGE DEDICATION PLAT

All Distances must be from the outer boundaries of the section

Operator NORTHWEST PIPELINE CORP.			Lease SAN JUAN 32-7 UNIT		Well No. 227
Unit Letter N	Section 18	Township 1.31 N.	Range R.7 W.	County SAN JUAN	RIO ARriba COUNTY
Actual Footage Location of Well: 795 feet from the SOUTH line and 1004 feet from the WEST line					
Ground level Elev. 6540	Producing Formation FRUITLAND		Pool BASIN FRUITLAND COAL	Dedicated Acreage: 321 Acres	

- Outline the acreage dedicated to the subject well by colored pencil or hatchure marks on the plat below.
- If more than one lease is dedicated to the well, outline each and identify the ownership thereof (both as to working interest and royalty).
- If more than one lease of different ownership is dedicated to the well, have the interest of all owners been consolidated by communitization, unitization, force-pooling, etc?
☒ Yes ☐ No If answer is "yes" type of consolidation **UNITIZED**
If answer is "no" list the owners and tract descriptions which have actually been consolidated. (Use reverse side of this form if necessary.)
No allowable will be assigned to the well until all interests have been consolidated (by communitization, unitization, forced-pooling, or otherwise) or until a non-standard unit, eliminating such interest, has been approved by the Division.

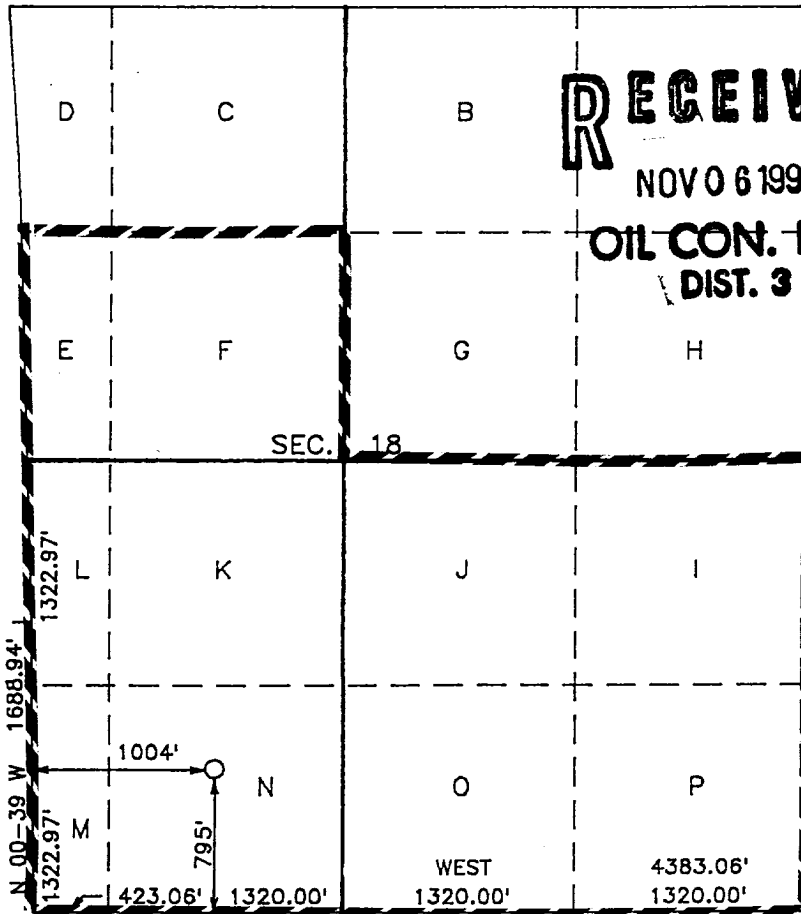

OPERATOR CERTIFICATION

I hereby certify that the information contained herein is true and complete to the best of my knowledge and belief.

Signature
Mike Turnbaugh
Printed Name
MIKE TURNBAUGH
Position
PRODUCTION SUPERINTENDENT
Company
NORTHWEST PIPELINE CORP.
Date
9-18-90

SURVEYOR CERTIFICATION

I hereby certify that the well location shown on this plat was plotted from field notes of actual surveys made by me or under my supervision, and that the same is true and correct to the best of my knowledge and belief.

Date Surveyed
SEPTEMBER 14, 1990
Signature & Seal of Professional Land Surveyor
R. Howard Daggett
R. HOWARD DAGGETT
9879
Certificate No.
9879
Registered Professional Land Surveyor

(All BLM surface from Highway 511 to location)

Highway 251

