

UNITED STATES
DEPARTMENT OF THE INTERIOR
BUREAU OF LAND MANAGEMENT

RECEIVED
MAIL ROOM

APPLICATION FOR PERMIT TO DRILL, DEEPEN, OR PLUG BACK

1a. TYPE OF WORK DRILL <input checked="" type="checkbox"/> DEEPEN <input type="checkbox"/> PLUG BACK <input type="checkbox"/>				5. LEASE IDENTIFICATION AND SERIAL NO. SF-080597	
b. TYPE OF WELL OIL WELL <input type="checkbox"/> GAS WELL <input checked="" type="checkbox"/> Coal Seam <input type="checkbox"/> OTHER <input type="checkbox"/>				6. IF INDIAN, ALLOTTEE OR TRIBE NAME	
2. NAME OF OPERATOR Amoco Production Company				7. UNIT AGREEMENT NAME	
3. ADDRESS OF OPERATOR 2325 East 30th Street, Farmington NM 87401				8. FARM OR LEASE NAME Gartner A	
4. LOCATION OF WELL (Report location clearly and in accordance with any State requirements.) At surface: 1860' 20" 1580' FNL x 1050' FEL At proposed prod. zone: Same				9. WELL NO. 11	
11. DISTANCE IN MILES AND DIRECTION FROM NEAREST TOWN OR POST OFFICE* 28 miles northeast of Bloomfield NM				10. FIELD AND POOL, OR WILDCAT Basin Fruitland Coal Gas	
13. DISTANCE FROM PROPOSED* LOCATION TO NEAREST PROPERTY OR LEASE LINE, FT. (Also to nearest drlg. unit line, if any) 1050'				11. SEC., T., R., M., OR BLK. AND SURVEY OR AREA H SENE Sec 26 T30N R8W	
18. DISTANCE FROM PROPOSED LOCATION* TO NEAREST WELL, DRILLING, COMPLETED, OR APPLIED FOR, ON THIS LEASE, FT.				12. COUNTY OR PARISH San Juan	
19. PROPOSED DEPTH See attached plan 3190'				13. STATE NM	
21. ELEVATIONS (Show whether DF, RT, GR, etc.) 6070' GR 6057				17. NO. OF ACRES ASSIGNED TO THIS WELL 320 E/2	
22. APPROX. DATE WORK WILL START* As soon as permitted				20. ROTARY OR CABLE TOOLS Rotary	
23. PROPOSED CASING AND CEMENTING PROGRAM This action is subject to technical and procedural review pursuant to 43 CFR 3165.3 and appeal by 43 CFR 3165.4.					
SIZE OF HOLE		SIZE OF CASING	WEIGHT PER FOOT	SETTING DEPTH	
12-1/4"		9-5/8"	36# K55	250'	200 cf Class B
8-3/4"		7"	20# K55	2227'	766 cf Class B
6-1/4"		5-1/2"	23# P110	2931'	

Notice of Staking was submitted 4-21-89.

Lease description:

T30N-R8W, NMPM
Sec. 26: E/2 SW/4, E/2 NW/4, SW/4 NW/4
Sec. 27: SE/4 NE/4, W/2 NE/4, NW/4, S/2
Sec. 28: All
Sec. 29: Lots 1,8
Sec. 33: All

RECEIVED
NOV 23 1990
OIL CON. DIV.
DIST. 3

IN ABOVE SPACE DESCRIBE PROPOSED PROGRAM: If proposal is to deepen or plug back, give data on present productive zone and proposed new productive zone. If proposal is to drill or deepen directionally, give pertinent data on subsurface locations and measured and true vertical depths. Give blowout preventer program, if any.

SIGNED <u>J. L. Hampton</u>		TITLE <u>Admin. Supv.</u>		APPROVED <u>AS AMENDED</u>	
(This space for Federal or State office use)					
PERMIT NO. _____		APPROVAL DATE _____			
APPROVED BY _____		TITLE _____			
CONDITIONS OF APPROVAL, IF ANY:					

[Handwritten initials]

NOV 02 1990
John S. [Signature]
AREA MANAGER

Submit to Appropriate
District Office
State Lease - 4 copies
Fee Lease - 3 copies

State of New Mexico
Energy, Minerals and Natural Resources Department

Form C-102
Revised 1-1-89

OIL CONSERVATION DIVISION

P.O. Box 2088
Santa Fe, New Mexico 87504-2088

DISTRICT I
P.O. Box 1980, Hobbs, NM 88240

DISTRICT II
P.O. Drawer DD, Artesia, NM 88210

DISTRICT III
1000 Rio Brazos Rd., Aztec, NM 87410

WELL LOCATION AND ACREAGE DEDICATION PLAT

All Distances must be from the outer boundaries of the section

Operator AMOCO PRODUCTION COMPANY			Lease GARTNER /A/		Well No. # 11
Unit Letter H	Section 26	Township 30 NORTH	Range 8 WEST	County SAN JUAN	
Actual Footage Location of Well: 1880 feet from the NORTH line and 830 feet from the EAST line					
Ground level Elev. 6057	Producing Formation Fruitland Coal		Pool Basin Fruitland Coal Gas	Dedicated Acreage E/2 320 Acres	

- Outline the acreage dedicated to the subject well by colored pencil or hatchure marks on the plat below.
- If more than one lease is dedicated to the well, outline each and identify the ownership thereof (both as to working interest and royalty).
- If more than one lease of different ownership is dedicated to the well, have the interest of all owners been consolidated by communization, unitization, force-pooling, etc?
☐ Yes ☐ No If answer is "yes" type of consolidation _____
If answer is "no" list the owners and tract descriptions which have actually been consolidated. (Use reverse side of this form if necessary). _____
No allowable will be assigned to the well until all interests have been consolidated (by communization, unitization, forced-pooling, or otherwise) or until a non-standard unit, eliminating such interest, has been approved by the Division.

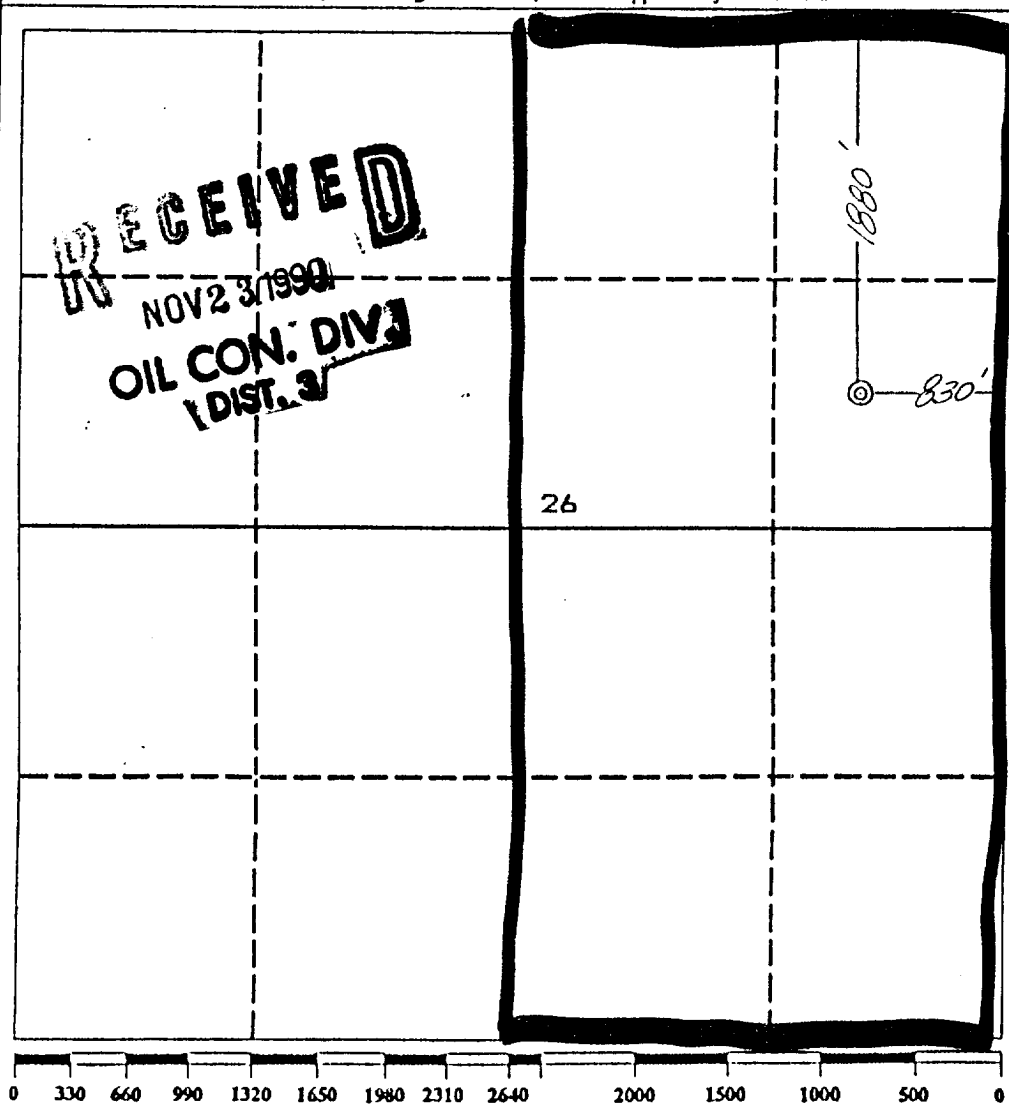

OPERATOR CERTIFICATION I hereby certify that the information contained herein is true and complete to the best of my knowledge and belief.	
Signature <i>J. L. Hampton</i>	Printed Name J. L. Hampton
Position Sr Staff Admin Svr	
Company Amoco Prod	
Date 5-29-90	
SURVEYOR CERTIFICATION I hereby certify that the well location shown on this plat was plotted from field notes of actual surveys made by me or under my supervision, and that the same is true and correct to the best of my knowledge and belief.	
Date Surveyed May 22, 1990	
Signature & Seal of Professional Surveyor <i>G. D. Vann</i> GARY D. VANN NEW MEXICO REGISTERED PROFESSIONAL LAND SURVEYOR 7016	
Gary Certification No. 7016	

Amoco proposes to drill the well to further develop the Fruitland Coal reservoir. The well will be drilled to the surface casing point using native mud. The well will then be drilled to the intermediate casing point with a non-dispersed mud system. The attached modified 11" 3000 psi blowout preventer will be used. Amoco will attempt to complete the Fruitland coal by drilling the interval with water and air. A service unit will probably be used to drill into the coals using the attached modified 6" 3000 psi BOP. If commercial productivity is established, then a 5-1/2" uncemented liner will be run. Amoco reserves the right to utilize a drilling rig to drill this hole section.

Quantity	Size	Weight	Description	Cementing Program
<u>SURFACE CASING</u>				
250'	9-5/8"	36#	K55 ST&C	200 cf Class B, 2% CaCl ₂ 15.6 ppg
<u>INTERMEDIATE STRING</u>				
2727'	7"	20#	K55 ST&C	766 cf Class B, 65:35:6 10% salt, .25% dispersant 13.1 ppg 118 cf Class B, 2% CaCl ₂ 15.6 ppg
<u>LINER</u>				
300'	5-1/2"	23#	P110 LT&C	None

The above casing design is based upon a 9.0#/gallon mud weight.

CONTINGENCY OPERATIONAL PLAN

In the event the well does not yield commercial volumes of gas from the open hole completion, the water filled hole will be mudded-up and weighted-up as necessary (9-11#/gal.) for hole stability and well control. The well will then be deepened approximately 250' into the Pictured Cliffs formation to provide necessary footage for a cased and cemented completion technique. The Fruitland coals will then be perforated and fracture stimulated. The Pictured Cliffs formation will be isolated with cement.

CONTINGENCY LINER

650'	4-1/2"	11.6#	K-55 LT&C	250 cf Class B
------	--------	-------	-----------	----------------

The contingency string is based upon a 11.0#/gallon mud weight.

Evaluation:

Mud logs will be the only logs run if the well is completed as an open hole. The log surveys (FDC/GR/CAL, DIL/SP/GR, Microlog, Mudlogger) will be run only if the well is drilled into the Pictured Cliffs formation, and only if well condition is suitable to allow proper wireline log interpretation.

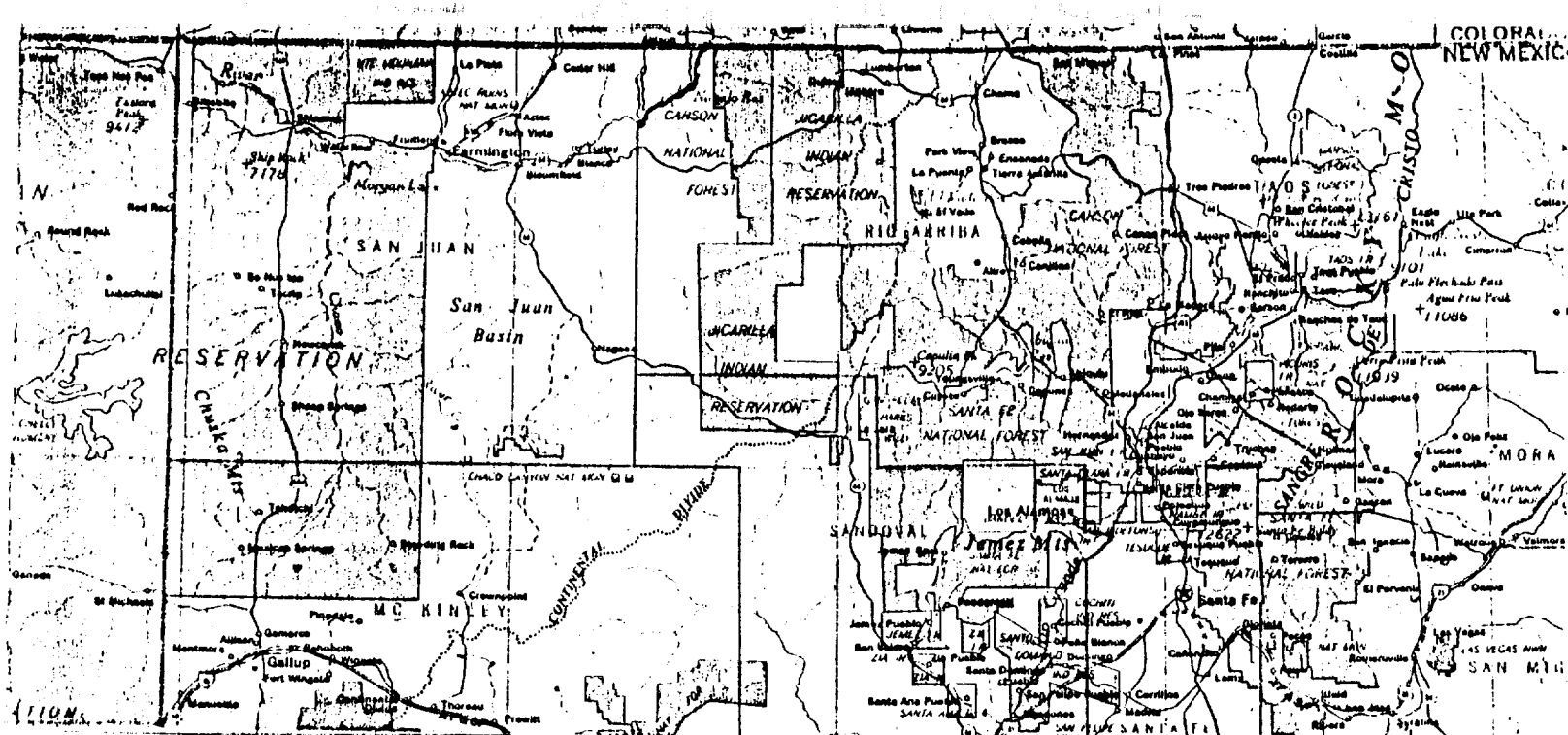

AMOCO PRODUCTION COMPANY
 GARTNER /A/ # 11
 1880' F/NL 830' F/EL
 SEC. 26, T30N, RBW, NMPM
 SAN JUAN COUNTY, NEW MEXICO

Rail: 149 miles from Montrose, Co.
 Mud: 36 miles from Aztec, Nm
 Cement: 40 miles from Farmington, Nm

GARTNER
 /A/ # 11

