

JUN. 08 1990

SF-078765 (WC)
3162.3-1.0 (019)

CERTIFIED MAIL
P 140 431 376

Meridian Oil, Incorporated
P. O. Box 4289
Farmington, NM 87499

RECEIVED
JUN 11 1990
OIL CON. DIV
DIST. 3

Gentlemen:

Enclosed is your Application for Permit to Drill (APD) well No. 224 Rosa Unit, SE/4NW/4, sec. 8, T. 31 N., R. 6 W., Rio Arriba County, New Mexico, lease SF-078765. As discussed with Cindy Bassing of your company on May 17, 1990, the subject APD is rescinded and returned due to drilling not being commenced within one year of the approval date.

You are required to request surface rehabilitation instructions from this office if construction activities occurred on the referenced drill site. If this office does not receive comment within 30 days, we will presume that no construction occurred and proceed accordingly. Later discovery that construction activities have in fact occurred, may result in assessment of liquidated damages.

Sincerely,

/s/ John L. Keller

John L. Keller, Chief
Branch of Mineral Resources

Enclosure

cc: New Mexico Oil Conservation Division, 1000 Rio Brazos Rd.,
Aztec, NM 87410

ABANDONED LOCATION

UNITED STATES
DEPARTMENT OF THE INTERIOR
BUREAU OF LAND MANAGEMENT

APPLICATION FOR PERMIT TO DRILL, DEEPEN, OR PLUG BACK

1a. TYPE OF WORK

DRILL ☒

DEEPEN ☐

PLUG BACK ☐

b. TYPE OF WELL

OIL
WELL ☐

GAS
WELL ☒

OTHER

SINGLE
ZONE ☒

MULTIPLE
ZONE ☐

2. NAME OF OPERATOR

Northwest Pipeline Corporation

3. ADDRESS OF OPERATOR

3539 E. 30th Street - Farmington, NM 87401

4. LOCATION OF WELL (Report location clearly and in accordance with any State requirements.)*

At surface

1330' FNL & 1360' FWL SE/4 NW/4

At proposed prod. zone

Same

14. DISTANCE IN MILES AND DIRECTION FROM NEAREST TOWN OR POST OFFICE*

Approximately 25 miles to Ignacio Colorado

15. DISTANCE FROM PROPOSED*

LOCATION TO NEAREST
PROPERTY OR LEASE LINE, FT.
(Also to nearest drlg. unit line, if any)

1330'

18. DISTANCE FROM PROPOSED LOCATION*
TO NEAREST WELL, DRILLING, COMPLETED,
OR APPLIED FOR, ON THIS LEASE, FT.

+ 2500'

16. NO. OF ACRES IN LEASE

N/A 3460-23

19. PROPOSED DEPTH

3134'

17. NO. OF ACRES ASSIGNED
TO THIS WELL

N/320'

20. ROTARY OR CABLE TOOLS

Rotary

21. ELEVATIONS (Show whether DF, RT, GR, etc.)

6340' GR DRILLING OPERATIONS AUTHORIZED ARE

22. APPROX. DATE WORK WILL START*

3-1-89

23. SUBJECT TO COMPLIANCE WITH ATTACHED
"GENERAL REQUIREMENTS" PROPOSED CASING AND CEMENTING PROGRAM

This action is subject to technical and
procedural review pursuant to 43 CFR 3165.3
and appeal pursuant to 43 CFR 3165.4.

SIZE OF HOLE	SIZE OF CASING	WEIGHT PER FOOT	SETTING DEPTH	
12-1/4"	9-5/8"	32.3#	200'	125 cu. ft.
8-3/4"	7"	20#	2934'	170 cu. ft.
6-1/4"	5-1/2"	23#	2734'-3134'	Open hole completion

The N/2 of Section 8 is dedicated to this well.

RECEIVED
APR 18 1989
OIL CON. DIV.
DIST. 3

IN ABOVE SPACE DESCRIBE PROPOSED PROGRAM: If proposal is to deepen or plug back, give data on present productive zone and proposed new productive zone. If proposal is to drill or deepen directionally, give pertinent data on subsurface locations and measured and true vertical depths. Give blowout preventer program, if any.

24.

SIGNED

Mike Turnbaugh

TITLE

Senior Engineer

DATE

12-19-88

(This space for Federal or State office use)

PERMIT NO.

APPROVAL DATE

APPROVED BY

TITLE

CONDITIONS OF APPROVAL, IF ANY:

ch-1

NMOCC

*See Instructions On Reverse Side

Title 18 U.S.C. Section 1001, makes it a crime for any person knowingly and willfully to make to any department or agency of the United States any false, fictitious or fraudulent statements or representations as to any matter within its jurisdiction.

All distances must be from the outer boundaries of the Section.

Operator Northwest Pipeline Corporation			Lease Rosa Unit		Well No. 224
Unit Letter F	Section 8	Township 31 North	Range 6 West	County San Juan	
Actual Footage Location of Well: 1330 feet from the North line and 1360 feet from the West line					
Ground Level Elev. 6340	Producing Formation Fruitland		Pool Basin Fruitland Pool		Dedicated Acreage: 320 Acres

1. Outline the acreage dedicated to the subject well by colored pencil or hatchure marks on the plat below.
2. If more than one lease is dedicated to the well, outline each and identify the ownership thereof (both as to working interest and royalty).
3. If more than one lease of different ownership is dedicated to the well, have the interests of all owners been consolidated by communitization, unitization, force-pooling, etc?

☒ Yes ☐ No If answer is "yes," type of consolidation unitization

If answer is "no," list the owners and tract descriptions which have actually been consolidated. (Use reverse side of this form if necessary.)

No allowable will be assigned to the well until all interests have been consolidated (by communitization, unitization, forced-pooling, or otherwise) or until a non-standard unit, eliminating such interests, has been approved by the Division.

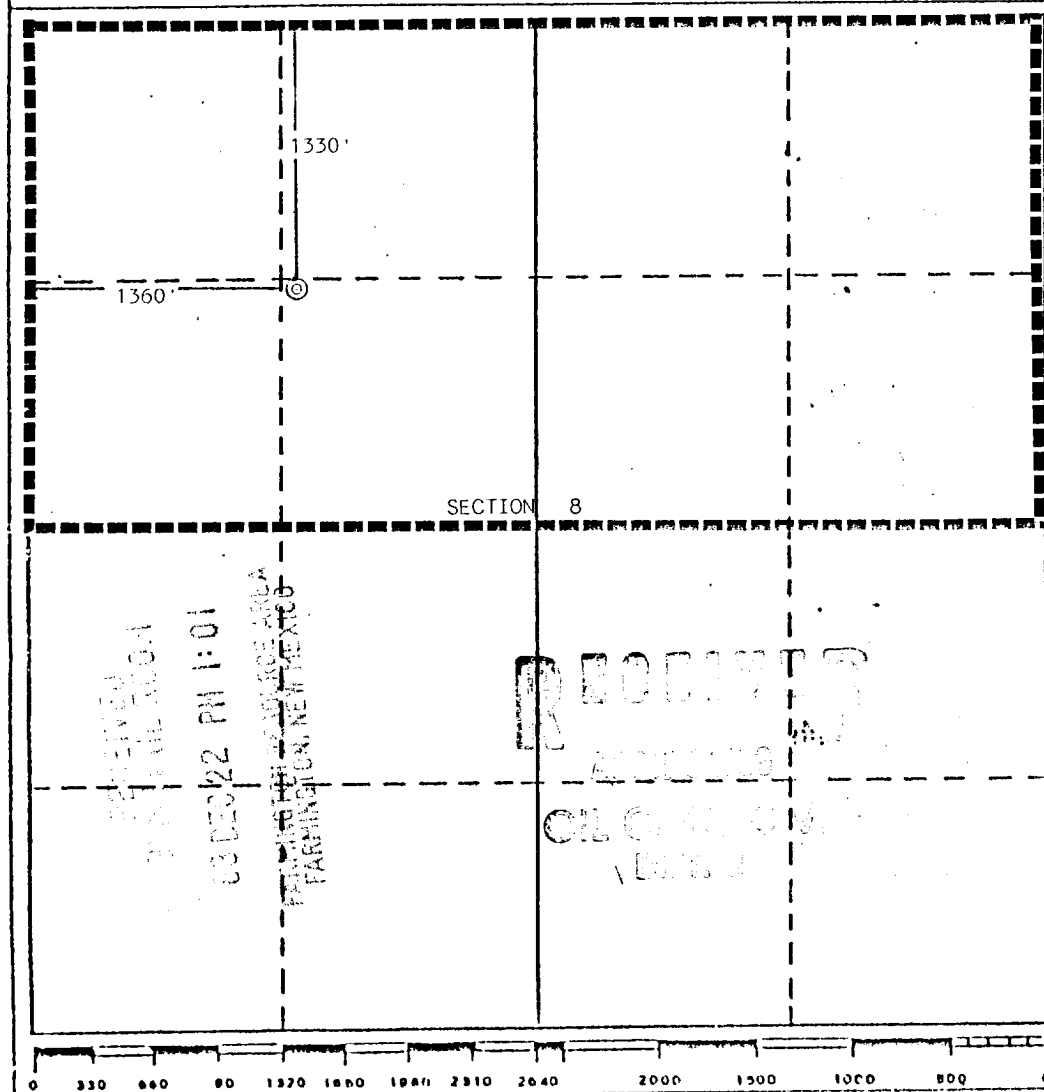

CERTIFICATION

I hereby certify that the information contained herein is true and complete to the best of my knowledge and belief.

Mike J. Turnbaugh
Name
Mike J. Turnbaugh
Position
Senior Engineer
Company
Northwest Pipeline Corp.
Date
11-1-88

I hereby certify that the well location shown on this plat was plotted from field notes of actual surveys made by me or under my supervision, and that the same is true and correct to the best of my knowledge and belief.

Date Surveyed
October 19, 1988
Registered Professional Engineer and/or Land Surveyor
Edgar L. Risenhoover
Certificate No. 5979
Edgar L. Risenhoover, L.S.

1330' F/NL 1360' F/WL
Sec. 8, T-31-N, R-6-W, NMPM
San Juan County, New Mexico

1330' F/NL 1360' F/WL
Sec. 8, T-31-N, R-6-W, NMPM
San Juan County, New Mexico

To Bureau
may they
Red

2 150 000 FEET
(CENTRAL)

3.6° 52' 20"