

05-01-90

Elev. 6051 GL

Casing S. _____ @ _____ W _____ Sx. _____ Cu. ft. _____ Elev. _____ GL _____ Spd. _____ Comp. _____ TD _____ PB _____
Csg. Perf. _____ Int. _____ @ _____ W _____ Sx. _____ Pr. _____ @ _____ W _____ Sx. _____ I. _____ @ _____
Prod. Stim. _____

T Gas
R
A
N
S

I.P. _____ BO/D _____ Grav. _____ 1st Del. _____ Gas _____
MCF/D After _____ Hrs. SICP _____ PSI After _____ Days GOR _____ 1st Del. _____ Oil _____

TOPS		NiTD	X	Well Log	TEST DATA									
Ojo Alamo		C-103		Plot	X	Schd.	PC	Q	PW	PD	D	Ref.No.		
Kirtland		C-104		Electric Log										
Fruitland				C-122										
Pictured Cliffs		Ditr		Dfa										
Chacra		Datr		Dac										
Cliff House		<div>S/315.76 Acres</div>												
Menefee														
Point Lookout														
Mancos														
Gallup														
Greenhorn														
Dakota														
Entrado														

P

BasinFrCoal Co. SJ S 25 T 30N R10W U L Oper. Amoco Production Co. Les. Florance AE No. 3

Florance AE #3

L-25-30N-10W

AMOCO PRODUCTION CO.



United States Department of the Interior

BUREAU OF LAND MANAGEMENT
FARMINGTON RESOURCE AREA
1235 LAPLATA HIGHWAY
FARMINGTON, NEW MEXICO 87401

TAKE
PRIDE IN
AMERICA

IN REPLY REFER TO:

SF-080243 et. al. (NC)
3162.3-1.0 (019)

JUL 18 1991

Amoco Production Company
PO Box 800
Denver, Colorado 80201

RECEIVED

JUL 19 1991

**OIL CON. DIV.,
DIST. 3**

Gentlemen:

Enclosed are your Applications for Permit to Drill well Nos.:

- ✓ 1. No. 3 Florance Gas Com I, sec. 18, T 30 N, R 9 W, SF-080243
- ✓ 2. No. 3 Florance "AA", sec. 8, T 30 N, R 9 W, SF-078129-A
- ✓ 3. No. 3 Florance "AE", sec. 25, T 30 N, R 10 W, SF-080776
- ✓ 4. No. 7 Florance "AD", sec. 24, T 30 N, R 10 W, SF-078116
- ✓ 5. No. 9 Riddle "H", sec. 17, T 30 N, R 9 W, SF-080244
- ✓ 6. No. 5 Elmer E. Elliott "A", sec. 15, T 30 N, R 9 W, SF-078139
- ✓ 7. No. 3 Giomi Gas Com "C", sec. 28, T 30 N, R 9 W, SF-078042
- ✓ 8. No. 1 Walker Gas Com A, sec. 31, T 31 N, R 9 W, SF-078316-F
- ✓ 9. No. 1 Riddle Gas Com C, sec. 30, T 31 N, R 9 W, SF-078319-A

All of the above referenced wells are located in San Juan County, New Mexico. As Discussed with Cindy Burton of your company on June 27, 1991, the subject APDs are rescinded and returned due to drilling not being commenced within one year of the approval date.

You are required to request surface rehabilitation instructions from this office if construction activities occurred on the referenced drill sites. If this office does not receive comment within 30 days, we will presume that no construction occurred and proceed accordingly. Later discovery that construction activities have in fact occurred, may result in assessment of liquidated damages.

Sincerely,

/s/ John L. Keller

John L. Keller
Chief, Branch of Mineral Resources

9 Enclosures

cc:

~~New Mexico Oil Conservation Division~~, 1000 Rio Brazos Rd., Aztec,
NM 87410

ABANDONED LOCATION

UNITED STATES
DEPARTMENT OF THE INTERIOR
BUREAU OF LAND MANAGEMENT

APPLICATION FOR PERMIT TO DRILL, DEEPEN, OR PLUG BACK

1a. TYPE OF WORK

DRILL ☒

DEEPEN ☐

PLUG BACK ☐

b. TYPE OF WELL

OIL
WELL ☐

GAS
WELL ☒

OTHER

Coal Seam

SINGLE
ZONE ☒

MULTIPLE
ZONE ☐

2. NAME OF OPERATOR

Amoco Production Company

ATTN: J. L. Hampton

3. ADDRESS OF OPERATOR

P. O. Box 800 Denver, Colorado 80201

4. LOCATION OF WELL (Report location clearly and in accordance with any State requirements.)*

1570' FSL, 1300' FWL NW/4SW
At proposed prod. zone 1570' FSL & 1300' FWL
same

14. DISTANCE IN MILES AND DIRECTION FROM NEAREST TOWN OR POST OFFICE*

16 miles from Aztec, NM

15. DISTANCE FROM PROPOSED*

LOCATION TO NEAREST
PROPERTY OR LEASE LINE, FT.
(Also to nearest drlg. unit line, if any)

1300'

16. NO. OF ACRES IN LEASE

315.76

17. NO. OF ACRES ASSIGNED
TO THIS WELL

320 acres S/2 315.76

18. DISTANCE FROM PROPOSED LOCATION*
TO NEAREST WELL, DRILLING, COMPLETED,
OR APPLIED FOR, ON THIS LEASE, FT.

19. PROPOSED DEPTH

2829' TD

20. ROTARY OR CABLE TOOLS

Rotary

21. ELEVATIONS (Show whether DF, RT, GR, etc.)

6051 GR

22. APPROX. DATE WORK WILL START*

As soon as permitted

DRILLING OPERATIONS AUTHORIZED ARE
SUBJECT TO COMPLIANCE WITH ATTACHED

PROPOSED CASING AND CEMENTING PROGRAM

This action is subject to technical and
procedural review pursuant to 43 CFR 3165.3
and appeal pursuant to 43 CFR 3165.4.

GENERAL REQUIREMENTS

SIZE OF CASING	WEIGHT PER FOOT	SETTING DEPTH
12 1/4"	24#	250'
8 5/8"	17#	2829' (TD)
5 1/2"		250 cf (cement to surface)
		792 cf (cement to surface)

Notice of Staking was submitted: 3-20-90

Lease Description:

T30N-R10W

Sec.25: Lots 9-16

RECEIVED
MAY 01 1990
OIL CON. DIV
DIST. 3

IN ABOVE SPACE DESCRIBE PROPOSED PROGRAM: If proposal is to deepen or plug back, give data on present productive zone and proposed new productive zone. If proposal is to drill or deepen directionally, give pertinent data on subsurface locations and measured and true vertical depths. Give blowout preventer program, if any.

24. SIGNED J. L. Hampton TITLE Sr. Staff Admin. Supv.
(This space for Federal or State office use)

DATE 3/30/90

PERMIT NO.

APPROVAL DATE

APPROVED
AS AMENDED

APPROVED BY

TITLE

CONDITIONS OF APPROVAL, IF ANY:

DATE APR 26 1990

AREA MANAGER

*See Instructions On Reverse Side

Submit to Appropriate
District Office
State Lease - 4 copies
Fee Lease - 3 copies

State of New Mexico
Energy, Minerals and Natural Resources Department

Form C-102
Revised 1-1-89

OIL CONSERVATION DIVISION

P.O. Box 2088

Santa Fe, New Mexico 87504-2088

DISTRICT I
P.O. Box 1980, Hobbs, NM 88240

DISTRICT II
P.O. Drawer DD, Artesia, NM 88210

DISTRICT III
1000 Rio Brazos Rd., Aztec, NM 87410

WELL LOCATION AND ACREAGE DEDICATION PLAT

All Distances must be from the outer boundaries of the section

Operator AMOCO PRODUCTION COMPANY			Lease FLORANCE /AE/		Well No. # 3
Unit Letter L	Section 25	Township 30 NORTH	Range 10 WEST	County SAN JUAN	
Actual Footage Location of Well: 1570 feet from the SOUTH line and 1300 feet from the WEST line					
Ground level Elev. 6051	Producing Formation <i>Fruitland Coal</i>	Pool <i>Basin Fruitland Coal No 5/2</i>	Dedicated Acreage: 315.76 Acres		

- Outline the acreage dedicated to the subject well by colored pencil or hatchure marks on the plat below.
- If more than one lease is dedicated to the well, outline each and identify the ownership thereof (both as to working interest and royalty).
- If more than one lease of different ownership is dedicated to the well, have the interest of all owners been consolidated by communization, unitization, force-pooling, etc.?
☐ Yes ☐ No If answer is "yes" type of consolidation _____
If answer is "no" list the owners and tract descriptions which have actually been consolidated. (Use reverse side of this form if necessary). _____
No allowable will be assigned to the well until all interests have been consolidated (by communization, unitization, forced-pooling, or otherwise) or until a non-standard unit, eliminating such interest, has been approved by the Division.

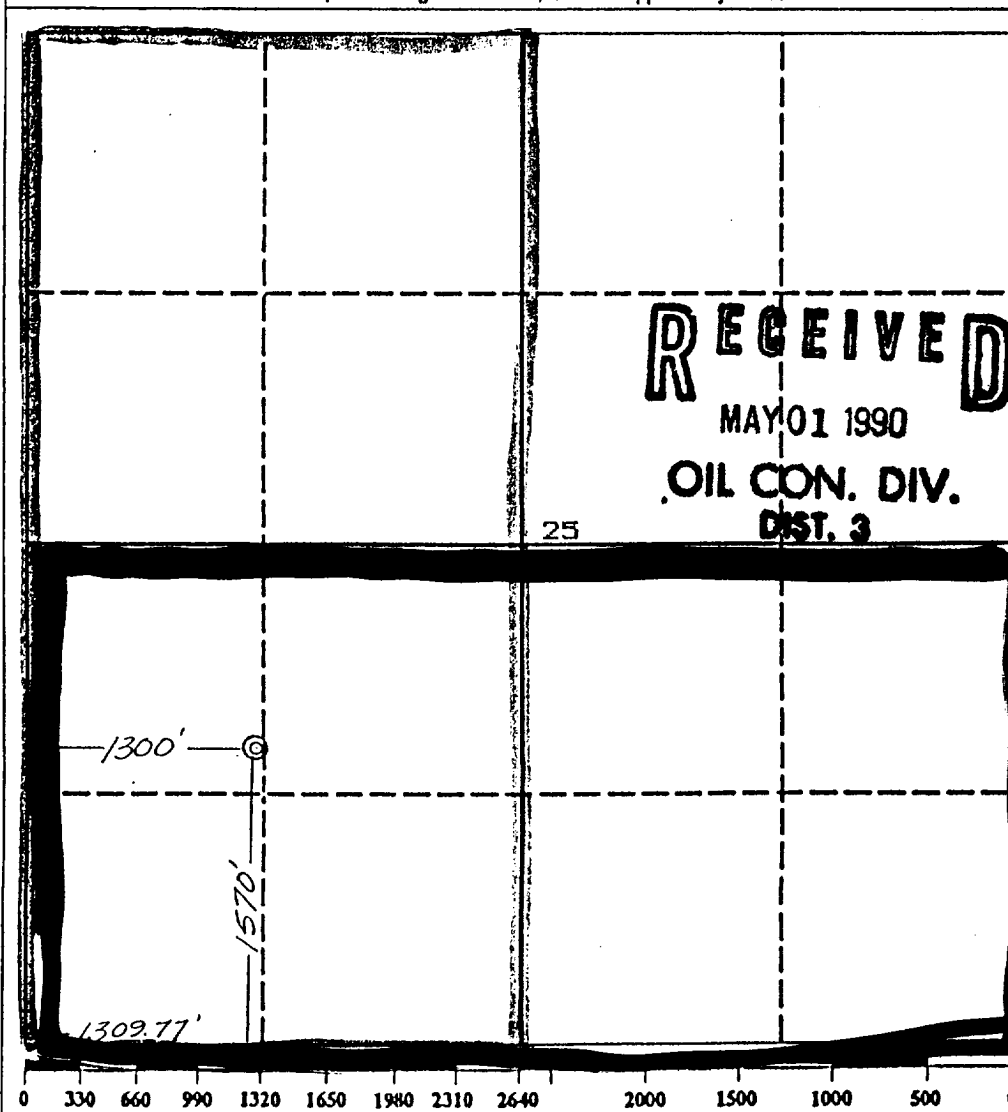

OPERATOR CERTIFICATION

I hereby certify that the information contained herein is true and complete to the best of my knowledge and belief.

Signature *J. L. Hampton*
Printed Name **J. L. Hampton**
Position *De. Staff. Admin. Super*
Company *Amoco Prod. Company*
Date **3/20/90**

SURVEYOR CERTIFICATION

I hereby certify that the well location shown on this plat was plotted from field notes of actual surveys made by me or under my supervision, and that the same is true and correct to the best of my knowledge and belief.

Date Surveyed **March 15, 1990**

Signature & Seal of Professional Surveyor
GARY D. VANN
NEW MEXICO
REGISTERED PROFESSIONAL LAND SURVEYOR
7016



WIDENED DO

0.1210

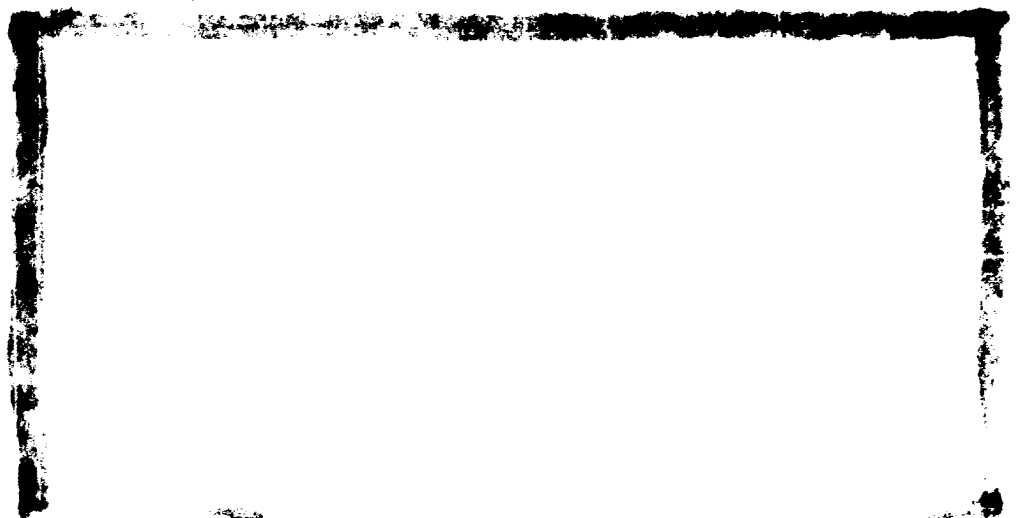

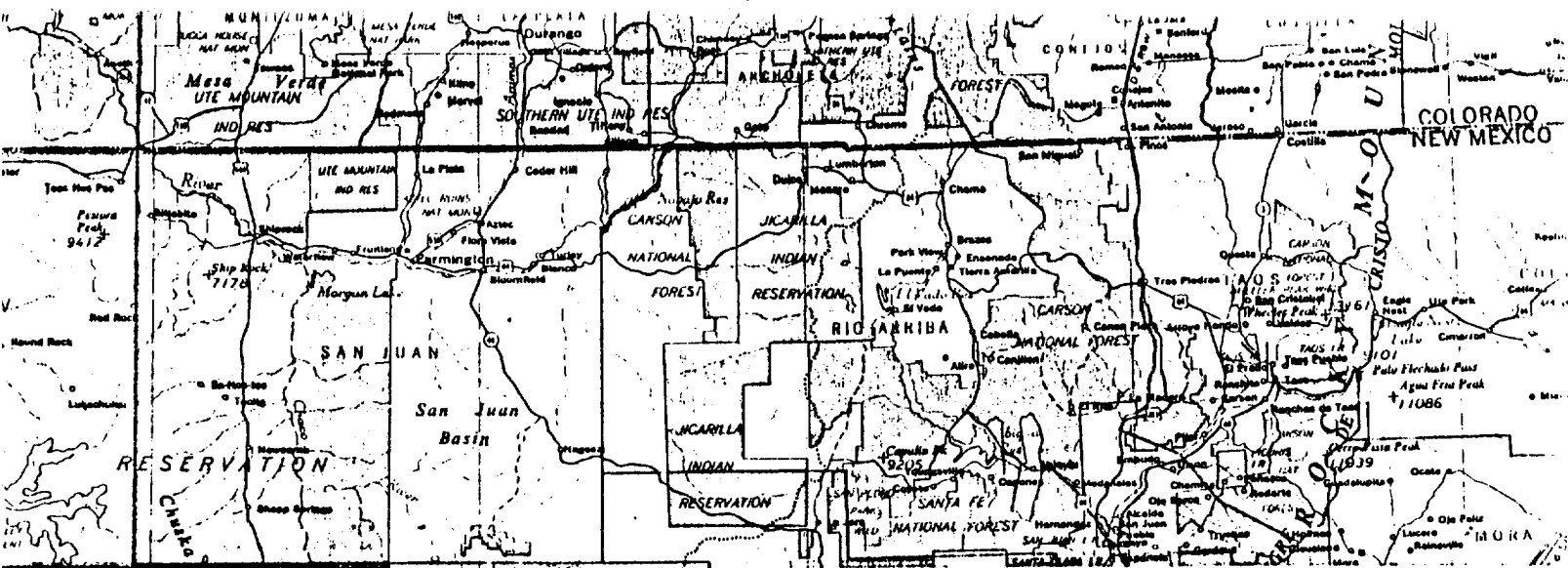

FLORANCE /AE/ # 3
 1570' F/SL 1300' F/WL
 SEC. 25, T30N, R10W, NMPM
 RAIL POINT: 158 miles from Montrose, Co.
 MUD POINT: 16 miles from Aztec, NM
 CEMENT POINT: 30 miles from Farmington, NM

