

UNITED STATES  
DEPARTMENT OF THE INTERIOR  
BUREAU OF LAND MANAGEMENT

30-045-21613  
APPLICATION FOR PERMIT TO DRILL, DEEPEN, OR PLUG BACK

1a. TYPE OF WORK

DRILL

1b. TYPE OF WELL

GAS

2. OPERATOR

MERIDIAN OIL INC.

3. ADDRESS & PHONE NO. OF OPERATOR

P O BOX 4289

FARMINGTON, NM 87499

4. LOCATION OF WELL

835' FNL 1240' FEL

RECEIVED

OCT 18 1991

OIL CON. DIV.

DIST. 3

5. LEASE NUMBER

SF-078511

6. IF INDIAN, ALL. OR TRIBE NAME

7. UNIT AGREEMENT NAME

8. FARM OR LEASE NAME

QUINN

9. WELL NO.

342

10. FIELD, POOL, OR WILDCAT

BASIN

FRUITLAND COAL

11. SEC. T. R. M OR BLK.

A SEC. 19 T31N Q8W NMPM

14. DISTANCE IN MILES FROM NEAREST TOWN

17 MILES NE OF AZTEC NM

12. COUNTY

SAN JUAN

13. STATE

NM

15. DISTANCE FROM

PROPOSED LOCATION 835'

TO NEAREST PROPERTY

OR LEASE LINE.

16. ACRES IN LEASE

17. ACRES ASSIGNED TO WELL

E/ 320.00

18. DISTANCE FROM

PROPOSED LOCATION

TO NEAREST WELL DR. 400'

COMPL., OR APPLIED

FOR ON THIS LEASE

This action is subject to technical and  
procedural review pursuant to 43 CFR 3165.3  
and appeal pursuant to 43 CFR 3165.4.

19. PROPOSED DEPTH

3330'

3342

20. ROTARY OR CABLE TOOLS

ROTARY

21. ELEVATIONS (DF, FT, GR, ETC.)

6486' GL

22. APPROX. DATE WORK WILL START

23.

PROPOSED CASING AND CEMENTING PROGRAM

\*SEE OPERATIONS PLAN

24. AUTHORIZED BY:

Danny Boone  
REG. DRILLING ENGR.

9-14-91

DATE

"Approval of this action does

not warrant that the applicant  
PERMIT NO.

has legal or equitable rights

in the lease.

TITLE

APPROVAL DATE

DATE

APPROVED  
AS AMENDED

OCT 16 1991

AREA MANAGER

NOTE: THIS FORMAT IS ISSUED IN LIEU OF US BLM FORM 3160-3

ARCH REPORT SUBMITTED 08/20/91

Hold c-104 for subsequentaneous dedication of Quinn #10 well

Well Name: 342 QUINN  
 Sec. 19 T31N 08W  
 BASIN FRUITLAND COAL

835'FNL 1240'FEL  
 SAN JUAN NEW MEXICO  
 Elevation 6486'GL

Formation tops: Surface- SAN JOSE  
 Ojo Alamo- 2169  
 Kirtland- 2199  
 Fruitland- 2969  
 Fruitland Coal Top- 3141 Intermediate TD- 3120  
 Fruitland Coal Base- 3341 Total Depth- 3342  
 Pictured Cliffs- 3354

Logging Program: Mud logs from intermediate to total depth.

Mud Program:	Interval	Type	Weight	Visc.	Fl. Loss
	0 - 200	Spud	8.4 - 8.9	40-50	no control
	200 - 3120	Non-dispersed	8.4 - 9.1	30-60	no control
	3120 - 3342	Formation Water	8.4		no control

Casing Program:	Hole Size	Depth Interval	Csg. Size	Weight	Grade
	12 1/4"	0 - 200	9 5/8"	32.3#	H-40
	8 3/4"	0 - 3120	7"	20.0#	K-55
	6 1/4"	3070 - 3342	5 1/2"	15.5#	K-55
Tubing Program:		0 - 3342	2 7/8"	6.5#	J-55

Float Equipment: 9 5/8" surface casing - saw tooth guide shoe. Centralizers will be run in accordance with Onshore Order #2.

7" intermediate casing - guide shoe and self-fill insert float valve. Three centralizers run every other joint above shoe. Run insert float one joint above the guide shoe. Two turbolizing type centralizers - one below and one into the base of the Ojo Alamo @ 2199'. Standard centralizers thereafter every fourth joint up to the base of the surface pipe.

5 1/2" production casing - float shoe on bottom and a pre-drilled liner run to the 7" casing with a minimum 50' overlap. Liner hanger is a double slip grip type.

Wellhead Equipment: 9 5/8" x 7" x 2 7/8" x 11" 3000 psi xmas tree assembly.

#### Cementing:

9 5/8" surface casing - cement with 160 sacks of class "B" cement with 1/4# flocele/sack and 3% calcium chloride (189 cu ft. of slurry, 200% excess to circulate to surface). WOC 12 hours. Test casing to 600 psi for 30 minutes.

7" intermediate casing - lead with 454 sacks of 65/35 class "B" poz with 6% gel, 2% calcium chloride and 1/2 cu ft. Perlite/sack (10.3 gallons of 995 cu ft. of slurry, 110% excess to circ. to surface. If hole conditions permit, a 600 ft spacer will be run ahead of the cement slurry to avoid mud contamination of the cement. WOC 12 hours. If cement does not circ. to surface, a temperature log will be run after 8 hours to determine TOC.

*Top 1st 50' of class B of 220 CF*  
 5 1/2" production casing (uncemented).

OIL CONSERVATION DIVISION

P.O. Box 2088  
Santa Fe, New Mexico 87504-2088

DISTRICT I  
P.O. Box 1980, Hobbs, NM 88240

DISTRICT II  
P.O. Drawer DD, Artesia, NM 88210

DISTRICT III  
1000 Rio Brazos Rd., Aztec, NM 87410

WELL LOCATION AND ACREAGE DEDICATION PLAT

All Distances must be from the outer boundaries of the section

Operator Meridian Oil Inc.		Lease Quinn		Well No. 342	
Unit Letter A	Section 19	Township 31 North	Range 8 West	County San Juan	
Actual Footage Location of Well: 835 feet from the North line and 1240 feet from the East line					
Gross level Elev. 6486'	Producing Formation Fruitland Coal		Pool Basin	Dedicated Acreage: 320 Acres	

- Outline the acreage dedicated to the subject well by colored pencil or hectare marks on the plat below.
- If more than one lease is dedicated to the well, outline each and identify the ownership thereof (both as to working interest and royalty).
- If more than one lease of different ownership is dedicated to the well, have the interest of all owners been consolidated by communitization, unitization, force-pooling, etc?  
☐ Yes ☐ No If answer is "yes" type of consolidation \_\_\_\_\_  
If answer is "no" list the owners and tract descriptions which have actually been consolidated. (Use reverse side of this form if necessary).  
No allowable will be assigned to the well until all interests have been consolidated (by communitization, unitization, forced-pooling, or otherwise) or until a non-standard unit, eliminating such interest, has been approved by the Division.

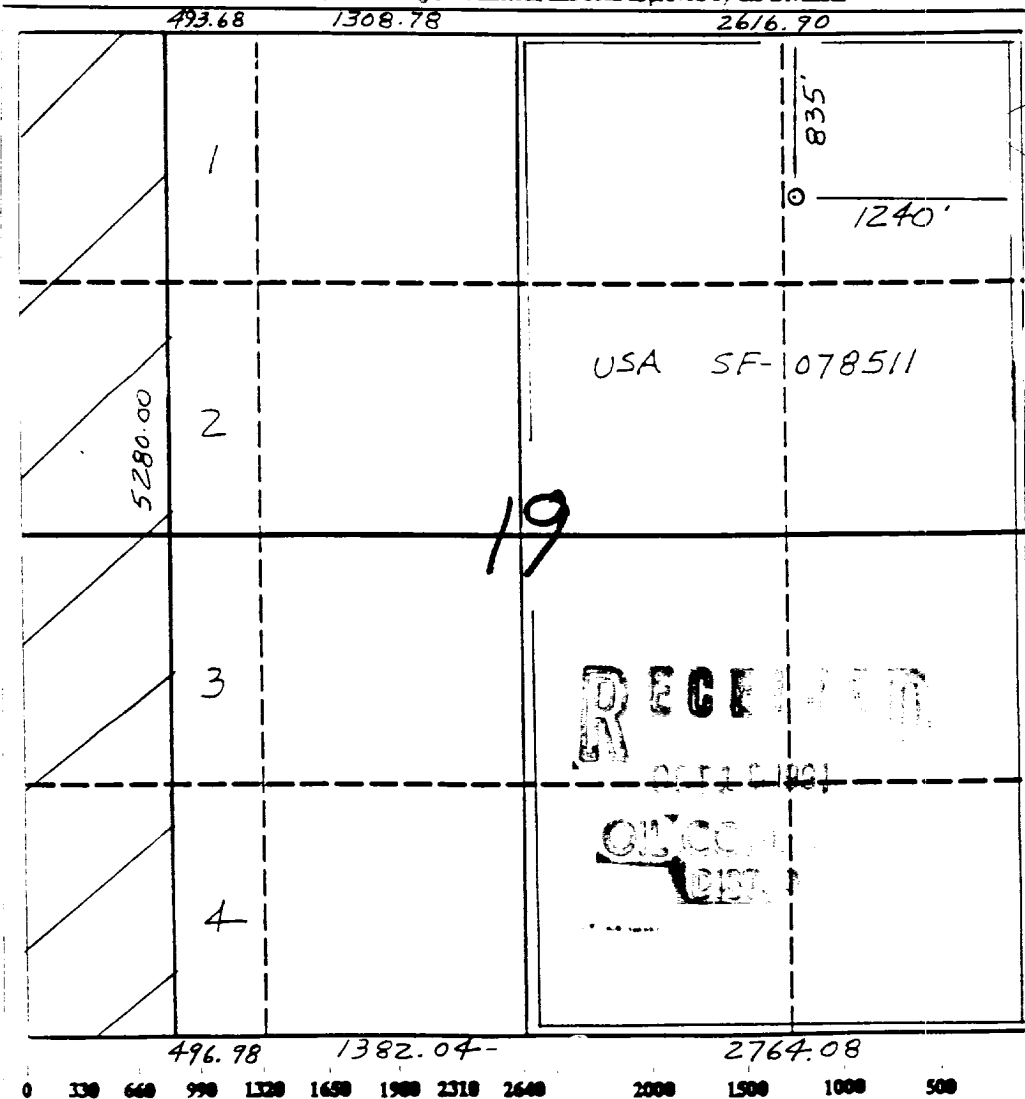

OPERATOR CERTIFICATION

I hereby certify that the information contained herein is true and complete to the best of my knowledge and belief.

Signature  
Peggy Bradfield  
Printed Name  
Regulatory Affairs  
Position  
Meridian Oil Inc.  
Company

Date

SURVEYOR CERTIFICATION

I hereby certify that the well location shown on this plat was plotted from field notes of actual surveys made by me or under my supervision, and that the same is true and correct to the best of my knowledge and belief.

8-2-91

Date Surveyed

Signature  
Professional Surveyor



Certificate No.  
Neale C. Edwards

Quinn #342

T 31 N, R 08 W

No New Construction

Section 19: NENE

1500'

18: SESE

200'

17: S2S2

5600'

MERIDIAN OIL INC

NEW BLM

R-O-W

STATE

LANDS

17

16

Northus #716  
PUMP

Bull  
Spring

SCALE 1:24 000

MILES