

F

30-045-27774

04-26-90

F. Loc. 1700/S; 1810/W Elev. 6141 GL Spd. \_\_\_\_\_ Comp. \_\_\_\_\_ TD \_\_\_\_\_ PB \_\_\_\_\_  
 Cu. ft. \_\_\_\_\_ Cu. ft. \_\_\_\_\_  
 Casing S. \_\_\_\_\_ @ \_\_\_\_\_ W \_\_\_\_\_ Sx. \_\_\_\_\_ Int. \_\_\_\_\_ @ \_\_\_\_\_ W \_\_\_\_\_ Sx. \_\_\_\_\_ T. \_\_\_\_\_ @ \_\_\_\_\_  
 Csg. Perf. \_\_\_\_\_ Prod. Stim. \_\_\_\_\_

T  
R  
A  
N  
S

Grav. \_\_\_\_\_ 1st Del. Gas \_\_\_\_\_  
 I.P. \_\_\_\_\_ BO/D \_\_\_\_\_ MCF/D After \_\_\_\_\_ Hrs. SICP \_\_\_\_\_ PSI After \_\_\_\_\_ Days GOR \_\_\_\_\_ 1st Del. Oil \_\_\_\_\_

TOPS		NiTD	X	Well Log	TEST DATA							Ref.No.
					Schd.	PC	Q	PW	PD	D		
Ojo Alamo		C-103		Plat X								
Kirtland		C-104		Electric Log								
Fruitland				C-122								
Pictured Cliffs		Ditr		Dfa								
Chacra		Datr		Dac								
Cliff House												
Menefee												
Point Lookout												
Mancos												
Gallup												
Greenhorn												
Dakota												
Entrada												
				Acres S/320								

P  
o  
o

BasinFrCoal Co. SJ S 15 T 30N R 09W U K Oper. Amoco Production Co. Lse. Elmer E. Elliott A No. 5

Elmer E. Elliott A #5

K-15-30N-09W

AMOCO PRODUCTION CO.



# United States Department of the Interior

BUREAU OF LAND MANAGEMENT  
FARMINGTON RESOURCE AREA  
1235 LAPLATA HIGHWAY  
FARMINGTON, NEW MEXICO 87401



IN REPLY REFER TO:

SF-080243 et. al. (WC)  
3162.3-1.0 (019)

JUL 18 1991

Amoco Production Company  
PO Box 800  
Denver, Colorado 80201

**RECEIVED**

JUL 19 1991

**OIL CON. DIV.,  
DIST. 3**

Gentlemen:

Enclosed are your Applications for Permit to Drill well Nos.:

1. No. 3 Florance Gas Com I, sec. 18, T 30 N, R 9 W, SF-080243
2. No. 3 Florance "AA", sec. 8, T 30 N, R 9 W, SF-078129-A
3. No. 3 Florance "AE", sec. 25, T 30 N, R 10 W, SF-080776
4. No. 7 Florance "AD", sec. 24, T 30 N, R 10 W, SF-078116
5. No. 9 Riddle "H", sec. 17, T 30 N, R 9 W, SF-080244
6. No. 5 Elmer E. Elliott "A", sec. 15, T 30 N, R 9 W, SF-078139
7. No. 3 Giomi Gas Com "C", sec. 28, T 30 N, R 9 W, SF-078042
8. No. 1 Walker Gas Com A, sec. 31, T 31 N, R 9 W, SF-078316-F
9. No. 1 Riddle Gas Com C, sec. 30, T 31 N, R 9 W, SF-078319-A

All of the above referenced wells are located in San Juan County, New Mexico. As Discussed with Cindy Burton of your company on June 27, 1991, the subject APDs are rescinded and returned due to drilling not being commenced within one year of the approval date.

You are required to request surface rehabilitation instructions from this office if construction activities occurred on the referenced drill sites. If this office does not receive comment within 30 days, we will presume that no construction occurred and proceed accordingly. Later discovery that construction activities have in fact occurred, may result in assessment of liquidated damages.

Sincerely,

/s/ John L. Keller

John L. Keller  
Chief, Branch of Mineral Resources

9 Enclosures

cc:

~~New Mexico Oil Conservation Division~~, 1000 Rio Brazos Rd., Aztec, NM 87410

## ABANDONED LOCATION

UNITED STATES  
DEPARTMENT OF THE INTERIOR  
BUREAU OF LAND MANAGEMENT

APPLICATION FOR PERMIT TO DRILL, DEEPEN, OR PLUG BACK

1A. TYPE OF WORK

DRILL ☒

DEEPEN ☐

PLUG BACK ☐

B. TYPE OF WELL

OIL  
WELL ☐

GAS  
WELL ☒

OTHER

Coal Seam

SINGLE  
ZONE ☒

MULTIPLE  
ZONE ☐

2. NAME OF OPERATOR

Amoco Production Company

ATTN: J. L. Hampton

3. ADDRESS OF OPERATOR

P. O. Box 800 Denver, Colorado 80201

4. LOCATION OF WELL (Report location clearly and in accordance with any State requirements.)\*

At surface

1700' FSL, 1810' FWL

NE/SW

At proposed prod. zone

same

14. DISTANCE IN MILES AND DIRECTION FROM NEAREST TOWN OR POST OFFICE\*

15 miles from Aztec, NM

15. DISTANCE FROM PROPOSED\*

LOCATION TO NEAREST  
PROPERTY OR LEASE LINE, FT.  
(Also to nearest drig. unit line, if any)

1700'

18. DISTANCE FROM PROPOSED LOCATION\*

TO NEAREST WELL, DRILLING, COMPLETED,  
OR APPLIED FOR, ON THIS LEASE, FT.

16. NO. OF ACRES IN LEASE

2,560'

19. PROPOSED DEPTH

3082 TD

17. NO. OF ACRES ASSIGNED  
TO THIS WELL

320 acres S/2

20. ROTARY OR CABLE TOOLS

Rotary

21. ELEVATIONS (Show whether DF, RT, GR, etc.)

6141 GR

22. APPROX. DATE WORK WILL START\*

As soon as permitted

23. ATTACHED

PROPOSED CASING AND CEMENTING PROGRAM

This action is subject to technical and  
procedural review pursuant to 43 CFR 3165.3  
and appeal pursuant to 43 CFR 3165.4.

SIZE OF HOLE	SIZE OF CASING	WEIGHT PER FOOT	SETTING DEPTH
12 1/4"	8 5/8"	24#	250'
7 7/8"	5 1/2"	17#	3082' (TD)

250 cf (cement to surface)  
863 cf (cement to surface)

Notice of Staking was submitted: 3-22-90

Lease Description:

T30N-R9W

Sec. 9: NW/4, W/2 NE/4, SE/4NE/4, SE/4, SE/4 SW/4

Sec. 15: S/2

Sec. 26: W/2, W/2 E/2

Sec. 27: All

Sec. 33: N/2 NE/4, S/2 SW/4, SW/4 SE/4

Sec. 34: NE/4, N/2 NW/4, SW/4 NW/4

Sec. 35: N/2 Nw/4, SW/4 NW/4, Nw/4 Ne/4

RECEIVED

APR 26 1990

OIL CON. DIV.  
DIST. 3

"Approval of this action does  
not warrant that the applicant  
holds legal or equitable rights  
or title to this lease."

IN ABOVE SPACE DESCRIBE PROPOSED PROGRAM: If proposal is to deepen or plug back, give data on present productive zone and proposed new productive zone. If proposal is to drill or deepen directionally, give pertinent data on subsurface locations and measured and true vertical depths. Give blowout prevention program, if any.

24. J. L. Hampton

SIGNED

J. L. Hampton

TITLE Sr. Staff Admin. Supv.

DATE

3/30/90

(This space for Federal or State office use)

PERMIT NO.

APPROVAL DATE

APPROVED  
AS AMENDED

APPROVED BY

CONDITIONS OF APPROVAL, IF ANY:

TITLE

APR 23 1990

AREA MANAGER

\*See Instructions On Reverse Side

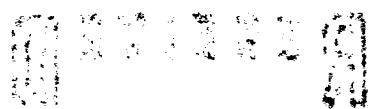

the 1990s, the number of people in the world who are undernourished has declined from 1.1 billion to 800 million. The number of people who are malnourished has declined from 1.5 billion to 1 billion. The number of people who are obese has increased from 100 million to 300 million. The number of people who are overweight has increased from 100 million to 300 million. The number of people who are obese and overweight has increased from 100 million to 300 million. The number of people who are obese and overweight has increased from 100 million to 300 million.

Submit to Appropriate  
District Office  
State Lease - 4 copies  
Fee Lease - 3 copies

State of New Mexico  
Energy, Minerals and Natural Resources Department

Form C-102  
Revised 1-1-89

OIL CONSERVATION DIVISION

DISTRICT I  
P.O. Box 1980, Hobbs, NM 88240

P.O. Box 2088

Santa Fe, New Mexico 87504-2088

DISTRICT II  
P.O. Drawer DD, Artesia, NM 88210

DISTRICT III  
1000 Rio Brazos Rd., Aztec, NM 87410

WELL LOCATION AND ACREAGE DEDICATION PLAT

All Distances must be from the outer boundaries of the section

Operator <b>AMOCO PRODUCTION COMPANY</b>			Lease <b>ELMER E. ELLIOTT /A/</b>		Well No. <b># 5</b>
Unit Letter <b>K</b>	Section <b>15</b>	Township <b>30 NORTH</b>	Range <b>9 WEST</b>	County <b>SAN JUAN</b>	

Actual Footage Location of Well:

1700 feet from the **SOUTH** line and 1810 feet from the **WEST** line

Ground level Elev. <b>6141</b>	Producing Formation <b>Fruitland Coal</b>	Pool <b>Basin Fruitland Coal</b>	Dedicated Acreage <b>5 1/2</b>	<b>320.0</b> Acres
-----------------------------------	--	-------------------------------------	-----------------------------------	-----------------------

1. Outline the acreage dedicated to the subject well by colored pencil or hatchure marks on the plat below.
2. If more than one lease is dedicated to the well, outline each and identify the ownership thereof (both as to working interest and royalty).
3. If more than one lease of different ownership is dedicated to the well, have the interest of all owners been consolidated by communization, unitization, force-pooling, etc?  
☐ Yes ☐ No If answer is "yes" type of consolidation \_\_\_\_\_  
If answer is "no" list the owners and tract descriptions which have actually been consolidated. (Use reverse side of this form if necessary). \_\_\_\_\_  
No allowable will be assigned to the well until all interests have been consolidated (by communization, unitization, forced-pooling, or otherwise) or until a non-standard unit, eliminating such interest, has been approved by the Division.

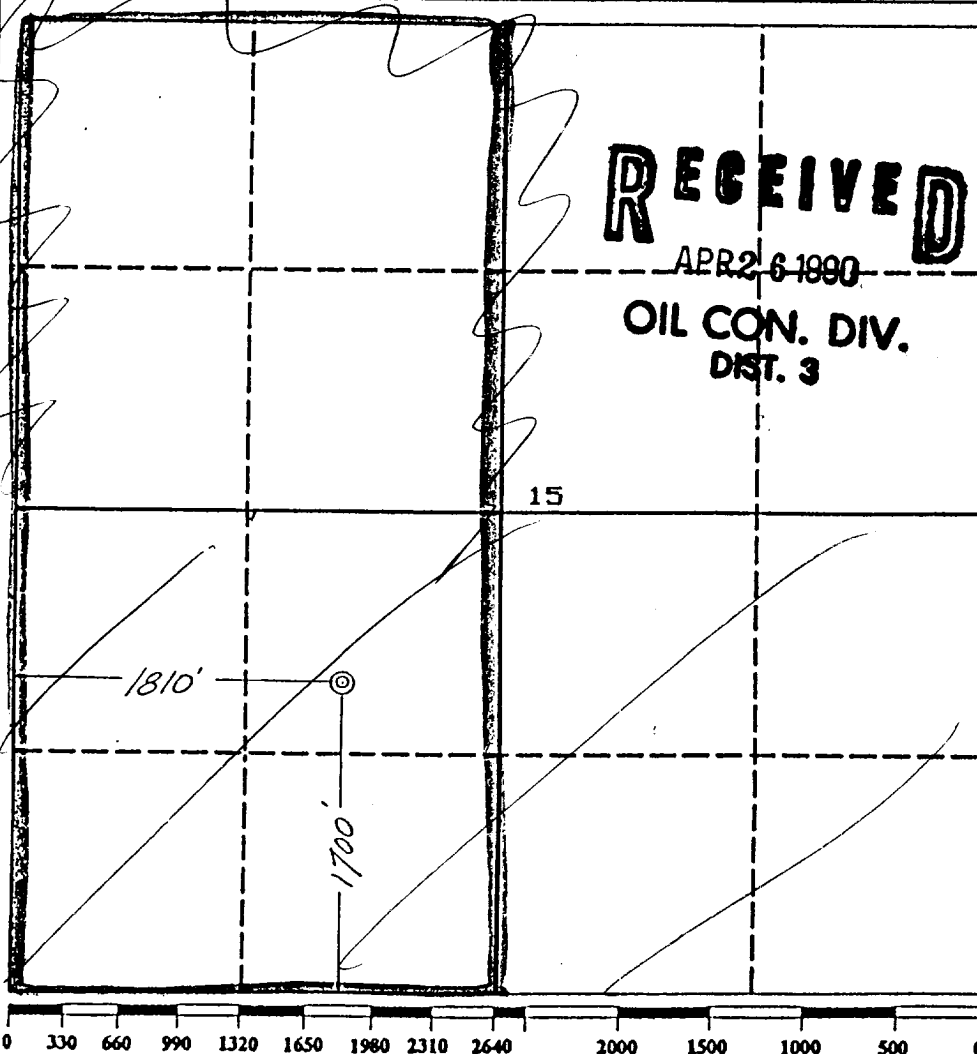

OPERATOR CERTIFICATION

I hereby certify that the information contained herein is true and complete to the best of my knowledge and belief.

Signature *J. Hampton/CBS*  
Printed Name **T.L. Hampton**  
Position **Sr. Staff Admin Supr**  
Company **Amoco Prod. Company**  
Date **3/21/90**

SURVEYOR CERTIFICATION

I hereby certify that the well location shown on this plat was plotted from field notes of actual surveys made by me or under my supervision, and that the same is true and correct to the best of my knowledge and belief.

Date Surveyed **March 16, 1990**

Signature & Seal of Professional Surveyor **GARY D. VANN**  
Registered Professional Land Surveyor  
New Mexico  
7016

RECEIVED

U.S. 1960

DEPT. OF COM. DIV.  
C. 1210

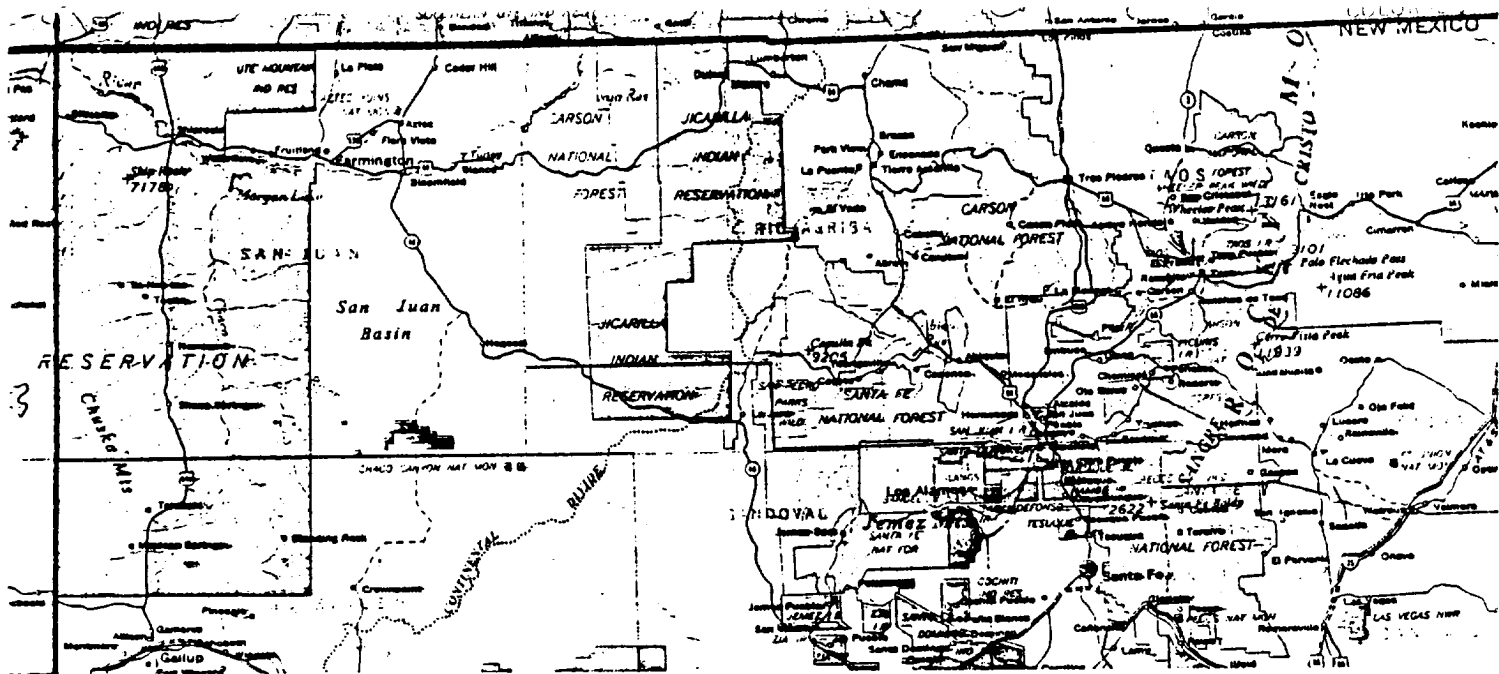

ELMER E. ELLIOTT /A/ # 5

1700' F/SL 1810' F/WL

SEC. 15, T30N, R9W, . NMPM

RAIL POINT: 157 miles from Montrose, Co.

MUD POINT: 15 miles from Aztec, NM

CEMENT POINT: 29 miles from Farmington, NM

