

UNITED STATES
DEPARTMENT OF THE INTERIOR
BUREAU OF LAND MANAGEMENT

30-045-28632

APPLICATION FOR PERMIT TO DRILL, DEEPEN, OR PLUG BACK

1a. TYPE OF WORK
DRILL ☒ DEEPEN ☐ PLUG BACK ☐

b. TYPE OF WELL
OIL WELL ☐ GAS WELL ☒ OTHER ☐
SINGLE ZONE ☒ MULTIPLE ZONE ☐

2. NAME OF OPERATOR
Amoco Production Company ATTN: J.L. Hampton

3. ADDRESS OF OPERATOR
P. O. Box 800 Denver, Colorado 80201

4. LOCATION OF WELL (Report location clearly and in accordance with any State requirements.)
At surface 1730' FSL, 810' FEL NE/SE
At proposed prod. zone

14. DISTANCE IN MILES AND DIRECTION FROM NEAREST TOWN OR POST OFFICE*
57 Miles from Aztec, NM

10. DISTANCE FROM PROPOSED* LOCATION TO NEAREST PROPERTY OR LEASE LINE, FT.
(Also to nearest drlg. unit line, if any) 810'

18. DISTANCE FROM PROPOSED LOCATION* TO NEAREST WELL, DRILLING, COMPLETED, OR APPLIED FOR, ON THIS LEASE, FT.

21. ELEVATIONS (Show whether DF, RT, GR, etc.)
6453' GR

23. This action is subject to technical and procedural review and approval pursuant to 43 CFR 3165.4

SIZE OF HOLE	SIZE OF CASING	WEIGHT PER FOOT	SETTING DEPTH
12 1/4"	9 5/8"	36#	400'
8 3/4"	7"	23#	3650'
6 1/4"	4 1/2" Liner	11.6#	8200'

16. NO. OF ACRES IN LEASE
2560 Acres

17. NO. OF ACRES ASSIGNED TO THIS WELL
320 acres S/2

20. ROTARY OR CABLE TOOLS
Rotary

22. APPROX. DATE WORK WILL START*

DRILLING OPERATIONS AUTHORIZED ARE
SUBJECT TO QUANTITY OF CEMENT ATTACHED
GENERAL REQUIREMENTS:
320 cf C1 B (cement to surface)
1022 cf C1 B (cement to surface)
566 cf C1 B (cement to surface)

[TD - (ICP-200) X .13]

Notice of Staking was submitted: 10/7/91

Lease Description: T31N-R7W

Sec. 22: All
Sec. 27: All
Sec. 34: All
Sec. 35: All

RECEIVED
NOV 2 1991
OIL CON. DIV.
DIST. 3

RECEIVED
BLM
91 OCT 22 AM 10:14
OIL CON. DIV., N.M.

IN ABOVE SPACE DESCRIBE PROPOSED PROGRAM: If proposal is to deepen or plug back, give data on present productive zone and proposed new productive zone. If proposal is to drill or deepen directionally, give pertinent data on subsurface locations and measured and true vertical depths. Give blowout preventer program, if any.

24. SIGNED J. Hampton/CUB TITLE Sr. Staff Admin. Supervisor DATE 10/21/91
(This space for Federal or State office use)

APPROVED
AS AMENDED

PERMIT NO. APPROVAL DATE

APPROVED BY TITLE

CONDITIONS OF APPROVAL, IF ANY:

NOV 8 1991
AREA MANAGER

Hold C-104 For N/2 Dedication of NEBU #55
NMOC

*See Instructions On Reverse Side

RECEIVED
JAN 12 1971
U.S. AIR FORCE
HONOLULU, HAWAII

APPROVED
AS AMBASSADOR

1971 JAN 12

Submit to Appropriate
District Office
State Lease - 4 copies
Fee Lease - 3 copies

State of New Mexico
Energy, Minerals and Natural Resources Department

Form C-102
Revised 1-1-89

OIL CONSERVATION DIVISION

P.O. Box 2088
Santa Fe, New Mexico 87504-2088

DISTRICT I
P.O. Box 1980, Hobbs, NM 88240

DISTRICT II
P.O. Drawer DD, Artesia, NM 88210

DISTRICT III
1000 Rio Brazos Rd., Aztec, NM 87410

WELL LOCATION AND ACREAGE DEDICATION PLAT

All Distances must be from the outer boundaries of the section

Operator AMOCO PRODUCTION COMPANY			Lease NE BLANCO Unit		Well No. # 5055
Unit Letter I	Section 22	Township 31 NORTH	Range 7 WEST	County SAN JUAN	
Actual Footage Location of Well: 1730 feet from the SOUTH line and 810 feet from the EAST line					
Ground level Elev. 6453	Producing Formation Dakota		Pool Basin Dakota		Dedicated Acreage: S/2 320 Acres

- Outline the acreage dedicated to the subject well by colored pencil or hatchure marks on the plat below.
- If more than one lease is dedicated to the well, outline each and identify the ownership thereof (both as to working interest and royalty).
- If more than one lease of different ownership is dedicated to the well, have the interest of all owners been consolidated by communitization, unitization, force-pooling, etc.?
☐ Yes ☐ No If answer is "yes" type of consolidation _____
If answer is "no" list the owners and tract descriptions which have actually been consolidated. (Use reverse side of this form if necessary).
No allowable will be assigned to the well until all interests have been consolidated (by communitization, unitization, forced-pooling, or otherwise) or until a non-standard unit, eliminating such interest, has been approved by the Division.

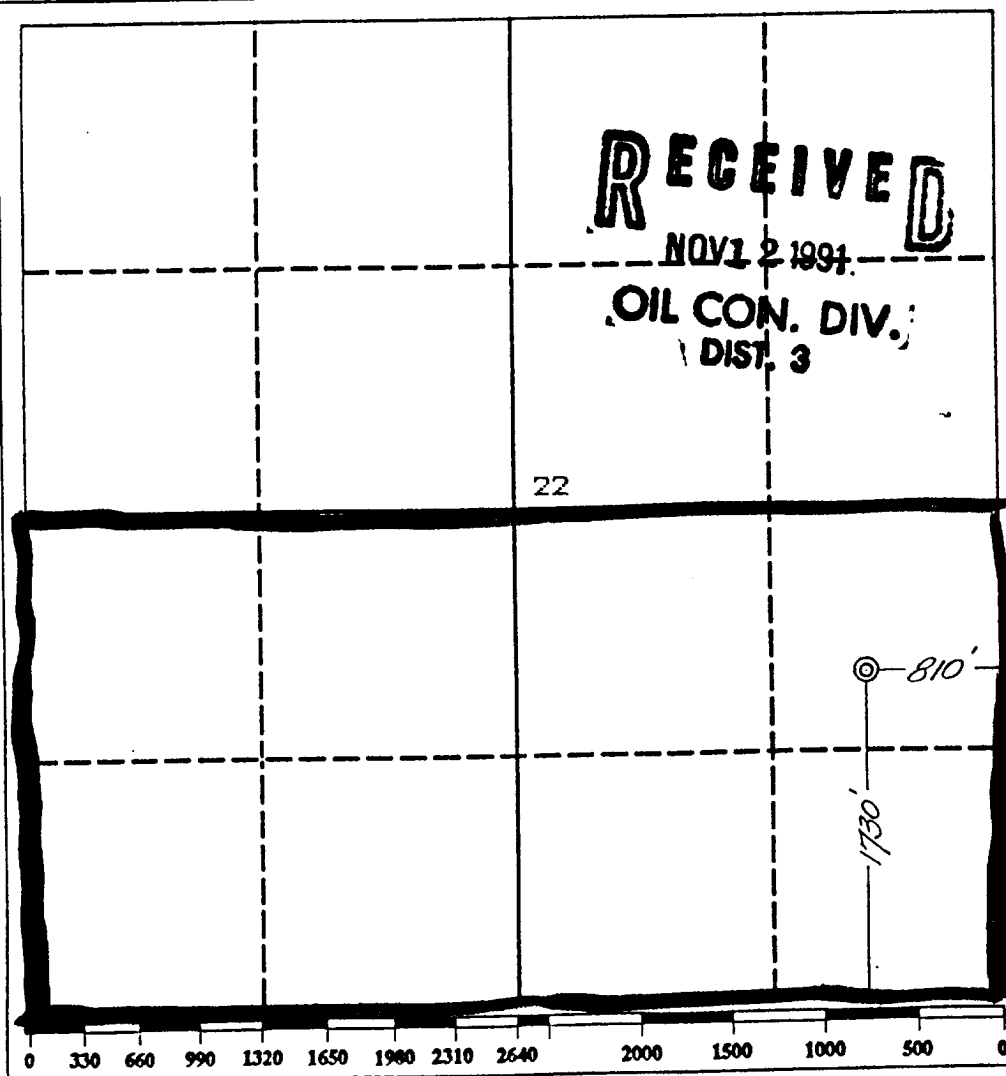

OPERATOR CERTIFICATION

I hereby certify that the information contained herein is true and complete to the best of my knowledge and belief.

Signature *[Signature]*
Printed Name **JL Hampton**
Position **Sr. Staff Admin Sup**
Company **Amoco Production Co**
Date **10/16/91**

SURVEYOR CERTIFICATION

I hereby certify that the well location shown on this plat was plotted from field notes of actual surveys made by me or under my supervision, and that the same is true and correct to the best of my knowledge and belief.

Date Surveyed
October 1, 1991

Signature & Seal of
Professional Surveyor

GARY D. VANN
7016
Certification
7016

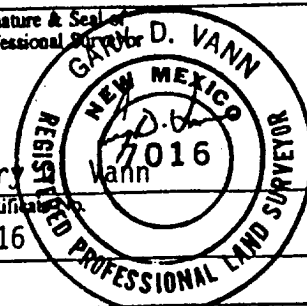

RECEIVED
JAN 10 1964
U.S. DEPT. OF JUSTICE
FEDERAL BUREAU OF INVESTIGATION
WASHINGTON, D.C.

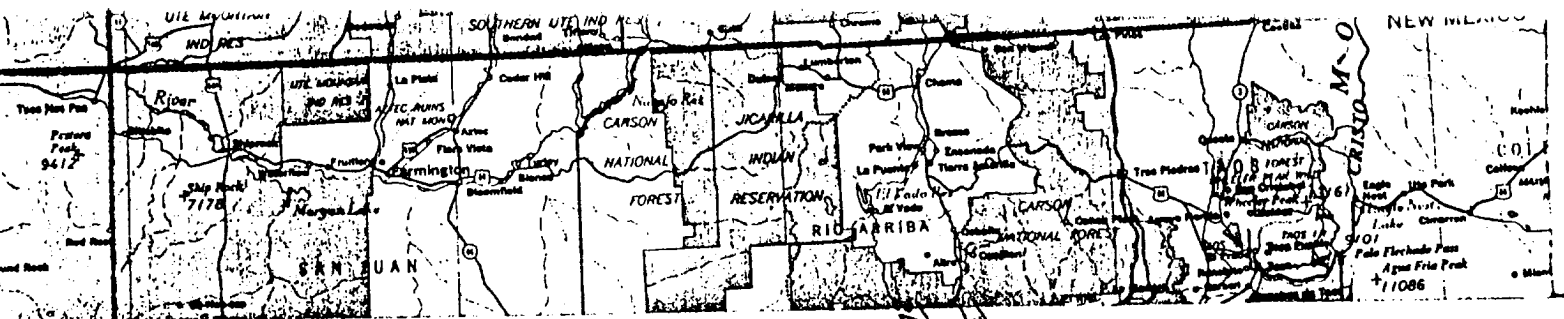

(TURN-OFF IS
1.1 MILE FROM
STATE LINE)

COLORADO
NEW MEXICO

COLORADO
NEW MEXICO

NE BLANCO # 305
1730' F/SL B10' F/EL
SEC. 22, T31N, R7W, NMFP
RAIL POINT: 200 miles - Montrose
MUD POINT: 57 miles - Aztec
CEMENT POINT: 71 miles - Farmington

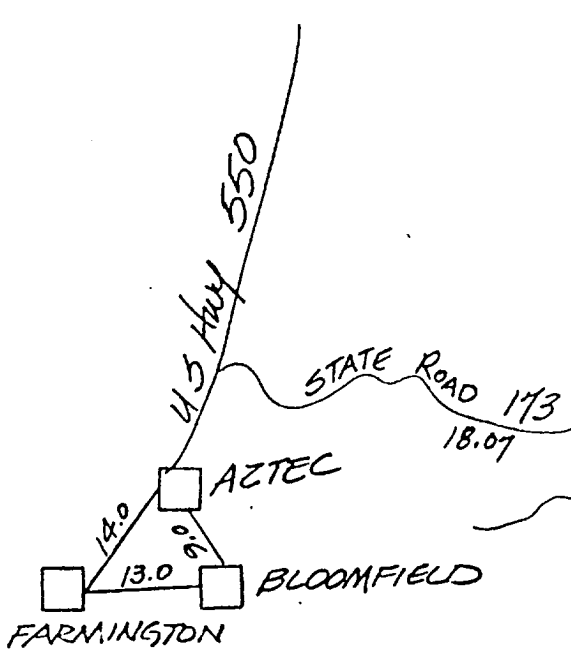
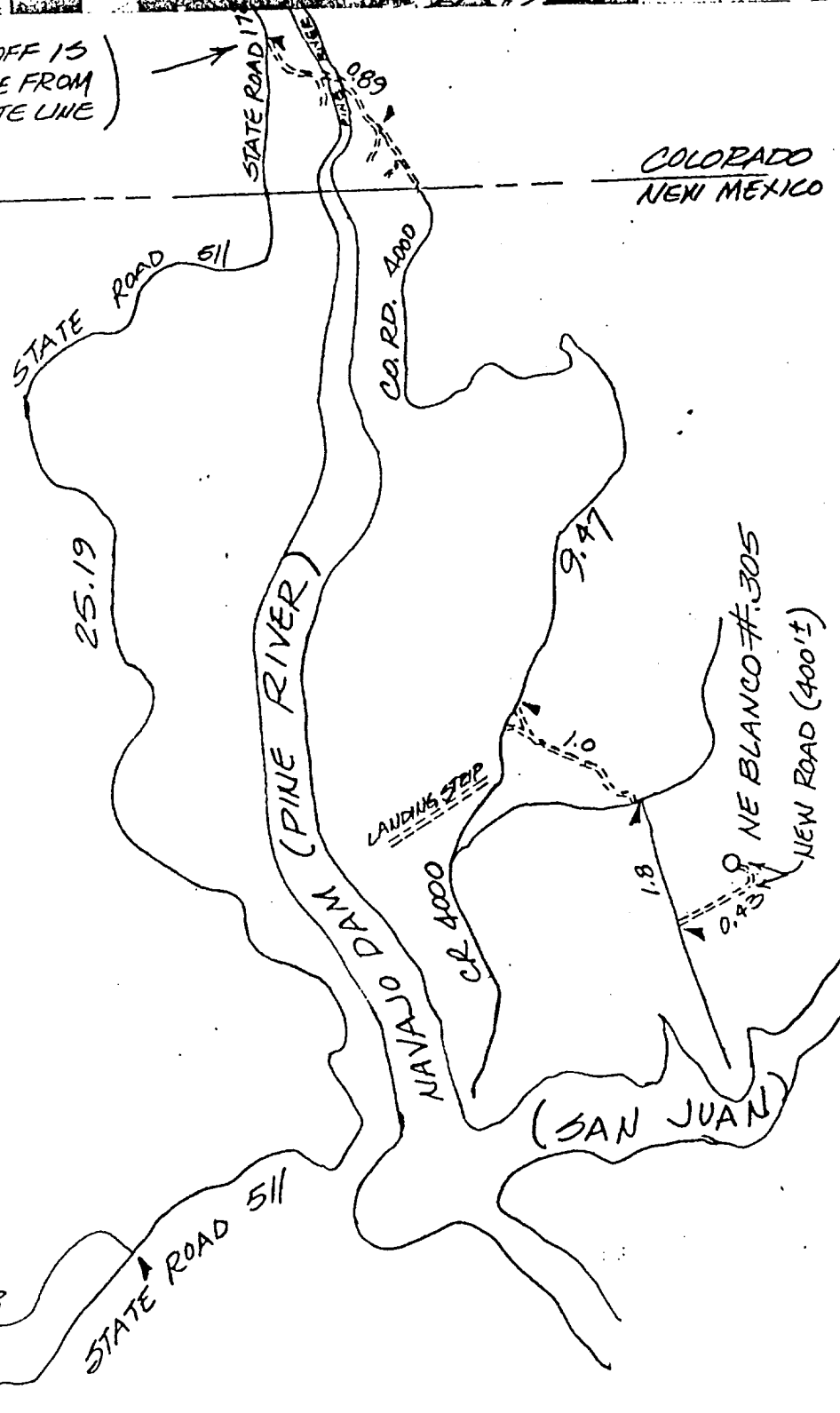

NE BLANCO #305
NEW ROAD (400'±)

