

UNITED STATES
DEPARTMENT OF THE INTERIOR
BUREAU OF LAND MANAGEMENT

Form approved.
Budget Bureau No. 1004-0136
Expires: December 31, 1991

RECEIVED
93 JUN 25 AM 9:47

APPLICATION FOR PERMIT TO DRILL OR DEEPEN

1a. TYPE OF WORK
b. TYPE OF WELL
OIL WELL ☐ GAS WELL ☒ OTHER ☐
DEEPEN ☐ SINGLE ZONE ☐ MULTIPLE ZONE ☒

2. NAME OF OPERATOR
Amoco Production Company
Attention: Lori Arnold

3. ADDRESS AND TELEPHONE NO.
P.O. Box 800, Denver, Colorado 80201 (303) 830-5651

4. LOCATION OF WELL (Report location clearly and in accordance with any State requirements. *)
At surface 1005 FNL 1605
At proposed prod. zone

5. LEASE DESIGNATION AND SERIAL NO.
SF-078386

6. IF INDIAN, ALLOTTEE OR TRIBE NAME

7. UNIT AGREEMENT NAME

8. FARM OR LEASE NAME, WELL NO.
San Juan Unit 32-9 114

9. API WELL NO.
30-045-28988

10. FIELD AND POOL, OR WILDCAT
71549 Basin Dakota/Blanco Pictured Cliffs

11. SEC., T., R., M., OR BLK. AND SURVEY OR AREA
Section 17
Township 31N Range 9W

12. COUNTY OR PARISH
San Juan

13. STATE
New Mexico

14. DISTANCE IN MILES AND DIRECTION FROM NEAREST TOWN OR POST OFFICE*
13.26 Miles from Aztec, NM

15. DISTANCE FROM PROPOSED* LOCATION TO NEAREST PROPERTY OR LEASE LINE, FT. (Also to nearest drlg. unit line, if any)

16. NO. OF ACRES IN LEASE
1260.44

17. NO. OF ACRES ASSIGNED TO THIS WELL
716.41 157.28
320 E/2 400 NE/4

18. DISTANCE FROM PROPOSED LOCATION* TO NEAREST WELL, DRILLING, COMPLETED, OR APPLIED FOR, ON THIS LEASE, FT.

19. PROPOSED DEPTH
8185

20. ROTARY OR CABLE TOOLS
Rotary

21. ELEVATIONS (Show whether DF, RT, GR., etc.)
6628' GR

22. APPROX. DATE WORK WILL START*
ASAP

23. PROPOSED CASING AND CEMENTING PROGRAM

SIZE OF HOLE	GRADE, SIZE OF CASING	WEIGHT PER FOOT	SETTING DEPTH	QUANTITY OF CEMENT
12 1/4 "	9 5/8" K-55	36#	400'	282cf CI B W/2% CaCl2 (Cement to surface)
8 3/4"	7" K-55	23#	3703'	1034cf CI B (Cement to surface)
6 1/4"	4 1/2" N-80	11.6#	8185'-3603'	785cf CI G

Notice of Staking was submitted 5/17/93 under the temporary name of Reference 28.

Lease Description: T31N-R9W

Sec 15: Lots 1(39.27), 2(39.30), 3(39.33), 4(39.36), 5(39.41), 6(39.38), 7(39.35), 8(39.32), 9(39.37), 10(39.40), 11(39.43), 12(39.46), 13(39.51), 14(39.48), 15(39.45), 16(39.42) (all).

Sec 17: Lots 1(39.29), 2(39.12), 3(38.96), 4(38.79), 5(39.03), 6(39.19), 7(39.35), 8(39.52), 9(39.75), 10(39.58), 11(39.42), 12(39.26), 13(39.49), 14(39.65), 15(39.82), 16(39.98) (all).

RECEIVED

AUG 18 1993

OIL CON. DIV
DIST. 3

IN ABOVE SPACE DESCRIBE PROPOSED PROGRAM: If proposal is to deepen, give data on present productive zone and proposed new productive zone. If proposal is to drill or deepen directionally, give pertinent data on subsurface locations and measured and true vertical depths. Give blowout preventer program, if any.

24. SIGNED Jori Arnold TITLE Business Analyst DATE 06-23-1993

(This space for Federal or State office use)

PERMIT NO. APPROVAL DATE

Application approval does not warrant or certify that the applicant holds legal or equitable title to those rights in the subject lease which would entitle the applicant to conduct operations thereon.

CONDITIONS OF APPROVAL, IF ANY:

APPROVED BY [Signature] TITLE NMOOD DATE AUG 11 1993
DISTRICT MANAGER

*See Instructions On Reverse Side

Title 18 U.S.C. Section 1001, makes it a crime for any person knowingly and willfully to make to any department or agency of the United States any false, fictitious or fraudulent statements or representations as to any matter within its jurisdiction.

Submit to Appropriate
District Office
State Lease - 4 copies
Fee Lease - 3 copies

Energy, Minerals and Natural Resources Department

Form C-102
Revised 1-1-89

OIL CONSERVATION DIVISION

P.O. Box 2088
Santa Fe, New Mexico 87504-2088

RECEIVED
BLM

DISTRICT I
P.O. Box 1980, Hobbs, NM 88240

DISTRICT II
P.O. Drawer DD, Artesia, NM 88210

DISTRICT III
1000 Rio Brazos Rd., Aztec, NM 87410

WELL LOCATION AND ACREAGE DEDICATION PLAT

All Distances must be from the outer boundaries of the section.

93 JUN 25 AM 9:47

070 FARMINGTON, NM

Operator AMOCO PRODUCTION COMPANY			Lease San Juan 32-9 Unit		Well No. 114
Unit Letter B	Section 17	Township 31 NORTH	Range 9 WEST	County SAN JUAN	
Actual Footage Location of Well: 1005 feet from the NORTH line and 1605 feet from the EAST line					
Ground level Elev. 6628	Producing Formation Basin Dakota		Pool Basin Dakota	Dedicated Acreage: 320 E/2 316.41 Acres	

- Outline the acreage dedicated to the subject well by colored pencil or hashure marks on the plat below.
- If more than one lease is dedicated to the well, outline each and identify the ownership thereof (both as to working interest and royalty).
- If more than one lease of different ownership is dedicated to the well, have the interest of all owners been consolidated by communitization, unitization, force-pooling, etc?
☐ Yes ☐ No If answer is "yes" type of consolidation _____
If answer is "no" list the owners and tract descriptions which have actually been consolidated. (Use reverse side of this form if necessary). _____
No allowable will be assigned to the well until all interests have been consolidated (by communitization, unitization, forced-pooling, or otherwise) or until a non-standard unit, eliminating such interest, has been approved by the Division.

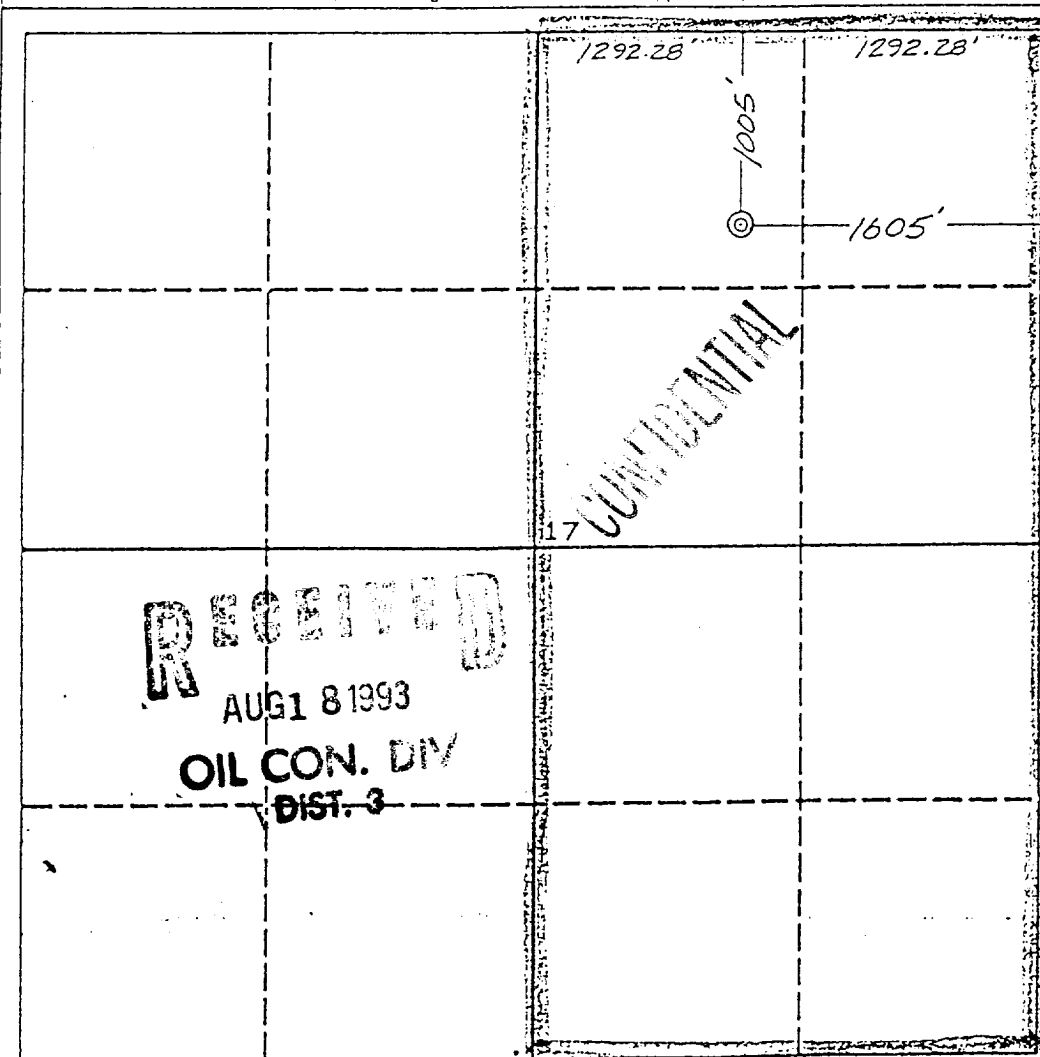

OPERATOR CERTIFICATION

I hereby certify that the information contained herein is true and complete to the best of my knowledge and belief.

Lori Arnold
Signature
Lori Arnold
Printed Name
Business Analyst
Position
Amoco Production Co.
Company
5/17/93
Date

SURVEYOR CERTIFICATION

I hereby certify that the well location shown on this plat was plotted from field notes of actual surveys made by me or under my supervision, and that the same is true and correct to the best of my knowledge and belief.

Date Surveyed
April 6, 1993

Signature & Seal of
Professional Surveyor **D. VANN**

GARY D. VANN
Registered Professional Land Surveyor
7016
Certification No.

Submit to Appropriate
District Office
State Lease - 4 copies
Fee Lease - 3 copies

State of New Mexico
Energy, Minerals and Natural Resources Department

Form C-102
Revised 1-1-89

OIL CONSERVATION DIVISION

DISTRICT I
P.O. Box 1980, Hobbs, NM 88240

P.O. Box 2088

Santa Fe, New Mexico 87504-2088

DISTRICT II
P.O. Drawer DD, Artesia, NM 88210

DISTRICT III
1000 Rio Brazos Rd., Aztec, NM 87410

WELL LOCATION AND ACREAGE DEDICATION PLAT

All Distances must be from the outer boundaries of the section

Operator AMOCO PRODUCTION COMPANY			Lease San Juan 32-9 Unit		Well No. 114
Unit Letter B	Section 17	Township 31 NORTH	Range 9 WEST	County NMPM	SAN JUAN
Actual Footage Location of Well: 1005 feet from the NORTH line and 1605 feet from the EAST line					
Ground level Elev. 6628	Producing Formation Blanco PC		Pool Blanco PC	Dedicated Acreage: 160 NE/4 57.28 Acres	

- Outline the acreage dedicated to the subject well by colored pencil or hashure marks on the plat below.
- If more than one lease is dedicated to the well, outline each and identify the ownership thereof (both as to working interest and royalty).
- If more than one lease of different ownership is dedicated to the well, have the interest of all owners been consolidated by communitization, unitization, force-pooling, etc?
☐ Yes ☐ No If answer is "yes" type of consolidation _____
If answer is "no" list the owners and tract descriptions which have actually been consolidated. (Use reverse side of this form if necessary.) _____
No allowable will be assigned to the well until all interests have been consolidated (by communitization, unitization, forced-pooling, or otherwise) or until a pool-standard unit, eliminating such interest, has been approved by the Division.

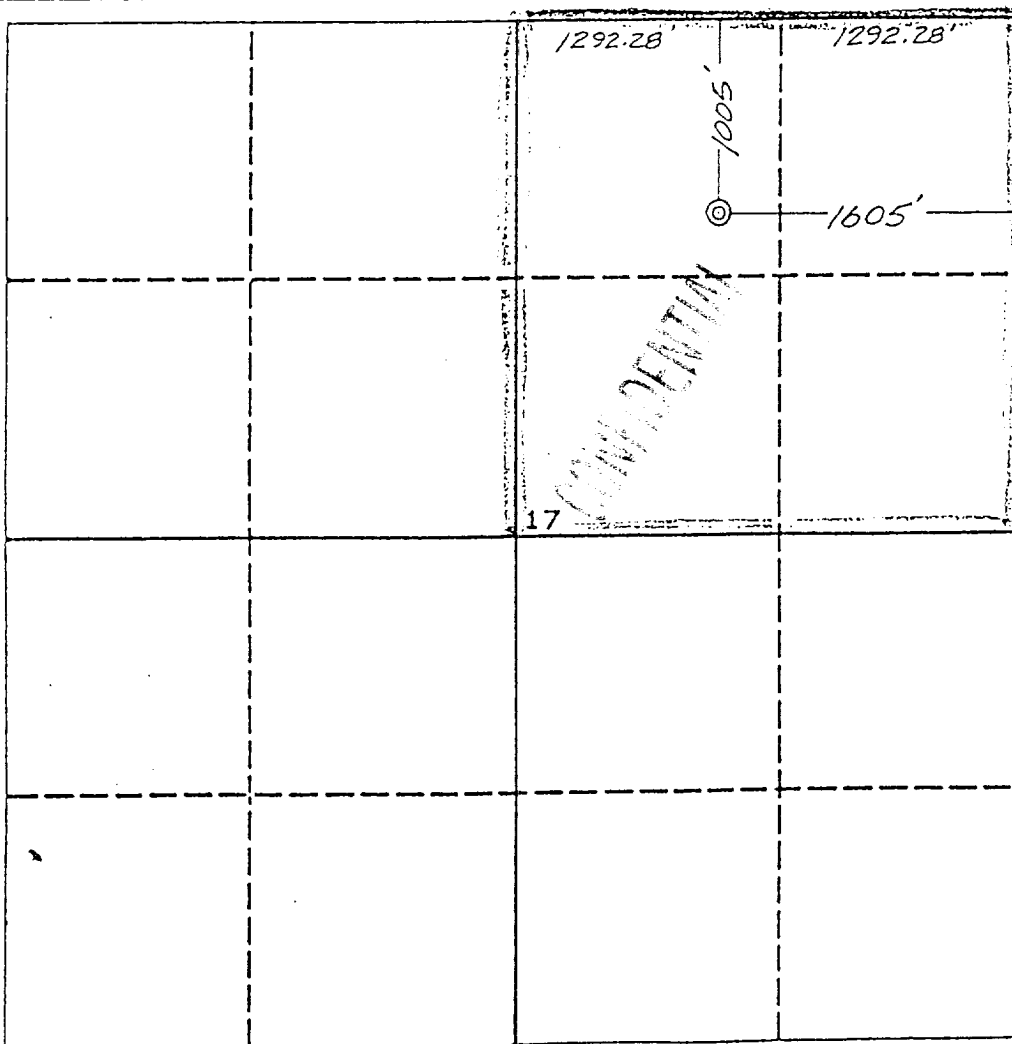

OPERATOR CERTIFICATION

I hereby certify that the information contained herein is true and complete to the best of my knowledge and belief.

Lori Arnold

Signature
Lori Arnold

Printed Name
Business Analyst

Position
Amoco Production Co.

Company
5/17/93

Date

SURVEYOR CERTIFICATION

I hereby certify that the well location shown on this plat was plotted from field notes of actual surveys made by me or under my supervision, and that the same is true and correct to the best of my knowledge and belief.

Date Surveyed
April 6, 1993

Signature & Seal of
Professional Surveyor

Gary D. Vann

7016

Certification
7016

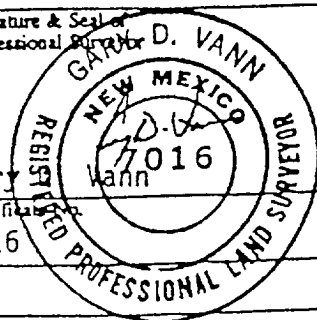

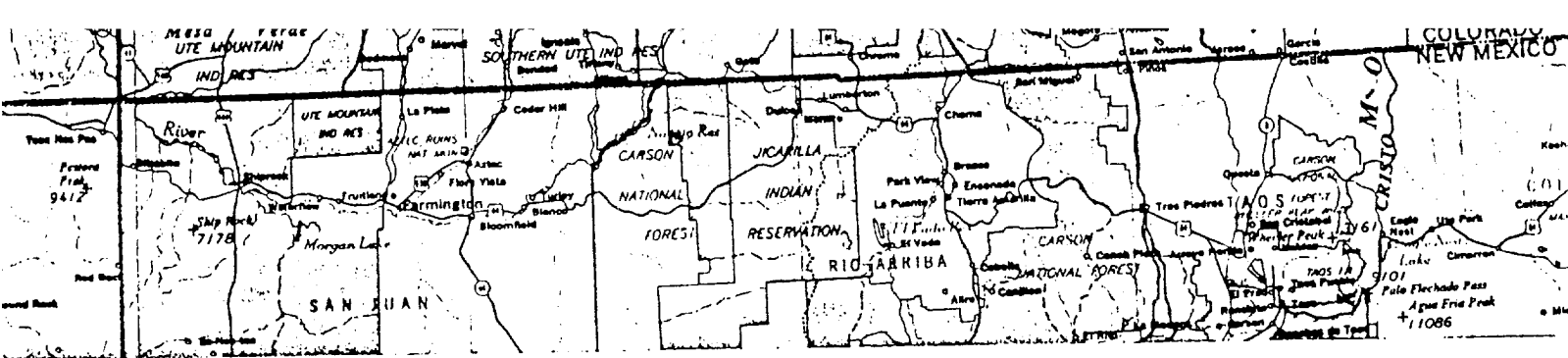

1005' F/NL 1605' F/EL
 SEC. 17, T31N, R9W, NMPM
 SAN JUAN COUNTY, NEW MEXICO
 RAIL POINT: 149.4 miles from Montrose, CO
 MUD POINT: 13.26 miles from Aztec, NM
 CEMENT POINT: 27.26 miles from Farmington, NM

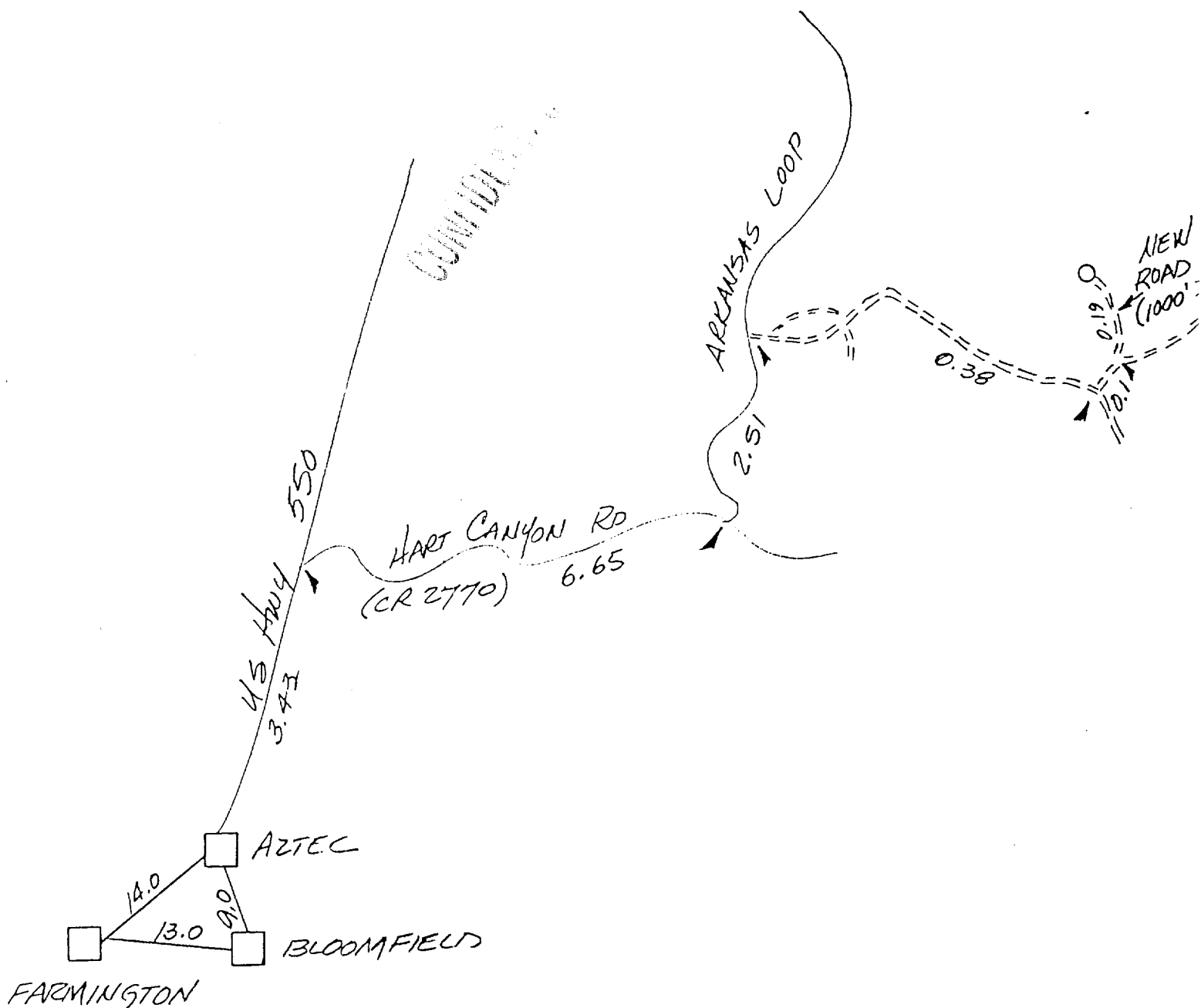



248 R9W 249 250 251 252
 SCALE AMOCO PRODUCTION COMPANY
 1005' F/NL 1605' F/EL
 SEC. 17, T31N, R9W, NMPM
 CAN. JUAN COUNTY, NEW MEXICO
 NEW ROAD
 EXISTING ROAD
 GUARDRANCE LOCATION
 10