

UNITED STATES  
DEPARTMENT OF THE INTERIOR  
BUREAU OF LAND MANAGEMENT

APPLICATION FOR PERMIT TO DRILL, DEEPEN, OR PLUG BACK

1a. Type of Work DRILL	<b>RECEIVED</b> AUG 23 1995 <b>OIL CON. DIV.</b> DIST. 3	5. Lease Number SF-080875 Unit Reporting Number
1b. Type of Well GAS		6. If Indian, All. or Tribe
2. Operator <b>MERIDIAN OIL</b> 4538		7. Unit Agreement Name San Juan 32-9 Unit
3. Address & Phone No. of Operator PO Box 4289, Farmington, NM 87499  (505) 326-9700		8. Farm or Lease Name 7473 San Juan 32-9 Unit 9. Well Number 46A
4. Location of Well 790' FSL, 1830' FEL  Latitude 36° 55' 18", Longitude 107° 46' 58"		10. Field, Pool, Wildcat 72319 Blanco Mesa Verde 11. Sec., Twn, Rge, Mer. (NMPM) 0 Sec 4, T-31-N, R-9-W API # 30-045-29277
14. Distance in Miles from Nearest Town 4 miles to Cedar Hill NM	12. County San Juan	13. State NM
15. Distance from Proposed Location to Nearest Property or Lease Line 790'		
16. Acres in Lease	17. Acres Assigned to Well 310.30 E/2 311.27	
18. Distance from Proposed Location to Nearest Well, Drig, Compl, or Applied for on this Lease 1600'		
19. Proposed Depth 6160'	20. Rotary or Cable Tools Rotary	
21. Elevations (DF, FT, GR, Etc.) 6578' GR	22. Approx. Date Work will Start 3rd quarter 1995	
23. Proposed Casing and Cementing Program See Operations Plan attached	DRILLING OPERATIONS AND RECORDS ARE SUBJECT TO OPERATIONS PLAN ATTACHED "GENERAL REQUIREMENTS"	
24. Authorized by:  Regional Drilling Engineer	Date: 7/31/95	

PERMIT NO. \_\_\_\_\_ APPROVAL DATE \_\_\_\_\_  
APPROVED BY \_\_\_\_\_ TITLE \_\_\_\_\_ DATE \_\_\_\_\_

Archaeological Report to be submitted by Arboles Contract Archaeology  
Threatened and Endangered Species Report to be submitted  
NOTE: This format is issued in lieu of U.S. BLM Form 3160-3

APPROVED  
AS AMENDED

AUG 21 1995

DISTRICT MANAGER

NMUCD

District I  
PO Box 1980, Hobbs, NM 88241-1980  
District II  
PO Drawer DD, Artesia, NM 88211-0775  
District III  
1000 Rio Brazos Rd., Aztec, NM 87410  
District IV  
PO Box 2088, Santa Fe, NM 87504-2088

**RECEIVED**  
AUG 2 3 1995  
**OIL CON. DIV.**  
**DIST. 3**

State of New Mexico  
Energy, Minerals & Natural Resources Department  
CONSERVATION DIVISION  
PO Box 2088  
Santa Fe, NM 87504-2088

Form C-102  
Revised February 21, 1994  
Instructions on back  
Submit to Appropriate District Office  
State Lease - 4 Copies  
Fee Lease - 3 Copies

☐ AMENDED REPORT

### WELL LOCATION AND ACREAGE DEDICATION PLAT

API Number 30-045-29277		Pool Code 72319	Pool Name Blanco Mesaverde
Property Code 7473	Property Name San Juan 32-9 Unit		Well Number 46A
OGRID No. 14538	Operator Name Meridian Oil Inc.		Elevation 6578'

#### 10 Surface Location

UL or lot no. 0	Section 4	Township 31 N	Range 9 W	Lot Idn	Feet from the 790	North/South line South	Feet from the 1830	East/West line East	County S.J.
--------------------	--------------	------------------	--------------	---------	----------------------	---------------------------	-----------------------	------------------------	----------------

#### 11 Bottom Hole Location If Different From Surface

UL or lot no.	Section	Township	Range	Lot Idn	Feet from the	North/South line	Feet from the	East/West line	County
---------------	---------	----------	-------	---------	---------------	------------------	---------------	----------------	--------

12 Dedicated Acres 311.27 E/311.27-30	13 Joint or Infill	14 Consolidation Code	15 Order No.
---	--------------------	-----------------------	--------------

NO ALLOWABLE WILL BE ASSIGNED TO THIS COMPLETION UNTIL ALL INTERESTS HAVE BEEN CONSOLIDATED  
OR A NON-STANDARD UNIT HAS BEEN APPROVED BY THE DIVISION

16 2623.50'	7	2613.60'	5	17 OPERATOR CERTIFICATION I hereby certify that the information contained herein is true and complete to the best of my knowledge and belief  Signature Peggy Bradfield Printed Name Regulatory Affairs Title 7-10-95 Date
8	9	10	11	
15	14	13	12	
16	17	18		
5250.96'				18 SURVEYOR CERTIFICATION I hereby certify that the well location shown on this plat was plotted from field notes of actual surveys made by me or under my supervision, and that the same is true and correct to the best of my belief.  5-31-95 Date of Survey Signature and Seal of Professional Surveyor NEAR C. EDWARDS 6857 6852 Certificate Number

**OPERATIONS PLAN**

**Well Name:** San Juan 32-9 Unit #46A  
**Location:** 790' FSL, 1830' FEL Section 4, T-31-N, R-9-W  
 San Juan County, New Mexico  
 Latitude 36° 55' 18", Longitude 107° 46' 58"  
**Formation:** Blanco Mesa Verde  
**Elevation:** 6578' GL

<b><u>Formation Tops:</u></b>	<b><u>Top</u></b>	<b><u>Bottom</u></b>	<b><u>Contents</u></b>
Surface	San Jose	1877'	
Ojo Alamo	1877'	1954'	aquifer
Kirtland	1954'	2886'	
Fruitland	2886'	3473'	gas
Pictured Cliffs	3473'	3586'	gas
Lewis	3586'	4162'	
<b>Intermediate TD</b>	<b>3790'</b>		
Huerfanito Bentonite	4162'	4211'	
Chacra	4211'	5347'	
Massive Cliff House	5347'	5396'	gas
Menefee	5396'	5713'	gas
Massive Point Lookout	5713'	5793'	gas
Lower Point Lookout	5793'		
<b>Total Depth</b>	<b>6160'</b>		

**Logging Program:**

Openhole Wireline Logging -  
 Surface to Intermediate TD : DIL/LDT/CNL/NGT/ML/FMS  
 Intermediate TD to Total Depth : DIL/LDT/CNL/Temp  
 Mud Logs/Coring/DST -  
 Mud logs - 1850' to Total Depth  
 Cores - none  
 DST - none

**Mud Program:**

<u>Interval</u>	<u>Type</u>	<u>Weight</u>	<u>Vis.</u>	<u>Fluid Loss</u>
0- 200'	Spud	8.4-8.9	40-50	no control
200-3790'	Weighted	8.4-9.1	30-60	no control
3790-6160'	Gas/Mist	n/a	n/a	n/a

Pit levels will be visually monitored to detect gain or loss of fluid control.

**Casing Program:**

<u>Hole Size</u>	<u>Depth Interval</u>	<u>Csg. Size</u>	<u>Wt.</u>	<u>Grade</u>
12 1/4"	0' - 200'	9 5/8"	32.3#	H-40
8 3/4"	0' - 3790'	7"	20.0#	K-55
	7" stage tool @ 2836'			
6 1/4"	3640' - 6160'	4 1/2"	10.5#	K-55

**Tubing Program:**

0' - 6160' 2 3/8" 4.7# J-55

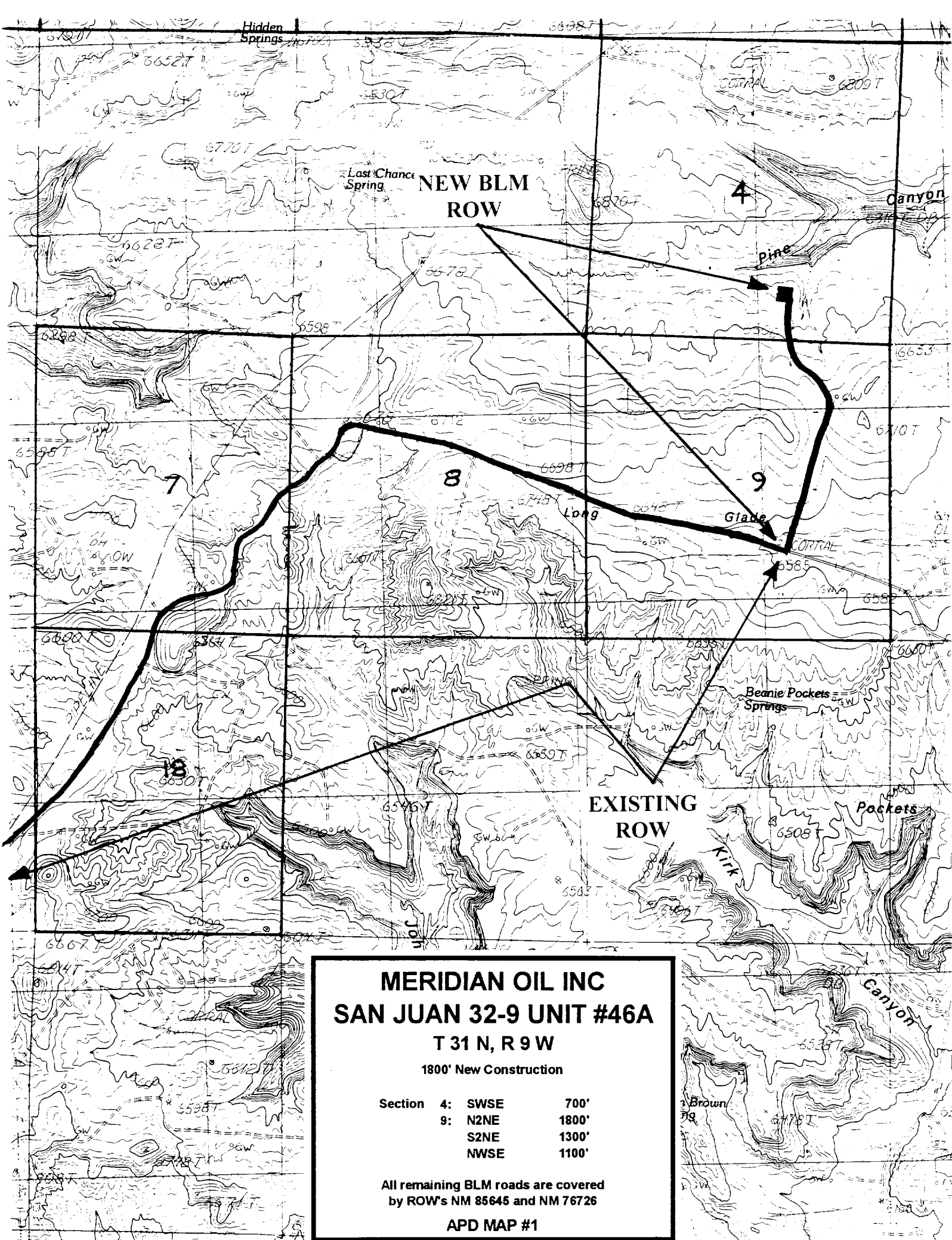

**MERIDIAN OIL INC**  
**SAN JUAN 32-9 UNIT #46A**

**T 31 N, R 9 W**

**1800' New Construction**

Section	4:	SWSE	700'
	9:	N2NE	1800'
		S2NE	1300'
		NWSE	1100'

All remaining BLM roads are covered  
by ROW's NM 85645 and NM 76726

**APD MAP #1**