

UNITED STATES
DEPARTMENT OF THE INTERIOR
BUREAU OF LAND MANAGEMENT

APPLICATION FOR PERMIT TO DRILL, DEEPEN, OR PLUG BACK

1a. Type of Work
DRILL
070 FARMINGTON, NM

5. Lease Number
SF-080751A
Unit Reporting Number

1b. Type of Well
GAS

6. If Indian, All. or Tribe

2. Operator
MERIDIAN OIL
14538

7. Unit Agreement Name
OIL CON. DIV.
DIST. 3

3. Address & Phone No. of Operator
PO Box 4289, Farmington, NM 87499
(505) 326-9700

8. Farm or Lease Name
7568 Sunray F

9. Well Number
7

4. Location of Well
1710' FNL, 1480' FEL
Latitude 36° 47.2, Longitude 107° 51.0

10. Field, Pool, Wildcat
71599 Basin Dakota

11. Sec., Twn, Rge, Mer. (NMPM)
G Sec 26, T-30-N, R-10-W
API # 30-045-24323

14. Distance in Miles from Nearest Town
6 miles from Aztec

12. County
San Juan

13. State
NM

15. Distance from Proposed Location to Nearest Property or Lease Line
1480'

16. Acres in Lease

17. Acres Assigned to Well
317.22 E/2

18. Distance from Proposed Location to Nearest Well, Drig, Compl, or Applied for on this Lease
150'

19. Proposed Depth
7550'

This action is subject to technical and procedural review pursuant to 43 CFR 3165.3 and appeal pursuant to 43 CFR 3165.4.

20. Rotary or Cable Tools
Rotary

21. Elevations (DF, FT, GR, Etc.)
6217

22. Approx. Date Work will Start
1st quarter 1996

23. Proposed Casing and Cementing Program
See Operations Plan attached

24. Authorized by: 
Regional Drilling Engineer

DRILLING OPERATIONS AUTHORIZED ARE SUBJECT TO COMPLIANCE WITH ATTACHED "GENERAL REQUIREMENTS".
12/1/95
Date

PERMIT NO. _____ APPROVAL DATE _____

APPROVED BY _____ TITLE _____ DATE _____

Archaeological Report to be submitted
Threatened and Endangered Species Report to be submitted
NOTE: This format is issued in lieu of U.S. BLM Form 3160-3

APPROVED
AS AMENDED

DEC 06 1995

DISTRICT MANAGER

NMOCD

District I
PO Box 1988, Hobbs, NM 88241-1988
District II
PO Drawer DD, Artesia, NM 88211-0719
District III
1008 Rio Brans Rd., Aztec, NM 87410
District IV
PO Box 2088, Santa Fe, NM 87504-2088

State of New Mexico
Energy, Minerals & Natural Resources Department

Form C-102
Revised February 21, 1994
Instructions on back
Submit to Appropriate District Office
State Lease - 4 Copies
Fee Lease - 3 Copies

OIL CONSERVATION DIVISION

PO Box 2088
Santa Fe, NM 87504-2088

55 DEC -5 AM 8:13

☐ AMENDED REPORT

WELL LOCATION AND ACREAGE DEDICATION PLAT

1 APT Number 30-045-29323		1 Pool Code 71599		1 Pool Name Basin Dakota	
1 Property Code 7568		1 Property Name Sunray F			1 Well Number 7
1 OGRID No. 14538		1 Operator Name MERIDIAN OIL INC.			1 Elevation 6217'

10 Surface Location

UL or lot no.	Section	Township	Range	Lot Idn	Feet from the	North/South line	Feet from the	East/West line	County
G	26	30 N	10 W	X	1710	North	1480	East	S.J.

11 Bottom Hole Location If Different From Surface

UL or lot no.	Section	Township	Range	Lot Idn	Feet from the	North/South line	Feet from the	East/West line	County

12 Dedicated Acres E/317.22	13 Joint or Infill	14 Consolidation Code	15 Order No.
--------------------------------	--------------------	-----------------------	--------------

NO ALLOWABLE WILL BE ASSIGNED TO THIS COMPLETION UNTIL ALL INTERESTS HAVE BEEN CONSOLIDATED
OR A NON-STANDARD UNIT HAS BEEN APPROVED BY THE DIVISION

16 <p>RECEIVED DEC 11 1995 OIL CON. DIV. DIST. 3</p>				17 OPERATOR CERTIFICATION I hereby certify that the information contained herein is true and complete to the best of my knowledge and belief Signature Peggy Bradfield Printed Name Regulatory Administrator Title 11-1-95 Date			
18 SURVEYOR CERTIFICATION I hereby certify that the well location shown on this plat was plotted from field notes of actual surveys made by me or under my supervision, and that the same is true and correct to the best of my belief. 10-9-95 Date of Survey Signature and Seal of Professional Surveyor Nels C. Edwards 6857 Certificate Number							

OPERATIONS PLAN

Well Name: Sunray F #7
Location: 1710' FNL, 1480' FEL Section 26, T-30-N, R-10-W
 San Juan County, NM
 Latitude 36° 47.2, Longitude 107° 51.0
Formation: Basin Dakota
Elevation: 6217' GL

<u>Formation Tops:</u>	<u>Top</u>	<u>Bottom</u>	<u>Contents</u>
Surface	San Jose	1510'	
Ojo Alamo	1510'	1655'	aquifer
Kirtland	1655'	2260'	
Fruitland	2260'	2805'	gas
Pictured Cliffs	2805'	2970'	gas
Lewis	2970'	3545'	
Intermediate TD	3170'		
Huerfanito Bentonite	3545'	3580'	gas
Navajo City	3580'	3793'	gas
Otero	3793'	4410'	gas
Massive Cliff House	4410'	4570'	gas
Menefee	4570'	5060'	gas
Point Lookout	5060'	5450'	gas & hydrocarbons
Mancos	5450'	6320'	gas
Intermediate TD	5650'		
Gallup	6320'	7055'	gas
Greenhorn	7055'	7105'	
Graneros	7105'	7250'	
Dakota	7250'	7430'	gas
Morrison	7430'		hydrocarbons
Total Depth	7550'		

Logging Program:

Openhole Wireline Logging -
 DIL/LDT/CNL/Temp/NGT/GR/CAL/FMS
 Mud logs from 3170' to TD

Mud Program:

<u>Interval</u>	<u>Type</u>	<u>Weight</u>	<u>Vis.</u>	<u>Fluid Loss</u>
0- 200'	Spud	8.4-8.9	40-50	no control
200-3170'	LSND	8.4-9.1	30-60	no control
3170-5650'	Gas	n/a	n/a	n/a
5650-7550'	LSND	8.7-9.0	40-50	10-15 cc/30 min

Pit levels will be visually monitored to detect gain or loss of fluid control.

Casing Program:

<u>Hole Size</u>	<u>Depth Interval</u>	<u>Csg. Size</u>	<u>Wt.</u>	<u>Grade</u>
17 1/2"	0' - 200'	13 3/8"	48.0#	H-40
12 1/4"	200' - 3170'	9 5/8"	36.0#	K-55
8 3/4"	3020' - 5650'	7"	23.0#	K-55
6 1/4"	5500' - 7550'	4 1/2"	11.6#	N-80

Tubing Program:

0' - 7550' 2 3/8" tubing

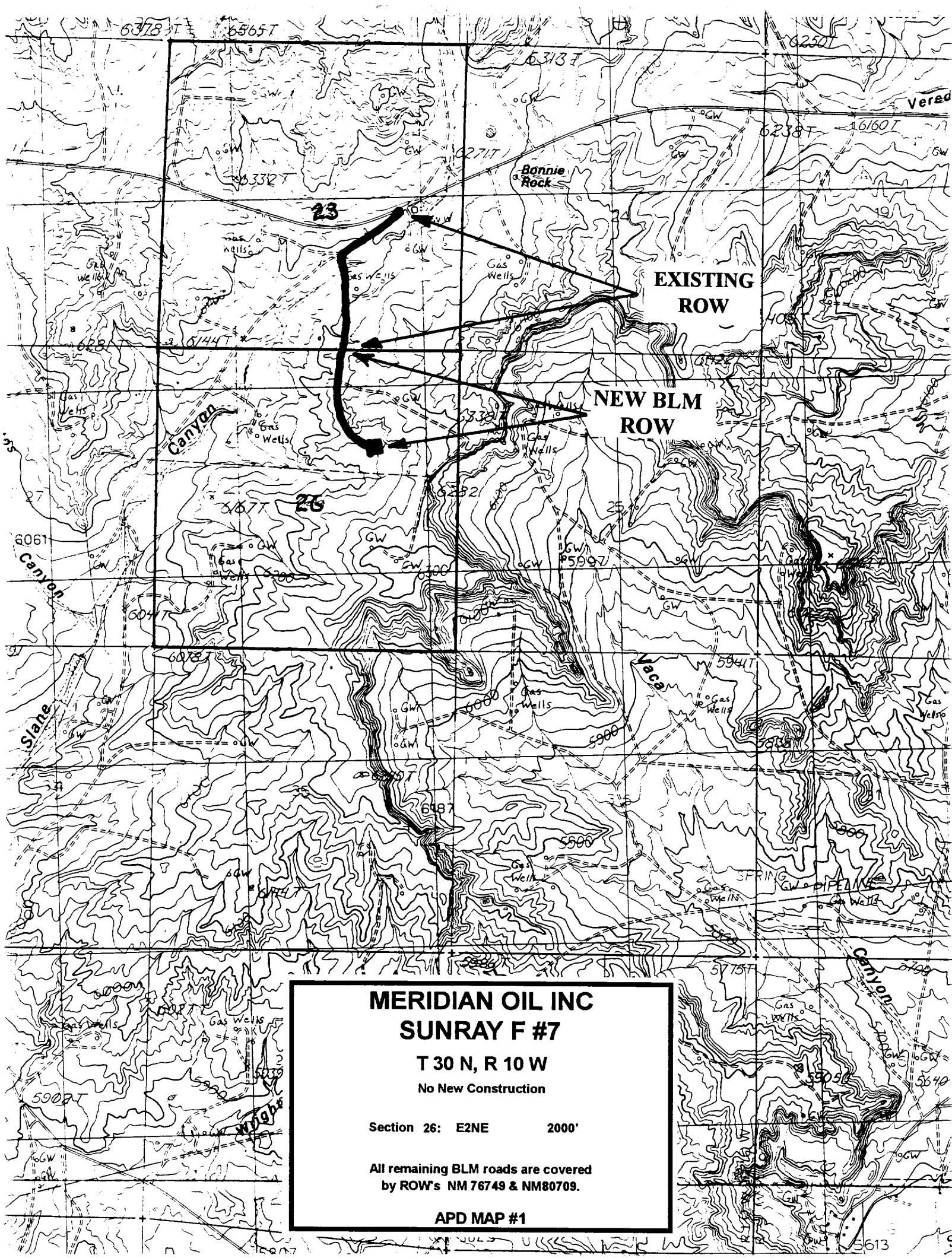

**MERIDIAN OIL INC
SUNRAY F #7**

T 30 N, R 10 W

No New Construction

Section 26: E2NE

2000'

**All remaining BLM roads are covered
by ROW's NM 76749 & NM80709.**

APD MAP #1