

UNITED STATES
DEPARTMENT OF THE INTERIOR
BUREAU OF LAND MANAGEMENT

APPLICATION FOR PERMIT TO DRILL OR DEEPEN

1a. TYPE OF WORK

DRILL ☒DEEPEN ☐

070 Farmington, NM

b. TYPE OF WELL

OIL
WELL ☐GAS
WELL ☒

OTHER

SINGLE
ZONE ☒MULTIPLE
ZONE ☐

2. NAME OF OPERATOR

Robert L. Bayless 19418

3. ADDRESS AND TELEPHONE NO.

P.O. Box 168 Farmington, NM (505) 326-2659

4. LOCATION OF WELL (Report location clearly and in accordance with any State requirements.)*

At surface 1325 FSL & 1635 FEL

At proposed prod. zone

Same

14. DISTANCE IN MILES AND DIRECTION FROM NEAREST TOWN OR POST OFFICE*

10. DISTANCE FROM PROPOSED*
LOCATION TO NEAREST
PROPERTY OR LEASE LINE, FT.
(Also to nearest drig. unit line, if any)

1325

18. DISTANCE FROM PROPOSED LOCATION*
TO NEAREST WELL, DRILLING, COMPLETED,
OR APPLIED FOR, ON THIS LEASE, FT.

100

16. NO. OF ACRES IN LEASE

19. PROPOSED DEPTH

1740

17. NO. OF ACRES ASSIGNED
TO THIS WELL

160

20. ROTARY OR CABLE TOOLS

Rotary

21. ELEVATIONS (Show whether DF, RT, GR, etc.)

5580KB

22. APPROX. DATE WORK WILL START*

ASAP

23.

PROPOSED CASING AND CEMENTING PROGRAM

SIZE OF HOLE	GRADE, SIZE OF CASING	WEIGHT PER FOOT	SETTING DEPTH	QUANTITY OF CEMENT
8 3/4"	7" J-55	23.0 #/ft	120	30sx (35 ft ³)
6 1/4"	4 1/2" J-55	10.5 #/ft	1740	160sx (244 ft ³)

This action is subject to technical and
procedural review pursuant to 43 CFR 3165.3
and appeal pursuant to 43 CFR 3165.4.

DRILLING OPERATIONS AUTHORIZED ARE
SUBJECT TO COMPLIANCE WITH ATTACHED
"GENERAL REQUIREMENTS"

Will Drill 8 3/4" hole to 120 ft and set 120 ft 7" 23.0#/ft J55 new casing. Will cement w/ 30sx (35 ft³) class B cement, circulated to surface will drill 6 1/4" hole to 1740 ft and set 1740 ft 4 1/2" 10.5#/ft J55 new casing. Will cement with 160sx(244 ft³) cement circulated to surface. Circulating medium will be clean water, natural mud and water loss control additives. No abnormal temperatures on pressures are anticipated. Induction and density logs will be run. The gas from this well is not dedicated.

Estimated Tops

Ojo Alamo	Surface
Kirtland	150 ft
Fruitland	1260 ft
Pictured Cliffs	1560 ft

RECEIVED
OCT 14 1997

OIL CON. DIV.

IN ABOVE SPACE DESCRIBE PROPOSED PROGRAM: If proposal is to deepen, give data on present productive zone and proposed new productive zone. If proposal is to drill or deepen directionally, give pertinent data on subsurface locations and measured and true vertical depths. Give blowout preventer program, if any.

24.

SIGNED

TITLE Engineer

DATE 6/30/97

(This space for Federal or State office use)

PERMIT NO.

APPROVAL DATE

Application approval does not warrant or certify that the applicant holds legal or equitable title to those rights in the subject lease which would entitle the applicant to conduct operations thereon.
CONDITIONS OF APPROVAL, IF ANY:

APPROVED BY

TITLE

DATE

*See Instructions On Reverse Side

NMOCD

Use this space to any department or agency of the

OIL CONSERVATION DIVISION

PO Box 2088
Santa Fe, NM 87504-2088

88 JUL 24 PM 2:12

☐ AMENDED REPORT

070 FARMINGTON, NM

WELL LOCATION AND ACREAGE DEDICATION PLAT

1 API Number 30-045-29495		2 Pool Code 77700		3 Pool Name UNDESIGNATED PC FOLCHER KUTZ PC	
4 Property Code 21695		5 Property Name TIGER			6 Well Number 1
7 OGRID No. 19418		8 Operator Name ROBERT L. BAYLESS			9 Elevation 5575

¹⁰ Surface Location

UL or lot no.	Section	Township	Range	Lot Idn	Feet from the	North/South line	Feet from the	East/West line	County
J	35	30 N	13 W		1325	South	1635	East	San Juan

11 Bottom Hole Location If Different From Surface

Ul. or lot no.	Section	Township	Range	Lot 1dn	Feet from the	North/South line	Feet from the	East/West line	County
----------------	---------	----------	-------	---------	---------------	------------------	---------------	----------------	--------

¹² Dedicated Acres 160	¹³ Joint or Infill	¹⁴ Consolidation Code	¹⁵ Order No.
--------------------------------------	-------------------------------	----------------------------------	-------------------------

NO ALLOWABLE WILL BE ASSIGNED TO THIS COMPLETION UNTIL ALL INTERESTS HAVE BEEN CONSOLIDATED
OR A NON-STANDARD UNIT HAS BEEN APPROVED BY THE DIVISION

16	<div style="border: 1px solid black; padding: 10px; margin: 0 auto; width: 80%;"> <p style="font-size: 2em; margin: 0;">RECEIVED</p> <p style="margin: 0;">OCT 14 1997</p> <p style="font-size: 1.5em; margin: 10px 0;">OIL CON. DIV.</p> <p style="margin: 0;">BUREAU</p> </div>	<p>17 OPERATOR CERTIFICATION</p> <p><i>I hereby certify that the information contained herein is true and complete to the best of my knowledge and belief</i></p> <div style="border-bottom: 1px solid black; height: 40px; margin-bottom: 5px;"></div> <p>Signature <u>Price M. Bayless</u></p> <p>Printed Name <u>Price M. Bayless</u></p> <p>Title <u>Engineer</u></p> <p>Date <u>6/30/97</u></p>
<p>Ed. Rdc</p> <p>Ed. Bc</p>	<div style="border: 1px solid black; padding: 10px; margin: 0 auto; width: 80%;"> <p style="font-size: 2em; margin: 0;">RECEIVED</p> <p style="margin: 0;">OCT 14 1997</p> <p style="font-size: 1.5em; margin: 10px 0;">OIL CON. DIV.</p> <p style="margin: 0;">BUREAU</p> </div>	<p>18 SURVEYOR CERTIFICATION</p> <p><i>I hereby certify that the well location shown on this plat was plotted from field notes of actual surveys made by me or under my supervision, and that the same is true and correct to the best of my belief.</i></p> <div style="border-bottom: 1px solid black; height: 40px; margin-bottom: 5px;"></div> <p>Date of Survey <u>1 May 1997</u></p> <p>Signature and Seal of Professional Surveyor:</p> <div style="text-align: center; margin: 10px 0;">  </div> <p><u>William G. Hahnke II</u></p> <p>Certificate Number <u>8466</u></p>

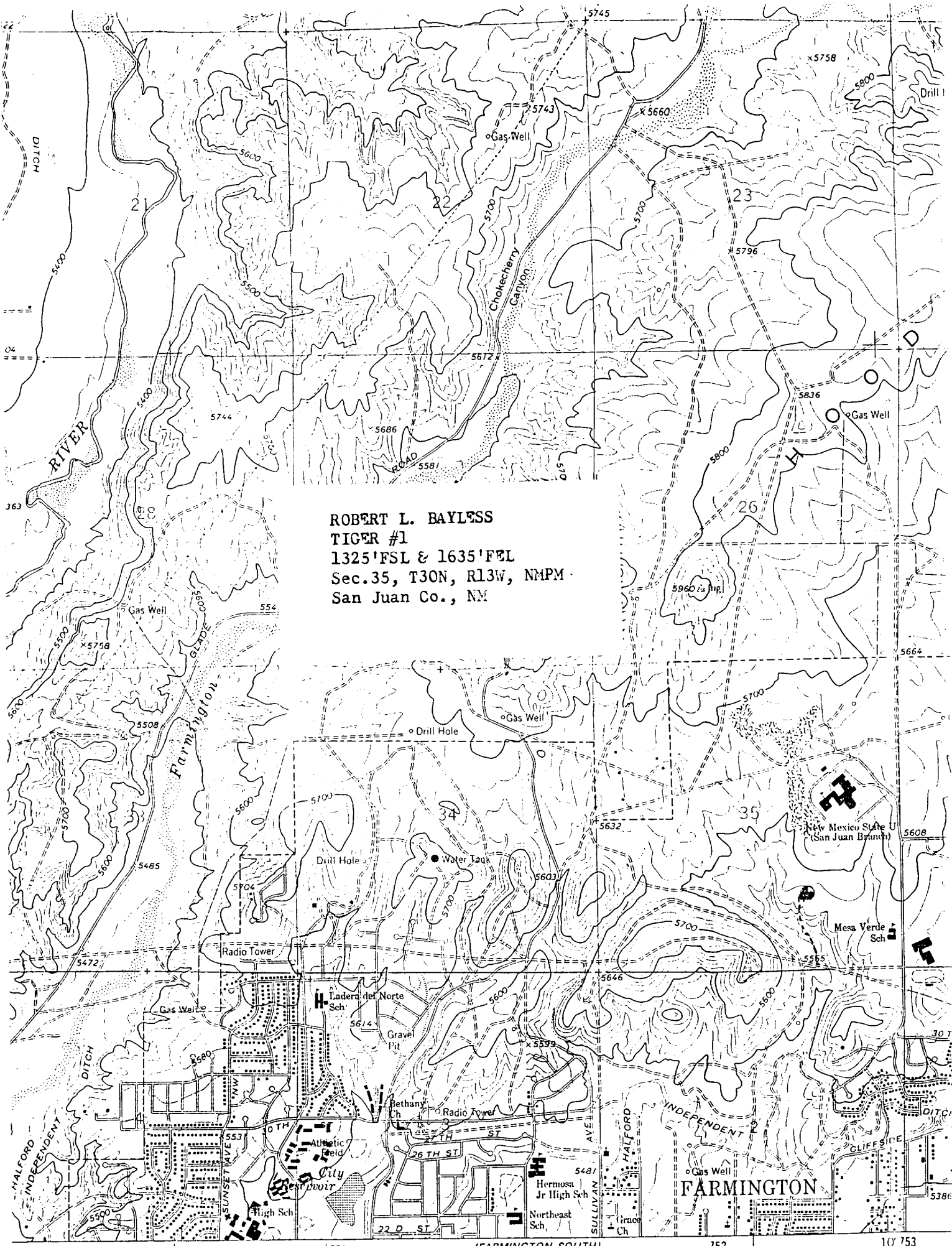

ROBERT L. BAYLESS
TIGER #1
1325'FSL & 1635'FEL
Sec.35, T30N, R13W, NMPM
San Juan Co., NM

749 12°30'

750

(FARMINGTON SOUTH)
4357 11 NW

752

10° 753

DIRG BWH 1973

29 MON 29

27 MON 27

MON 41

MON 42

ROBERT L. BAYLESS
TIGER #1
1325'FSL & 1635'FEL
Sec.35, T30N, R13W, NMPM
San Juan Co., NM