

UNITED STATES
DEPARTMENT OF THE INTERIOR
BUREAU OF LAND MANAGEMENT

APPLICATION FOR PERMIT TO DRILL OR DEEPEN

1A. TYPE OF WORK

DRILL ☒DEEPEN ☐

070 FARMINGTON, NM

B. TYPE OF WELL

OIL
WELL ☐GAS
WELL ☒

OTHER

SINGLE
ZONE ☒MULTIPLE
ZONE ☐

2. NAME OF OPERATOR

ROBERT L. BAYLESS, PRODUCER LLC 150182

3. ADDRESS AND TELEPHONE NO.

PO BOX 168 FARMINGTON, NM 87499 (505)326-2659

4. LOCATION OF WELL (Report location clearly and in accordance with any State requirements.)*

At surface

798 FNL & 860 FWL

At proposed prod. zone
same 753

14. DISTANCE IN MILES AND DIRECTION FROM NEAREST TOWN OR POST OFFICE*

15. DISTANCE FROM PROPOSED*

LOCATION TO NEAREST
PROPERTY OR LEASE LINE, FT.
(Also to nearest drig. unit line, if any)

16. NO. OF ACRES IN LEASE

17. NO. OF ACRES ASSIGNED
TO THIS WELL

160

18. DISTANCE FROM PROPOSED LOCATION*
TO NEAREST WELL, DRILLING, COMPLETED,
OR APPLIED FOR, ON THIS LEASE, FT.

19. PROPOSED DEPTH

20. ROTARY OR CABLE TOOLS

ROTARY

21. ELEVATIONS (Show whether DF, RT, GR, etc.)

5706 RT 57026L

This action is subject to technical and
procedural review pursuant to 43 CFR 3165.3
and appeal pursuant to 43 CFR 3165.4.

22. APPROX. DATE WORK WILL START*

ASAP

23.

PROPOSED CASING AND CEMENTING PROGRAM

SIZE OF HOLE	GRADE, SIZE OF CASING	WEIGHT PER FOOT	SETTING DEPTH	QUANTITY OF CEMENT
8 3/4"	7" J-55	23.0#/ft	310	60sx (71cf)
6 1/4"	4 1/2" J-55	10.5#/ft	1825	160sx (238cf)

Will drill 8 3/4" hole to 310 feet and set 310 feet of 7" 23.0#/ft J-55 new casing. Will cement with 60sx (71cf) of Class B cement, circulated to surface. Will drill 6 1/4" hole to 1825 feet. Circulating medium will be clear water, natural mud, and water loss additives. No abnormal temperatures or pressures are anticipated. Induction and density logs will be run. Will set 1825 feet of new 4 1/2" 10.5#/ft J-55 ST&C casing. Will cement with 160sx (238cf) of Class B cement, circulated to surface. We also request a variance on the use of an upper kelly cock as the rig utilized has a double drum that uses a track to retract the kelly, and the kelly cock lengthens the kelly such that connections cannot be made safely.

ESTIMATED FORMATION TOPS:

Ojo Alamo surface
Kirtland 310 feet
Fruitland 1320 feet
Pictured Cliffs 1640 feet

RECEIVED
APR 20 1998
OIL CON. DIV.DRILLING OPERATIONS AUTHORIZED ARE
SUBJECT TO COMPLIANCE WITH ATTACHED
"GENERAL REQUIREMENTS"

IN ABOVE SPACE DESCRIBE PROPOSED PROGRAM: If proposal is to deepen, give data on present productive zone and proposed new productive zone. If proposal is to drill or deepen directionally, give pertinent data on subsurface locations and measured and true vertical depths. Give blowout preventer program, if any.

24.

SIGNED

TITLE

ENGINEER

DATE

2/4/98

(This space for Federal or State office use)

PERMIT NO.

APPROVAL DATE

Application approval does not warrant or certify that the applicant holds legal or equitable title to those rights in the subject lease which would entitle the applicant to conduct operations thereon.

CONDITIONS OF APPROVAL, IF ANY:

APPROVED BY

/s/ Duane W. Spencer

TITLE

DATE

APR 17 1998

*See Instructions On Reverse Side

DATA FILE OF THE MINISTRY OF
DATA FILE OF THE MINISTRY OF
DATA FILE OF THE MINISTRY OF

DATA FILE OF THE MINISTRY OF
DATA FILE OF THE MINISTRY OF
DATA FILE OF THE MINISTRY OF
DATA FILE OF THE MINISTRY OF

District I
PO Box 1980, Hobbs, NM 88241-1980
District II
PO Drawer DD, Artesia, NM 88211-0719
District III
1000 Rio Brazos Rd., Aztec, NM 87410
District IV
PO Box 2088, Santa Fe, NM 87504-2088

State of New Mexico
Energy, Minerals & Natural Resources Department

OIL CONSERVATION DIVISION
PO Box 2088
Santa Fe, NM 87504-2088

Form C-102
Revised February 21, 1994
Instructions on back
Submit to Appropriate District Office
State Lease - 4 Copies
Fee Lease - 3 Copies

☐ AMENDED REPORT

WELL LOCATION AND ACREAGE DEDICATION PLAT

1 API Number <u>30-045-29581</u>		2 Pool Code <u>77200</u>		3 Pool Name <u>FULCHER KUTZ PICTURED CLIFFS EXT</u>	
4 Property Code <u>22189</u>		5 Property Name <u>TIGER</u>			6 Well Number <u>6</u>
7 OGRID No. <u>150182</u>		8 Operator Name <u>ROBERT L. BAYLESS, PRODUCER LLC</u>			9 Elevation <u>5702</u>

10 Surface Location

UL or lot no.	Section	Township	Range	Lot Idn	Feet from the	North/South line	Feet from the	East/West line	County
<u>D</u>	<u>35</u>	<u>30 N</u>	<u>13 W</u>		<u>910</u>	<u>North</u>	<u>753</u>	<u>West</u>	<u>San Juan</u>

11 Bottom Hole Location If Different From Surface

UL or lot no.	Section	Township	Range	Lot Idn	Feet from the	North/South line	Feet from the	East/West line	County

12 Dedicated Acres <u>160</u>	13 Joint or Infill	14 Consolidation Code	15 Order No.
----------------------------------	--------------------	-----------------------	--------------

NO ALLOWABLE WILL BE ASSIGNED TO THIS COMPLETION UNTIL ALL INTERESTS HAVE BEEN CONSOLIDATED
OR A NON-STANDARD UNIT HAS BEEN APPROVED BY THE DIVISION

		<p>17 OPERATOR CERTIFICATION</p> <p>I hereby certify that the information contained herein is true and complete to the best of my knowledge and belief</p> <p><u>Price M Bayless</u> Signature PRICE M BAYLESS Printed Name ENGINEER Title 4-14-98 Date</p>	
<p>RECEIVED APR 22 1998 OIL CON. DIV. DIST. 3</p>		<p>18 SURVEYOR CERTIFICATION</p> <p>I hereby certify that the well location shown on this plat was plotted from field notes of actual surveys made by me or under my supervision, and that the same is true and correct to the best of my belief.</p> <p><u>APR 21 1998</u> Date of Survey <u>William E. Mahnke II</u> Signature and Seal of Professional Surveyer #8466 William E. Mahnke II Certificate Number 8466</p>	

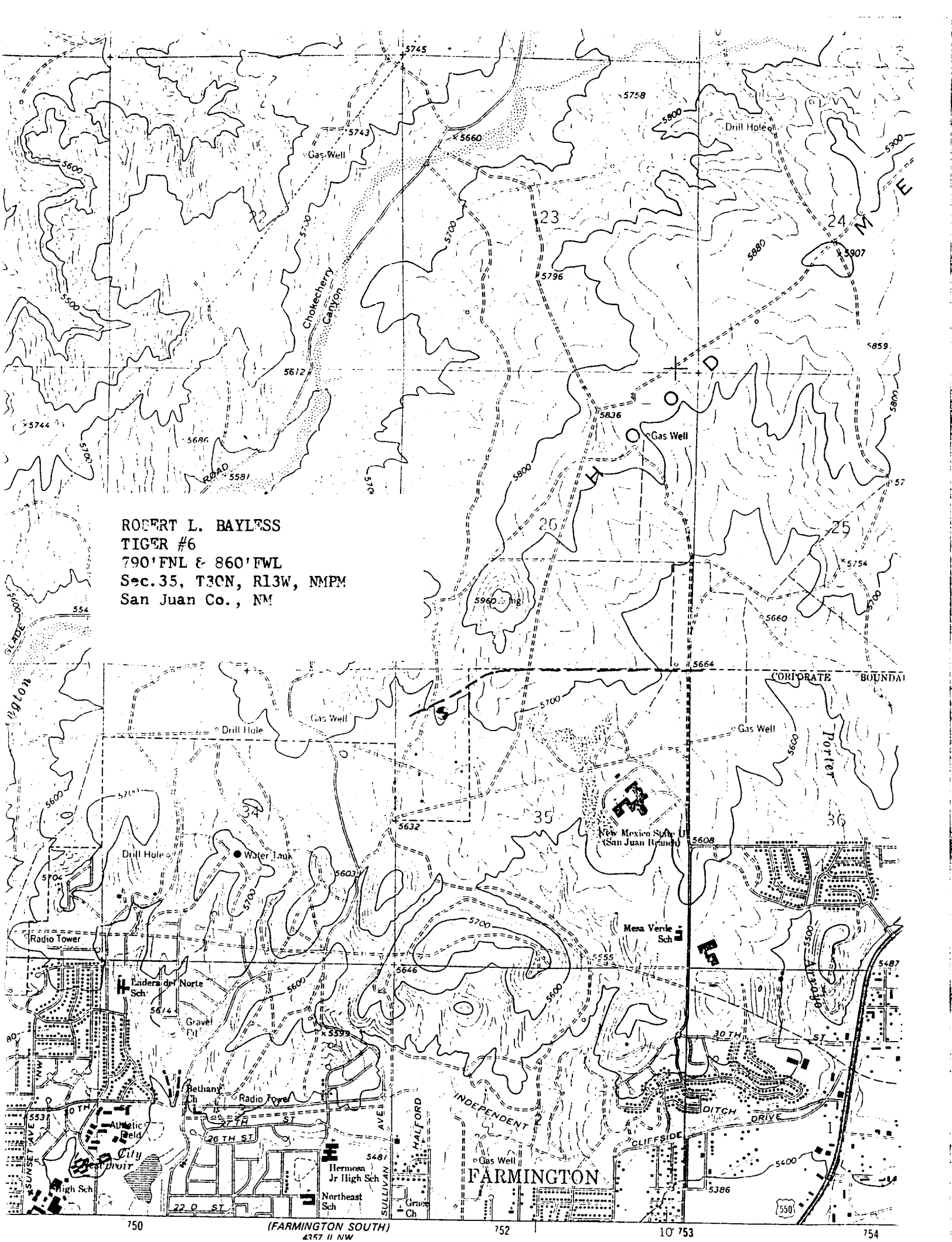

ROBERT L. BAYLESS
TIGER #6
790' FNL & 860' FWL
Sec. 35, T30N, R13W, NMPM
San Juan Co., NM