

# BURLINGTON RESOURCES

SANTA FE, NEW MEXICO

RECEIVED  
FEB 22 1994  
NEW MEXICO  
SANTA FE

Sent Federal Express

Mr. Michael Stogner  
New Mexico Oil Conservation Division  
2040 South Pacheco  
Santa Fe, New Mexico 87505

Re: Davis A Federal #1M  
1885'FSL, 1745'FWL Section 25, T-30-N, R-11-W, San Juan County;  
30-045-not assigned

Dear Mr. Stogner:

Burlington Resources is applying for administrative approval of an unorthodox gas well location for the Basin Dakota pool. This application for the referenced location is at the request of the Bureau of Land Management due to terrain, to utilize an existing access road and not create unnecessary surface disturbance, and because of the presence of archaeology. The Mesa Verde is covered under R-10987A.

This well was originally intended as a single Mesa Verde well and an Application for Permit to Drill was submitted as the Payne #8A. It has since been determined to utilize the same wellbore for a Dakota completion also, which caused a name change to the Davis A Federal #1M with Conoco operating the Dakota and Burlington Resources operating the Mesa Verde. Burlington will drill this well.

Production from the Dakota pool is to be included in a 314.89 acre gas spacing and proration unit for the west half (W/2) in Section 25 and is to be dedicated to the Davis A Federal #1 (30-045-09210) located at 1190'FNL, 990'FWL in Section 25 operated by Conoco. Production from the Mesa Verde is to be included in a 314.89 acre gas spacing and proration unit for the west half (W/2) in Section 25 and is to be dedicated to the Payne #8 (30-045-26643) located at 1120'FNL, 1550'FWL in Section 25 operated by Burlington Resources. Communitization agreement SW-174 is for the Dakota; communitization agreement NM-015P35-87C339 is for the Mesa Verde.

The following attachments are for your review:

- Application for Permit to Drill as Payne #8A
- Sundry notice to add Dakota and change name to David A Federal #1M
- Completed C-102 at referenced location.
- Offset operators/owners plat
- 7.5 minute topographic map

Davis A Federal #1M  
Page Two

Three copies of this application are being submitted to offset operators by certified mail with a request that they furnish you with a Waiver of Objection, keep one copy for their files and return one copy to this office. We appreciate your earliest consideration of this application.

We appreciate your earliest consideration of this application.

Sincerely,

BURLINGTON RESOURCES

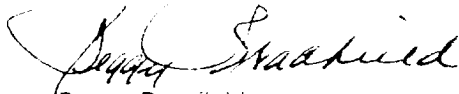

Peggy Bradfield  
Regulatory Compliance Administrator

xc: NMDCD - Aztec District Office  
Bureau of Land Management

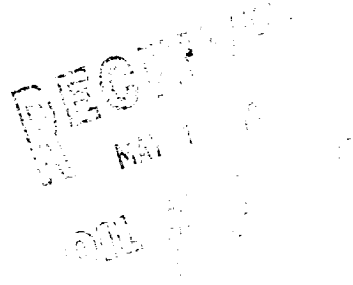

**WAIVER**

\_\_\_\_\_ hereby waives objection to Burlington Resources' application for a non-standard location for the Davis A Federal #1M as proposed above.

By: \_\_\_\_\_ Date: \_\_\_\_\_

UNITED STATES  
DEPARTMENT OF THE INTERIOR  
BUREAU OF LAND MANAGEMENT

APPLICATION FOR PERMIT TO DRILL, DEEPEN, OR PLUG BACK

1a. Type of Work DRILL	5. Lease Number SF-081469 Unit Reporting Number
1b. Type of Well GAS	6. If Indian, All or Tribe
2. Operator <b>BURLINGTON RESOURCES</b> Oil & Gas Company	7. Unit Agreement Name
3. Address & Phone No. of Operator PO Box 4289, Farmington, NM 87499  (505) 326-9700	8. Farm or Lease Name Payne 9. Well Number #8A
4. Location of Well 1885' FSL, 1745' FWL  Latitude 36° 46.9 , Longitude 107° 56.8	10. Field, Pool, Wildcat Blanco Mesaverde 11. Sec., Twp, Rge, Mer. (NMPM) Sec. 13, T-30-N, R-11-W API # 30-045-
14. Distance in Miles from Nearest Town 4 miles to Aztec	12. County San Juan 13. State NM
15. Distance from Proposed Location to Nearest Property or Lease Line 1745'	
16. Acres in Lease	17. Acres Assigned to Well 314.81
18. Distance from Proposed Location to Nearest Well, Drlg, Compl, or Applied for on this Lease 300'	
19. Proposed Depth 5090'	20. Rotary or Cable Tools Rotary
21. Elevations (DF, FT, GR, Etc.) 5980' GR	22. Approx Date Work will Start
23. Proposed Casing and Cementing Program See Operations Plan attached	
24. Authorized by: <u>[Signature]</u> (Regulatory/Compliance Administrator)	<u>11-14-98</u> Date

PERMIT NO. \_\_\_\_\_ APPROVAL DATE \_\_\_\_\_

APPROVED BY \_\_\_\_\_ TITLE \_\_\_\_\_ DATE \_\_\_\_\_

Archaeological Report to be submitted

Threatened and Endangered Species Report to be submitted

NOTE: This form is issued in lieu of U.S. BLM Form 3160-3

Title 18 U.S.C. Section 1001, makes it a crime for any person knowingly and willfully to make to any department or agency of the United States any false, fictitious or fraudulent statements or presentations as to any matter within its jurisdiction.

submitted in lieu of Form 3160-5

UNITED STATES  
DEPARTMENT OF THE INTERIOR  
BUREAU OF LAND MANAGEMENT

Sundry Notices and Reports on Wells

1. Type of Well  
GAS

2. Name of Operator

**BURLINGTON  
RESOURCES**

OIL & GAS COMPANY

3. Address & Phone No. of Operator

PO Box 4289, Farmington, NM 87499 (505) 326-9700

4. Location of Well, Footage, Sec., T, R, M

1885' FSL, 1745' FWL, Sec. 25, T-30-N, R-11-W, NMPM

5. Lease Number

ST-080869

6. If Indian, All. or  
Tribe Name

7. Unit Agreement Name

8. Well Name & Number

Davis A Federal #1M

9. API Well No.

30-045-

10. Field and Pool

Blanco MV/Basin DK

11. County and State

San Juan Co, NM

12. CHECK APPROPRIATE BOX TO INDICATE NATURE OF NOTICE, REPORT, OTHER DATA

Type of Submission

☒ Notice of Intent

☐ Subsequent Report

☐ Final Abandonment

Type of Action

☐ Abandonment

☐ Recompletion

☐ Plugging Back

☐ Casing Repair

☐ Altering Casing

☒ Other

☒ Change of Plans

☐ New Construction

☐ Non-Routine Fracturing

☐ Water Shut off

☐ Conversion to Injection

13. Describe Proposed or Completed Operations

The subject well, formerly the Payne #8A, has been changed to the Davis A Federal #1M, and now includes the Dakota formation. The attached plat reflects this revision. Below are applicable casing and cementing program changes:

Casing Program:

Hole Size	Depth Interval	Csg Size	Weight	Grade
12 1/4"	0' - 320'	8 5/8"	24.0#	K-55
7 7/8"	0' - 7100'	4 1/2"	10.0#	K-55

Tubing Program:

0' - 7100'	2 3/8"	4.0#	J-55 ECH
------------	--------	------	----------

Cementing Program:

8 5/8" csg - no change

4 1/2" csg - First stage: 1114 sx Class "H" 50/50 Pcp (1437 cu ft)

Second stage: 607 sx Class "B" neat bmt (1730 cu ft)

Additional Information:

New Total Depth: 7100'

Anticipated pore pressure for the Dakota formation: 500 psi

14. I hereby certify that the foregoing is true and correct.

Signed [Signature] Title Regulatory Administrator Date 2/23/99  
vkh

(This space for Federal or State Office use)

APPROVED BY \_\_\_\_\_ Title \_\_\_\_\_ Date \_\_\_\_\_

CONDITION OF APPROVAL, if any:

District I  
PO Box 1980, Hobbs, NM 88241-1980

District II  
PO Drawer DC, Artesia, NM 88211-0719

District III  
1000 Rio Brazos Rd., Aztec, NM 87410

District IV  
PO Box 2088, Santa Fe, NM 87504-2088

State of New Mexico  
Energy, Minerals & Natural Resources Department

OIL CONSERVATION DIVISION  
PO Box 2088  
Santa Fe, NM 87504-2088

Form O-102  
Revised February 21, 1994

Instructions on back  
Submit to Appropriate District Office  
State Lease - 4 Copies  
Fee Lease - 3 Copies

☐ AMENDED REPORT

WELL LOCATION AND ACREAGE DEDICATION PLAT

API Number 30-045-	Pool Code 72319/71599	Pool Name Blanco Mesaverde/Basin Dakota
Property Code 18510	Property Name DAVIS A FEDERAL	Well Number 1M
GRID No. 14538	Operator Name BURLINGTON RESOURCES OIL & GAS COMPANY	Elevation 5980'

<sup>10</sup> Surface Location

UL or lot no. K	Section 25	Township 30N	Range 11W	Lot ID#	Feet from the 1885	North/South line SOUTH	Feet from the 1745	East/West line WEST	County SAN JUAN
--------------------	---------------	-----------------	--------------	---------	-----------------------	---------------------------	-----------------------	------------------------	--------------------

<sup>11</sup> Bottom Hole Location If Different From Surface

UL or lot no.	Section	Township	Range	Lot ID#	Feet from the	North/South line	Feet from the	East/West line	County
---------------	---------	----------	-------	---------	---------------	------------------	---------------	----------------	--------

<sup>12</sup> Dedicated Acres W/314.89	<sup>13</sup> Joint or Infill	<sup>14</sup> Consolidation Code	<sup>15</sup> Order No.
---	-------------------------------	----------------------------------	-------------------------

NO ALLOWABLE WILL BE ASSIGNED TO THIS COMPLETION UNTIL ALL INTERESTS HAVE BEEN CONSOLIDATED OR A NON-STANDARD UNIT HAS BEEN APPROVED BY THE DIVISION

16 2630.76'	4	3	5188.92'	*Revised to show name change	1	17 OPERATOR CERTIFICATION I hereby certify that the information contained herein is true and complete to the best of my knowledge and belief.  Signature Peggy Bradfield Printed Name Regulatory Administrator Title 2-23-99 Date
	5	6	NMSF-079962	2		
2655.84'	1745'	11	10	9	5236.44'	18 SURVEYOR CERTIFICATION I hereby certify that the well location shown on this plat was plotted from field notes of actual surveys made by me or under my supervision, and that the same is true and correct to the best of my belief.  JULY 17, 1998 Date of Survey Signature and Seal of Registered Professional Surveyor NEALE C. EDWARDS NEW MEXICO 6857 Certificate No. 10001
			5217.96'			

**PLAT #1**

**BURLINGTON RESOURCES OIL & GAS COMPANY**  
**PAYNE #8A, 1885' FSL & 1745' FWL**  
**SECTION 25, T30N, R11W, NMPM, SAN JUAN COUNTY, NEW MEXICO**  
**GROUND ELEVATION: 5980' DATE: JULY 17, 1998**

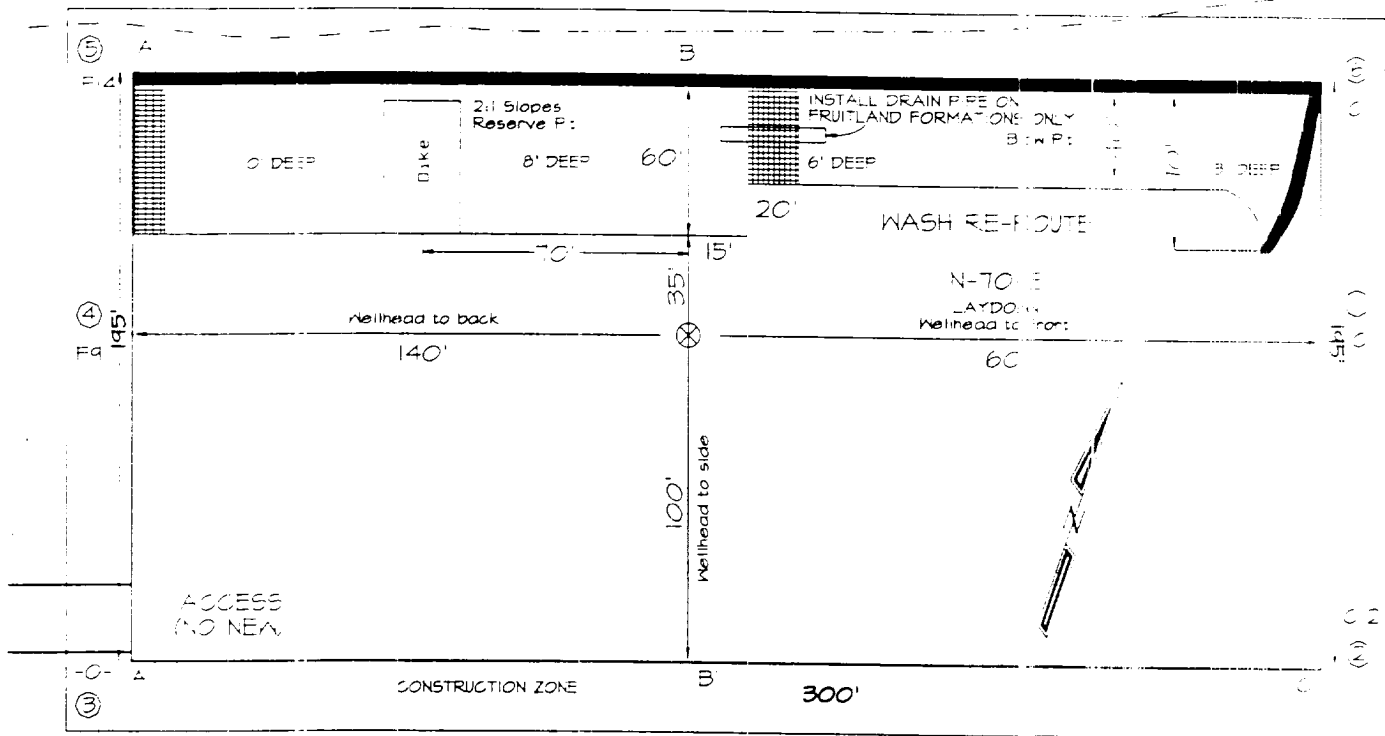

195' x 300' (295' x 400') = 2.71 ACRES

Reserve Pit Dike: to be 8' above Deep side (overflow - 3' wide and 1' above shallow side)  
 Blow Pit: overflow pipe halfway between top and bottom and to extend over plastic liner and into blow pit.

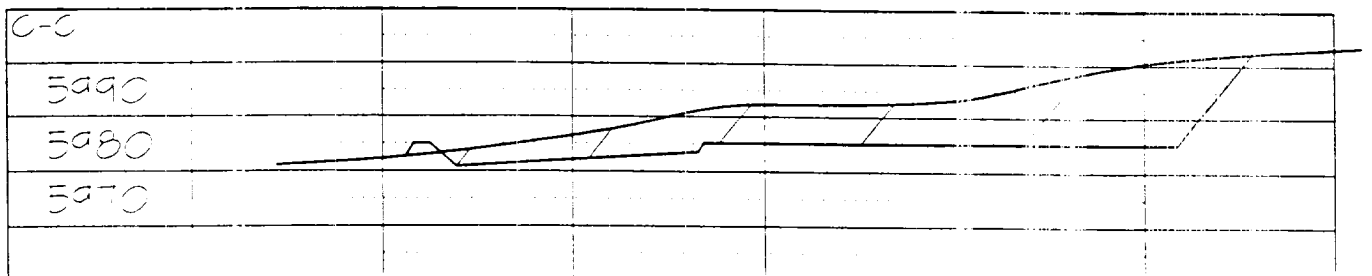
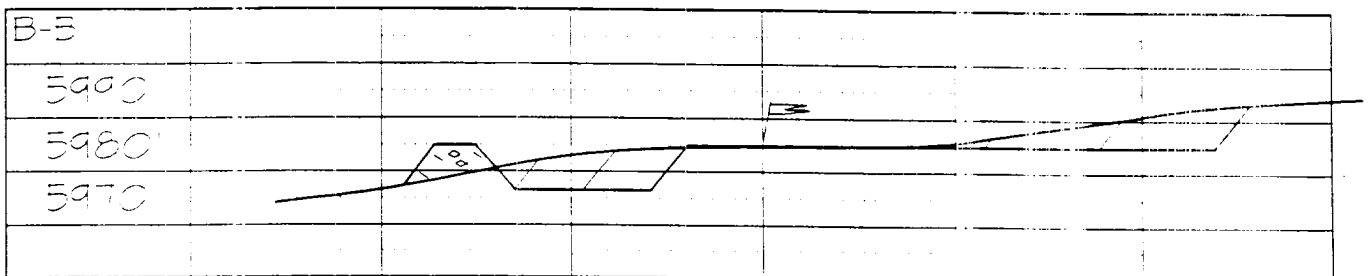
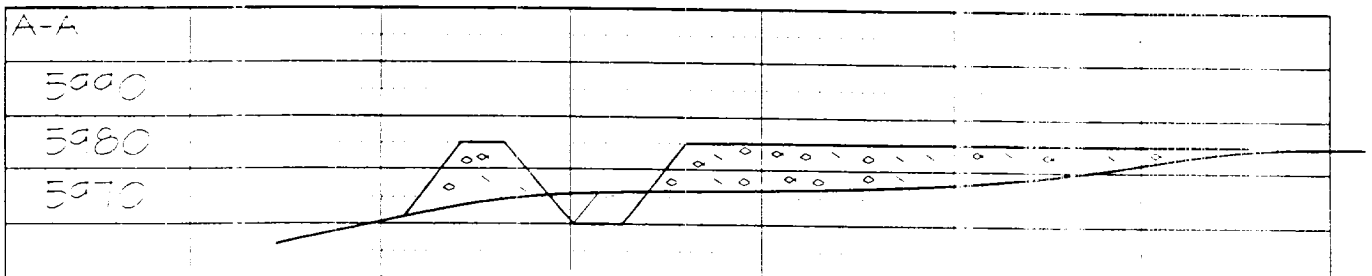

Note: Contractor should call One-Call for location of any marked or unmarked buried pipelines or cables on well pad and/or access road at least two (2) working days prior to construction.

***BURLINGTON RESOURCES OIL AND GAS COMPANY***

**Davis A Federal #1M  
OFFSET OPERATOR \ OWNER PLAT  
Nonstandard Location**

**Mesaverde/Dakota Formations Well**

**Township 30 North, Range 11 West**

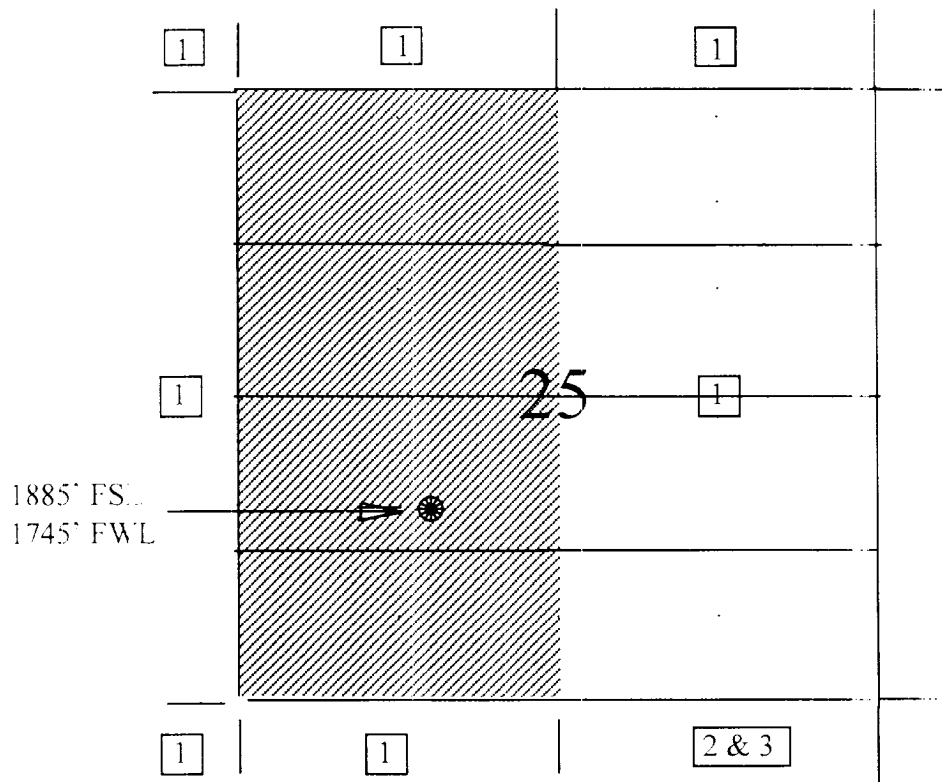

- 1) Burlington Resources
- 2) Amoco Production Company - Land Dept  
Attn: Steve Trefz  
P.O. Box 800  
1670 Broadway  
Denver, CO 80201
- 3) Conoco Inc.  
Attn: Lori Thorpe  
10 Desta Drive, Suite 100W  
Midland, TX 79705

Re: Davis A Federal #1M  
1885'FSL, 1745'FWL Section 25, T-30-N, R-11-W, San Juan County  
30-045-not assigned

I hereby certify that the following offset operators/owners have been mailed notification of our application for non-standard location to drill the referenced well.

Amoco Production Company  
San Juan Operation Center  
200 Amoco Court  
Farmington, NM 87401

Conoco Inc  
Att: Lori Thorpe  
10 Desta Drive, Suite 100W  
Midland, Tx 79705

A handwritten signature in black ink, appearing to read "Peggy Bracfield". The signature is fluid and cursive, with the first name "Peggy" and last name "Bracfield" clearly distinguishable.

Peggy Bracfield  
Burlington Resources  
Regulatory Compliance Administrator



