

Form 3160-3
(July 1992)UNITED STATES
DEPARTMENT OF THE INTERIOR
BUREAU OF LAND MANAGEMENT(Other instructions on
reverse side)FORM APPROVED
OMB NO. 1004-0136
Expires February 28, 1995

APPLICATION FOR PERMIT TO DRILL OR DEEPEN

5. LEASE DESIGNATION AND SERIAL NO

SF NM 078194

6 IF INDIAN, ALLOTTEE OR TRIBE NAME

7 UNIT AGREEMENT NAME

Ludwick LS

8 FARM OR LEASE NAME WELL NO

8C

9. API WELL NO

30-045-30141

10. FIELD AND POOL, OR WILDCAT

Blanco Mesa Verde

11. SEC. T., R., M., OR BLK.

AND SURVEY OR AREA
Sec. 31, T30N, R10W

12 COUNTY OR PARISH

San Juan

13. STATE

NM

1a. TYPE OF WORK

DRILL ☒DEEPEN ☐

b. TYPE OF WELL

OIL WELL ☐GAS WELL ☒

OTHER

SINGLE ZONE ☒MULTIPLE ZONE ☐

2. NAME OF OPERATOR

Conoco Inc.

3. ADDRESS AND TELEPHONE NO

10 Desta Dr. Ste 430E, Midland, Tx. 79705-4500

4. LOCATION OF WELL (Report location clearly and in accordance with any State requirements)

At surface

1285' FNL & 2270' FEL

MAR 2000

RECEIVED

OIL CON DIV

DIST. 3

At proposed prod. zone

1285' FNL & 2270' FEL

14. DISTANCE IN MILES AND DIRECTION FROM NEAREST TOWN OR POST OFFICE

5. DISTANCE FROM PROPOSED*

LOCATION TO NEAREST
PROPERTY OR LEASE LINE, FT.
(Also to nearest drlg. unit line, if Any)

16 NO OF ACRES IN LEASE

17. NO. OF ACRES ASSIGNED
TO THIS WELL

314.52

8. DISTANCE FROM PROPOSED LOCATION*
TO NEAREST WELL, DRILLING, COMPLETED,
OR APPLIED FOR, ON THIS LEASE, FT.

19. PROPOSED DEPTH

5580'

20. ROTARY OR CABLE TOOLS

Rotary

21. ELEVATIONS (Show whether DF, RT, GR, etc.)

6061'

22. APPROX. DATE WORK WILL START*

3/1/00

23

PROPOSED CASING AND CEMENTING PROGRAM

SIZE OF HOLE	GRADE, SIZE OF CASING	WEIGHT PER FOOT	SETTING DEPTH	QUANTITY OF CEMENT
12-1/4"	WC-50, 9-5/8"	32.5#	250'	145 sxs, circ.
8-3/4"	WC-50, 7"	20#	2025'	250 sxs, circ.
6-1/4"	WC-50, 4-1/2"	10.5#	5280'	360 sxs, tol @ 1825'

It is proposed to drill a vertical wellbore to the Blanco Mesaverde Pool. An NOS was filed 10/11/99. The well will be drilled and equipped according to the following additional attachments:

1. Well Location & Acreage Dedication Plat (C-102).
2. Proposed Well Plan Outline.
3. Cementing Plan.
4. Blowout Preventer Hookup.
5. Surface Use Plan with Production Facility layout.
6. Temporary Pipeline Tie Specifications.

This action is subject to technical and procedural review pursuant to 43 CFR 3165.3 and appeal pursuant to 43 CFR 3165.4.

This application includes ROW's for the well pad, cathodic protection and pipeline.

OPERATIONS AUTHORIZED ARE
SUBJECT TO COMPLIANCE WITH ATTACHED
"GENERAL REQUIREMENTS"

IN ABOVE SPACE DESCRIBE PROPOSED PROGRAM; If proposal is to deepen give data on present productive zone and proposed new productive zone. If proposal is to drill or deepen directionally, give pertinent data on subsurface locations and measured and true vertical depths. Give blowout preventer program, if any.

24.

SIGNATURE

Jo Ann Johnson

TITLE

Jo Ann Johnson
Sr. Property Analyst

DATE

2/4/00

(This space for Federal or State office Use)

PERMIT NO

APPROVAL DATE

Application approval does not warrant or certify that the applicant holds legal or equitable title to those rights in the subject lease which would entitle the applicant to conduct operations thereon.

CONDITIONS OF APPROVAL, IF ANY:

/s/ Charlie Beecham

MAOCD

MAR 20 2000

APPROVED BY

TITLE

DATE

*See Instructions On Reverse Side

Title 18 U.S.C. Section 1001, makes it a crime for any person knowingly and willfully to make to any department or agency of the United States any false, fictitious or fraudulent statements or representations as to any matter within its jurisdiction.

OKCTP

District I
PO Box 1980, Hobbs, NM 88241-1980

State of New Mexico
Energy, Minerals & Natural Resources Department

Form C-10
Revised February 21, 1995

District II
PO Drawer 00, Artesia, NM 88211-0719

Submit to Appropriate District Office
State Lease - 4 Copies
Fee Lease - 3 Copies

District III
1000 Rio Brazos Rd., Aztec, NM 87410

OIL CONSERVATION DIVISION
PO Box 2088
Santa Fe, NM 87504-2088

District IV
PO Box 2088, Santa Fe, NM 87504-2088

☐ AMENDED REPORT

WELL LOCATION AND ACREAGE DEDICATION PLAT

API Number 30045-30141		Pool Code 72319	Pool Name BLANCO MESAVERDE
Property Code 22398	Property Name LUDWICK LS		Well Number 8C
OGAID No. 005073	Operator Name CONOCO, INC.		Elevation 6061'

10 Surface Location

UL or lot no.	Section	Township	Range	Lot 101	Feet from the	North/South line	Feet from the	East/West line	County
B	31	30N	10W		1285	NORTH	2270	EAST	SAN JUAN

11 Bottom Hole Location If Different From Surface

UL or lot no.	Section	Township	Range	Lot 101	Feet from the	North/South line	Feet from the	East/West line	County
Dedicated Acres 314.52		Joint or Infill		Consolidation Code		Order No.			

NO ALLOWABLE WILL BE ASSIGNED TO THIS COMPLETION UNTIL ALL INTERESTS HAVE BEEN CONSOLIDATED OR A NON-STANDARD UNIT HAS BEEN APPROVED BY THE DIVISION

1212.42'	1303.50'	2507.00'		17 OPERATOR CERTIFICATION	
LOT 8	LOT 7	1285'	LOT 6	LOT 5	I hereby certify that the information contained herein is true and complete to the best of my knowledge and belief.
2618.22'	LOT	31	2270'		Signature <i>Mike L. Mankin</i>
			LOT 11	LOT 12	Printed Name Mike L. Mankin
					Right-of-Way Agent
					Title 1-31-00
					Date
LOT 16	LOT 15	LOT 14	LOT 13	18 SURVEYOR CERTIFICATION	
				I hereby certify that the well location shown on this plat was plotted from field notes of actual surveys made by me or under my supervision, and that the same is true and correct to the best of my belief.	
2607.00'	LOT 17	LOT 18	LOT 19	LOT 20	OCTOBER 15, 1999
					Date of Survey
1156.32'	1284.36'	2644.62'	Signature and Seal of NEALE C. EDWARDS NEW MEXICO 6857		
			Certificate Number 6857		

UNITED STATES
DEPARTMENT OF THE INTERIOR
BUREAU OF LAND MANAGEMENT(Other instructions on
reverse side)FORM APPROVED
OMB NO. 1004-0136
Expires February 28, 1995

APPLICATION FOR PERMIT TO DRILL OR DEEPEN

1a. TYPE OF WORK

DRILL ☒DEEPEN ☐

b. TYPE OF WELL

OIL
WELL ☐GAS
WELL ☒

OTHER

SINGLE
ZONE ☒MULTIPLE
ZONE ☐

2. NAME OF OPERATOR

Conoco Inc.

a. ADDRESS AND TELEPHONE NO

10 Desta Dr. Ste 649W Midland, Tx. 79705-4500

4. LOCATION OF WELL (Report location clearly and in accordance with any State requirements *)

At surface

1285' FNL & 2270' FEL

At proposed prod. zone

1285' FNL & 2270' FEL

14. DISTANCE IN MILES AND DIRECTION FROM NEAREST TOWN OR POST OFFICE*

5. DISTANCE FROM PROPOSED*

LOCATION TO NEAREST

PROPERTY OR LEASE LINE, FT.

(Also to nearest drilg. unit line, if Any)

16. NO. OF ACRES IN LEASE

17. NO. OF ACRES ASSIGNED
TO THIS WELL

8. DISTANCE FROM PROPOSED LOCATION*

TO NEAREST WELL, DRILLING, COMPLETED,
OR APPLIED FOR, ON THIS LEASE, FT.

19. PROPOSED DEPTH

5580'

20. ROTARY OR CABLE TOOLS

Rotary

21. ELEVATIONS (Show whether DF, RT, GR, etc.)

6061'

22. APPROX. DATE WORK WILL START*

3/1/00

5. LEASE DESIGNATION AND SERIAL NO

NM 078194

6. IF INDIAN, ALLOTTEE OR TRIBE NAME

7. UNIT AGREEMENT NAME

Ludwick LS

8. FARM OR LEASE NAME WELL NO

8C

9. API WELL NO

10. FIELD AND POOL, OR WILDCAT

Blanco Mesa Verde

11. SEC. T., R., M., OR BLK.
AND SURVEY OR AREA

Sec. 31, T30N, R10W

12. COUNTY OR PARISH

San Juan

13. STATE

NM

PROPOSED CASING AND CEMENTING PROGRAM

SIZE OF HOLE	GRADE, SIZE OF CASING	WEIGHT PER FOOT	SETTING DEPTH	QUANTITY OF CEMENT
12-1/4"	WC-50, 9-5/8"	32.5#	250'	145 sxs, circ.
8-3/4"	WC-50, 7"	20#	2025'	250 sxs, circ.
6-1/4"	WC-50, 4-1/2"	10.5#	5280'	360 sxs, tol @ 1825'

It is proposed to drill a vertical wellbore to the Blanco Mesaverde Pool. An NOS was filed 10/11/99. The well will be drilled and equipped according to the following additional attachments:

1. Well Location & Acreage Dedication Plat (C-102).
2. Proposed Well Plan Outline.
3. Cementing Plan.
4. Blowout Preventer Hookup.
5. Surface Use Plan with Production Facility layout.
6. Temporary Pipeline Tie Specifications.

This application includes ROW's for the well pad, cathodic protection and pipeline.

IN ABOVE SPACE DESCRIBE PROPOSED PROGRAM: If proposal is to deepen give data on present productive zone and proposed new productive zone. If proposal is to drill or deepen directionally, give pertinent data on subsurface locations and measured and true vertical depths. Give blowout preventer program, if any.

24.

SIGNED

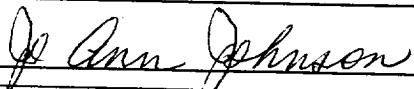

TITLE

Jo Ann Johnson
Sr. Property Analyst

DATE 2/4/00

(This space for Federal or State office use)

PERMIT NO

APPROVAL DATE

Application approval does not warrant or certify that the applicant holds legal or equitable title to those rights in the subject lease which would entitle the applicant to conduct operations thereon.

CONDITIONS OF APPROVAL, IF ANY:

APPROVED BY

TITLE

DATE

*See Instructions On Reverse Side

Title 18 U.S.C. Section 1001, makes it a crime for any person knowingly and willfully to make to any department or agency of the United States any false, fictitious or fraudulent statements or representations as to any matter within its jurisdiction.

District I
PO Box 1980, Hobbs, NM 88241-1980

District II
PO Drawer 00, Artesia, NM 88211-0719

District III
1000 Rio Brazos Rd., Aztec, NM 87410

District IV
PO Box 2088, Santa Fe, NM 87504-2088

State of New Mexico
Energy, Minerals & Natural Resources Department

OIL CONSERVATION DIVISION
PO Box 2088
Santa Fe, NM 87504-2088

Form C-102
Revised February 21, 1994

Instructions on back
Submit to Appropriate District Office
State Lease - 4 Copies
Fee Lease - 3 Copies

☐ AMENDED REPORT

WELL LOCATION AND ACREAGE DEDICATION PLAT

*API Number		*Pool Code 72319	*Pool Name BLANCO MESAVERDE
*Property Code 22398	*Property Name LUDWICK LS		*Well Number 8C
*OGRID No. 005073	*Operator Name CONOCO, INC.		*Elevation 6061'

¹⁰ Surface Location

UL or lot no. B	Section 31	Township 30N	Range 10W	Lot Idn	Feet from the 1285	North/South line NORTH	Feet from the 2270	East/West line EAST	County SAN JUAN
--------------------	---------------	-----------------	--------------	---------	-----------------------	---------------------------	-----------------------	------------------------	--------------------

¹¹ Bottom Hole Location If Different From Surface

UL or lot no.	Section	Township	Range	Lot Idn	Feet from the	North/South line	Feet from the	East/West line	County
---------------	---------	----------	-------	---------	---------------	------------------	---------------	----------------	--------

¹² Dedicated Acres 320 E/2	¹³ Joint or Infill	¹⁴ Consolidation Code	¹⁵ Order No.
--	-------------------------------	----------------------------------	-------------------------

NO ALLOWABLE WILL BE ASSIGNED TO THIS COMPLETION UNTIL ALL INTERESTS HAVE BEEN CONSOLIDATED
OR A NON-STANDARD UNIT HAS BEEN APPROVED BY THE DIVISION

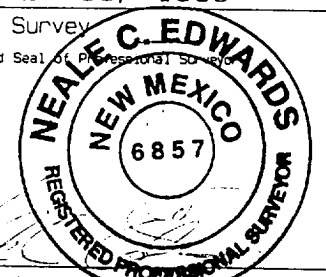
¹⁶ 1212.42'	1303.50'	2607.00'		¹⁷ OPERATOR CERTIFICATION	
LOT 8	LOT 7	LOT 6	LOT 5	I hereby certify that the information contained herein is true and complete to the best of my knowledge and belief	
2618.22'	LOT 9	LOT 10	LOT 11	LOT 12	Signature <i>Mike L. Mankin</i>
					Printed Name Mike L. Mankin
2607.00'	LOT 16	LOT 15	LOT 14	LOT 13	Right-of-Way Agent
					Title
					Date 1-31-99
1156.32'	LOT 17	LOT 18	LOT 19	LOT 20	¹⁸ SURVEYOR CERTIFICATION
					I hereby certify that the well location shown on this plat was plotted from field notes of actual surveys made by me or under my supervision, and that the same is true and correct to the best of my belief.
OCTOBER 15, 1999					
Date of Survey					
Signature and Seal of Professional Surveyor					
					
Certificate Number 6857					

Directions from the intersection of State Hwy 173 & US Hwy 550 in Aztec, NM

to Conoco, Inc. Ludwick LS #8C

1285' FNL & 2270' FEL, Section 31, T30N, R10W, N.M.P.M., San Juan County, NM.

From the Intersection of State Hwy 173 & US Hwy 550 in Aztec, NM, travel (South-easterly) on State Hwy 173 for 4.2 miles to State Hwy 575;

Go right (South-easterly) on State Hwy 575 for 100' to fork in road;

Go right (South-westerly) for 0.1 miles to fork in road;

Go left (South-westerly) for 1.3 miles to 4-way intersection;

Go straight (Southerly) for 0.3 miles to fork in road;

Go left (South-easterly) for 0.4 miles to fork in road;

Go right (South-westerly) for 0.8 miles to fork in road;

Go right (South-westerly) for 0.2 miles to fork in road;

Go straight (South-westerly) for 0.4 miles to staked location on left-hand side of road.

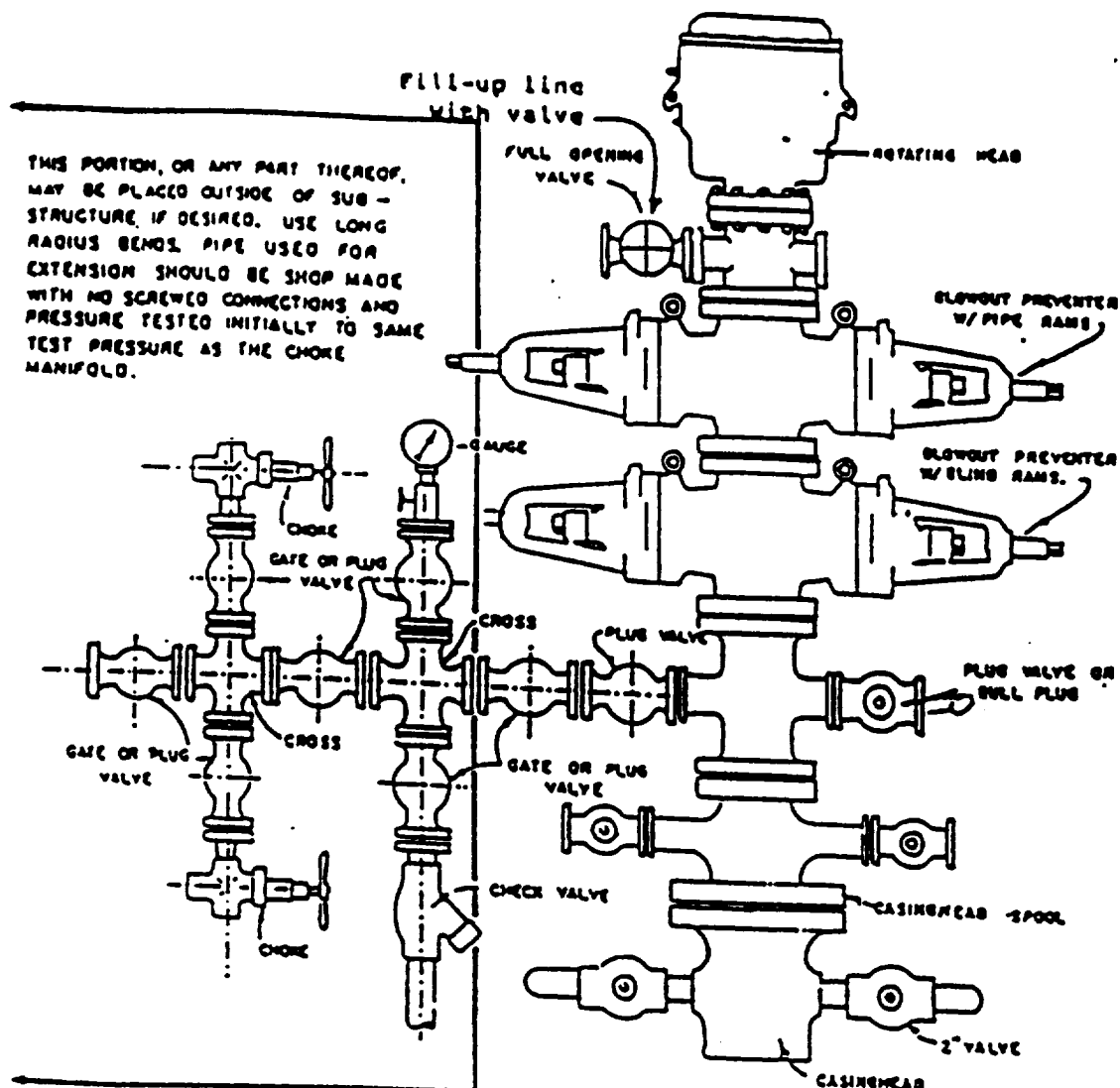

BLOWOUT PREVENTER HOOKUP

Drilling contractors used in the San Juan Basing supply 3000 psi equipment, but cannot provide annular preventors because of sub-structure limitations. Maximum anticipated surface pressures for this well will not exceed the working pressure of the proposed BOP system. Please see the attached BOP diagram details 2000 psi equipment according to Onshore Order No. 2 even though the deletion of the annular preventor and fulfills your requirements (note diagram No. 1). In addition, the following equipment will comprise the 2000 psi system:

1. Two rams with one blind and one pipe ram.
2. Kill line (2 inch maximum).
3. One kill line valve.
4. One choke line valve.
5. Two chokes (reference diagram No. 1).
6. Upper kelly cock valve with handle.
7. Safety valve and subs to fit all drill strings in use.
8. Two-inch minimum choke line.
9. Pressure gauge on choke manifold.
10. Fill-up line above the upper most preventor.
11. Rotating head.

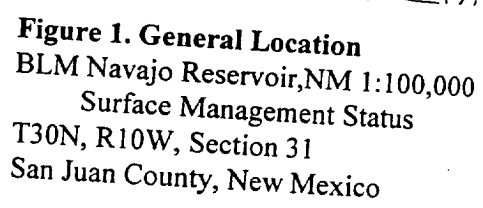

1285' FNL & 2270' FEL, SECTION 31, T30N, R10W, N.M.P.M.
SAN JUAN COUNTY, NEW MEXICO

