

(SUBMIT IN TRIPLICATE)

UNITED STATES
DEPARTMENT OF THE INTERIOR
GEOLOGICAL SURVEY

Land Office Santa Fe
Lease No. SF-078996
Unit 14-08-001-441

APPROVED

AUG 20 1957

JERRY W. LOGG
ACTING DISTRICT ENGINEER

SPINDRY NOTICES AND REPORTS ON WELLS

| | | |
|--|-------------------------------------|--|
| NOTICE OF INTENTION TO DRILL | <input checked="" type="checkbox"/> | SUBSEQUENT REPORT OF WATER SHUT-OFF |
| NOTICE OF INTENTION TO CHANGE PLANS | | SUBSEQUENT REPORT OF SHOOTING OR ACIDIZING |
| NOTICE OF INTENTION TO TEST WATER SHUT-OFF | | SUBSEQUENT REPORT OF ALTERING CASING |
| NOTICE OF INTENTION TO RE-DRILL OR REPAIR WELL | | SUBSEQUENT REPORT OF RE-DRILLING OR REPAIR |
| NOTICE OF INTENTION TO SHOOT OR ACIDIZE | | SUBSEQUENT REPORT OF ABANDONMENT |
| NOTICE OF INTENTION TO PULL OR ALTER CASING | | SUPPLEMENTARY WELL HISTORY |
| NOTICE OF INTENTION TO ABANDON WELL | | |

(INDICATE ABOVE BY CHECK MARK NATURE OF REPORT, NOTICE, OR OTHER DATA)

August 26, 1957

Well No. 32-7 Unit
19-4 is located 990 ft. from S line and 1650 ft. from W line of sec. 4

SE/4 SW/4 Sec. 4 31 North 7 West N.M.P.M.
(1/4 Sec. and Sec. No.) (Twp.) (Range) (Meridian)

Blanco Mesa Verde San Juan New Mexico
(Field) (County or Subdivision) (State or Territory)

The elevation of the ground floor above sea level is 6624 ft.

DETAILS OF WORK

(State names of and expected depths to objective sands; show sizes, weights, and lengths of proposed casings; indicate mudding jobs, cementing points, and all other important proposed work)

Propose to drill to 200' and set 9-5/8" casing, cement to surface. Set 7" casing @ 3750', cement w/150 sx regular w/8% gel and 50 sx neat. Set 5" casing @ 6020', cement w/150 sx regular.

Mesa Verde to be fractured thru perfs using approx 150,000 gals water. Clean out to total depth, set tubing and complete well.

The SW/4, NW/4SE/4, Lots 6, 7, & 8, of Section 4 and Lot 5 of Section 5, containing 323.15 acres, is dedicated to this well.

100% Pacific Northwest Pipeline Corporation

I understand that this plan of work must receive approval in writing by the Geological Survey before operations may be commenced.

Company PACIFIC NORTHWEST PIPELINE CORPORATION

Address 405 1/2 West Broadway

Farmington, New Mexico

By Original signed by T. A. Dugan

Title Division Manager

APPROVED

NEW MEXICO OIL CONSERVATION COMMISSION

Well Location and Acreage Dedication Plat

Section A.

Date August 28, 1957

Operator Pacific Northwest Pipeline Corporation Lease 30-7
Well No. 10-4 Unit Letter Section 4 Township 31 North Range 7 West NMPM
Located 990 Feet From South Line, 1650 Feet From West Line
County San Juan G. L. Elevation 6624 Dedicated Acreage 100.15 Acres
Name of Producing Formation Alamo Wells Pool Alamo

1. Is the Operator the only owner* in the dedicated acreage outlined on the plat below?
Yes X No
2. If the answer to question one is "no," have the interests of all the owners been consolidated by communitization agreement or otherwise? Yes No . If answer is "yes,"
Type of Consolidation
3. If the answer to question two is "no," list all the owners and their respective interests below:

| <u>Owner</u> | <u>Land Description</u> |
|--------------|-------------------------|
| | |
| | |
| | |

Section. B

LOT #5 SECTION 5 Dedicated to Well

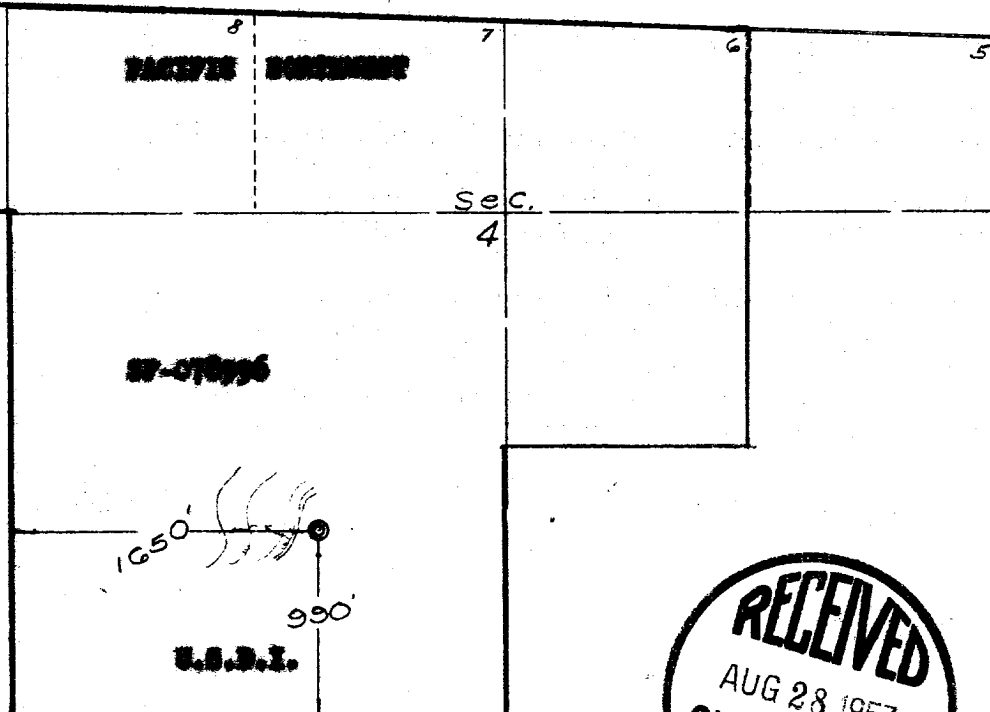

Scale 1"=1000'

This is to certify that the information in Section A above is true and complete to the best of my knowledge and belief.

PACIFIC NORTHWEST PIPELINE
(Operator)

Original signed by T. A. Dugan
(Representative)

4024 W. Hwy. Farmington, N.M.
Address

This is to certify that the well location shown on the plat in Section B was located from field notes of surveys made by my super that the same is to the best of and belief.

Date Surveyed August 19, 1957

Ernest V. Echohawk
Registered Land Surveyor.

Certificate No. 145