

NEW MEXICO OIL CONSERVATION COMMISSION
Santa Fe, New Mexico

NOTICE OF INTENTION TO DRILL OR RECOMPLETE

Notice must be given to the District Office of the Oil Conservation Commission and approval obtained before drilling or recompletion begins. If changes in the proposed plan are considered advisable, a copy of this notice showing such changes will be returned to the sender. Submit this notice in **QUINTUPLICATE**. One copy will be returned following approval. See additional instructions in Rules and Regulations of the Commission.

Farmington, New Mexico

March 26, 1954

(Place)

(Date)

OIL CONSERVATION COMMISSION
SANTA FE, NEW MEXICO

Gentlemen:

You are hereby notified that it is our intention to commence the (Drilling) ~~recompletion~~ of a well to be known as

El Paso Natural Gas Company

(Company or Operator)

Fifield

(Lease)

Well No. **1**

D

(Unit)

The well is

located **990** feet from the

N

line and **1150**

feet from the

W

line of Section **21**

T. **30N**

R. **11W**

NMPM.

(GIVE LOCATION FROM SECTION LINE)

Aztec

Pool,

San Juan

County

If State Land the Oil and Gas Lease is No.

Fifield

If patented land the owner is

Address

We propose to drill well with drilling equipment as follows: **Rotary tools to the top of the Pictured Cliffs, completing the well with Cable Tools.**

The status of plugging bond is **Statewide**

Drilling Contractor **Company Tools**

We intend to complete this well in the **Pictured Cliffs**

formation at an approximate depth of **2180** feet.

CASING PROGRAM

We propose to use the following strings of Casing and to cement them as indicated:

Size of Hole	Size of Casing	Weight per Foot	New or Second Hand	Depth	Sacks Cement
13 3/8	9 5/8	25.4	New	100'	100
8 3/4	7	20	New	2103'	150

If changes in the above plans become advisable we will notify you immediately.

ADDITIONAL INFORMATION (If recompletion give full details of proposed plan of work.) **It is intended to shoot the Pictured Cliffs formation with 2 quarts S.N.G. per foot. Total Depth 2180'.**

The NW/4 of Section 21 is dedicated to this well.

Approved
Except as follows:

5-29, 1954

Sincerely yours,

El Paso Natural Gas Company

(Company or Operator)

By

Petroleum Engineer

Position

Send Communications regarding well to

Name **E. J. Coal**

Address **Box 997, Farmington, New Mexico**

OIL CONSERVATION COMMISSION

By

Title

RECEIVED BY MAIL NO. 3

COMPANY EL PASO NATURAL GAS COMPANY

Well Name & No. FITFIELD NO. 1 Lease No. FEE

Location 990 FEET FROM THE NORTH LINE, 1150 FEET FROM THE WEST LINE

being in NW/4 OF THE NW/4

Sec. 21, T30 N., R11 E., N.M.P.M., SAN JUAN COUNTY, NEW MEXICO

Ground Elevation 5731⁷²

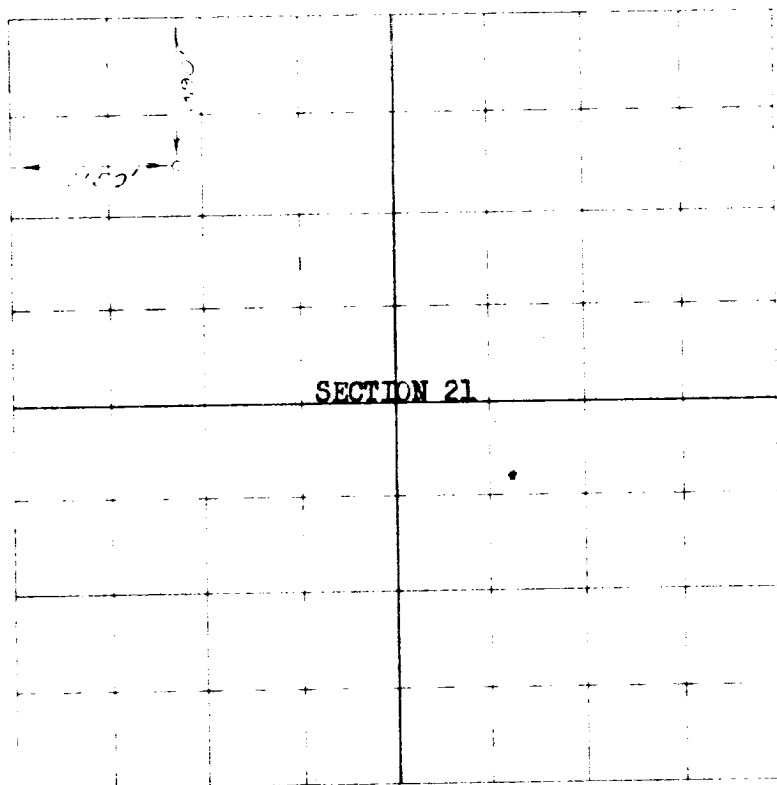

Scale -- 4 inches equals 1 mile



Surveyed MARCH 17, 19 54

This is to certify that the above plat was prepared from field notes of actual surveys made by me or under my supervision and that the same are true and correct to the best of my knowledge and belief.

Seal:

C. A. Z. [Signature]
Registered Professional
Engineer and Land Surveyor.

Farmington, New Mexico

OIL CONSERVATION COMMISSION		
AZTEC DISTRICT OFFICE		
No. Copies Recd.	7	
DISPOSITION		
	No. Emitted	
Operator	3	
Santa Fe	1	
Proration Office		
State Land Office		
U. S. G. S.	2	
Transporter		
File	1	✓