

(SUBMIT IN TRIPLICATE)

UNITED STATES
DEPARTMENT OF THE INTERIOR
GEOLOGICAL SURVEY

Land Office Santa Fe
Lease No. 079003
Unit Northeast Blanco

SUNDRY NOTICES AND REPORTS ON WELLS

NOTICE OF INTENTION TO DRILL.....	<input checked="" type="checkbox"/>	SUBSEQUENT REPORT OF WATER SHUT-OFF.....	
NOTICE OF INTENTION TO CHANGE PLANS.....		SUBSEQUENT REPORT OF SHOOTING OR ACIDIZING.....	
NOTICE OF INTENTION TO TEST WATER SHUT-OFF.....		SUBSEQUENT REPORT OF ALTERING CASING.....	
NOTICE OF INTENTION TO RE-DRILL OR REPAIR WELL.....		SUBSEQUENT REPORT OF REDRILLING OR REPAIR.....	
NOTICE OF INTENTION TO SHOOT OR ACIDIZE.....		SUBSEQUENT REPORT OF ABANDONMENT.....	
NOTICE OF INTENTION TO PULL OR ALTER CASING.....		SUPPLEMENTARY WELL HISTORY.....	
NOTICE OF INTENTION TO ABANDON WELL.....			

(INDICATE ABOVE BY CHECK MARK NATURE OF REPORT, NOTICE, OR OTHER DATA)

April 24, 19 52

Well No. 1 is located 1650 ft. from N line and 990 ft. from E line of sec. 27
NE 1/4 Sec. 27 31N 7W New Mexico Principal
 (1/4 Sec. and Sec. No.) (Twp.) (Range) (Meridian)
Wildcat New Mexico
 (Field) (County or Subdivision) (State or Territory)

APR 25 1952
OIL CON. COM.
DIST. 3

The elevation of the derrick floor above sea level is _____ ft. Will report when run.

DETAILS OF WORK

(State names of and expected depths to objective sands; show sizes, weights, and lengths of proposed casings; indicate mudding jobs, cementing points, and all other important proposed work)

Set approximately 450' of 13-3/8" OD, 48#, Surface Casing and circulate cement.
 Set approximately 5600' of 8-5/8" OD, 32# and 36#, Intermediate Casing and cement with 100 or more sacks of cement, if necessary.
 Drill and test Pictured Cliff @ approximately 3900', Mesa Verde @ approximately 5000' and Dakota @ approximately 8000'.
 Should Dakota test favorably, set up to 8500' of 5-1/2" OD, 15.5# and 17#, casing and attempt to complete a Dakota well using 2" EUE 4.7# J tubing string.

I understand that this plan of work must receive approval in writing by the Geological Survey before operations may be commenced.

Company BLACKWOOD & NICHOLS COMPANY
 Address 1313 Liberty Bank Building
Oklahoma City
Oklahoma
 By W. H. Little
 Title Superintendent

Santa Fe Lease #079303

Company Blackwood-Nichols

Lease Northeast Blanco Unit Well No. 1

Sec. 27 T. 31 N., R. 7 W., N.M.P.M.

Location 1650' from the North line and 990' from the East line.

Sandoval County New Mexico

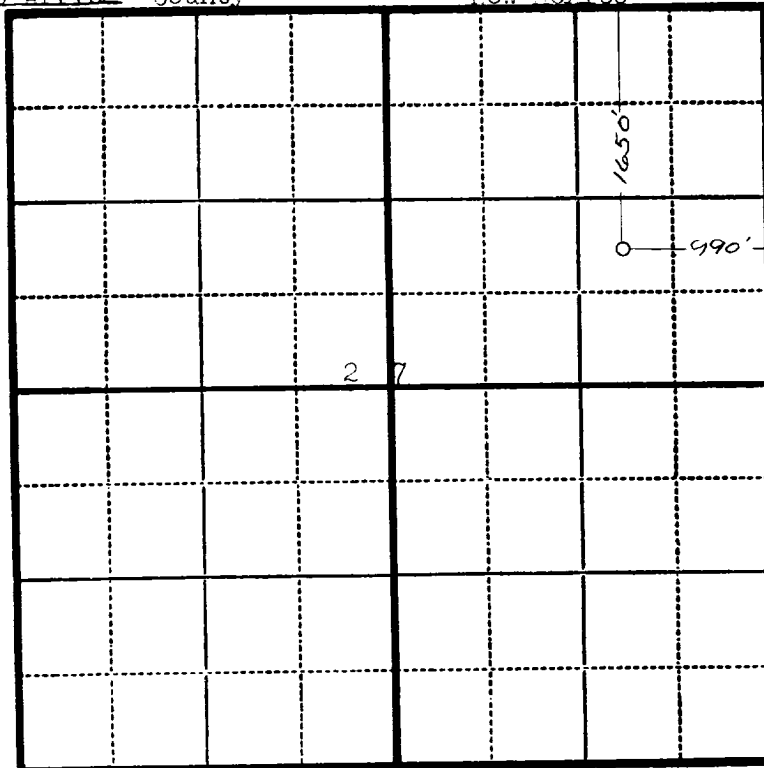

Scale—4 inches equals 1 mile.

This is to certify that the above plat was prepared from field notes of actual surveys made by me or under my supervision and that the same are true and correct to the best of my knowledge and belief.

Charles J. Finklea

Seal:

Registered Professional
Engineer and Land Surveyor.

Charles J. Finklea
N. Mex. Reg. No. 1302

Surveyed April 22, 1952