

(SUBMIT IN TRIPLICATE)

UNITED STATES
DEPARTMENT OF THE INTERIOR
GEOLOGICAL SURVEY

Land Office Santa Fe
Lease No. 97903
Unit Northeast Blance
Unit Agreement No. 1 See 929

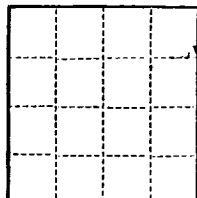

SUNDRY NOTICES AND REPORTS ON WELLS

NOTICE OF INTENTION TO DRILL.....	<input checked="" type="checkbox"/>	SUBSEQUENT REPORT OF WATER SHUT-OFF.....
NOTICE OF INTENTION TO CHANGE PLANS.....		SUBSEQUENT REPORT OF SHOOTING OR ACIDIZING.....
NOTICE OF INTENTION TO TEST WATER SHUT-OFF.....		SUBSEQUENT REPORT OF ALTERING CASING.....
NOTICE OF INTENTION TO RE-DRILL OR REPAIR WELL.....		SUBSEQUENT REPORT OF RE-DRILLING OR REPAIR.....
NOTICE OF INTENTION TO SHOOT OR ACIDIZE.....		SUBSEQUENT REPORT OF ABANDONMENT.....
NOTICE OF INTENTION TO PULL OR ALTER CASING.....		SUPPLEMENTARY WELL HISTORY.....
NOTICE OF INTENTION TO ABANDON WELL.....		

(INDICATE ABOVE BY CHECK MARK NATURE OF REPORT, NOTICE, OR OTHER DATA)

May 12, 1954

Well No. 20-28 is located 1190 ft. from N line and 1650 ft. from E line of sec. 28
NE 1/4 Sec 28 T1 N 7 W RPM
(1/4 Sec. and Sec. No.) (Twp.) (Range) (Meridian)
Wildcat Bluff San Juan New Mexico
(Field) (County or Subdivision) (State or Territory)

The elevation of the derrick floor above sea level is 6989 ft.

DETAILS OF WORK

(State names of and expected depths to objective sands; show sizes, weights, and lengths of proposed casings; indicate mudding jobs, cementing points, and all other important proposed work)

Set approximately 200' of 10-3/4" 32.75# H-40 casing and circulate cement.
 Set approximately 5300' of 7" 20 & 23# J-55 casing and cement with 300oz cement.
 Drill to total depth of approximately 5900' to test the Manavero Formation.

I understand that this plan of work must receive approval in writing by the Geological Survey before operations may be commenced.

Company Blackwood & Nichols Company
 Address P. O. Box 1237
Durango, Colorado

By De Lasso Loos
DE LASSO LOOS
 Title FIELD SUPERINTENDENT

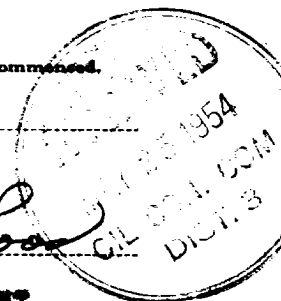

Company BLACK AND NICHOLS COMPANY

Lease..... Well No.....

Sec..... 28, T..... 31 N, R..... 7 W., N.M.P.M.

Location 1190' from the North line and 1650' from the East line.

Elevation..... 6979 Ungraded ground.

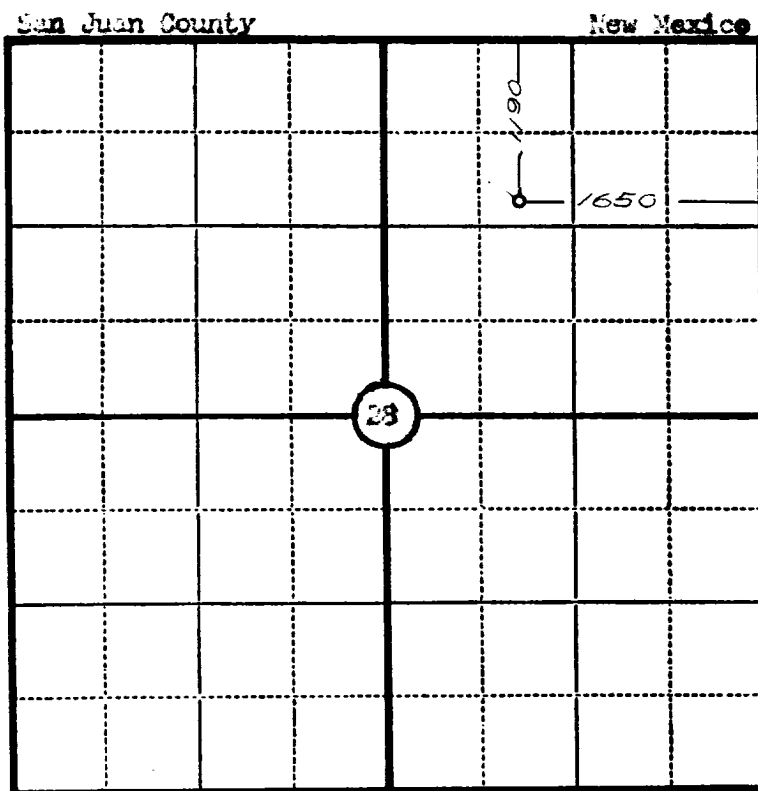

Scale—4 inches equal 1 mile.

This is to certify that the above plat was prepared from field notes of actual surveys made by me or under my supervision and that the same are true and correct to the best of my knowledge and belief.

Seal:

Registered Professional
Engineer and Land Surveyor.

Charles J. Finkles
N. Mex. Reg. No. 1302

Surveyed 6 May, 19 54

RECEIVED
MAY 7 1954

