

NEW MEXICO OIL CONSERVATION COMMISSION

Santa Fe, New Mexico

NOTICE OF INTENTION TO DRILL OR RECOMPLETE

Notice must be given to the District Office of the Oil Conservation Commission and approval obtained before drilling or recompletion begins. If changes in the proposed plan are considered advisable, a copy of this notice showing such changes will be returned to the submitter. Submit this notice in QUINTUPLICATE. One copy will be returned following approval. See additional instructions in the regulations of the Commission.

Durango, Colorado

(Place)

May 4, 1956

(Date)

OIL CONSERVATION COMMISSION
SANTA FE, NEW MEXICO

Gentlemen:

You are hereby notified that it is our intention to commence the (Drilling) (Recompletion) of a well to be known as

47-32

Blackwood & Nichols Company (Unit Operator)

(Company or Operator)

E-292-9 (NE Blanco Unit)

(Lease)

47-32

(Unit)

NE Blanco (K)

The well is

located 1650' feet from the South line and 1850' feet from the West line of Section 32, T. 31N, R. 7W, NMPM.

(GIVE LOCATION FROM SECTION LINE)

Blanco Mesaverde

Pool,

San Juan

County

If State Land the Oil and Gas Lease is No. E-292-9

If patented land the owner is

Address

We propose to drill well with drilling equipment as follows: EMSCO "500" Drilling rig (Rotary)

The status of plugging bond is

Drilling Contractor George Holand Drilling Co., Inc.

We intend to complete this well in the Mesaverde

formation at an approximate depth of 5800' feet.

CASING PROGRAM

We propose to use the following strings of Casing and to cement them as indicated:

Size of Hole	Size of Casing	Weight per Foot	New or Second Hand	Depth	Sacks Cement
15"	10-3/4"	32.75#	New	160'	200
9-7/8"	7-5/8"	26.40#	New	3500'	225
6-3/4"	5-1/2"	15.50#	New	5800'	200

If changes in the above plans become advisable we will notify you immediately.

ADDITIONAL INFORMATION (If recompletion give full details of proposed plan of work.)

Sanfrac the Cliffhouse, Menafee and Point Lookout formations with approximately 60,000 gals water and 50,000 lbs sand, each.

Approved
Except as follows:

5-7, 19.56

Sincerely yours,

BLACKWOOD & NICHOLS COMPANY

(Company or Operator)

By

De Lasso Loos

DELA SSO LOOS

Position

Field Superintendent

Send Communications regarding well to

Name

Blackwood & Nichols Company

Address

P. O. Box 1237

Durango, Colorado

OIL CONSERVATION COMMISSION

By

Oil and Gas Inspector Dist. #3.

Title

NEW MEXICO
OIL CONSERVATION COMMISSION

Form C-128

Well Location and/or Gas Proration Plat

Date April 25, 1956

Operator BLACKWOOD AND NICHOLS COMPANY

Lease Northeast Blanco Unit

Well No. 47-32 Section 32 Township 31 NORTH Range 7 WEST, NMPM

Located 1650 Feet From the SOUTH Line, 1850 Feet From the WEST Line,

SAN JUAN County, New Mexico. G. L. Elevation 6365.8 UNGRADED.

Name of Producing Formation Mesaverde Pool Blanco Mesaverde Dedicated Acreage 320.11

(Note: All distances must be from outer boundaries of Section)

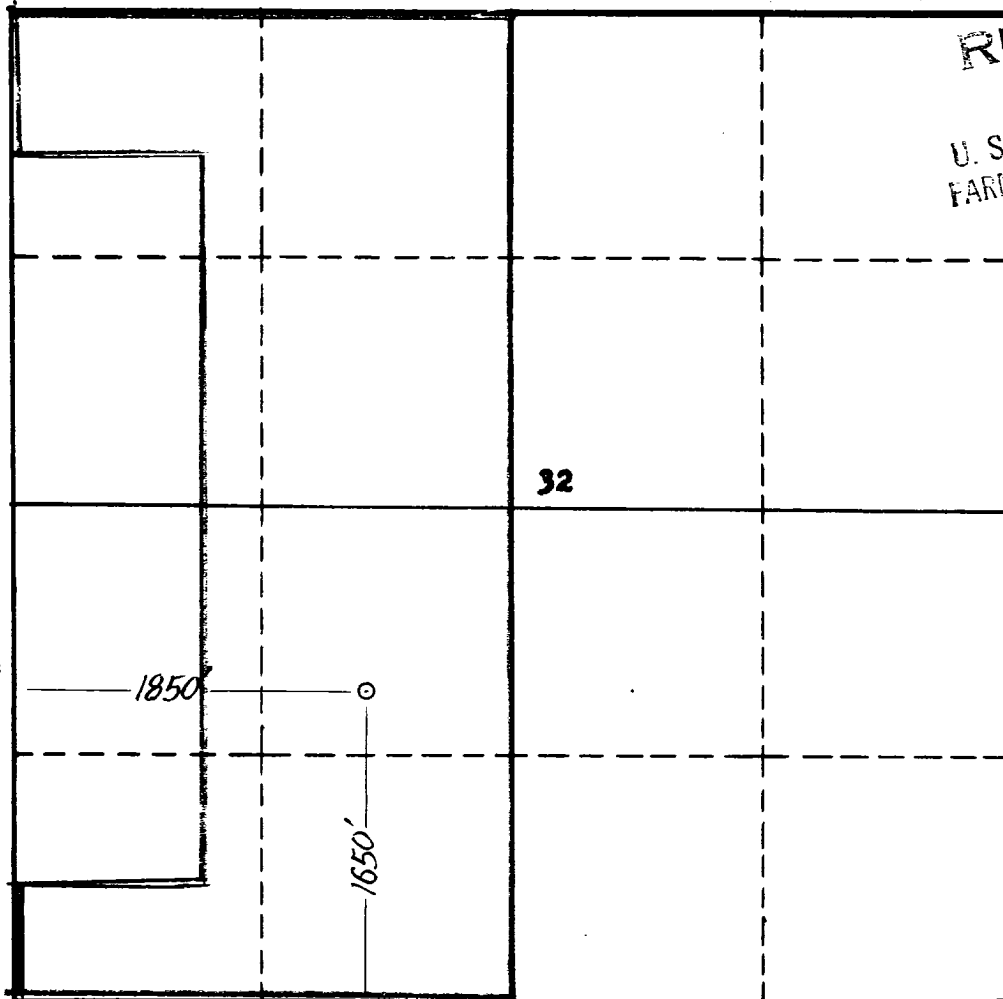

RECEIVED
APR 25 1956
U. S. GEOLOGICAL SURVEY
FARMINGTON, NEW MEXICO

Patented _____

State _____



NOTE

This section of form is to be used for gas wells only.

SCALE: 1"=1000'

1. Is this Well a Dual Comp. ? Yes No X
2. If the answer to Question 1 is yes, are there any other dually completed wells within the dedicated acreage ? Yes No

Name De Lasso Loos DE LASSO LOOS
Position Field Superintendent
Representing Blackwood & Nichols Company
Address P.O. Box 1237, Durango, Colorado

This is to certify that the above plat was prepared from field notes of actual surveys made by me or under my supervision and that the same are true and correct to the best of my knowledge and belief.

Date Surveyed 5 MARCH 1956

James P. Loos
Registered Professional Engineer and/or
Land Surveyor James P. Loos
N. Mex. Reg. No. 1463

CONSERVATION COMMISSION		
AZTEC DISTRICT OFFICE		
No. Copies Received <u>4</u>		
DISTRIBUTION		
	no copies	
Operator	<u>1</u>	
Santa Fe	<u>1</u>	
Proration Office		
State Land Office	<u>1</u>	
U. S. G. S.	<u>2</u>	
Transporter		
File	<u>1</u>	<input checked="" type="checkbox"/>