

(SUBMIT IN TRIPLICATE)

Indian Agency Ute Mts

UNITED STATES

Tribal Lands

DEPARTMENT OF THE INTERIOR

Allottee _____

GEOLOGICAL SURVEY

Lease No. Contract 14-20-60-20

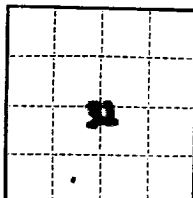

SUNDRY NOTICES AND REPORTS ON WELLS

NOTICE OF INTENTION TO DRILL.....	<input checked="" type="checkbox"/>	SUBSEQUENT REPORT OF WATER SHUT-OFF.....	
NOTICE OF INTENTION TO CHANGE PLANS.....		SUBSEQUENT REPORT OF SHOOTING OR ACIDIZING.....	
NOTICE OF INTENTION TO TEST WATER SHUT-OFF.....		SUBSEQUENT REPORT OF ALTERING CASING.....	
NOTICE OF INTENTION TO REDRILL OR REPAIR WELL.....		SUBSEQUENT REPORT OF REDRILLING OR REPAIR.....	
NOTICE OF INTENTION TO SHOOT OR ACIDIZE.....		SUBSEQUENT REPORT OF ABANDONMENT.....	
NOTICE OF INTENTION TO PULL OR ALTER CASING.....		SUPPLEMENTARY WELL HISTORY.....	
NOTICE OF INTENTION TO ABANDON WELL.....			

(INDICATE ABOVE BY CHECK MARK NATURE OF REPORT, NOTICE, OR OTHER DATA)

March 23, 19 57

Ute Mountain Tribe "B"

Well No. 7 is located 660 ft. from S line and 1880 ft. from W line of sec. 31

C-22-SW Sec. 31

T11N

R13W

Range

(1/4 Sec. and Sec. No.)

(Twp.)

(Range)

(Meridian)

Verde-Gallup

San Juan

(Field)

(County or Subdivision)

(State or Territory)

The elevation of the derrick floor above sea level is 5690 ft. (estimated)

DETAILS OF WORK

(State names of and expected depths to objective sands; show sizes, weights, and lengths of proposed casings; indicate casing points, and all other important proposed work)

We propose to drill a well at the above location through the Tecite formation to an approximate total depth of 2170'. We will set and cement to the surface 10' 3-7/8", 20#, 11-10 casing with 60 ann.

Estimated formation tops are as follows: Mancos Shale 670' and Tecite 2000'.

Correlation log will be run at 2000' and 3-1/8", 15.5#, 8-95 casing will be run to approximately 2040' and cemented with 100 ann. The Tecite will be cased using crude oil as drilling fluid.

All work to be done in accordance with the Rules and Regulations of the USGS and New Mexico Oil and Gas Conservation Commission.

I understand that this plan of work must receive approval in writing by the Geological Survey before operations may be commenced.

Company THUNDERBOLT GAS TRANSMISSION COMPANY

Address P. O. Box 177B

Casper, Wyoming

By Fetterman Lay
Title District Superintendent



NEW MEXICO OIL CONSERVATION COMMISSION

Well Location and/or Gas Proration Plat

Form O-128

Date

Operator **TENNESSEE GAS TRANSMISSION CO.**

Lease **UTE MOUNTAIN TRIBE**

Well No. **B-207**

Section **31**

Township **31 N**

Range **15 W**

NMPM

Located **660**

Feet From **south**

Line, **1880**

Feet From **west**

Line.

San Juan

County, New Mexico, G. L. Elevation **5449**

Name of Producing Formation

Pool

Dedicated Acreage

(Note: All distances must be from center boundaries of Section)

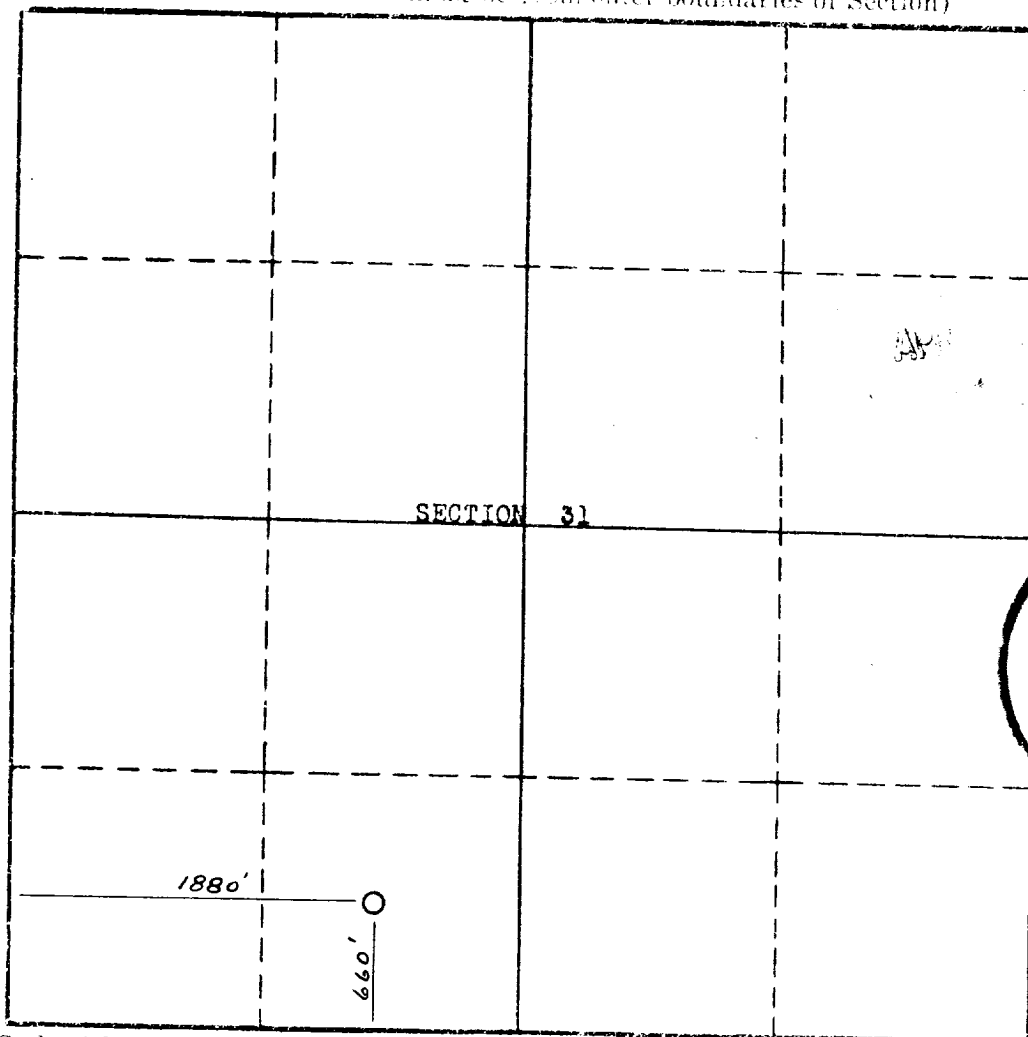

Scale—1 Inch Equals 1000 Feet

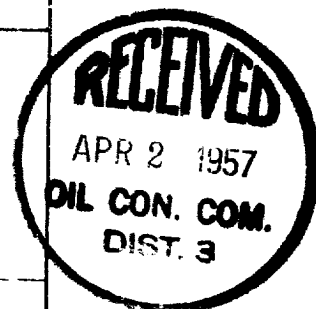

1. Is this Well a Dual Comp.? Yes ☐ No ☐
2. If the answer to Question 1 is yes, are there any other dually completed wells within the dedicated acreage? Yes ☐ No ☐

This is to certify that the above plat was prepared from field notes of actual surveys made by me or under my supervision and that the same are true and correct to the best of my knowledge and belief.

Name

Position

Representing

Address

Date Surveyed **March 21, 1957**

Stephen H. Kinney

STEPHEN H. KINNEY

Registered Professional Engineer and Land Surveyor

