

(SUBMIT IN TRIPLICATE)

UNITED STATES
DEPARTMENT OF THE INTERIOR
GEOLOGICAL SURVEY

Land Office **SANTA FE**

Lease No. **SP 078244**

Unit **1/2 Sec. 31, T-31N,
R-12W, S.R.2.N., San Juan
County, New Mexico**

SUNDRY NOTICES AND REPORTS ON WELLS

NOTICE OF INTENTION TO DRILL.....	<input checked="" type="checkbox"/>	SUBSEQUENT REPORT OF WATER SHUT-OFF.....	
NOTICE OF INTENTION TO CHANGE PLANS.....		SUBSEQUENT REPORT OF SHOOTING OR ACIDIZING.....	
NOTICE OF INTENTION TO TEST WATER SHUT-OFF.....		SUBSEQUENT REPORT OF ALTERING CASING.....	
NOTICE OF INTENTION TO RE-DRILL OR REPAIR WELL.....		SUBSEQUENT REPORT OF RE-DRILLING OR REPAIR.....	
NOTICE OF INTENTION TO SHOOT OR ACIDIZE.....		SUBSEQUENT REPORT OF ABANDONMENT.....	
NOTICE OF INTENTION TO PULL OR ALTER CASING.....		SUPPLEMENTARY WELL HISTORY.....	
NOTICE OF INTENTION TO ABANDON WELL.....			

(INDICATE ABOVE BY CHECK MARK NATURE OF REPORT, NOTICE, OR OTHER DATA)

February 22, 1961

Taliaferro
Well No. **2** is located **990** ft. from **S** line and **990** ft. from **W** line of sec. **31**
SW 1/4 Sec. 31 **31N** **12W** **S.R.2.N.**
(1/4 Sec. and Sec. No.) (Twp.) (Range) (Meridian)
Basin-Dakota **San Juan County** **New Mexico**
(Field) (County or Subdivision) (State or Territory)

The elevation of the derrick floor above sea level is **5902** ft. G.L.

DETAILS OF WORK

(State names of and expected depths to objective sands; show sizes, weights, and lengths of proposed casings; indicate mudlogging jobs, cementing points, and all other important proposed work)

The objective sand is the Dakota Formation, anticipated at approximately 6880 feet.

Proposed Casing Program: 250' 8-5/8" OD., 3200#, J-55 Cemented to surface
6880' 4-1/2" OD., 9.50#, J-55 Cemented w/250 sacks

Run 4 1/2" Stage collar set below Mesa Verde Formation, Cement w/100 sacks.

Rotary tools will be employed from surface to F.D. Pipe will be set at approx. 6880'.

The well will be Sand-Fraced in an effort to stimulate production.

I understand that this plan of work must receive approval in writing by the Geological Survey before operations may be commenced.

Company **SOUTHERN UNION PRODUCTION COMPANY**

Address **P. O. Box 808**

Farmington, New Mexico

By **Gilbert D. Noland, Jr.**
Gilbert D. Noland, Jr.
Title **Drilling Superintendent**

NUMBER OF COPIES RECEIVED	
DISTRIBUTION	
SANTA FE	
FILE	
U.S.G.S.	
LAND OFFICE	
TRANSPORTER	OIL
	GAS
PRODUCTION OFFICE	
OPERATOR	

NEW MEXICO OIL CONSERVATION COMMISSION
WELL LOCATION AND ACREAGE DEDICATION PLAT
 SEE INSTRUCTIONS FOR COMPLETING THIS FORM ON THE REVERSE SIDE

FORM C-128
 Revised 6/1/57

RECEIVED
 FEB 27 1961

SECTION A

Operator PRODUCTION SOUTHERN UNION GAS COMPANY		Lease Taliaferro		Well No. 2
Unit Letter M	Section 31	Township 31 NORTH	Range 12 WEST	County SAN JUAN
Actual Footage Location of Well: 990 feet from the SOUTH line and 990 feet from the WEST line				
Ground Level Elev. 5902.0	Producing Formation DAKOTA	Pool Basin-Dakota	Dedicated Acreage: 320 Acres	

Ref: GLO plat dated 18 November 1953

- Is the Operator the only owner in the dedicated acreage outlined on the plat below? YES X NO ____ . ("Owner" means the person who has the right to drill into and to produce from any pool and to appropriate the production either for himself or for himself and another. (65-3-29 (e) NMSA 1935 Comp.)
- If the answer to question one is "no," have the interests of all the owners been consolidated by communitization agreement or otherwise? YES ____ NO ____ . If answer is "yes," Type of Consolidation _____
- If the answer to question two is "no," list all the owners and their respective interests below:

Owner	Land Description

RECEIVED
 FEB 22 1961

SECTION B

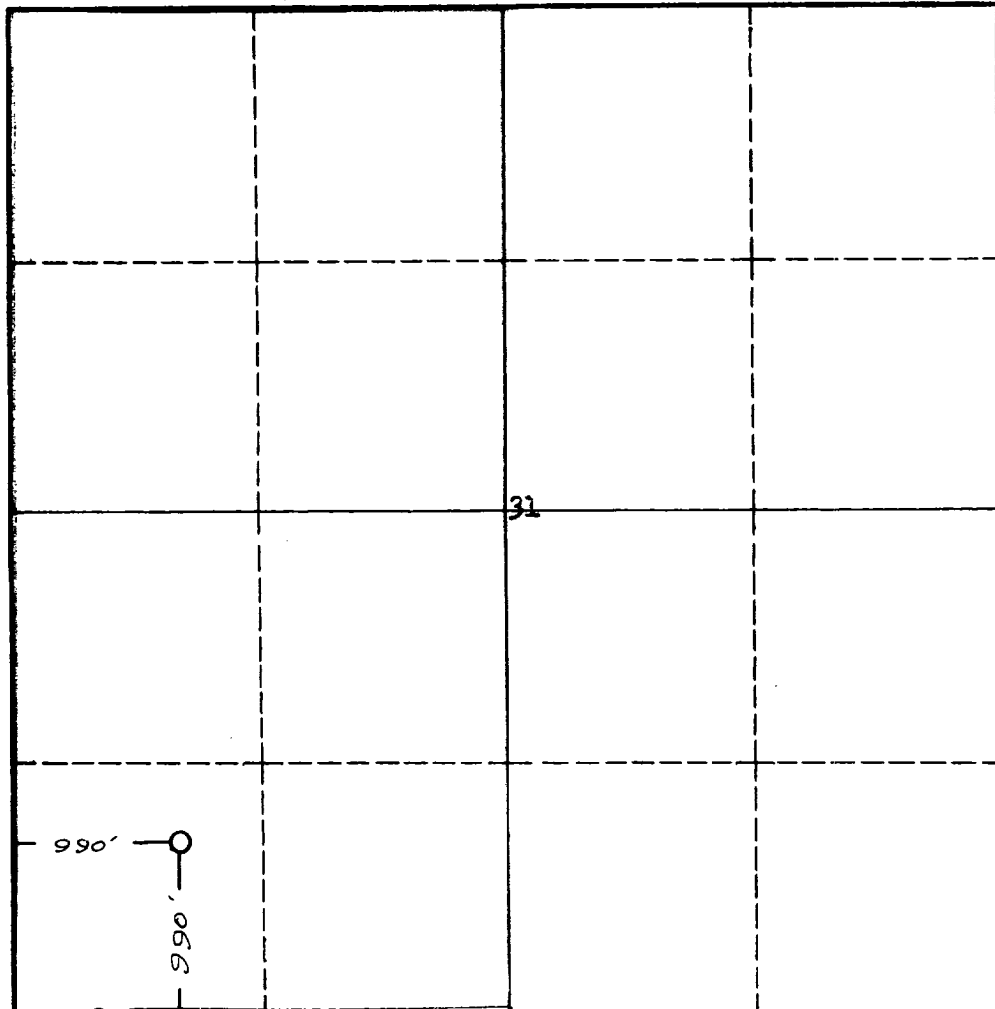

U. S. GEOLOGICAL SURVEY
 CERTIFICATION, NEW MEXICO

I hereby certify that the information in SECTION A above is true and complete to the best of my knowledge and belief.

Name Gilbert D. Nolan, Jr.
Position Drilling Superintendent
Company SOUTHERN UNION PROD. CO.
Date February 22, 1961

I hereby certify that the well location shown on the plat in SECTION B was plotted from field notes of actual surveys made by me or under my supervision, and that the same is true and correct to the best of my knowledge and belief.

Date Surveyed 24 November 1960
Registered Professional Engineer and/or Land Surveyor James P. Leese
Certificate No. 1463

INSTRUCTIONS FOR COMPLETION OF FORM C-128

1. Operator shall furnish and certify to the information called for in Section A.
2. Operator shall outline the dedicated acreage for *both* oil and gas wells on the plat in Section B.
3. A registered professional engineer or land surveyor registered in the State of New Mexico or approved by the Commission shall show on the plat the location of the well and certify this information in the space provided.
4. All distances shown on the plat must be from the outer boundaries of the Section.
5. If additional space is needed for listing owners and their respective interests as required in question 3 of Section A, please use space below.