

NO. OF COPIES RECEIVED	
DISTRIBUTION	6
SANTA FE	1
FILE	1
U.S.G.S.	2
LAND OFFICE	1
OPERATOR	1

NEW MEXICO OIL CONSERVATION COMMISSION

Form C-101
Revised 1-1-65

5A. Indicate Type of Lease
STATE <input checked="" type="checkbox"/> FEE <input type="checkbox"/>
5. State Oil & Gas Lease No.
OG-2005

APPLICATION FOR PERMIT TO DRILL, DEEPEN, OR PLUG BACK

1a. Type of Work		7. Unit Agreement Name	
DRILL <input checked="" type="checkbox"/> DEEPEN <input type="checkbox"/> PLUG BACK <input type="checkbox"/>			
b. Type of Well		8. Farm or Lease Name	
OIL WELL <input type="checkbox"/> GAS WELL <input checked="" type="checkbox"/> OTHER <input type="checkbox"/> SINGLE ZONE <input checked="" type="checkbox"/> MULTIPLE ZONE <input type="checkbox"/>		State "BH" Gas Com.	
2. Name of Operator		9. Well No.	
PAN AMERICAN PETROLEUM CORPORATION		1	
3. Address of Operator		10. Field and Pool, or Wildcat	
P. O. Box 480, Farmington, New Mexico		Basin Dakota	
4. Location of Well		12. County	
UNIT LETTER <u>M</u> LOCATED <u>900</u> FEET FROM THE <u>South</u> LINE AND <u>870</u> FEET FROM THE <u>West</u> LINE OF SEC. <u>32</u> TWP. <u>31-N</u> RGE. <u>13-W</u> NMPM		San Juan	
19. Proposed Depth		19A. Formation	
6300		Dakota	
20. Rotary or C.T.		Rotary	
21. Elevations (Show whether DF, RT, etc.)		21B. Drilling Contractor	
Will report later		JCM Drilling Company	
21A. Kind & Status Plug. Bond		22. Approx. Date Work will start	
Statewide		July 29, 1965	

23.

PROPOSED CASING AND CEMENT PROGRAM

SIZE OF HOLE	SIZE OF CASING	WEIGHT PER FOOT	SETTING DEPTH	SACKS OF CEMENT	EST. TOP
12-1/4"	8-5/8"	24#	350	250	Surface
7-7/8"	4-1/2"	10.5#	6300*	1500	Surface
* Stage collar set 100' below Mesaverde.					

Copies of location plat are attached.

Copies of any logs run will be furnished upon completion of well.



IN ABOVE SPACE DESCRIBE PROPOSED PROGRAM: IF PROPOSAL IS TO DEEPEN OR PLUG BACK, GIVE DATA ON PRESENT PRODUCTIVE ZONE AND PROPOSED NEW PRODUCTIVE ZONE. GIVE BLOWOUT PREVENTER PROGRAM, IF ANY.

I hereby certify that the information above is true and complete to the best of my knowledge and belief.

ORIGINAL SIGNED BY George W. Eaton, Area Engineer
Signed G. W. Eaton, Jr. Title Sup Dist III Date July 28, 1965

(This space for State Use)

APPROVED BY George W. Eaton, Jr. TITLE Sup Dist III APPROVAL VALID FOR 90 DAYS UNLESS DRILLING COMMENCED, EXPIRES 8-2-65

CONDITIONS OF APPROVAL, IF ANY:

EXPIRES

NEW MEXICO OIL CONSERVATION COMMISSION

Well Location and Acreage Dedication Plat

Date JULY 28, 1965

Section A.

Operator PAN AMERICAN PETROLEUM CORPORATION Lease STATE "BH" GAS COM
 Well No. 1 Unit Letter M Section 32 Township 31 NORTH Range 13 WEST NMPM
 Located 900 Feet From the SOUTH Line, 870 Feet From the WEST Line
 County SAN JUAN G. L. Elevation REPORT LATER Dedicated Acreage 320 Acres
 Name of Producing Formation DAKOTA Pool BASIN DAKOTA

1. Is the Operator the only owner in the dedicated acreage outlined on the plat below?

Yes X No _____

2. If the answer to question one is "no", have the interests of all the owners been consolidated by communitization agreement or otherwise? Yes _____ No _____. If answer is "yes", Type of Consolidation.

3. If the answer to question two is "no", list all the owners and their respective interests below:

Owner

Land Description

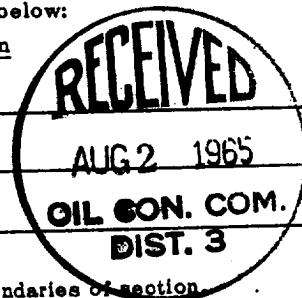

Section B.

This is to certify that the information
 in Section A above is true and complete
 to the best of my knowledge and belief.

PAN AMERICAN PETROLEUM CORP.F. H. Hollingsworth (Operator)F. H. Hollingsworth
(Representative)P. O. Box 480

(Address)

Farmington, New Mexico

Note: All distances must be from outer boundaries of section.

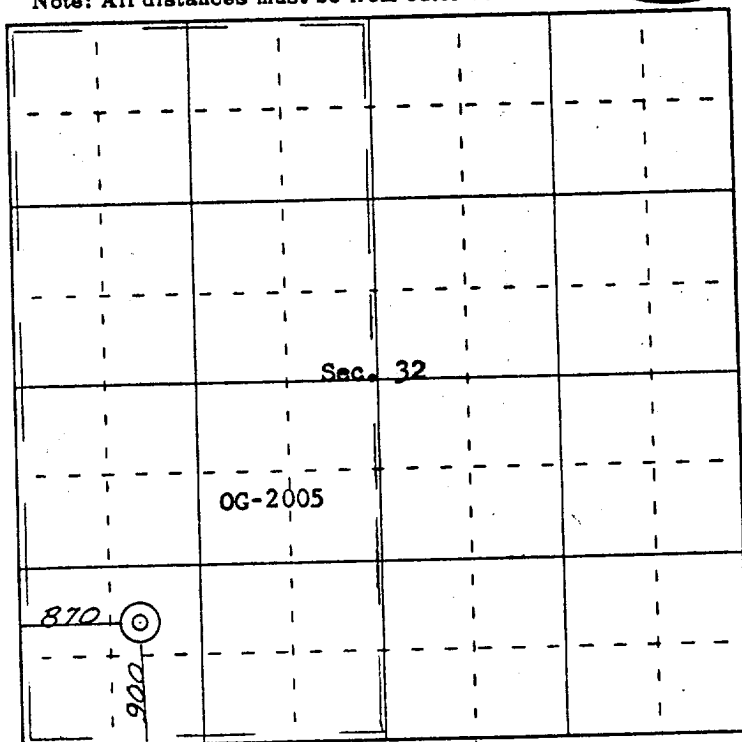

0 320 640 960 1280 1600 1920 2240 2560 2880 3200 3520 3840 4160 4480 4800 5120 5440 5760 6080 6400

Scale 4 inches equal 1 mile

Ref. GLO plat dated July 9, 1954

This is to certify that the above plat was prepared from field notes of actual surveys
 made by me or under my supervision and that the same are true and correct to the best
 of my knowledge and belief.

Date Surveyed July 20, 1965

James P. Leese
 Registered Professional Engineer and/or Land Surveyor
 James P. Leese, N.Mex. Reg. No. 1463
 San Juan Engineering Company.

Farmington, New Mexico