

(SUBMIT IN TRIPLICATE)

UNITED STATES
DEPARTMENT OF THE INTERIOR
GEOLOGICAL SURVEY

Indian Agency _____

Window Rock _____

Allottee Navajo Tribal

Lease No. 11-20-603-734

SUNDRY NOTICES AND REPORTS ON WELLS

NOTICE OF INTENTION TO DRILL	<input checked="" type="checkbox"/>	SUBSEQUENT REPORT OF WATER SHUT-OFF	
NOTICE OF INTENTION TO CHANGE PLANS		SUBSEQUENT REPORT OF SHOOTING OR ACIDIZING	
NOTICE OF INTENTION TO TEST WATER SHUT-OFF		SUBSEQUENT REPORT OF ALTERING CASING	
NOTICE OF INTENTION TO REDRILL OR REPAIR WELL		SUBSEQUENT REPORT OF REDRILLING OR REPAIR	
NOTICE OF INTENTION TO SHOOT OR ACIDIZE		SUBSEQUENT REPORT OF ABANDONMENT	
NOTICE OF INTENTION TO PULL OR ALTER CASING		SUPPLEMENTARY WELL HISTORY	
NOTICE OF INTENTION TO ABANDON WELL			

(INDICATE ABOVE BY CHECK MARK NATURE OF REPORT, NOTICE, OR OTHER DATA)

RECEIVED

SUR
SANTO DOMINGO NEW MEXICO

December 29, 19 58

Well No. 28 is located 1949 ft. from S line and 1980 ft. from E line of sec. 31
N. SE Sec. 31 31 N 16 W N.H.P.M.
 (1/4 Sec. and Sec. No.) (Twp.) (Range) (Meridian)
Horseshoe Gallup San Juan New Mexico
 (Field) (County or Subdivision) (State or Territory)

The elevation of the ground ~~description~~ above sea level is 5462 ft.

DETAILS OF WORK

(State names of and expected depths to objective sands; show sizes, weights, and lengths of proposed casings; indicate mudding jobs, cementing points, and all other important proposed work)

We propose to drill a well with rotary tools at the above location to an approximate total depth of 1400'. 100' of 8-5/8" O.D. casing will be set and cemented to surface. Completion is contemplated in the Gallup formation. Should the well prove productive a 5-1/2" O.D. oil string will be used.



I understand that this plan of work must receive approval in writing by the Geological Survey before operations may be commenced.

Company The Atlantic Refining Company

Address P. O. Box 520

Casper, Wyoming

By Ad Klopfer

Title Drilling Superintendent

Winton Road
Hawthorn
H-50-003-731

1

28
22
20
19
18
17
16
15
14
13
12
11
10
9
8
7
6
5
4
3
2
1

...the ... of ...
...the ... of ...
...the ... of ...
...the ... of ...

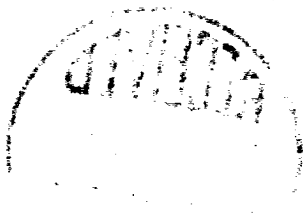

...

...

...

...

NEW MEXICO OIL CONSERVATION COMMISSION

Well Location and Acreage Dedication Plat

Section A.

Date **JANUARY 20, 1959**

Operator **ATLANTIC REFINING CO.** Lease **NAVAJO**
 Well No. **28** Unit Letter **J** Section **31** Township **31 NORTH** Range **16 WEST** NMPM
 Located **1949** Feet From **SOUTH** Line, **1980** Feet From **EAST** Line
 County **SAN JUAN** G. L. Elevation **5462.0** Dedicated Acreage **40** Acres
 Name of Producing Formation **GALLUP** Pool **HORSESHOE GALLUP**

1. Is the Operator the only owner in the dedicated acreage outlined on the plat below?
 Yes ☒ No ☐
2. If the answer to question one is "no", have the interests of all the owners been consolidated by communitization agreement or otherwise? Yes ☐ No ☐ If answer is "yes", Type of Consolidation.
3. If the answer to question two is "no", list all the owners and their respective interests below:

Owner

Land Description

Section B.

Note: All distances must be from outer boundaries of section.

This is to certify that the information in Section A above is true and complete to the best of my knowledge and belief.

The Atlantic Refining Co
 (Operator)
W. O. K. K. K.
 (Representative)
Box 520
 (Address)
Casper, Wyo

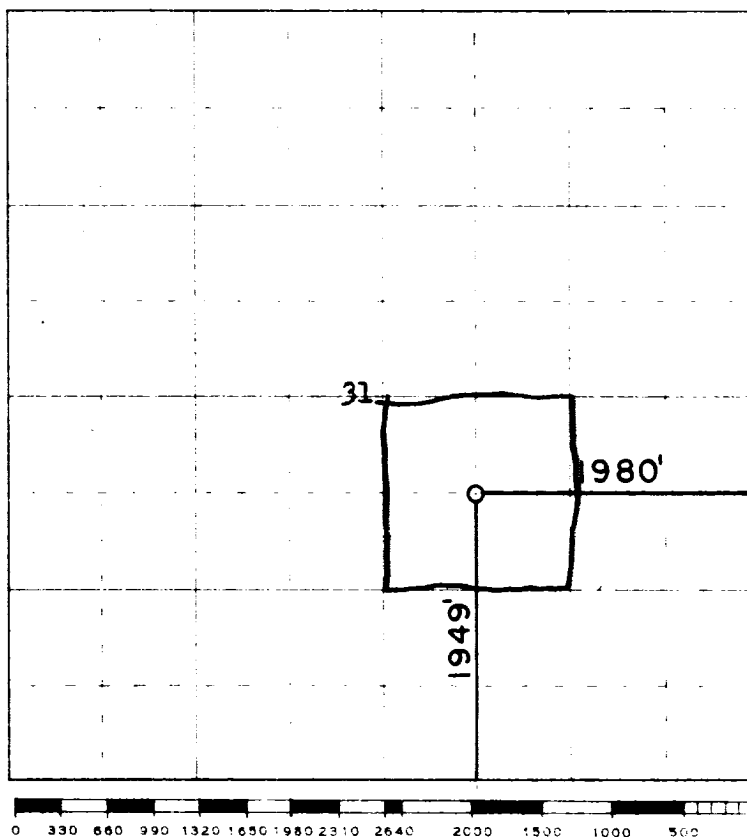

Farmington, New Mexico

This is to certify that the above plat was prepared from field notes of actual surveys made by me or under my supervision and that the same are true and correct to the best of my knowledge and belief.

Date Surveyed **24 DECEMBER 1958**

James P. Lease
 Registered Professional Engineer and/or Land Surveyor

OIL CONSERVATION COMMISSION		
AZTEC DISTRICT OFFICE		
No. Copies Received		✓
DISTRIBUTION		
	NO. COPIES	
Operator		
Santa Fe	/	
Protection Office		
State Land Office	✓	
U. S. G. S.		
Transporter		
File	/	✓